

Map Lot U19-001

Account 1808

Location 822 BATH ROAD

Card 1 Of 1 9/19/2022

CEDERLUND, L.B. & H.A.  
MAIN, JUDITH C.; TRUSTEE  
WISCASSET ME 04578

B1651P294

Inspection Witnessed By:

X

Date

No./Date	Description	Date Insp.

Notes:

WISCASSET

### Property Data

Neighborhood	200 U.S. RTE 1		
Tree Growth Year	0		
FARM LAND YEAR	0		
OPEN SPACE YEAR	0		
Zone/Land Use	21 RURAL		
Secondary Zone			
Topography	1 Level		
1.Level	4.Below St	7.Steep	
2.Rolling	5.Low	8.Rough	
3.Above St	6.Swampy	9.	
Utilities	2 Public Water	5 Dugwell/Lake	
1.Public	4.Dr Well	7.Cesspool	
2.Water	5.DUG/LAKE	8.	
3.Sewer	6.Septic	9.None	
Street	1 Paved		
1.Paved	4.Proposed	7.	
2.Semi Imp	5.Private	8.	
3.Gravel	6.Pub Eas	9.NoStreet	
TREE GROWTH PLAN	0		
CONSERV EASE	0		
Sale Data			
Sale Date			
Price			
Sale Type			
1.Land	4.Mobile	7.	
2.L & B	5.Other	8.	
3.Building	6.	9.	
Financing			
1.Convent	4.Seller	7.	
2.FHA/VA	5.Private	8.	
3.Assumed	6.Cash	9.Unknown	
Validity			
1.Valid	4.Split	7.Renovate	
2.Related	5.Partial	8.Other	
3.Distress	6.Exempt	9.Foreclose	
Verified			
1.Buyer	4.Agent	7.Family	
2.Seller	5.Pub Rec	8.Other	
3.Lender	6.MLS	9.	

### Assessment Record

Year	Land	Buildings	Exempt	Total
2009	91,520	100,300	19,000	172,820
2010	91,500	100,300	16,000	175,800
2011	91,500	100,300	16,000	175,800
2012	91,500	100,300	16,000	175,800
2013	91,500	100,300	16,000	175,800
2014	91,500	100,300	16,000	175,800
2015	91,500	100,300	16,000	175,800
2016	91,500	100,300	21,000	170,800
2017	91,500	100,300	26,000	165,800
2018	91,500	100,300	26,000	165,800
2019	91,500	100,300	26,000	165,800
2020	91,500	100,300	31,000	160,800
2021	91,500	100,300	31,000	160,800
2022	91,500	100,300	29,760	162,040

### Land Data

Front Foot	Type	Effective		Influence		Influence Codes
		Frontage	Depth	Factor	Code	
11.Regular Lot				%		1.Open Space
12.Delta Triangle				%		2.Neighborhood A
13.Nabla Triangle				%		3.Topography
14.Rear Land				%		4.Size/Shape
15.Front Foot				%		5.Access
				%		6.Restriction
				%		7.Corner/Locatio
				%		8.View/Environ
				%		9.Fract Share
				%		Acres
				%		30.Rear 20+
				%		31.Waterfront Rea
				%		32.Open Space
				%		33.RestrictEsm
				%		34.PASTURE 1
				%		35.HORTICULTURAL-
				%		36.Pasture 3
				%		37.Softwood
				%		38.Mixed Wood
				%		39.Hardwood
				%		40.Wasteland
				%		41.CAMP SITE
				%		42.Mobile Home Si
				%		43.Condo Site
				%		44.Site Improve
				%		45.CAMP SITE
				%		46.PAVING/00
Total Acreage		0.76				

# WISCASSET

Map Lot U19-001

Account 1808

Location 822 BATH ROAD

Card 1

Of 1

9/19/2022

Building Style <b>2 Ranch</b>	SF Bsmt Living <b>0</b>	Layout <b>1 Typical</b>
1.Conv. 5.Colonial 9.Other	Fin Bsmt Grade <b>0 0</b>	1.Typical 4. 7.
2.Ranch 6.Split 10.Double	HEARTH <b>1</b>	2.Inadeq 5. 8.
3.R Ranch 7.Mod/Cont 11.Multi	Heat Type <b>100% 1 Hot Water BB</b>	3. 6. 9.
4.Cape 8.Log 12.Cot.	1.HWBB 5.FWA 9.No Heat	Attic <b>5 Floor &amp; Stairs</b>
Dwelling Units <b>1</b>	2.HWCI 6.GravWA 10.	1.1/4 Fin 4.Full Fin 7.
Other Units <b>1</b>	3.H Pump 7.Electric 11.	2.1/2 Fin 5.F/Stair 8.
Stories <b>1 One Story</b>	4.Steam 8.F/Wall 12.	3.3/4 Fin 6. 9.None
1.1 4.1.5 7.	Cool Type <b>0% 9 None</b>	Insulation <b>1 Full</b>
2.2 5.1.75 8.	1.Refrig 4.W&C Air 7.	1.Full 4.Minimal 7.
3.3 6.2.5 9.	2.Evapor 5. 8.	2.Heavy 5.Unknown 8.
Exterior Walls <b>8 ALUM/VINYL</b>	3.H Pump 6. 9.None	3.Capped 6. 9.None
1.CLAP 5.T-111 9.OTHER	Kitchen Style <b>2 TYPICAL</b>	Unfinished % <b>0%</b>
2.WD SH 6.BR/STONE 10.	1.GOOD 4.Obsolete 7.	Grade & Factor <b>3 Average 105%</b>
3.COMP 7.NOV 11.	2.TYPICAL 5. 8.	1.E Grade 4.B Grade 7.AA+ Grad
4.ASB/ASP 8.AL/VIN 12.	3.OLD TYPE 6. 9.None	2.D Grade 5.A Grade 8.AA++Grad
Roof Surface <b>1 Asphalt Shingles</b>	Bath(s) Style <b>2 TYPICAL</b>	3.C Grade 6.AA Grade 9.Same
1.Asphalt 4.Composit 7.	1.GOOD 4.Obsolete 7.	SQFT (Footprint) <b>1140</b>
2.Slate 5.Wood 8.	2.TYPICAL 5. 8.	Condition <b>3 Below Average</b>
3.Metal 6.Other 9.	3.Old Type 6. 9.None	1.Poor 4.Avg 7.V G
SF Masonry Trim <b>0</b>	# Rooms <b>5</b>	2.Fair 5.Avg+ 8.Exc
OPEN-3-CUSTOM <b>0</b>	# Bedrooms <b>3</b>	3.Avg- 6.Good 9.Same
OPEN-4-CUSTOM <b>0</b>	# Full Baths <b>1</b>	Phys. % Good <b>0%</b>
Year Built <b>1956</b>	# Half Baths <b>0</b>	Funct. % Good <b>100%</b>
Year Remodeled <b>0</b>	# Addn Fixtures <b>0</b>	Functional Code <b>9 None</b>
Foundation <b>2 Concrete Block</b>	# Fireplaces <b>1</b>	1.Incomp 4.SMALL 7.LAYOUT
1.Concrete 4.Wood 7.		2.O-Built 5.CDU 8.OTHER
2.C Block 5.Slab 8.		3.Defmaint 6.STYLE 9.None
3.Br/Stone 6.Piers 9.		Econ. % Good <b>100%</b>
Basement <b>4 Full Basement</b>		Economic Code <b>None</b>
1.1/4 Bmt 4.Full Bmt 7.		0.None 3.Services 9.None
2.1/2 Bmt 5.None 8.		1.Location 4.Traffic 8.
3.3/4 Bmt 6. 9.None		2.Encroach 8.Other 9.
Bsmt Gar # Cars <b>0</b>		Entrance Code <b>1 Interior Inspect</b>
Wet Basement <b>3 Wet Basement</b>		1.Interior 4.Vacant 7.
1.Dry 4. 7.		2.Refusal 5.Estimate 8.
2.Damp 5. 8.		3.Informed 6. 9.
3.Wet 6. 9.		Information Code <b>1 Owner</b>
		1.Owner 4.Agent 7.
		2.Relative 5.Estimate 8.
		3.Tenant 6.Other 9.

Date Inspected 3/28/2007

## Additions, Outbuildings & Improvements

Type	Year	Units	Grade	Cond	Phys.	Funct.	Sound Value	
22 Encl Frame Porch	0	60	0 0	0	0 %	0 %		1.ONE STORY FRAM
22 Encl Frame Porch	0	121	0 0	0	0 %	0 %		2.TWO STORY FRAM
23 Frame Garage	0	440	0 0	0	0 %	100 %		3.THREE STORY FR
23 Frame Garage	1960	592	4 100	3	0 %	100 %		4.1 & 1/2 STORY
					%	%		5.1 & 3/4 STORY
					%	%		6.2 & 1/2 STORY
					%	%		21.Open Frame Por
					%	%		22.Encl Frame Por
					%	%		23.Frame Garage
					%	%		24.Frame Shed
					%	%		25.Frame Bay Wind
					%	%		26.1SFr Overhang
					%	%		27.Unfin Basement
					%	%		28.Unfinished Att
					%	%		29.Finished Attic

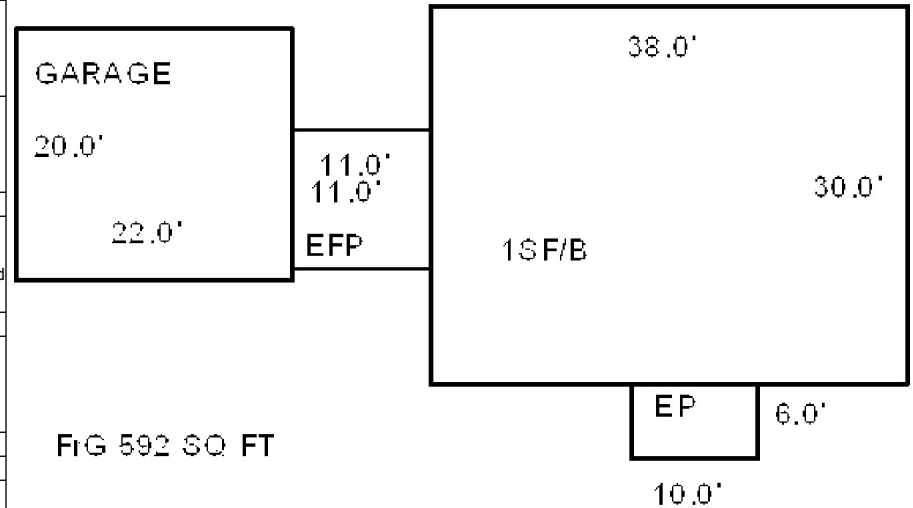

Map Lot U19-002

Account 1809

Location 830 BATH ROAD

Card 1 Of 1 9/19/2022

HARRISON, RONALD L  
HARRISON, DEBRA A  
830 BATH ROAD  
WISCASSET ME 04578

B855P178 B5265P120

Inspection Witnessed By:

X

Date

No./Date	Description	Date Insp.

Notes:

WISCASSET

### Property Data

Neighborhood	200 U.S. RTE 1		
Tree Growth Year	0		
FARM LAND YEAR	0		
OPEN SPACE YEAR	0		
Zone/Land Use	21 RURAL		
Secondary Zone	14 S-R		
Topography	1 Level		
1.Level	4.Below St	7.Steep	
2.Rolling	5.Low	8.Rough	
3.Above St	6.Swampy	9.	
Utilities	4 Drilled Well	6 Septic System	
1.Public	4.Dr Well	7.Cesspool	
2.Water	5.DUG/LAKE	8.	
3.Sewer	6.Septic	9.None	
Street	1 Paved		
1.Paved	4.Proposed	7.	
2.Semi Imp	5.Private	8.	
3.Gravel	6.Pub Eas	9.NoStreet	
TREE GROWTH PLAN	0		
CONSERV EASE	0		
Sale Data			
Sale Date	6/06/2018		
Price	135,000		
Sale Type	2 Land & Buildings		
1.Land	4.Mobile	7.	
2.L & B	5.Other	8.	
3.Building	6.	9.	
Financing	9 Unknown		
1.Convent	4.Seller	7.	
2.FHA/VA	5.Private	8.	
3.Assumed	6.Cash	9.Unknown	
Validity	8 Other Non Valid		
1.Valid	4.Split	7.Renovate	
2.Related	5.Partial	8.Other	
3.Distress	6.Exempt	9.Foreclose	
Verified	5 Public Record		
1.Buyer	4.Agent	7.Family	
2.Seller	5.Pub Rec	8.Other	
3.Lender	6.MLS	9.	

### Assessment Record

Year	Land	Buildings	Exempt	Total
2009	112,100	92,440	19,000	185,540
2010	112,100	92,400	16,000	188,500
2011	112,100	92,400	16,000	188,500
2012	112,100	92,400	16,000	188,500
2013	112,100	92,400	16,000	188,500
2014	112,100	92,400	16,000	188,500
2015	112,100	92,400	16,000	188,500
2016	112,100	92,400	21,000	183,500
2017	112,100	92,400	26,000	178,500
2018	112,100	92,400	26,000	178,500
2019	112,100	104,200	20,000	196,300
2020	112,100	104,200	25,000	191,300
2021	112,100	104,200	25,000	191,300
2022	112,100	104,200	24,000	192,300

### Land Data

Front Foot	Type	Effective		Influence		Influence Codes
		Frontage	Depth	Factor	Code	
11.Regular Lot				%		1.Open Space
12.Delta Triangle				%		2.Neighborhood A
13.Nabla Triangle				%		3.Topography
14.Rear Land				%		4.Size/Shape
15.Front Foot				%		5.Access
				%		6.Restriction
				%		7.Corner/Locatio
				%		8.View/Environ
				%		9.Fract Share
				%		Acres
				%		30.Rear 20+
				%		31.Waterfront Rea
				%		32.Open Space
				%		33.RestrictEsm
				%		34.PASTURE 1
				%		35.HORTICULTURAL-
				%		36.Pasture 3
				%		37.Softwood
				%		38.Mixed Wood
				%		39.Hardwood
				%		40.Wasteland
				%		41.CAMP SITE
				%		42.Mobile Home Si
				%		43.Condo Site
				%		44.Site Improve
				%		45.CAMP SITE
				%		46.PAVING/00
Total Acreage		4.80				

# WISCASSET

Map Lot U19-002

Account 1809

Location 830 BATH ROAD

Card 1

Of 1

9/19/2022

Building Style <b>4 Cape Cod</b>	SF Bsmt Living <b>0</b>	Layout <b>1 Typical</b>
1.Conv. 5.Colonial 9.Other	Fin Bsmt Grade <b>0 0</b>	1.Typical 4. 7.
2.Ranch 6.Split 10.Double	HEARTH <b>0</b>	2.Inadeq 5. 8.
3.R Ranch 7.Mod/Cont 11.Multi	Heat Type <b>100% 2 Hot Water C Iron</b>	3. 6. 9.
4.Cape 8.Log 12.Cot.	1.HWBB 5.FWA 9.No Heat	Attic <b>4 Full Finished</b>
Dwelling Units <b>1</b>	2.HWCI 6.GravWA 10.	1.1/4 Fin 4.Full Fin 7.
Other Units <b>0</b>	3.H Pump 7.Electric 11.	2.1/2 Fin 5.F/Stair 8.
Stories <b>1 One Story</b>	4.Steam 8.F/Wall 12.	3.3/4 Fin 6. 9.None
1.1 4.1.5 7.	Cool Type <b>0% 9 None</b>	Insulation <b>1 Full</b>
2.2 5.1.75 8.	1.Refrig 4.W&C Air 7.	1.Full 4.Minimal 7.
3.3 6.2.5 9.	2.Evapor 5. 8.	2.Heavy 5.Unknown 8.
Exterior Walls <b>8 ALUM/VINYL</b>	3.H Pump 6. 9.None	3.Capped 6. 9.None
1.CLAP 5.T-111 9.OTHER	Kitchen Style <b>2 TYPICAL</b>	Unfinished % <b>0%</b>
2.WD SH 6.BR/STONE 10.	1.GOOD 4.Obsolete 7.	Grade & Factor <b>3 Average 105%</b>
3.COMP 7.NOV 11.	2.TYPICAL 5. 8.	1.E Grade 4.B Grade 7.AA+ Grad
4.ASB/ASP 8.AL/VIN 12.	3.OLD TYPE 6. 9.None	2.D Grade 5.A Grade 8.AA++Grad
Roof Surface <b>1 Asphalt Shingles</b>	Bath(s) Style <b>2 TYPICAL</b>	3.C Grade 6.AA Grade 9.Same
1.Asphalt 4.Composit 7.	1.GOOD 4.Obsolete 7.	SQFT (Footprint) <b>1140</b>
2.Slate 5.Wood 8.	2.TYPICAL 5. 8.	Condition <b>4 Average</b>
3.Metal 6.Other 9.	3.Old Type 6. 9.None	1.Poor 4.Avg 7.V G
SF Masonry Trim <b>0</b>	# Rooms <b>5</b>	2.Fair 5.Avg+ 8.Exc
OPEN-3-CUSTOM <b>0</b>	# Bedrooms <b>3</b>	3.Avg- 6.Good 9.Same
OPEN-4-CUSTOM <b>0</b>	# Full Baths <b>1</b>	Phys. % Good <b>0%</b>
Year Built <b>1955</b>	# Half Baths <b>0</b>	Funct. % Good <b>100%</b>
Year Remodeled <b>0</b>	# Addn Fixtures <b>0</b>	Functional Code <b>9 None</b>
Foundation <b>2 Concrete Block</b>	# Fireplaces <b>1</b>	1.Incomp 4.SMALL 7.LAYOUT
1.Concrete 4.Wood 7.		2.O-Built 5.CDU 8.OTHER
2.C Block 5.Slab 8.		3.Defmaint 6.STYLE 9.None
3.Br/Stone 6.Piers 9.		Econ. % Good <b>100%</b>
Basement <b>4 Full Basement</b>		Economic Code <b>None</b>
1.1/4 Bmt 4.Full Bmt 7.		0.None 3.Services 9.None
2.1/2 Bmt 5.None 8.		1.Location 4.Traffic 8.
3.3/4 Bmt 6. 9.None		2.Encroach 8.Other 9.
Bsmt Gar # Cars <b>0</b>		Entrance Code <b>5 Estimated</b>
Wet Basement <b>1 Dry Basement</b>		1.Interior 4.Vacant 7.
1.Dry 4. 7.		2.Refusal 5.Estimate 8.
2.Damp 5. 8.		3.Informed 6. 9.
3.Wet 6. 9.		Information Code <b>5 Estimate</b>
		1.Owner 4.Agent 7.
		2.Relative 5.Estimate 8.
		3.Tenant 6.Other 9.

Date Inspected 12/08/2006

## Additions, Outbuildings & Improvements

Type	Year	Units	Grade	Cond	Phys.	Funct.	Sound Value	
22 Encl Frame Porch	0	96	0 0	0	0 %	0 %		1.ONE STORY FRAM
23 Frame Garage	0	420	0 0	0	0 %	0 %		2.TWO STORY FRAM
24 Frame Shed	0	168	0 0	0	0 %	0 %		3.THREE STORY FR
22 Encl Frame Porch	0	60	0 0	0	0 %	0 %		4.1 & 1/2 STORY
					%	%		5.1 & 3/4 STORY
					%	%		6.2 & 1/2 STORY
					%	%		21.Open Frame Por
					%	%		22.Encl Frame Por
					%	%		23.Frame Garage
					%	%		24.Frame Shed
					%	%		25.Frame Bay Wind
					%	%		26.1SFr Overhang
					%	%		27.Unfin Basement
					%	%		28.Unfinished Att
					%	%		29.Finished Attic

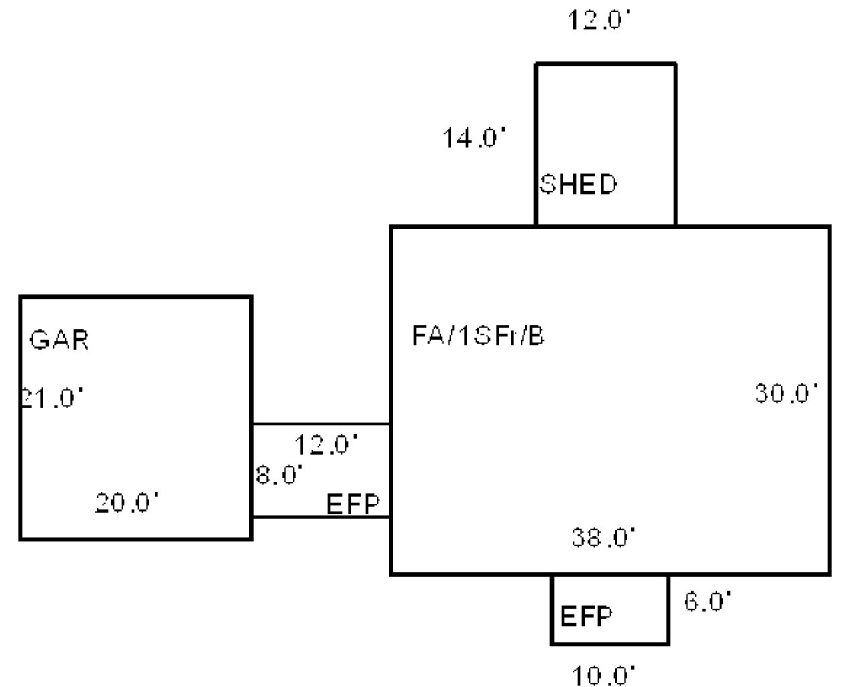

SEWALL, NICHOLAS S  
BATH ME 04530

## Property Data

Neighborhood **200 U.S. RTE 1**

## Assessment Record

Year	Land	Buildings	Exempt	Total
2009	53,240	0	0	53,240
2010	53,200	0	0	53,200
2011	53,200	0	0	53,200
2012	53,200	0	0	53,200
2013	53,200	0	0	53,200
2014	53,200	0	0	53,200
2015	53,200	0	0	53,200
2016	53,200	0	0	53,200
2017	53,200	0	0	53,200
2018	53,200	0	0	53,200
2019	53,200	0	0	53,200
2020	53,200	0	0	53,200
2021	53,200	0	0	53,200
2022	53,200	0	0	53,200

## Land Data

Front Foot	Type	Effective		Influence		Influence Codes
		Frontage	Depth	Factor	Code	
11.Regular Lot				%		1.Open Space
12.Delta Triangle				%		2.Neighborhood A
13.Nabla Triangle				%		3.Topography
14.Rear Land				%		4.Size/Shape
15.Front Foot				%		5.Access
				%		6.Restriction
				%		7.Corner/Locatio
						8.View/Environ
						9.Fract Share
<b>Square Foot</b>		<b>Square Feet</b>				<b>Acres</b>
16.Regular Lot				%		30.Rear 20+
17.Secondary Site				%		31.Waterfront Rea
18.Secondary Site				%		32.Open Space
19.Condominium				%		33.RestrictEsm
20.Base Homesite				%		34.PASTURE 1
				%		35.HORTICULTURAL-
<b>Fract. Acre</b>		<b>Acreege/Sites</b>				36.Pasture 3
21.HS Size Adj	20	1.00	100	%	0	37.Softwood
22.Base Waterfront	21	1.00	100	%	0	38.Mixed Wood
23.Deep WF Size A	28	1.62	100	%	0	39.Hardwood
<b>Acres</b>				%		40.Wasteland
24.Base Waterfront				%		41.CAMP SITE
25.Shallow WF Siz				%		42.Mobile Home Si
26.Base Water Inf				%		43.Condo Site
27.Influence W Si				%		44.Site Improveve
28.Rear Land 1-10						45.CAMP SITE
29.Rear Land 11-2						
		<b>Total Acreage</b>		2.62		

B4063P198 B4234P33 B4234P37

Previous Owner  
SEWALL, NICHOLAS S. & ANN C. SLOCUM  
TRUSTEES OF THE SEWALL FAMILY TRUST  
C/O NICHOLAS SEWALL  
BATH ME 04530  
Sale Date: 12/18/2009

Previous Owner  
SEWALL, NICHOLAS S.  
SLOCUM, ANN C.  
C/O NICHOLAS SEWALL  
BATH ME 04530  
Sale Date: 10/22/2008

Previous Owner  
SEWALL, HELEN  
C/O NICHOLAS SEWALL  
42 FRONT STREET  
BATH ME 04530

Inspection Witnessed By:

X

Date

No./Date	Description	Date Insp.

Notes:

2009-Deed of Distribution putting into Revocable Trust and then deed putting into Sewall Family Trust as Trustees, previous BK3254 PG52.  
2010-Conformatory deed of distribution recorded 12/18/09 BK4234 PG33 and Deed of sale by Trustees recorded 12/18/09 BK4234 PG37 into Nicholas S. Sewall name only.

# WISCASSET

**WISCASSET**

Map Lot U19-003

Account 1810

Location BATH ROAD

Card 1 Of 1 9/19/2022

Building Style			SF Bsmt Living			Layout		
1.Conv.	5.Colonial	9.Other	Fin Bsmt Grade			1.Typical 4. 7.		
2.Ranch	6.Split	10.Double	HEARTH			2.Inadeq 5. 8.		
3.R Ranch	7.Mod/Cont	11.Multi	Heat Type <b>100%</b>			3. 6. 9.		
4.Cape	8.Log	12.Cot.	1.HWBB 5.FWA 9.No Heat			Attic		
Dwelling Units			2.HWCI 6.GravWA 10.			1.1/4 Fin 4.Full Fin 7.		
Other Units			3.H Pump 7.Electric 11.			2.1/2 Fin 5.F/Stair 8.		
Stories			4.Steam 8.F/Wall 12.			3.3/4 Fin 6. 9.None		
1.1	4.1.5	7.	Cool Type <b>0%</b>			Insulation		
2.2	5.1.75	8.	1.Refrig 4.W&C Air 7.			1.Full 4.Minimal 7.		
3.3	6.2.5	9.	2.Evapor 5. 8.			2.Heavy 5.Unknown 8.		
Exterior Walls			3.H Pump 6. 9.None			3.Capped 6. 9.None		
1.CLAP	5.T-111	9.OTHER	Kitchen Style			Unfinished %		
2.WD SH	6.BR/STONE	10.	1.GOOD 4.Obsolete 7.			Grade & Factor		
3.COMP	7.NOV	11.	2.TYPICAL 5. 8.			1.E Grade 4.B Grade 7.AA+ Grad		
4.ASB/ASP	8.AL/VIN	12.	3.OLD TYPE 6. 9.None			2.D Grade 5.A Grade 8.AA++Grad		
Roof Surface			Bath(s) Style			3.C Grade 6.AA Grade 9.Same		
1.Asphalt	4.Composit	7.	1.GOOD 4.Obsolete 7.			SQFT (Footprint)		
2.Slate	5.Wood	8.	2.TYPICAL 5. 8.			Condition		
3.Metal	6.Other	9.	3.Old Type 6. 9.None			1.Poor 4.Avg 7.V G		
SF Masonry Trim			# Rooms			2.Fair 5.Avg+ 8.Exc		
OPEN-3-CUSTOM			# Bedrooms			3.Avg- 6.Good 9.Same		
OPEN-4-CUSTOM			# Full Baths			Phys. % Good		
Year Built			# Half Baths			Funct. % Good		
Year Remodeled			# Addn Fixtures			Functional Code		
Foundation			# Fireplaces			1.Incomp 4.SMALL 7.LAYOUT		
1.Concrete	4.Wood	7.				2.O-Built 5.CDU 8.OTHER		
2.C Block	5.Slab	8.				3.Defmaint 6.STYLE 9.None		
3.Br/Stone	6.Piers	9.				Econ. % Good		
Basement						Economic Code		
1.1/4 Bmt	4.Full Bmt	7.				0.None 3.Services 9.None		
2.1/2 Bmt	5.None	8.				1.Location 4.Traffic 8.		
3.3/4 Bmt	6.	9.None				2.Encroach 8.Other 9.		
Bsmt Gar # Cars						Entrance Code <b>4 Unoccupied</b>		
Wet Basement						1.Interior 4.Vacant 7.		
1.Dry	4.	7.				2.Refusal 5.Estimate 8.		
2.Damp	5.	8.				3.Informed 6. 9.		
3.Wet	6.	9.				Information Code <b>5 Estimate</b>		
Date Inspected						1.Owner 4.Agent 7.		
						2.Relative 5.Estimate 8.		
						3.Tenant 6.Other 9.		
<b>Additions, Outbuildings &amp; Improvements</b>								1.ONE STORY FRAM
Type	Year	Units	Grade	Cond	Phys.	Funct.	Sound Value	2.TWO STORY FRAM
					%	%		3.THREE STORY FR
					%	%		4.1 & 1/2 STORY
					%	%		5.1 & 3/4 STORY
					%	%		6.2 & 1/2 STORY
					%	%		21.Open Frame Por
					%	%		22.Encl Frame Por
					%	%		23.Frame Garage
					%	%		24.Frame Shed
					%	%		25.Frame Bay Wind
					%	%		26.1SFr Overhang
					%	%		27.Unfin Basement
					%	%		28.Unfinished Att
					%	%		29.Finished Attic

Map Lot U19-004-A

Account 2569

Location BATH ROAD

Card 1 Of 1 9/19/2022

CHEWONKI FOUNDATION, INC.  
WISCASSET ME 04578

B4069P238

Inspection Witnessed By:

X

Date

No./Date	Description	Date Insp.

Notes:

2009-Previous Owner: Maine Yankee who retained 5.76 acres and 698.3' frontage. This property now exempt as stated in the deed, non-profit 501 (c) (3) organization.  
2015-Changed exemption/use from Charitable to Literary and Scientific as used that way.

WISCASSET

Property Data

Neighborhood	200 U.S. RTE 1		
Tree Growth Year	0		
FARM LAND YEAR	0		
OPEN SPACE YEAR	0		
Zone/Land Use	21 RURAL		
Secondary Zone	14 S-R		
Topography	1 Level		
1.Level	4.Below St	7.Steep	
2.Rolling	5.Low	8.Rough	
3.Above St	6.Swampy	9.	
Utilities	9 NoWater/NoSewer		
1.Public	4.Dr Well	7.Cesspool	
2.Water	5.DUG/LAKE	8.	
3.Sewer	6.Septic	9.None	
Street	1 Paved		
1.Paved	4.Proposed	7.	
2.Semi Imp	5.Private	8.	
3.Gravel	6.Pub Eas	9.NoStreet	
TREE GROWTH PLAN	0		
CONSERV EASE	0		
Sale Data			
Sale Date			
Price			
Sale Type			
1.Land	4.Mobile	7.	
2.L & B	5.Other	8.	
3.Building	6.	9.	
Financing			
1.Convent	4.Seller	7.	
2.FHA/VA	5.Private	8.	
3.Assumed	6.Cash	9.Unknown	
Validity			
1.Valid	4.Split	7.Renovate	
2.Related	5.Partial	8.Other	
3.Distress	6.Exempt	9.Foreclose	
Verified			
1.Buyer	4.Agent	7.Family	
2.Seller	5.Pub Rec	8.Other	
3.Lender	6.MLS	9.	

Assessment Record

Year	Land	Buildings	Exempt	Total
2009	82,120	0	82,120	0
2010	82,100	0	82,100	0
2011	82,100	0	82,100	0
2012	82,100	0	82,100	0
2013	82,100	0	82,100	0
2014	82,100	0	82,100	0
2015	82,100	0	82,100	0
2016	82,100	0	82,100	0
2017	82,100	0	82,100	0
2018	82,100	0	82,100	0
2019	82,100	0	82,100	0
2020	82,100	0	82,100	0
2021	82,100	0	82,100	0
2022	82,100	0	82,100	0

Land Data

Front Foot	Type	Effective		Influence		Influence Codes
		Frontage	Depth	Factor	Code	
11.Regular Lot				%		1.Open Space
12.Delta Triangle				%		2.Neighborhood A
13.Nabla Triangle				%		3.Topography
14.Rear Land				%		4.Size/Shape
15.Front Foot				%		5.Access
				%		6.Restriction
				%		7.Corner/Locatio
				%		8.View/Environ
				%		9.Fract Share
				%		Acres
				%		30.Rear 20+
				%		31.Waterfront Rea
				%		32.Open Space
				%		33.RestrictEsm
				%		34.PASTURE 1
				%		35.HORTICULTURAL-
				%		36.Pasture 3
				%		37.Softwood
				%		38.Mixed Wood
				%		39.Hardwood
				%		40.Wasteland
				%		41.CAMP SITE
				%		42.Mobile Home Si
				%		43.Condo Site
				%		44.Site Improve
				%		45.CAMP SITE
				%		46.PAVING/00
Total Acreage		25.24				

**WISCASSET**

Map Lot U19-004-A

Account 2569

Location BATH ROAD

Card 1 Of 1 9/19/2022

Building Style			SF Bsmt Living			Layout		
1.Conv.	5.Colonial	9.Other	Fin Bsmt Grade			1.Typical 4. 7.		
2.Ranch	6.Split	10.Double	HEARTH			2.Inadeq 5. 8.		
3.R Ranch	7.Mod/Cont	11.Multi	Heat Type <b>100%</b>			3. 6. 9.		
4.Cape	8.Log	12.Cot.	1.HWBB 5.FWA 9.No Heat			Attic		
Dwelling Units			2.HWCI 6.GravWA 10.			1.1/4 Fin 4.Full Fin 7.		
Other Units			3.H Pump 7.Electric 11.			2.1/2 Fin 5.F/Stair 8.		
Stories			4.Steam 8.F/Wall 12.			3.3/4 Fin 6. 9.None		
1.1	4.1.5	7.	Cool Type <b>0%</b>			Insulation		
2.2	5.1.75	8.	1.Refrig 4.W&C Air 7.			1.Full 4.Minimal 7.		
3.3	6.2.5	9.	2.Evapor 5. 8.			2.Heavy 5.Unknown 8.		
Exterior Walls			3.H Pump 6. 9.None			3.Capped 6. 9.None		
1.CLAP	5.T-111	9.OTHER	Kitchen Style			Unfinished %		
2.WD SH	6.BR/STONE	10.	1.GOOD 4.Obsolete 7.			Grade & Factor		
3.COMP	7.NOV	11.	2.TYPICAL 5. 8.			1.E Grade 4.B Grade 7.AA+ Grad		
4.ASB/ASP	8.AL/VIN	12.	3.OLD TYPE 6. 9.None			2.D Grade 5.A Grade 8.AA++Grad		
Roof Surface			Bath(s) Style			3.C Grade 6.AA Grade 9.Same		
1.Asphalt	4.Composit	7.	1.GOOD 4.Obsolete 7.			SQFT (Footprint)		
2.Slate	5.Wood	8.	2.TYPICAL 5. 8.			Condition		
3.Metal	6.Other	9.	3.Old Type 6. 9.None			1.Poor 4.Avg 7.V G		
SF Masonry Trim			# Rooms			2.Fair 5.Avg+ 8.Exc		
OPEN-3-CUSTOM			# Bedrooms			3.Avg- 6.Good 9.Same		
OPEN-4-CUSTOM			# Full Baths			Phys. % Good		
Year Built			# Half Baths			Funct. % Good		
Year Remodeled			# Addn Fixtures			Functional Code		
Foundation			# Fireplaces			1.Incomp 4.SMALL 7.LAYOUT		
1.Concrete	4.Wood	7.				2.O-Built 5.CDU 8.OTHER		
2.C Block	5.Slab	8.				3.Defmoint 6.STYLE 9.None		
3.Br/Stone	6.Piers	9.				Econ. % Good		
Basement						Economic Code		
1.1/4 Bmt	4.Full Bmt	7.				0.None 3.Services 9.None		
2.1/2 Bmt	5.None	8.				1.Location 4.Traffic 8.		
3.3/4 Bmt	6.	9.None				2.Encroach 8.Other 9.		
Bsmt Gar # Cars						Entrance Code <b>0</b>		
Wet Basement						1.Interior 4.Vacant 7.		
1.Dry	4.	7.				2.Refusal 5.Estimate 8.		
2.Damp	5.	8.				3.Informed 6. 9.		
3.Wet	6.	9.				Information Code <b>0</b>		
						1.Owner 4.Agent 7.		
						2.Relative 5.Estimate 8.		
						3.Tenant 6.Other 9.		
Date Inspected								
<b>Additions, Outbuildings &amp; Improvements</b>								
Type	Year	Units	Grade	Cond	Phys.	Funct.	Sound Value	1.ONE STORY FRAM
					%	%		2.TWO STORY FRAM
					%	%		3.THREE STORY FR
					%	%		4.1 & 1/2 STORY
					%	%		5.1 & 3/4 STORY
					%	%		6.2 & 1/2 STORY
					%	%		21.Open Frame Por
					%	%		22.Encl Frame Por
					%	%		23.Frame Garage
					%	%		24.Frame Shed
					%	%		25.Frame Bay Wind
					%	%		26.1SFr Overhang
					%	%		27.Unfin Basement
					%	%		28.Unfinished Att
					%	%		29.Finished Attic



Map Lot U19-005

Account 1811

Location 139 CHEWONKI NECK ROAD

Card 1 Of 1 9/19/2022

RYAN, MICHAEL R  
WOOLWICH ME 04579

B2480P339

Inspection Witnessed By:

X

Date

No./Date	Description	Date Insp.

Notes:

WISCASSET

### Property Data

Neighborhood <b>109 SOUTHEAST</b>		
Tree Growth Year <b>0</b>		
FARM LAND YEAR <b>0</b>		
OPEN SPACE YEAR <b>0</b>		
Zone/Land Use <b>21 RURAL</b>		
Secondary Zone		
Topography <b>1 Level</b>		
1.Level	4.Below St	7.Steep
2.Rolling	5.Low	8.Rough
3.Above St	6.Swampy	9.
Utilities <b>4 Drilled Well 6 Septic System</b>		
1.Public	4.Dr Well	7.Cesspool
2.Water	5.DUG/LAKE	8.
3.Sewer	6.Septic	9.None
Street <b>1 Paved</b>		
1.Paved	4.Proposed	7.
2.Semi Imp	5.Private	8.
3.Gravel	6.Pub Eas	9.NoStreet
TREE GROWTH PLAN <b>0</b>		
CONSERV EASE <b>0</b>		
<b>Sale Data</b>		
Sale Date		
Price		
Sale Type		
1.Land	4.Mobile	7.
2.L & B	5.Other	8.
3.Building	6.	9.
Financing		
1.Convent	4.Seller	7.
2.FHA/VA	5.Private	8.
3.Assumed	6.Cash	9.Unknown
Validity		
1.Valid	4.Split	7.Renovate
2.Related	5.Partial	8.Other
3.Distress	6.Exempt	9.Foreclose
Verified		
1.Buyer	4.Agent	7.Family
2.Seller	5.Pub Rec	8.Other
3.Lender	6.MLS	9.

### Assessment Record

Year	Land	Buildings	Exempt	Total
2009	142,000	198,110	0	340,110
2010	142,000	198,100	0	340,100
2011	142,000	198,100	0	340,100
2012	142,000	198,100	0	340,100
2013	142,000	198,100	0	340,100
2014	142,000	198,100	0	340,100
2015	142,000	198,100	0	340,100
2016	142,000	198,100	0	340,100
2017	142,000	198,100	0	340,100
2018	142,000	198,100	0	340,100
2019	142,000	198,100	0	340,100
2020	142,000	198,100	0	340,100
2021	142,000	198,100	0	340,100
2022	142,000	198,100	0	340,100

### Land Data

Front Foot	Type	Effective		Influence		Influence Codes
		Frontage	Depth	Factor	Code	
11.Regular Lot				%		1.Open Space
12.Delta Triangle				%		2.Neighborhood A
13.Nabla Triangle				%		3.Topography
14.Rear Land				%		4.Size/Shape
15.Front Foot				%		5.Access
				%		6.Restriction
				%		7.Corner/Locatio
				%		8.View/Environ
				%		9.Fract Share
				%		<b>Acres</b>
				%		30.Rear 20+
				%		31.Waterfront Rea
				%		32.Open Space
				%		33.RestrictEsm
				%		34.PASTURE 1
				%		35.HORTICULTURAL-
				%		36.Pasture 3
				%		37.Softwood
				%		38.Mixed Wood
				%		39.Hardwood
				%		40.Wasteland
				%		41.CAMP SITE
				%		42.Mobile Home Si
				%		43.Condo Site
				%		44.Site Improve
				%		45.CAMP SITE
				%		46.PAVING/00
<b>Total Acreage</b>		17.50				

# WISCASSET

Map Lot U19-005

Account 1811

Location 139 CHEWONKI NECK ROAD

Card 1 Of 1 9/19/2022

Building Style	SF Bsmt Living	Layout
1.Conv. 5.Colonial 9.Other	Fin Bsmt Grade	1.Typical 4. 7.
2.Ranch 6.Split 10.Double	HEARTH	2.Inadeq 5. 8.
3.R Ranch 7.Mod/Cont 11.Multi	Heat Type <b>100%</b>	3. 6. 9.
4.Cape 8.Log 12.Cot.	1.HWBB 5.FWA 9.No Heat	Attic
Dwelling Units	2.HWCI 6.GravWA 10.	1.1/4 Fin 4.Full Fin 7.
Other Units	3.H Pump 7.Electric 11.	2.1/2 Fin 5.F/Stair 8.
Stories	4.Steam 8.F/Wall 12.	3.3/4 Fin 6. 9.None
1.1 4.1.5 7.	Cool Type <b>0%</b>	Insulation
2.2 5.1.75 8.	1.Refrig 4.W&C Air 7.	1.Full 4.Minimal 7.
3.3 6.2.5 9.	2.Evapor 5. 8.	2.Heavy 5.Unknown 8.
Exterior Walls	3.H Pump 6. 9.None	3.Capped 6. 9.None
1.CLAP 5.T-111 9.OTHER	Kitchen Style	Unfinished %
2.WD SH 6.BR/STONE 10.	1.GOOD 4.Obsolete 7.	Grade & Factor
3.COMP 7.NOV 11.	2.TYPICAL 5. 8.	1.E Grade 4.B Grade 7.AA+ Grad
4.ASB/ASP 8.AL/VIN 12.	3.OLD TYPE 6. 9.None	2.D Grade 5.A Grade 8.AA++Grad
Roof Surface	Bath(s) Style	3.C Grade 6.AA Grade 9.Same
1.Asphalt 4.Composit 7.	1.GOOD 4.Obsolete 7.	SQFT (Footprint)
2.Slate 5.Wood 8.	2.TYPICAL 5. 8.	Condition
3.Metal 6.Other 9.	3.Old Type 6. 9.None	1.Poor 4.Avg 7.V G
SF Masonry Trim	# Rooms	2.Fair 5.Avg+ 8.Exc
OPEN-3-CUSTOM	# Bedrooms	3.Avg- 6.Good 9.Same
OPEN-4-CUSTOM	# Full Baths	Phys. % Good
Year Built	# Half Baths	Funct. % Good
Year Remodeled	# Addn Fixtures	Functional Code
Foundation	# Fireplaces	1.Incomp 4.SMALL 7.LAYOUT
1.Concrete 4.Wood 7.		2.O-Built 5.CDU 8.OTHER
2.C Block 5.Slab 8.		3.Defmaint 6.STYLE 9.None
3.Br/Stone 6.Piers 9.		Econ. % Good
Basement		Economic Code
1.1/4 Bmt 4.Full Bmt 7.		0.None 3.Services 9.None
2.1/2 Bmt 5.None 8.		1.Location 4.Traffic 8.
3.3/4 Bmt 6. 9.None		2.Encroach 8.Other 9.
Bsmt Gar # Cars		Entrance Code <b>3 Information Only</b>
Wet Basement		1.Interior 4.Vacant 7.
1.Dry 4. 7.		2.Refusal 5.Estimate 8.
2.Damp 5. 8.		3.Informed 6. 9.
3.Wet 6. 9.		Information Code <b>1 Owner</b>
		1.Owner 4.Agent 7.
		2.Relative 5.Estimate 8.
		3.Tenant 6.Other 9.

Date Inspected 3/20/2007

## Additions, Outbuildings & Improvements

Type	Year	Units	Grade	Cond	Phys.	Funct.	Sound Value	
248 MAN STEEL.....	1950	8343	2 100	3	0 %	100 %		1.ONE STORY FRAM
248 MAN STEEL.....	0	2987	2 100	3	0 %	100 %		2.TWO STORY FRAM
998 14' Mobile	1978	14x66	2 100	3	0 %	50 %		3.THREE STORY FR
1 ONE STORY	0	64	2 100	3	0 %	100 %		4.1 & 1/2 STORY
22 Encl Frame Porch	0	96	2 100	2	0 %	100 %		5.1 & 3/4 STORY
155 1 ST BARN.....	0	800	2 100	3	0 %	100 %		6.2 & 1/2 STORY
24 Frame Shed	0	800	2 100	3	0 %	100 %		21.Open Frame Por
24 Frame Shed	0	800	2 100	3	0 %	100 %		22.Encl Frame Por
					%	%		23.Frame Garage
					%	%		24.Frame Shed
					%	%		25.Frame Bay Wind
					%	%		26.1SFr Overhang
					%	%		27.Unfin Basement
					%	%		28.Unfinished Att
					%	%		29.Finished Attic

SHED 20X40

BARN 20X40

SHED 20X40

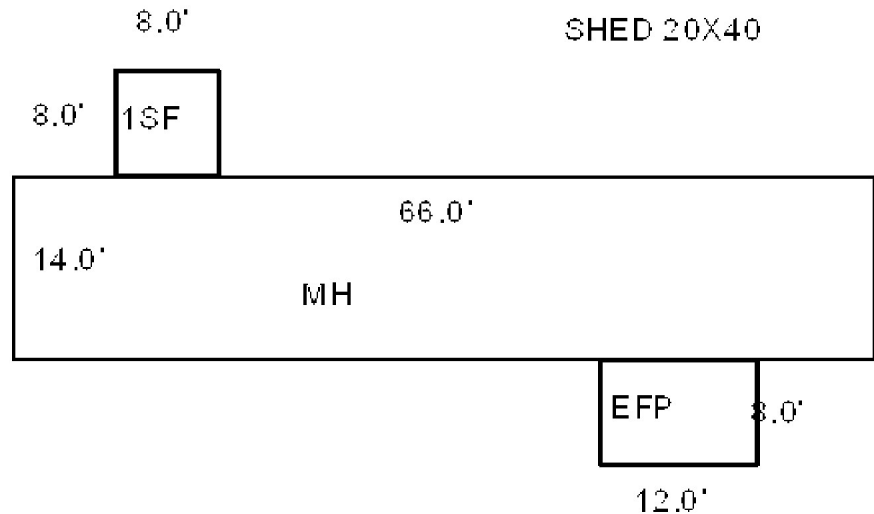

Map Lot		U19-005-A	Account	1812	Location	137 CHEWONKI NECK ROAD		Card	1	Of	1	9/19/2022		
RYAN, MICHAEL R WOOLWICH ME 04579					Property Data		Assessment Record							
					Neighborhood 109 SOUTHEAST		Year	Land	Buildings	Exempt	Total			
					Tree Growth Year 0		2009	47,550	101,230	0	148,780			
					FARM LAND YEAR 0		2010	47,600	101,200	0	148,800			
					OPEN SPACE YEAR 0		2011	47,600	101,200	0	148,800			
B4761P53					Zone/Land Use 21 RURAL		2012	47,600	35,100	0	82,700			
Previous Owner 137 CHEWONKI NECK ROAD, LLC C/O CHRISTOPHER & JACQUELINE CUNHA 21 LINDEN STREET BATH ME 04530 Sale Date: 2/28/2014					Secondary Zone		2013	47,600	35,100	0	82,700			
							2014	47,600	8,500	0	56,100			
					Topography 1 Level		2015	47,600	8,500	0	56,100			
Previous Owner CUNHA JR., CHRISTOPHER V. J/T CUNHA, JACQUELINE M.					1.Level 4.Below St 7.Steep 2.Rolling 5.Low 8.Rough 3.Above St 6.Swampy 9.		2016	47,600	8,500	0	56,100			
							2017	47,600	8,500	0	56,100			
					Utilities 4 Drilled Well 6 Septic System		2018	47,600	8,500	0	56,100			
							2019	47,600	8,500	0	56,100			
					1.Public 4.Dr Well 7.Cesspool 2.Water 5.DUG/LAKE 8. 3.Sewer 6.Septic 9.None		2020	47,600	8,500	0	56,100			
BATH ME 04530 Sale Date: 8/18/2005					Street 1 Paved		2021	47,600	8,500	0	56,100			
							2022	47,600	8,500	0	56,100			
					1.Paved 4.Proposed 7. 2.Semi Imp 5.Private 8. 3.Gravel 6.Pub Eas 9.NoStreet		Land Data							
					TREE GROWTH PLAN 0		Front Foot		Type	Effective		Influence		Influence Codes
					CONSERV EASE 0					Frontage	Depth	Factor	Code	
Sale Data														
Sale Date 2/28/2014		11.Regular Lot						1.Open Space						
Price 11,000		12.Delta Triangle						2.Neighborhood A						
					13.Nabla Triangle						3.Topography			
					14.Rear Land						4.Size/Shape			
					15.Front Foot						5.Access			
											6.Restriction			
											7.Corner/Locatio			
											8.View/Environ			
											9.Fract Share			
											Acres			
											30.Rear 20+			
											31.Waterfront Rea			
											32.Open Space			
											33.RestrictEsm			
											34.PASTURE 1			
											35.HORTICULTURAL-			
											36.Pasture 3			
											37.Softwood			
											38.Mixed Wood			
											39.Hardwood			
											40.Wasteland			
											41.CAMP SITE			
											42.Mobile Home Si			
											43.Condo Site			
											44.Site Improve			
											45.CAMP SITE			
											46.PAVING/00			
											</			

**WISCASSET**

Map Lot U19-005-A

Account 1812

Location 137 CHEWONKI NECK ROAD

Card 1

Of 1

9/19/2022

Building Style	SF Bsmt Living	Layout
1.Conv. 5.Colonial 9.Other	Fin Bsmt Grade	1.Typical 4. 7.
2.Ranch 6.Split 10.Double	HEARTH	2.Inadeq 5. 8.
3.R Ranch 7.Mod/Cont 11.Multi	Heat Type <b>100%</b>	3. 6. 9.
4.Cape 8.Log 12.Cot.	1.HWBB 5.FWA 9.No Heat	Attic
Dwelling Units	2.HWCI 6.GravWA 10.	1.1/4 Fin 4.Full Fin 7.
Other Units	3.H Pump 7.Electric 11.	2.1/2 Fin 5.F/Stair 8.
Stories	4.Steam 8.F/Wall 12.	3.3/4 Fin 6. 9.None
1.1 4.1.5 7.	Cool Type <b>0%</b>	Insulation
2.2 5.1.75 8.	1.Refrig 4.W&C Air 7.	1.Full 4.Minimal 7.
3.3 6.2.5 9.	2.Evapor 5. 8.	2.Heavy 5.Unknown 8.
Exterior Walls	3.H Pump 6. 9.None	3.Capped 6. 9.None
1.CLAP 5.T-111 9.OTHER	Kitchen Style	Unfinished %
2.WD SH 6.BR/STONE 10.	1.GOOD 4.Obsolete 7.	Grade & Factor
3.COMP 7.NOV 11.	2.TYPICAL 5. 8.	1.E Grade 4.B Grade 7.AA+ Grad
4.ASB/ASP 8.AL/VIN 12.	3.OLD TYPE 6. 9.None	2.D Grade 5.A Grade 8.AA++Grad
Roof Surface	Bath(s) Style	3.C Grade 6.AA Grade 9.Same
1.Asphalt 4.Composit 7.	1.GOOD 4.Obsolete 7.	SQFT (Footprint)
2.Slate 5.Wood 8.	2.TYPICAL 5. 8.	Condition
3.Metal 6.Other 9.	3.Old Type 6. 9.None	1.Poor 4.Avg 7.V G
SF Masonry Trim	# Rooms	2.Fair 5.Avg+ 8.Exc
OPEN-3-CUSTOM	# Bedrooms	3.Avg- 6.Good 9.Same
OPEN-4-CUSTOM	# Full Baths	Phys. % Good
Year Built	# Half Baths	Funct. % Good
Year Remodeled	# Addn Fixtures	Functional Code
Foundation	# Fireplaces	1.Incomp 4.SMALL 7.LAYOUT
1.Concrete 4.Wood 7.		2.O-Built 5.CDU 8.OTHER
2.C Block 5.Slab 8.		3.Defmaint 6.STYLE 9.None
3.Br/Stone 6.Piers 9.		Econ. % Good
Basement		Economic Code
1.1/4 Bmt 4.Full Bmt 7.		0.None 3.Services 9.None
2.1/2 Bmt 5.None 8.		1.Location 4.Traffic 8.
3.3/4 Bmt 6. 9.None		2.Encroach 8.Other 9.
Bsmt Gar # Cars		Entrance Code <b>5 Estimated</b>
Wet Basement		1.Interior 4.Vacant 7.
1.Dry 4. 7.		2.Refusal 5.Estimate 8.
2.Damp 5. 8.		3.Informed 6. 9.
3.Wet 6. 9.		Information Code <b>5 Estimate</b>
		1.Owner 4.Agent 7.
		2.Relative 5.Estimate 8.
		3.Tenant 6.Other 9.

Date Inspected 3/20/2007

**Additions, Outbuildings & Improvements**

Type	Year	Units	Grade	Cond	Phys.	Funct.	Sound Value	
103 SLAB.....	2012	4848	2 100	3	0 %	100 %		1.ONE STORY FRAM
					%	%		2.TWO STORY FRAM
					%	%		3.THREE STORY FR
					%	%		4.1 & 1/2 STORY
					%	%		5.1 & 3/4 STORY
					%	%		6.2 & 1/2 STORY
					%	%		21.Open Frame Por
					%	%		22.Encl Frame Por
					%	%		23.Frame Garage
					%	%		24.Frame Shed
					%	%		25.Frame Bay Wind
					%	%		26.1SFr Overhang
					%	%		27.Unfin Basement
					%	%		28.Unfinished Att
					%	%		29.Finished Attic

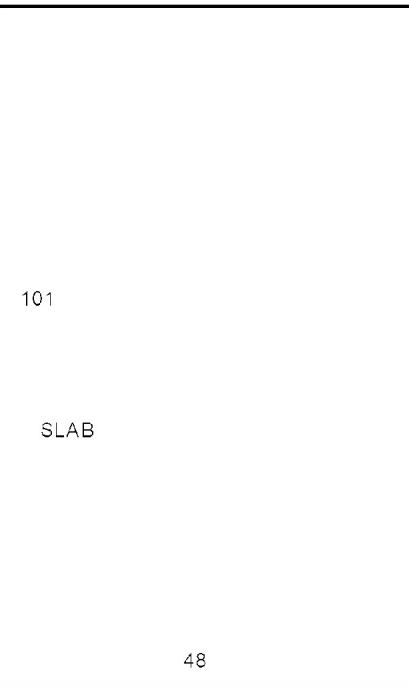

Map Lot U19-006

Account 1813

Location 34 SHADY LANE

Card 1 Of 1 9/19/2022

LORENTSEN, PHILIP  
WISCASSET ME 04578

B1089P78

Inspection Witnessed By:

X

Date

No./Date	Description	Date Insp.

Notes:

WISCASSET

Property Data			Assessment Record						
Neighborhood <b>109 SOUTHEAST</b>  Tree Growth Year <b>0</b> FARM LAND YEAR <b>0</b> OPEN SPACE YEAR <b>0</b>  Zone/Land Use <b>21 RURAL</b>  Secondary Zone			Year	Land	Buildings	Exempt	Total		
			2009	34,850	71,370	19,000	87,220		
			2010	34,800	71,400	16,000	90,200		
			2011	34,800	71,400	16,000	90,200		
Topography <b>2 Rolling</b> <b>3 Above Street</b>			2012	34,800	71,400	16,000	90,200		
			2013	34,800	71,400	16,000	90,200		
			2014	34,800	71,400	16,000	90,200		
1.Level                4.Below St                7.Steep 2.Rolling                5.Low                8.Rough 3.Above St                6.Swampy                9.			2015	34,800	71,400	16,000	90,200		
			2016	34,800	71,400	21,000	85,200		
			2017	34,800	71,400	26,000	80,200		
Utilities <b>4 Drilled Well</b> <b>6 Septic System</b>  1.Public                4.Dr Well                7.Cesspool 2.Water                5.DUG/LAKE                8. 3.Sewer                6.Septic                9.None			2018	34,800	71,400	26,000	80,200		
			2019	34,800	71,400	26,000	80,200		
			2020	34,800	71,400	31,000	75,200		
Street <b>1 Paved</b>  1.Paved                4.Proposed                7. 2.Semi Imp                5.Private                8. 3.Gravel                6.Pub Eas                9.NoStreet			2021	34,800	71,400	31,000	75,200		
			2022	34,800	71,400	29,760	76,440		
			Land Data						
TREE GROWTH PLAN <b>0</b> CONSERV EASE <b>0</b>  <b>Sale Data</b>  Sale Date  Price  Sale Type 1.Land                4.Mobile                7. 2.L & B                5.Other                8. 3.Building                6.                9.  Financing 1.Convent                4.Seller                7. 2.FHA/VA                5.Private                8. 3.Assumed                6.Cash                9.Unknown  Validity 1.Valid                4.Split                7.Renovate 2.Related                5.Partial                8.Other 3.Distress                6.Exempt                9.Foreclose  Verified 1.Buyer                4.Agent                7.Family 2.Seller                5.Pub Rec                8.Other 3.Lender                6.MLS                9.			Front Foot  11.Regular Lot 12.Delta Triangle 13.Nabla Triangle 14.Rear Land 15.Front Foot  <b>Square Foot</b>  16.Regular Lot 17.Secondary Site 18.Secondary Site 19.Condominium 20.Base Homesite  <b>Fract. Acre</b>  21.HS Size Adj 22.Base Waterfron 23.Deep WF Size A <b>Acres</b>  24.Base Waterfron 25.Shallow WF Siz 26.Base Water Inf 27.Influence W Si 28.Rear Land 1-10 29.Rear Land 11-2	Type	Effective		Influence		Influence Codes  1.Open Space 2.Neighborhood A 3.Topography 4.Size/Shape 5.Access 6.Restriction 7.Corner/Locatio 8.View/Environ 9.Fract Share <b>Acres</b> 30.Rear 20+ 31.Waterfront Rea 32.Open Space 33.RestrictEsm 34.PASTURE 1 35.HORTICULTURAL- 36.Pasture 3 37.Softwood 38.Mixed Wood 39.Hardwood 40.Wasteland 41.CAMP SITE 42.Mobile Home Si 43.Condo Site 44.Site Improve 45.CAMP SITE
					Frontage	Depth	Factor	Code	
								%	
								%	
								%	
								%	
								%	
								%	
								%	
								%	
				%					
				%					
				%					
				%					
				%					
				%					
				%					
				%					
				%					
				%					
				%					
				%					
				%					
				%					
				%					
				%					
				%					
				%					
				%					
				%					
				%					
				%					
				%					
				%					
				%					
				%					
				%					
				%					
				%					
				%					
				%					
				%					
				%					
				%					
				%					
				%					
				%					
				%					
				%					
				%					
				%					
				%					
				%					
				%					
				%					
				%					
				%					
				%					
				%					
				%					
				%					
				%					
				%					
				%					
				%					
				%					
				%					



# WISCASSET

Map Lot U19-006

Account 1813

Location 34 SHADY LANE

Card 1 Of 1 9/19/2022

Building Style <b>2 Ranch</b>			SF Bsmt Living <b>0</b>			Layout <b>1 Typical</b>		
1.Conv.	5.Colonial	9.Other	Fin Bsmt Grade <b>0 0</b>			1.Typical 4. 7.		
2.Ranch	6.Split	10.Double	HEARTH <b>0</b>			2.Inadeq 5. 8.		
3.R Ranch	7.Mod/Cont	11.Multi	Heat Type <b>100% 1 Hot Water BB</b>			3. 6. 9.		
4.Cape	8.Log	12.Cot.	1.HWBB	5.FWA	9.No Heat	Attic <b>9 None</b>		
Dwelling Units <b>1</b>			2.HWCI	6.GravWA	10.	1.1/4 Fin 4.Full Fin 7.		
Other Units <b>0</b>			3.H Pump	7.Electric	11.	2.1/2 Fin 5.F/Stair 8.		
Stories <b>1 One Story</b>			4.Steam	8.F/Wall	12.	3.3/4 Fin 6. 9.None		
1.1	4.1.5	7.	Cool Type <b>0% 9 None</b>			Insulation <b>1 Full</b>		
2.2	5.1.75	8.	1.Refrig	4.W&C Air	7.	1.Full 4.Minimal 7.		
3.3	6.2.5	9.	2.Evapor	5.	8.	2.Heavy 5.Unknown 8.		
Exterior Walls <b>3 COMPOSITION</b>			3.H Pump	6.	9.None	3.Capped 6. 9.None		
1.CLAP	5.T-111	9.OTHER	Kitchen Style <b>2 TYPICAL</b>			Unfinished % <b>0%</b>		
2.WD SH	6.BR/STONE	10.	1.GOOD	4.Obsolete	7.	Grade & Factor <b>3 Average 100%</b>		
3.COMP	7.NOV	11.	2.TYPICAL	5.	8.	1.E Grade 4.B Grade 7.AA+ Grad		
4.ASB/ASP	8.AL/VIN	12.	3.OLD TYPE	6.	9.None	2.D Grade 5.A Grade 8.AA++Grad		
Roof Surface <b>1 Asphalt Shingles</b>			Bath(s) Style <b>2 TYPICAL</b>			3.C Grade 6.AA Grade 9.Same		
1.Asphalt	4.Composit	7.	1.GOOD	4.Obsolete	7.	SQFT (Footprint) <b>960</b>		
2.Slate	5.Wood	8.	2.TYPICAL	5.	8.	Condition <b>3 Below Average</b>		
3.Metal	6.Other	9.	3.Old Type	6.	9.None	1.Poor 4.Avg 7.V G		
SF Masonry Trim <b>0</b>			# Rooms <b>5</b>			2.Fair 5.Avg+ 8.Exc		
OPEN-3-CUSTOM <b>0</b>			# Bedrooms <b>3</b>			3.Avg- 6.Good 9.Same		
OPEN-4-CUSTOM <b>0</b>			# Full Baths <b>1</b>			Phys. % Good <b>0%</b>		
Year Built <b>1975</b>			# Half Baths <b>0</b>			Funct. % Good <b>100%</b>		
Year Remodeled <b>0</b>			# Addn Fixtures <b>0</b>			Functional Code <b>9 None</b>		
Foundation <b>1 Concrete</b>			# Fireplaces <b>0</b>			1.Incomp 4.SMALL 7.LAYOUT		
1.Concrete	4.Wood	7.	<div><p><b>TRIO</b> Software A Division of Harris Computer Systems</p></div>					
2.C Block	5.Slab	8.						
3.Br/Stone	6.Piers	9.						
Basement <b>4 Full Basement</b>								
1.1/4 Bmt	4.Full Bmt	7.						
2.1/2 Bmt	5.None	8.						
3.3/4 Bmt	6.	9.None						
Bsmt Gar # Cars <b>0</b>								
Wet Basement <b>1 Dry Basement</b>								
1.Dry	4.	7.						
2.Damp	5.	8.						
3.Wet	6.	9.						
			Econ. % Good <b>100%</b>					
			Economic Code <b>None</b>					
			0.None 3.Services 9.None					
			1.Location 4.Traffic 8.					
			2.Encroach 8.Other 9.					
			Entrance Code <b>1 Interior Inspect</b>					
			1.Interior 4.Vacant 7.					
			2.Refusal 5.Estimate 8.					
			3.Informed 6. 9.					
			Information Code <b>1 Owner</b>					

Date Inspected 3/15/2007

Additions, Outbuildings & Improvements								1.ONE STORY FRAM
Type	Year	Units	Grade	Cond	Phys.	Funct.	Sound Value	2.TWO STORY FRAM
23 Frame Garage	0	384	0 0	0	0 %	0 %		3.THREE STORY FR
					%	%		4.1 & 1/2 STORY
					%	%		5.1 & 3/4 STORY
					%	%		6.2 & 1/2 STORY
					%	%		21.Open Frame Por
					%	%		22.Encl Frame Por
					%	%		23.Frame Garage
					%	%		24.Frame Shed
					%	%		25.Frame Bay Wind
					%	%		26.1SFr Overhang
					%	%		27.Unfin Basement
					%	%		28.Unfinished Att
					%	%		29.Finished Attic

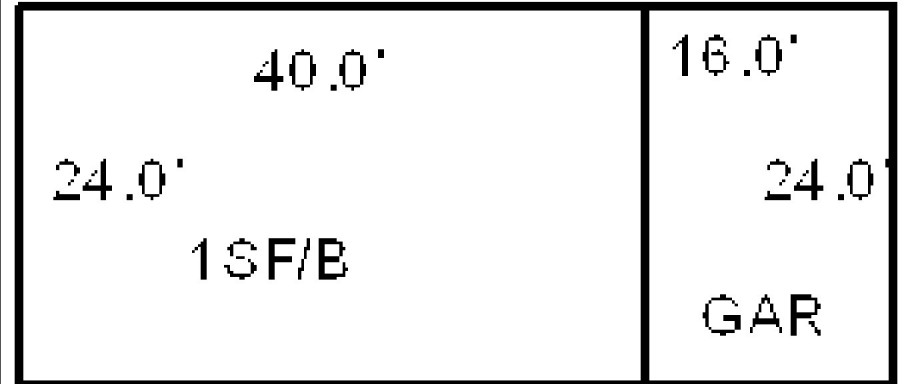

Map Lot U19-007

Account 1814

Location 38 SHADY LANE

Card 1 Of 1 9/19/2022

EGGEN, KENDRA F  
38 SHADY LANE  
WISCASSET ME 04578

B5717P251

Previous Owner  
MCINTIRE, KAREN E  
38 SHADY LANE

WISCASSET ME 04578  
Sale Date: 5/26/2021

Previous Owner  
PREBLE, LAURA A  
38 SHADY LANE

WISCASSET ME 04578  
Sale Date: 7/10/2020

Previous Owner  
MCINTIRE, KAREN E  
1341 POST ROAD

BOWDOINHAM ME 04008  
Sale Date: 7/06/2018

Inspection Witnessed By:

X

Date

No./Date	Description	Date Insp.

Notes:

'17 W/ Friend outdoors add wds.

2005-CHANGED ACREAGE FROM .48 TO .52 PER PLANNING BOARD PLAN

2010-Mr. Bancroft died 05/12/2007 leaving property to brother. Brother sold to Acquarius Property Management 10/26/09.

2012-Release deed recorded BK4479 PG295.

**WISCASSET****Property Data**Neighborhood **109 SOUTHEAST**Tree Growth Year **0**FARM LAND YEAR **0**OPEN SPACE YEAR **0**Zone/Land Use **21 RURAL**

Secondary Zone

Topography **2 Rolling 3 Above Street**

1.Level 4.Below St 7.Steep  
2.Rolling 5.Low 8.Rough  
3.Above St 6.Swampy 9.

Utilities **4 Drilled Well 6 Septic System**

1.Public 4.Dr Well 7.Cesspool  
2.Water 5.DUG/LAKE 8.  
3.Sewer 6.Septic 9.None

Street **1 Paved**

1.Paved 4.Proposed 7.  
2.Semi Imp 5.Private 8.  
3.Gravel 6.Pub Eas 9.NoStreet

TREE GROWTH PLAN **0**CONSERV EASE **0****Sale Data**Sale Date **5/26/2021**Price **240,000**Sale Type **2 Land & Buildings**

1.Land 4.Mobile 7.  
2.L & B 5.Other 8.  
3.Building 6. 9.

Financing **9 Unknown**

1.Convent 4.Seller 7.  
2.FHA/VA 5.Private 8.  
3.Assumed 6.Cash 9.Unknown

Validity **1 Arms Length Sale**

1.Valid 4.Split 7.Renovate  
2.Related 5.Partial 8.Other  
3.Distress 6.Exempt 9.Foreclose

Verified **5 Public Record**

1.Buyer 4.Agent 7.Family  
2.Seller 5.Pub Rec 8.Other  
3.Lender 6.MLS 9.

**Assessment Record**

Year	Land	Buildings	Exempt	Total
2009	34,720	77,750	0	112,470
2010	34,700	77,800	0	112,500
2011	34,700	77,800	0	112,500
2012	34,700	77,800	0	112,500
2013	34,700	77,800	0	112,500
2014	34,700	77,800	0	112,500
2015	34,700	77,800	0	112,500
2016	34,700	77,800	0	112,500
2017	34,700	80,200	0	114,900
2018	34,700	80,200	6,000	108,900
2019	34,700	80,200	0	114,900
2020	34,700	80,200	0	114,900
2021	34,700	80,200	31,000	83,900
2022	34,700	80,200	0	114,900

**Land Data**

Front Foot	Type	Effective		Influence		Influence Codes
		Frontage	Depth	Factor	Code	
11.Regular Lot				%		1.Open Space
12.Delta Triangle				%		2.Neighborhood A
13.Nabla Triangle				%		3.Topography
14.Rear Land				%		4.Size/Shape
15.Front Foot				%		5.Access
				%		6.Restriction
				%		7.Corner/Locatio
				%		8.View/Environ
				%		9.Fract Share
				%		<b>Acres</b>
				%		30.Rear 20+
				%		31.Waterfront Rea
				%		32.Open Space
				%		33.RestrictEsm
				%		34.PASTURE 1
				%		35.HORTICULTURAL-
				%		36.Pasture 3
				%		37.Softwood
				%		38.Mixed Wood
				%		39.Hardwood
				%		40.Wasteland
				%		41.CAMP SITE
				%		42.Mobile Home Si
				%		43.Condo Site
				%		44.Site Improve
				%		45.CAMP SITE
				%		46.PAVING/00
		<b>Total Acreage</b>		0.52		

**Front Foot**

11.Regular Lot  
12.Delta Triangle  
13.Nabla Triangle  
14.Rear Land  
15.Front Foot

**Square Foot**

16.Regular Lot  
17.Secondary Site  
18.Secondary Site  
19.Condominium  
20.Base Homesite

**Fract. Acre**

21.HS Size Adj  
22.Base Waterfron  
23.Deep WF Size A

**Acres**

24.Base Waterfron  
25.Shallow WF Siz  
26.Base Water Inf  
27.Influence W Si  
28.Rear Land 1-10  
29.Rear Land 11-2

**Type**

11.Regular Lot  
12.Delta Triangle  
13.Nabla Triangle  
14.Rear Land  
15.Front Foot

**Square Feet**

16.Regular Lot  
17.Secondary Site  
18.Secondary Site  
19.Condominium  
20.Base Homesite

**Fract. Acre**

21.HS Size Adj  
22.Base Waterfron  
23.Deep WF Size A

**Acres**

24.Base Waterfron  
25.Shallow WF Siz  
26.Base Water Inf  
27.Influence W Si  
28.Rear Land 1-10  
29.Rear Land 11-2

**Effective**

11.Regular Lot  
12.Delta Triangle  
13.Nabla Triangle  
14.Rear Land  
15.Front Foot

**Square Feet**

16.Regular Lot  
17.Secondary Site  
18.Secondary Site  
19.Condominium  
20.Base Homesite

**Fract. Acre**

21.HS Size Adj  
22.Base Waterfron  
23.Deep WF Size A

**Acres**

24.Base Waterfron  
25.Shallow WF Siz  
26.Base Water Inf  
27.Influence W Si  
28.Rear Land 1-10  
29.Rear Land 11-2

**Influence**

11.Regular Lot  
12.Delta Triangle  
13.Nabla Triangle  
14.Rear Land  
15.Front Foot

**Square Feet**

16.Regular Lot  
17.Secondary Site  
18.Secondary Site  
19.Condominium  
20.Base Homesite

**Fract. Acre**

21.HS Size Adj  
22.Base Waterfron  
23.Deep WF Size A

**Acres**

24.Base Waterfron  
25.Shallow WF Siz  
26.Base Water Inf  
27.Influence W Si  
28.Rear Land 1-10  
29.Rear Land 11-2

**Influence Codes**

1.Open Space  
2.Neighborhood A  
3.Topography  
4.Size/Shape  
5.Access  
6.Restriction  
7.Corner/Locatio  
8.View/Environ  
9.Fract Share  
**Acres**  
30.Rear 20+  
31.Waterfront Rea  
32.Open Space  
33.RestrictEsm  
34.PASTURE 1  
35.HORTICULTURAL-  
36.Pasture 3  
37.Softwood  
38.Mixed Wood  
39.Hardwood  
40.Wasteland  
41.CAMP SITE  
42.Mobile Home Si  
43.Condo Site  
44.Site Improve  
45.CAMP SITE  
46.PAVING/00

# WISCASSET

Map Lot U19-007

Account 1814

Location 38 SHADY LANE

Card 1

Of 1

9/19/2022

Building Style <b>2 Ranch</b>	SF Bsmt Living <b>0</b>	Layout <b>1 Typical</b>
1.Conv. 5.Colonial 9.Other	Fin Bsmt Grade <b>0 0</b>	1.Typical 4. 7.
2.Ranch 6.Split 10.Double	HEARTH <b>0</b>	2.Inadeq 5. 8.
3.R Ranch 7.Mod/Cont 11.Multi	Heat Type <b>100% 1 Hot Water BB</b>	3. 6. 9.
4.Cape 8.Log 12.Cot.	1.HWBB 5.FWA 9.No Heat	Attic <b>9 None</b>
Dwelling Units <b>1</b>	2.HWCI 6.GravWA 10.	1.1/4 Fin 4.Full Fin 7.
Other Units <b>0</b>	3.H Pump 7.Electric 11.	2.1/2 Fin 5.F/Stair 8.
Stories <b>1 One Story</b>	4.Steam 8.F/Wall 12.	3.3/4 Fin 6. 9.None
1.1 4.1.5 7.	Cool Type <b>0% 9 None</b>	Insulation <b>1 Full</b>
2.2 5.1.75 8.	1.Refrig 4.W&C Air 7.	1.Full 4.Minimal 7.
3.3 6.2.5 9.	2.Evapor 5. 8.	2.Heavy 5.Unknown 8.
Exterior Walls <b>8 ALUM/VINYL</b>	3.H Pump 6. 9.None	3.Capped 6. 9.None
1.CLAP 5.T-111 9.OTHER	Kitchen Style <b>2 TYPICAL</b>	Unfinished % <b>0%</b>
2.WD SH 6.BR/STONE 10.	1.GOOD 4.Obsolete 7.	Grade & Factor <b>3 Average 100%</b>
3.COMP 7.NOV 11.	2.TYPICAL 5. 8.	1.E Grade 4.B Grade 7.AA+ Grad
4.ASB/ASP 8.AL/VIN 12.	3.OLD TYPE 6. 9.None	2.D Grade 5.A Grade 8.AA++Grad
Roof Surface <b>1 Asphalt Shingles</b>	Bath(s) Style <b>2 TYPICAL</b>	3.C Grade 6.AA Grade 9.Same
1.Asphalt 4.Composit 7.	1.GOOD 4.Obsolete 7.	SQFT (Footprint) <b>960</b>
2.Slate 5.Wood 8.	2.TYPICAL 5. 8.	Condition <b>3 Below Average</b>
3.Metal 6.Other 9.	3.Old Type 6. 9.None	1.Poor 4.Avg 7.V G
SF Masonry Trim <b>0</b>	# Rooms <b>5</b>	2.Fair 5.Avg+ 8.Exc
OPEN-3-CUSTOM <b>0</b>	# Bedrooms <b>3</b>	3.Avg- 6.Good 9.Same
OPEN-4-CUSTOM <b>0</b>	# Full Baths <b>1</b>	Phys. % Good <b>0%</b>
Year Built <b>1975</b>	# Half Baths <b>0</b>	Funct. % Good <b>100%</b>
Year Remodeled <b>0</b>	# Addn Fixtures <b>0</b>	Functional Code <b>9 None</b>
Foundation <b>1 Concrete</b>	# Fireplaces <b>0</b>	1.Incomp 4.SMALL 7.LAYOUT
1.Concrete 4.Wood 7.		2.O-Built 5.CDU 8.OTHER
2.C Block 5.Slab 8.		3.Defmaint 6.STYLE 9.None
3.Br/Stone 6.Piers 9.		Econ. % Good <b>100%</b>
Basement <b>4 Full Basement</b>		Economic Code <b>None</b>
1.1/4 Bmt 4.Full Bmt 7.		0.None 3.Services 9.None
2.1/2 Bmt 5.None 8.		1.Location 4.Traffic 8.
3.3/4 Bmt 6. 9.None		2.Encroach 8.Other 9.
Bsmt Gar # Cars <b>0</b>		Entrance Code <b>1 Interior Inspect</b>
Wet Basement <b>2 Damp Basement</b>		1.Interior 4.Vacant 7.
1.Dry 4. 7.		2.Refusal 5.Estimate 8.
2.Damp 5. 8.		3.Informed 6. 9.
3.Wet 6. 9.		Information Code <b>1 Owner</b>
		1.Owner 4.Agent 7.
		2.Relative 5.Estimate 8.
		3.Tenant 6.Other 9.

Date Inspected 3/15/2007

## Additions, Outbuildings & Improvements

Type	Year	Units	Grade	Cond	Phys.	Funct.	Sound Value	
22 Encl Frame Porch	2002	182	2 100	3	0 %	100 %		1.ONE STORY FRAM
68 Wood Deck	0	64	3 100	4	0 %	100 %		2.TWO STORY FRAM
23 Frame Garage	2002	336	3 100	4	0 %	100 %		3.THREE STORY FR
68 Wood Deck	2016	120	3 100	4	0 %	100 %		4.1 & 1/2 STORY
68 Wood Deck	2016	113	3 100	4	0 %	100 %		5.1 & 3/4 STORY
					%	%		6.2 & 1/2 STORY
					%	%		21.Open Frame Por
					%	%		22.Encl Frame Por
					%	%		23.Frame Garage
					%	%		24.Frame Shed
					%	%		25.Frame Bay Wind
					%	%		26.1SFr Overhang
					%	%		27.Unfin Basement
					%	%		28.Unfinished Att
					%	%		29.Finished Attic





Map Lot U19-008

Account 1815

Location 41 SHADY LANE

Card 1 Of 1 9/19/2022

SHAW, MARITES  
SHAW, RICHARD M  
41 SHADY LANE  
WISCASSET ME 04578

B5797P1

Previous Owner  
GOWER, JOAN R

41 SHADY LANE  
WISCASSET ME 04578  
Sale Date: 10/19/2021

Inspection Witnessed By:

X

Date

No./Date	Description	Date Insp.

Notes:

2006-PER PLANIMETER CHECK CHANGED ACREAGE FROM 3.00 ACRES TO 4.6 ACRES WITH 539' FRONTAGE.  
2009-Sold 1.47 acres to daughter who built a new house added on portion of this property. Land retained = 3.13 with 360.88' frontage.

WISCASSET

## Property Data

Neighborhood	109 SOUTHEAST		
Tree Growth Year	0		
FARM LAND YEAR	0		
OPEN SPACE YEAR	0		
Zone/Land Use	21 RURAL		
Secondary Zone			
Topography	1 Level		
1.Level	4.Below St	7.Steep	
2.Rolling	5.Low	8.Rough	
3.Above St	6.Swampy	9.	
Utilities	1 All Public		
1.Public	4.Dr Well	7.Cesspool	
2.Water	5.DUG/LAKE	8.	
3.Sewer	6.Septic	9.None	
Street	1 Paved		
1.Paved	4.Proposed	7.	
2.Semi Imp	5.Private	8.	
3.Gravel	6.Pub Eas	9.NoStreet	
TREE GROWTH PLAN	0		
CONSERV EASE	0		
Sale Data			
Sale Date	10/19/2021		
Price	150,000		
Sale Type	2 Land & Buildings		
1.Land	4.Mobile	7.	
2.L & B	5.Other	8.	
3.Building	6.	9.	
Financing	9 Unknown		
1.Convent	4.Seller	7.	
2.FHA/VA	5.Private	8.	
3.Assumed	6.Cash	9.Unknown	
Validity	1 Arms Length Sale		
1.Valid	4.Split	7.Renovate	
2.Related	5.Partial	8.Other	
3.Distress	6.Exempt	9.Foreclose	
Verified	5 Public Record		
1.Buyer	4.Agent	7.Family	
2.Seller	5.Pub Rec	8.Other	
3.Lender	6.MLS	9.	

## Assessment Record

Year	Land	Buildings	Exempt	Total
2009	113,990	106,380	19,000	201,370
2010	114,000	106,400	16,000	204,400
2011	114,000	106,400	16,000	204,400
2012	114,000	106,400	16,000	204,400
2013	114,000	106,400	16,000	204,400
2014	114,000	106,400	16,000	204,400
2015	114,000	106,400	16,000	204,400
2016	114,000	106,400	21,000	199,400
2017	114,000	106,400	26,000	194,400
2018	114,000	106,400	26,000	194,400
2019	114,000	106,400	26,000	194,400
2020	114,000	106,400	31,000	189,400
2021	114,000	106,400	31,000	189,400
2022	114,000	106,400	0	220,400

## Land Data

Front Foot	Type	Effective		Influence		Influence Codes
		Frontage	Depth	Factor	Code	
11.Regular Lot				%		1.Open Space
12.Delta Triangle				%		2.Neighborhood A
13.Nabla Triangle				%		3.Topography
14.Rear Land				%		4.Size/Shape
15.Front Foot				%		5.Access
				%		6.Restriction
				%		7.Corner/Locatio
				%		8.View/Environ
				%		9.Fract Share
				%		Acres
				%		30.Rear 20+
				%		31.Waterfront Rea
				%		32.Open Space
				%		33.RestrictEsm
				%		34.PASTURE 1
				%		35.HORTICULTURAL-
				%		36.Pasture 3
				%		37.Softwood
				%		38.Mixed Wood
				%		39.Hardwood
				%		40.Wasteland
				%		41.CAMP SITE
				%		42.Mobile Home Si
				%		43.Condo Site
				%		44.Site Improve
				%		45.CAMP SITE
				%		46.PAVING/00
Total Acreage		3.13				

## Front Foot

11.Regular Lot  
12.Delta Triangle  
13.Nabla Triangle  
14.Rear Land  
15.Front Foot

## Square Foot

16.Regular Lot  
17.Secondary Site  
18.Secondary Site  
19.Condominium  
20.Base Homesite

## Fract. Acre

21.HS Size Adj  
22.Base Waterfron  
23.Deep WF Size A

## Acres

24.Base Waterfron  
25.Shallow WF Siz  
26.Base Water Inf  
27.Influence W Si  
28.Rear Land 1-10  
29.Rear Land 11-2

## Type

11.Regular Lot  
12.Delta Triangle  
13.Nabla Triangle  
14.Rear Land  
15.Front Foot

## Square Feet

16.Regular Lot  
17.Secondary Site  
18.Secondary Site  
19.Condominium  
20.Base Homesite

## Fract. Acre

21.HS Size Adj  
22.Base Waterfron  
23.Deep WF Size A

## Acres

24.Base Waterfron  
25.Shallow WF Siz  
26.Base Water Inf  
27.Influence W Si  
28.Rear Land 1-10  
29.Rear Land 11-2

## Effective

11.Regular Lot  
12.Delta Triangle  
13.Nabla Triangle  
14.Rear Land  
15.Front Foot

## Square Feet

16.Regular Lot  
17.Secondary Site  
18.Secondary Site  
19.Condominium  
20.Base Homesite

## Fract. Acre

21.HS Size Adj  
22.Base Waterfron  
23.Deep WF Size A

## Acres

24.Base Waterfron  
25.Shallow WF Siz  
26.Base Water Inf  
27.Influence W Si  
28.Rear Land 1-10  
29.Rear Land 11-2

## Influence

11.Regular Lot  
12.Delta Triangle  
13.Nabla Triangle  
14.Rear Land  
15.Front Foot

## Square Feet

16.Regular Lot  
17.Secondary Site  
18.Secondary Site  
19.Condominium  
20.Base Homesite

## Fract. Acre

21.HS Size Adj  
22.Base Waterfron  
23.Deep WF Size A

## Acres

24.Base Waterfron  
25.Shallow WF Siz  
26.Base Water Inf  
27.Influence W Si  
28.Rear Land 1-10  
29.Rear Land 11-2

## Influence Codes

1.Open Space  
2.Neighborhood A  
3.Topography  
4.Size/Shape  
5.Access  
6.Restriction  
7.Corner/Locatio  
8.View/Environ  
9.Fract Share  
Acres  
30.Rear 20+  
31.Waterfront Rea  
32.Open Space  
33.RestrictEsm  
34.PASTURE 1  
35.HORTICULTURAL-  
36.Pasture 3  
37.Softwood  
38.Mixed Wood  
39.Hardwood  
40.Wasteland  
41.CAMP SITE  
42.Mobile Home Si  
43.Condo Site  
44.Site Improve  
45.CAMP SITE  
46.PAVING/00

# WISCASSET

Map Lot U19-008

Account 1815

Location 41 SHADY LANE

Card 1

Of 1

9/19/2022

Building Style <b>2 Ranch</b>	SF Bsmt Living <b>0</b>	Layout <b>1 Typical</b>
1.Conv. 5.Colonial 9.Other	Fin Bsmt Grade <b>0 0</b>	1.Typical 4. 7.
2.Ranch 6.Split 10.Double	HEARTH <b>0</b>	2.Inadeq 5. 8.
3.R Ranch 7.Mod/Cont 11.Multi	Heat Type <b>100% 1 Hot Water BB</b>	3. 6. 9.
4.Cape 8.Log 12.Cot.	1.HWBB 5.FWA 9.No Heat	Attic <b>9 None</b>
Dwelling Units <b>1</b>	2.HWCI 6.GravWA 10.	1.1/4 Fin 4.Full Fin 7.
Other Units <b>0</b>	3.H Pump 7.Electric 11.	2.1/2 Fin 5.F/Stair 8.
Stories <b>1 One Story</b>	4.Steam 8.F/Wall 12.	3.3/4 Fin 6. 9.None
1.1 4.1.5 7.	Cool Type <b>0% 9 None</b>	Insulation <b>1 Full</b>
2.2 5.1.75 8.	1.Refrig 4.W&C Air 7.	1.Full 4.Minimal 7.
3.3 6.2.5 9.	2.Evapor 5. 8.	2.Heavy 5.Unknown 8.
Exterior Walls <b>8 ALUM/VINYL</b>	3.H Pump 6. 9.None	3.Capped 6. 9.None
1.CLAP 5.T-111 9.OTHER	Kitchen Style <b>2 TYPICAL</b>	Unfinished % <b>0%</b>
2.WD SH 6.BR/STONE 10.	1.GOOD 4.Obsolete 7.	Grade & Factor <b>3 Average 100%</b>
3.COMP 7.NOV 11.	2.TYPICAL 5. 8.	1.E Grade 4.B Grade 7.AA+ Grad
4.ASB/ASP 8.AL/VIN 12.	3.OLD TYPE 6. 9.None	2.D Grade 5.A Grade 8.AA++Grad
Roof Surface <b>1 Asphalt Shingles</b>	Bath(s) Style <b>2 TYPICAL</b>	3.C Grade 6.AA Grade 9.Same
1.Asphalt 4.Composit 7.	1.GOOD 4.Obsolete 7.	SQFT (Footprint) <b>912</b>
2.Slate 5.Wood 8.	2.TYPICAL 5. 8.	Condition <b>4 Average</b>
3.Metal 6.Other 9.	3.Old Type 6. 9.None	1.Poor 4.Avg 7.V G
SF Masonry Trim <b>0</b>	# Rooms <b>5</b>	2.Fair 5.Avg+ 8.Exc
OPEN-3-CUSTOM <b>0</b>	# Bedrooms <b>2</b>	3.Avg- 6.Good 9.Same
OPEN-4-CUSTOM <b>0</b>	# Full Baths <b>1</b>	Phys. % Good <b>0%</b>
Year Built <b>1970</b>	# Half Baths <b>0</b>	Funct. % Good <b>100%</b>
Year Remodeled <b>0</b>	# Addn Fixtures <b>0</b>	Functional Code <b>9 None</b>
Foundation <b>1 Concrete</b>	# Fireplaces <b>1</b>	1.Incomp 4.SMALL 7.LAYOUT
1.Concrete 4.Wood 7.		2.O-Built 5.CDU 8.OTHER
2.C Block 5.Slab 8.		3.Defmaint 6.STYLE 9.None
3.Br/Stone 6.Piers 9.		Econ. % Good <b>100%</b>
Basement <b>4 Full Basement</b>		Economic Code <b>None</b>
1.1/4 Bmt 4.Full Bmt 7.		0.None 3.Services 9.None
2.1/2 Bmt 5.None 8.		1.Location 4.Traffic 8.
3.3/4 Bmt 6. 9.None		2.Encroach 8.Other 9.
Bsmt Gar # Cars <b>0</b>		Entrance Code <b>3 Information Only</b>
Wet Basement <b>3 Wet Basement</b>		1.Interior 4.Vacant 7.
1.Dry 4. 7.		2.Refusal 5.Estimate 8.
2.Damp 5. 8.		3.Informed 6. 9.
3.Wet 6. 9.		Information Code <b>2 Relative</b>
		1.Owner 4.Agent 7.
		2.Relative 5.Estimate 8.
		3.Tenant 6.Other 9.

Date Inspected 12/08/2006

## Additions, Outbuildings & Improvements

Type	Year	Units	Grade	Cond	Phys.	Funct.	Sound Value	
22 Encl Frame Porch	0	236	0 0	0	0 %	0 %		1.ONE STORY FRAM
91 1S AD/GAR.....	0	576	3 100	4	0 %	100 %		2.TWO STORY FRAM
68 Wood Deck	0	36	1 100	1	0 %	100 %		3.THREE STORY FR
71 CARPORT.....	0	336	2 100	1	0 %	100 %		4.1 & 1/2 STORY
					%	%		5.1 & 3/4 STORY
					%	%		6.2 & 1/2 STORY
					%	%		21.Open Frame Por
					%	%		22.Encl Frame Por
					%	%		23.Frame Garage
					%	%		24.Frame Shed
					%	%		25.Frame Bay Wind
					%	%		26.1SFr Overhang
					%	%		27.Unfin Basement
					%	%		28.Unfinished Att
					%	%		29.Finished Attic

POLE SHED 13X26

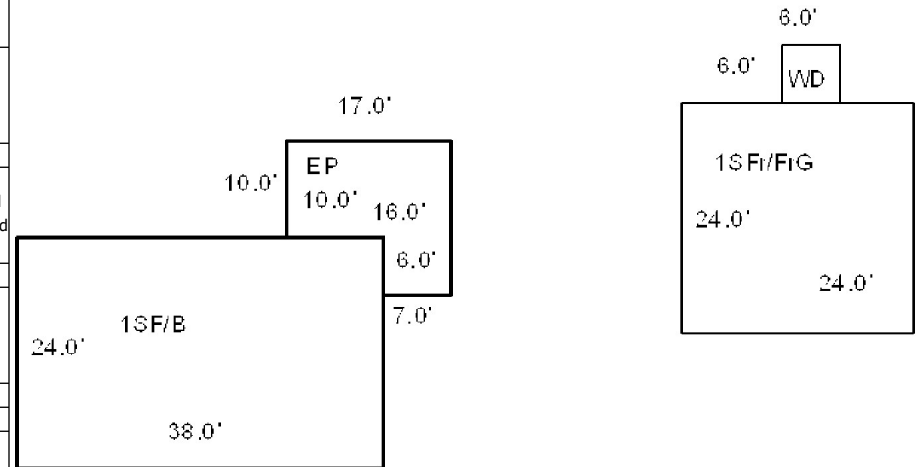

Map Lot U19-008-A

Account 1816

Location 59 SHADY LANE

Card 1 Of 1 9/19/2022

BERRY, LAURIE C WISCASSET ME 04578			Property Data			Assessment Record							
			Neighborhood <b>109 SOUTHEAST</b>			Year	Land	Buildings	Exempt	Total			
						2009	41,900	153,560	13,000	182,460			
			Tree Growth Year <b>0</b>			2010	41,900	153,600	10,000	185,500			
			FARM LAND YEAR <b>0</b>			2011	41,900	153,600	10,000	185,500			
B3007P150  Previous Owner BERRY, LAWRENCE F. BERRY, LAURIE C.			OPEN SPACE YEAR <b>0</b>			2012	41,900	153,600	10,000	185,500			
			Zone/Land Use <b>21 RURAL</b>			2013	41,900	153,600	10,000	185,500			
			Secondary Zone			2014	41,900	153,600	10,000	185,500			
						2015	41,900	153,600	10,000	185,500			
			WISCASSET ME 04578			Topography <b>4 Below Street</b>			2016	41,900	153,600	15,000	180,500
			1.Level           4.Below St       7.Steep 2.Rolling       5.Low           8.Rough 3.Above St      6.Swampy       9.			2017	45,200	153,600	20,000	178,800			
						2018	45,200	153,600	20,000	178,800			
			Utilities <b>4 Drilled Well</b> <b>6 Septic System</b>			2019	45,200	153,600	20,000	178,800			
			1.Public           4.Dr Well       7.Cesspool 2.Water           5.DUG/LAKE     8. 3.Sewer           6.Septic       9.None			2020	45,200	153,600	25,000	173,800			
						2021	45,200	153,600	25,000	173,800			
			Street <b>1 Paved</b>			2022	45,200	153,600	24,000	174,800			
			1.Paved           4.Proposed       7. 2.Semi Imp       5.Private       8. 3.Gravel          6.Pub Eas      9.NoStreet			Land Data							
						Front Foot		Type	Effective		Influence		Influence Codes
									Frontage	Depth	Factor	Code	
			11.Regular Lot								1.Open Space		
			12.Delta Triangle								2.Neighborhood A		
			13.Nabla Triangle						3.Topography				
			14.Rear Land						4.Size/Shape				
			15.Front Foot						5.Access				
									6.Restriction				
						7.Corner/Locatio							
						8.View/Environ							
						9.Fract Share							
						Acres							
						30.Rear 20+							
						31.Waterfront Rea							
						32.Open Space							
						33.RestrictEsm							
						34.PASTURE 1							
						35.HORTICULTURAL-							
						36.Pasture 3							
						37.Software							
						38.Mixed Wood							
						39.Hardwood							
						40.Wasteland							
						41.CAMP SITE							
						42.Mobile Home Si							
						43.Condo Site							
						44.Site Improve							
						45.CAMP SITE							
						46.PAVING/00							
Inspection Witnessed By:			TREE GROWTH PLAN <b>0</b>			11.Regular Lot		Type	Effective		Influence		Influence Codes
			CONSERV EASE <b>0</b>						Frontage	Depth	Factor	Code	
X			Sale Data			12.Delta Triangle							2.Neighborhood A
Date			Sale Date			13.Nabla Triangle							3.Topography
			Price										
No./Date			Sale Type			14.Rear Land							4.Size/Shape
			1.Land           4.Mobile       7.			15.Front Foot							5.Access
			2.L & B       5.Other       8.										
			3.Building      6.           9.			Square Foot			Square Feet				6.Restriction
			Financing			16.Regular Lot							7.Corner/Locatio
Notes:			1.Convent      4.Seller       7.			17.Secondary Site							8.View/Environ
			2.FHA/VA       5.Private      8.										
			3.Assumed     6.Cash       9.Unknown			18.Secondary Site							9.Fract Share
			Validity			19.Condominium							30.Rear 20+
			1.Valid       4.Split       7.Renovate			20.Base Homesite							31.Waterfront Rea
			2.Related     5.Partial     8.Other										
			3.Distress   6.Exempt     9.Foreclose			Fract. Acre			Acreage/Sites				32.Open Space
			Verified			21.HS Size Adj							33.RestrictEsm
			1.Buyer       4.Agent       7.Family			22.Base Waterfron							34.PASTURE 1
			2.Seller       5.Pub Rec    8.Other										
			3.Lender      6.MLS       9.			23.Deep WF Size A							35.HORTICULTURAL-
						Acres							36.Pasture 3
						24.Base Waterfron							37.Software
						25.Shallow WF Siz							38.Mixed Wood
						26.Base Water Inf							39.Hardwood
						27.Influence W Si							40.Wasteland
						28.Rear Land 1-10							41.CAMP SITE
						29.Rear Land 11-2							42.Mobile Home Si
									Total Acreage   5.45				43.Condo Site
WISCASSET													44.Site Improve
													45.CAMP SITE
													46.PAVING/00

# WISCASSET

Map Lot U19-008-A

Account 1816

Location 59 SHADY LANE

Card 1

Of 1

9/19/2022

Building Style <b>5 Colonial</b>	SF Bsmt Living <b>0</b>	Layout <b>1 Typical</b>
1.Conv. 5.Colonial 9.Other	Fin Bsmt Grade <b>0 0</b>	1.Typical 4. 7.
2.Ranch 6.Split 10.Double	HEARTH <b>0</b>	2.Inadeq 5. 8.
3.R Ranch 7.Mod/Cont 11.Multi	Heat Type <b>100% 1 Hot Water BB</b>	3. 6. 9.
4.Cape 8.Log 12.Cot.	1.HWBB 5.FWA 9.No Heat	Attic <b>9 None</b>
Dwelling Units <b>1</b>	2.HWCI 6.GravWA 10.	1.1/4 Fin 4.Full Fin 7.
Other Units <b>0</b>	3.H Pump 7.Electric 11.	2.1/2 Fin 5.F/Stair 8.
Stories <b>5 One &amp; 3/4 Story</b>	4.Steam 8.F/Wall 12.	3.3/4 Fin 6. 9.None
1.1 4.1.5 7.	Cool Type <b>0% 9 None</b>	Insulation <b>1 Full</b>
2.2 5.1.75 8.	1.Refrig 4.W&C Air 7.	1.Full 4.Minimal 7.
3.3 6.2.5 9.	2.Evapor 5. 8.	2.Heavy 5.Unknown 8.
Exterior Walls <b>1 CLAPBOARD</b>	3.H Pump 6. 9.None	3.Capped 6. 9.None
1.CLAP 5.T-111 9.OTHER	Kitchen Style <b>2 TYPICAL</b>	Unfinished % <b>0%</b>
2.WD SH 6.BR/STONE 10.	1.GOOD 4.Obsolete 7.	Grade & Factor <b>4 Good 95%</b>
3.COMP 7.NOV 11.	2.TYPICAL 5. 8.	1.E Grade 4.B Grade 7.AA+ Grad
4.ASB/ASP 8.AL/VIN 12.	3.OLD TYPE 6. 9.None	2.D Grade 5.A Grade 8.AA++Grad
Roof Surface <b>1 Asphalt Shingles</b>	Bath(s) Style <b>2 TYPICAL</b>	3.C Grade 6.AA Grade 9.Same
1.Asphalt 4.Composit 7.	1.GOOD 4.Obsolete 7.	SQFT (Footprint) <b>825</b>
2.Slate 5.Wood 8.	2.TYPICAL 5. 8.	Condition <b>4 Average</b>
3.Metal 6.Other 9.	3.Old Type 6. 9.None	1.Poor 4.Avg 7.V G
SF Masonry Trim <b>0</b>	# Rooms <b>5</b>	2.Fair 5.Avg+ 8.Exc
OPEN-3-CUSTOM <b>0</b>	# Bedrooms <b>3</b>	3.Avg- 6.Good 9.Same
OPEN-4-CUSTOM <b>0</b>	# Full Baths <b>1</b>	Phys. % Good <b>0%</b>
Year Built <b>1985</b>	# Half Baths <b>1</b>	Funct. % Good <b>95%</b>
Year Remodeled <b>0</b>	# Addn Fixtures <b>0</b>	Functional Code <b>9 None</b>
Foundation <b>1 Concrete</b>	# Fireplaces <b>1</b>	1.Incomp 4.SMALL 7.LAYOUT
1.Concrete 4.Wood 7.		2.O-Built 5.CDU 8.OTHER
2.C Block 5.Slab 8.		3.Defmaint 6.STYLE 9.None
3.Br/Stone 6.Piers 9.		Econ. % Good <b>100%</b>
Basement <b>4 Full Basement</b>		Economic Code <b>None</b>
1.1/4 Bmt 4.Full Bmt 7.		0.None 3.Services 9.None
2.1/2 Bmt 5.None 8.		1.Location 4.Traffic 8.
3.3/4 Bmt 6. 9.None		2.Encroach 8.Other 9.
Bsmt Gar # Cars <b>0</b>		Entrance Code <b>1 Interior Inspect</b>
Wet Basement <b>1 Dry Basement</b>		1.Interior 4.Vacant 7.
1.Dry 4. 7.		2.Refusal 5.Estimate 8.
2.Damp 5. 8.		3.Informed 6. 9.
3.Wet 6. 9.		Information Code <b>1 Owner</b>
		1.Owner 4.Agent 7.
		2.Relative 5.Estimate 8.
		3.Tenant 6.Other 9.

Date Inspected 3/22/2007

## Additions, Outbuildings & Improvements

Type	Year	Units	Grade	Cond	Phys.	Funct.	Sound Value	
23 Frame Garage	1980	384	3 100	4	0 %	100 %		1.ONE STORY FRAM
85 1.75 ST SHED....	1997	320	3 100	4	0 %	80 %		2.TWO STORY FRAM
24 Frame Shed	0				%	%	100	3.THREE STORY FR
50 CAPPED	1989	320	3 100	3	0 %	100 %		4.1 & 1/2 STORY
33 Masonry Garage	1999	1080	3 100	4	0 %	100 %		5.1 & 3/4 STORY
21 Open Frame	1999	84	3 100	4	0 %	100 %		6.2 & 1/2 STORY
					%	%		21.Open Frame Por
					%	%		22.Encl Frame Por
					%	%		23.Frame Garage
					%	%		24.Frame Shed
					%	%		25.Frame Bay Wind
					%	%		26.1SFr Overhang
					%	%		27.Unfin Basement
					%	%		28.Unfinished Att
					%	%		29.Finished Attic

SHED 8X12

GARAGE 16X24

1.75S SHED 16X20

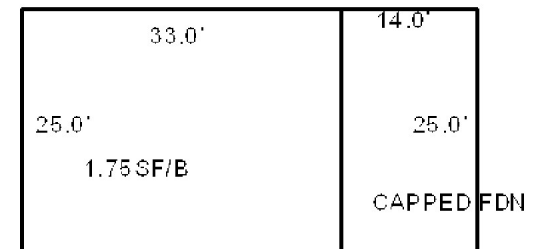

SEPARATE 325X40 CAPPED FOUNDATION



Map Lot		U19-008-B		Account		2570		Location		39 SHADY LANE		Card		1		Of		1		9/19/2022	
HANNA, BLAINE G HANNA, GLORIA J 39 SHADY LANE WISCASSET ME 04578  B5460P270 Previous Owner MEEHAN, TERRANCE J J/T MEEHAN, THERESA M  WISCASSET ME 04578 Sale Date: 11/21/2019 Previous Owner GOWER, CYNTHIA L.  39 SHADY LANE WISCASSET ME 04578 Sale Date: 10/18/2013								Property Data				Assessment Record									
								Neighborhood 109 SOUTHEAST				Year		Land		Buildings		Exempt		Total	
								Tree Growth Year 0				2009		37,240		106,130		0		143,370	
								FARM LAND YEAR 0				2010		37,200		106,600		10,000		133,800	
								OPEN SPACE YEAR 0				2011		37,200		106,600		10,000		133,800	
Previous Owner MEEHAN, TERRANCE J J/T MEEHAN, THERESA M  WISCASSET ME 04578 Sale Date: 11/21/2019 Previous Owner GOWER, CYNTHIA L.  39 SHADY LANE WISCASSET ME 04578 Sale Date: 10/18/2013								Zone/Land Use 21 RURAL				2012		37,200		106,600		10,000		133,800	
								Secondary Zone				2013		37,200		106,600		10,000		133,800	
												2014		37,200		106,600		10,000		133,800	
								Topography 1 Level				2015		37,200		106,600		10,000		133,800	
								1.Level 4.Below St 7.Steep 2.Rolling 5.Low 8.Rough 3.Above St 6.Swampy 9.				2016		37,200		106,600		15,000		128,800	
2017		37,200		106,600		20,000						123,800									
39 SHADY LANE WISCASSET ME 04578 Sale Date: 10/18/2013								Utilities 1 All Public				2018		37,200		106,600		20,000		123,800	
								1.Public 4.Dr Well 7.Cesspool 2.Water 5.DUG/LAKE 8. 3.Sewer 6.Septic 9.None				2019		37,200		106,600		20,000		123,800	
												2020		37,200		106,600		0		143,800	
								Street 1 Paved				2021		37,200		106,600		31,000		112,800	
								1.Paved 4.Proposed 7. 2.Semi Imp 5.Private 8. 3.Gravel 6.Pub Eas 9.NoStreet				2022		37,200		121,800		29,760		129,240	
Land Data																					
Inspection Witnessed By:  X  Date								Front Foot		Type		Effective		Influence		Influence Codes					
												Frontage		Depth				Factor		Code	
																		%			
																		%			
																		%			
X  Date								Square Foot				Square Feet				1.Open Space 2.Neighborhood A 3.Topography 4.Size/Shape 5.Access 6.Restriction 7.Corner/Locatio 8.View/Environ 9.Fract Share  Acres 30.Rear 20+ 31.Waterfront Rea 32.Open Space 33.RestrictEsm 34.PASTURE 1 35.HORTICULTURAL- 36.Pasture 3 37.Softwood 38.Mixed Wood 39.Hardwood 40.Wasteland 41.CAMP SITE 42.Mobile Home Si 43.Condo Site 44.Site Improveveme 45.CAMP SITE 46.PAVING/00					
														%							
														%							
														%							
														%							
Notes: 7/19/22 NAH ADD NEW GAR 6/15/21 DRIVEBY JUST A SLAB, EST AFTER 4/1 178.12' FRONTAGE 2014-Previous owner: Cynthia L. Gower BK4065 PG249.								Fract. Acre				Acreage/Sites									
												20		1.00		100 %		0			
												21		1.00		100 %		0			
												28		0.47		100 %		0			
																%					
WISCASSET												Total Acreage		1.47							



# WISCASSET

Map Lot U19-008-B

Account 2570

Location 39 SHADY LANE

Card 1 Of 1 9/19/2022

Building Style <b>2 Ranch</b>	SF Bsmt Living <b>0</b>	Layout <b>1 Typical</b>
1.Conv. 5.Colonial 9.Other	Fin Bsmt Grade <b>0 0</b>	1.Typical 4. 7.
2.Ranch 6.Split 10.Double	HEARTH <b>0</b>	2.Inadeq 5. 8.
3.R Ranch 7.Mod/Cont 11.Multi	Heat Type <b>100% 5 Forced Warm Air</b>	3. 6. 9.
4.Cape 8.Log 12.Cot.	1.HWBB 5.FWA 9.No Heat	Attic <b>9 None</b>
Dwelling Units <b>1</b>	2.HWCI 6.GravWA 10.	1.1/4 Fin 4.Full Fin 7.
Other Units <b>0</b>	3.H Pump 7.Electric 11.	2.1/2 Fin 5.F/Stair 8.
Stories <b>1 One Story</b>	4.Steam 8.F/Wall 12.	3.3/4 Fin 6. 9.None
1.1 4.1.5 7.	Cool Type <b>0% 9 None</b>	Insulation <b>1 Full</b>
2.2 5.1.75 8.	1.Refrig 4.W&C Air 7.	1.Full 4.Minimal 7.
3.3 6.2.5 9.	2.Evapor 5. 8.	2.Heavy 5.Unknown 8.
Exterior Walls <b>8 ALUM/VINYL</b>	3.H Pump 6. 9.None	3.Capped 6. 9.None
1.CLAP 5.T-111 9.OTHER	Kitchen Style <b>2 TYPICAL</b>	Unfinished % <b>0%</b>
2.WD SH 6.BR/STONE 10.	1.GOOD 4.Obsolete 7.	Grade & Factor <b>3 Average 100%</b>
3.COMP 7.NOV 11.	2.TYPICAL 5. 8.	1.E Grade 4.B Grade 7.AA+ Grad
4.ASB/ASP 8.AL/VIN 12.	3.OLD TYPE 6. 9.None	2.D Grade 5.A Grade 8.AA++Grad
Roof Surface <b>1 Asphalt Shingles</b>	Bath(s) Style <b>2 TYPICAL</b>	3.C Grade 6.AA Grade 9.Same
1.Asphalt 4.Composit 7.	1.GOOD 4.Obsolete 7.	SQFT (Footprint) <b>1350</b>
2.Slate 5.Wood 8.	2.TYPICAL 5. 8.	Condition <b>4 Average</b>
3.Metal 6.Other 9.	3.Old Type 6. 9.None	1.Poor 4.Avg 7.V G
SF Masonry Trim <b>0</b>	# Rooms <b>5</b>	2.Fair 5.Avg+ 8.Exc
OPEN-3-CUSTOM <b>0</b>	# Bedrooms <b>3</b>	3.Avg- 6.Good 9.Same
OPEN-4-CUSTOM <b>0</b>	# Full Baths <b>2</b>	Phys. % Good <b>0%</b>
Year Built <b>2009</b>	# Half Baths <b>0</b>	Funct. % Good <b>100%</b>
Year Remodeled <b>0</b>	# Addn Fixtures <b>0</b>	Functional Code <b>9 None</b>
Foundation <b>5 Concrete Slab</b>	# Fireplaces <b>0</b>	1.Incomp 4.SMALL 7.LAYOUT
1.Concrete 4.Wood 7.		2.O-Built 5.CDU 8.OTHER
2.C Block 5.Slab 8.		3.Defmaint 6.STYLE 9.None
3.Br/Stone 6.Piers 9.		Econ. % Good <b>100%</b>
Basement <b>9 No Basement</b>		Economic Code <b>None</b>
1.1/4 Bmt 4.Full Bmt 7.		0.None 3.Services 9.None
2.1/2 Bmt 5.None 8.		1.Location 4.Traffic 8.
3.3/4 Bmt 6. 9.None		2.Encroach 8.Other 9.
Bsmt Gar # Cars <b>0</b>		Entrance Code <b>1 Interior Inspect</b>
Wet Basement <b>9 No Basement</b>		1.Interior 4.Vacant 7.
1.Dry 4. 7.		2.Refusal 5.Estimate 8.
2.Damp 5. 8.		3.Informed 6. 9.
3.Wet 6. 9.		Information Code <b>0</b>
		1.Owner 4.Agent 7.
		2.Relative 5.Estimate 8.
		3.Tenant 6.Other 9.

Date Inspected 6/01/2010

## Additions, Outbuildings & Improvements

Type	Year	Units	Grade	Cond	Phys.	Funct.	Sound Value	
24 Frame Shed	2009	80	3 100	4	0 %	100 %		1.ONE STORY FRAM
23 Frame Garage	2021	576	3 100	4	0 %	100 %		2.TWO STORY FRAM
					%	%		3.THREE STORY FR
					%	%		4.1 & 1/2 STORY
					%	%		5.1 & 3/4 STORY
					%	%		6.2 & 1/2 STORY
					%	%		21.Open Frame Por
					%	%		22.Encl Frame Por
					%	%		23.Frame Garage
					%	%		24.Frame Shed
					%	%		25.Frame Bay Wind
					%	%		26.1SFr Overhang
					%	%		27.Unfin Basement
					%	%		28.Unfinished Att
					%	%		29.Finished Attic

SHED

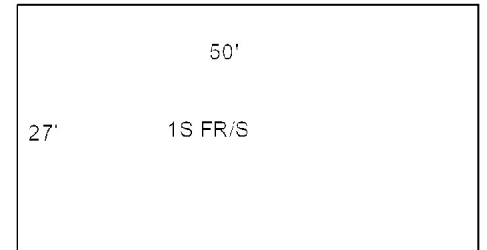
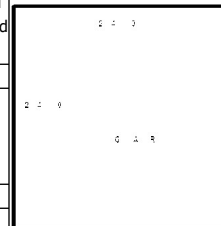

Map Lot U19-009

Account 1817

Location 46 SHADY LANE

Card 1 Of 1 9/19/2022

HARPER, JOHN A  
WISCASSET ME 04578

B2090P28

Inspection Witnessed By:

X

Date

No./Date	Description	Date Insp.

Notes:

WISCASSET

### Property Data

Neighborhood	109 SOUTHEAST		
Tree Growth Year	0		
FARM LAND YEAR	0		
OPEN SPACE YEAR	0		
Zone/Land Use	21 RURAL		
Secondary Zone			
Topography	1 Level		
1.Level	4.Below St	7.Steep	
2.Rolling	5.Low	8.Rough	
3.Above St	6.Swampy	9.	
Utilities	1 All Public		
1.Public	4.Dr Well	7.Cesspool	
2.Water	5.DUG/LAKE	8.	
3.Sewer	6.Septic	9.None	
Street	1 Paved		
1.Paved	4.Proposed	7.	
2.Semi Imp	5.Private	8.	
3.Gravel	6.Pub Eas	9.NoStreet	
TREE GROWTH PLAN	0		
CONSERV EASE	0		
Sale Data			
Sale Date			
Price			
Sale Type			
1.Land	4.Mobile	7.	
2.L & B	5.Other	8.	
3.Building	6.	9.	
Financing			
1.Convent	4.Seller	7.	
2.FHA/VA	5.Private	8.	
3.Assumed	6.Cash	9.Unknown	
Validity			
1.Valid	4.Split	7.Renovate	
2.Related	5.Partial	8.Other	
3.Distress	6.Exempt	9.Foreclose	
Verified			
1.Buyer	4.Agent	7.Family	
2.Seller	5.Pub Rec	8.Other	
3.Lender	6.MLS	9.	

### Assessment Record

Year	Land	Buildings	Exempt	Total
2009	35,540	186,960	13,000	209,500
2010	35,500	187,000	10,000	212,500
2011	35,500	187,000	10,000	212,500
2012	35,500	187,000	10,000	212,500
2013	35,500	187,000	10,000	212,500
2014	35,500	187,000	10,000	212,500
2015	35,500	187,000	10,000	212,500
2016	35,500	187,000	15,000	207,500
2017	35,500	187,000	20,000	202,500
2018	35,500	187,000	20,000	202,500
2019	35,500	187,000	20,000	202,500
2020	35,500	187,000	25,000	197,500
2021	35,500	187,000	25,000	197,500
2022	35,500	187,000	24,000	198,500

### Land Data

Front Foot	Type	Effective		Influence		Influence Codes
		Frontage	Depth	Factor	Code	
11.Regular Lot				%		1.Open Space
12.Delta Triangle				%		2.Neighborhood A
13.Nabla Triangle				%		3.Topography
14.Rear Land				%		4.Size/Shape
15.Front Foot				%		5.Access
				%		6.Restriction
				%		7.Corner/Locatio
				%		8.View/Environ
				%		9.Fract Share
				%		Acres
				%		30.Rear 20+
				%		31.Waterfront Rea
				%		32.Open Space
				%		33.RestrictEsm
				%		34.PASTURE 1
				%		35.HORTICULTURAL-
				%		36.Pasture 3
				%		37.Softwood
				%		38.Mixed Wood
				%		39.Hardwood
				%		40.Wasteland
				%		41.CAMP SITE
				%		42.Mobile Home Si
				%		43.Condo Site
				%		44.Site Improve
				%		45.CAMP SITE
				%		46.PAVING/00
Total Acreage		0.77				

# WISCASSET

Map Lot U19-009

Account 1817

Location 46 SHADY LANE

Card 1

Of 1

9/19/2022

Building Style <b>5 Colonial</b>	SF Bsmt Living <b>0</b>	Layout <b>1 Typical</b>
1.Conv. 5.Colonial 9.Other	Fin Bsmt Grade <b>0 0</b>	1.Typical 4. 7.
2.Ranch 6.Split 10.Double	HEARTH <b>0</b>	2.Inadeq 5. 8.
3.R Ranch 7.Mod/Cont 11.Multi	Heat Type <b>100% 7 Electric</b>	3. 6. 9.
4.Cape 8.Log 12.Cot.	1.HWBB 5.FWA 9.No Heat	Attic <b>9 None</b>
Dwelling Units <b>1</b>	2.HWCI 6.GravWA 10.	1.1/4 Fin 4.Full Fin 7.
Other Units <b>0</b>	3.H Pump 7.Electric 11.	2.1/2 Fin 5.F/Stair 8.
Stories <b>5 One &amp; 3/4 Story</b>	4.Steam 8.F/Wall 12.	3.3/4 Fin 6. 9.None
1.1 4.1.5 7.	Cool Type <b>0% 9 None</b>	Insulation <b>1 Full</b>
2.2 5.1.75 8.	1.Refrig 4.W&C Air 7.	1.Full 4.Minimal 7.
3.3 6.2.5 9.	2.Evapor 5. 8.	2.Heavy 5.Unknown 8.
Exterior Walls <b>2 WOOD SHINGLE</b>	3.H Pump 6. 9.None	3.Capped 6. 9.None
1.CLAP 5.T-111 9.OTHER	Kitchen Style <b>2 TYPICAL</b>	Unfinished % <b>0%</b>
2.WD SH 6.BR/STONE 10.	1.GOOD 4.Obsolete 7.	Grade & Factor <b>4 Good 100%</b>
3.COMP 7.NOV 11.	2.TYPICAL 5. 8.	1.E Grade 4.B Grade 7.AA+ Grad
4.ASB/ASP 8.AL/VIN 12.	3.OLD TYPE 6. 9.None	2.D Grade 5.A Grade 8.AA++Grad
Roof Surface <b>1 Asphalt Shingles</b>	Bath(s) Style <b>2 TYPICAL</b>	3.C Grade 6.AA Grade 9.Same
1.Asphalt 4.Composit 7.	1.GOOD 4.Obsolete 7.	SQFT (Footprint) <b>768</b>
2.Slate 5.Wood 8.	2.TYPICAL 5. 8.	Condition <b>5 Above Average</b>
3.Metal 6.Other 9.	3.Old Type 6. 9.None	1.Poor 4.Avg 7.V G
SF Masonry Trim <b>0</b>	# Rooms <b>6</b>	2.Fair 5.Avg+ 8.Exc
OPEN-3-CUSTOM <b>0</b>	# Bedrooms <b>3</b>	3.Avg- 6.Good 9.Same
OPEN-4-CUSTOM <b>0</b>	# Full Baths <b>1</b>	Phys. % Good <b>0%</b>
Year Built <b>1982</b>	# Half Baths <b>1</b>	Funct. % Good <b>100%</b>
Year Remodeled <b>0</b>	# Addn Fixtures <b>0</b>	Functional Code <b>9 None</b>
Foundation <b>1 Concrete</b>	# Fireplaces <b>1</b>	1.Incomp 4.SMALL 7.LAYOUT
1.Concrete 4.Wood 7.		2.O-Built 5.CDU 8.OTHER
2.C Block 5.Slab 8.		3.Defmaint 6.STYLE 9.None
3.Br/Stone 6.Piers 9.		Econ. % Good <b>100%</b>
Basement <b>4 Full Basement</b>		Economic Code <b>None</b>
1.1/4 Bmt 4.Full Bmt 7.		0.None 3.Services 9.None
2.1/2 Bmt 5.None 8.		1.Location 4.Traffic 8.
3.3/4 Bmt 6. 9.None		2.Encroach 8.Other 9.
Bsmt Gar # Cars <b>0</b>		Entrance Code <b>5 Estimated</b>
Wet Basement <b>1 Dry Basement</b>		1.Interior 4.Vacant 7.
1.Dry 4. 7.		2.Refusal 5.Estimate 8.
2.Damp 5. 8.		3.Informed 6. 9.
3.Wet 6. 9.		Information Code <b>5 Estimate</b>
		1.Owner 4.Agent 7.
		2.Relative 5.Estimate 8.
		3.Tenant 6.Other 9.

Date Inspected 12/08/2006

## Additions, Outbuildings & Improvements

Type	Year	Units	Grade	Cond	Phys.	Funct.	Sound Value	
1 ONE STORY	0	168	0 0	0	0 %	0 %		1.ONE STORY FRAM
21 Open Frame	0	86	0 0	0	0 %	0 %		2.TWO STORY FRAM
92 3/4S AD/GAR.....	0	672	0 0	0	0 %	0 %		3.THREE STORY FR
23 Frame Garage	2001	720	0 0	0	0 %	0 %		4.1 & 1/2 STORY
					%	%		5.1 & 3/4 STORY
					%	%		6.2 & 1/2 STORY
					%	%		21.Open Frame Por
					%	%		22.Encl Frame Por
					%	%		23.Frame Garage
					%	%		24.Frame Shed
					%	%		25.Frame Bay Wind
					%	%		26.1SFr Overhang
					%	%		27.Unfin Basement
					%	%		28.Unfinished Att
					%	%		29.Finished Attic

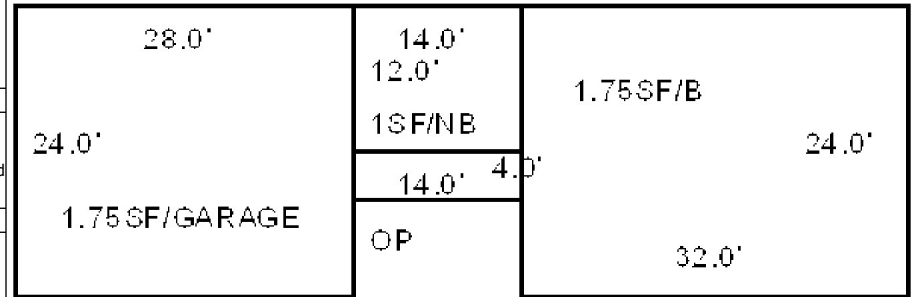



BUCCINA, ROBERT F J/T  
BUCCINA, STACIE  
WISCASSET ME 04578

B2624P156 B4167P293

Previous Owner  
BUCCINA, ROBERT F.

68 SHADY LANE  
WISCASSET ME 04578  
Sale Date: 7/01/2009

Inspection Witnessed By:

X

Date

No./Date	Description	Date Insp.

Notes:

'15 add sv p&p Greenhse.  
PREVIOUS BK0935 PG0112  
2001-JOINT TENANCY SEVERED  
2005-PER PLANNING BOARD PLAN CHANGED ACREAGE FROM  
1.52 TO 1.45.  
2010-created joint tenancy with daughter, Stacie Buccina.

# WISCASSET

## Property Data

Neighborhood		109 SOUTHEAST	
Tree Growth Year		0	
FARM LAND YEAR		0	
OPEN SPACE YEAR		0	
Zone/Land Use		21 RURAL	
Secondary Zone			
Topography		1 Level	
1.Level	4.Below St	7.Steep	
2.Rolling	5.Low	8.Rough	
3.Above St	6.Swampy	9.	
Utilities		1 All Public	
1.Public	4.Dr Well	7.Cesspool	
2.Water	5.DUG/LAKE	8.	
3.Sewer	6.Septic	9.None	
Street		1 Paved	
1.Paved	4.Proposed	7.	
2.Semi Imp	5.Private	8.	
3.Gravel	6.Pub Eas	9.NoStreet	
TREE GROWTH PLAN		0	
CONSERV EASE		0	
Sale Data			
Sale Date		7/01/2009	
Price			
Sale Type		2 Land & Buildings	
1.Land	4.Mobile	7.	
2.L & B	5.Other	8.	
3.Building	6.	9.	
Financing		9 Unknown	
1.Convert	4.Seller	7.	
2.FHA/VA	5.Private	8.	
3.Assumed	6.Cash	9.Unknown	
Validity		2 Related Parties	
1.Valid	4.Split	7.Renovate	
2.Related	5.Partial	8.Other	
3.Distress	6.Exempt	9.Foreclose	
Verified		5 Public Record	
1.Buyer	4.Agent	7.Family	
2.Seller	5.Pub Rec	8.Other	
3.Lender	6.MLS	9.	

## Assessment Record

Year	Land	Buildings	Exempt	Total
2009	37,220	172,800	13,000	197,020
2010	37,200	172,800	16,000	194,000
2011	37,200	172,800	16,000	194,000
2012	37,200	172,800	16,000	194,000
2013	37,200	172,800	16,000	194,000
2014	37,200	172,800	16,000	194,000
2015	37,200	173,800	16,000	195,000
2016	37,200	173,800	21,000	190,000
2017	37,200	173,800	26,000	185,000
2018	37,200	173,800	26,000	185,000
2019	37,200	173,800	26,000	185,000
2020	37,200	173,800	31,000	180,000
2021	37,200	173,800	31,000	180,000
2022	37,200	173,800	29,760	181,240

## Land Data

Front Foot	Type	Effective		Influence		Influence Codes	
		Frontage	Depth	Factor	Code		
11.Regular Lot				%		1.Open Space	
12.Delta Triangle				%		2.Neighborhood A	
13.Nabla Triangle				%		3.Topography	
14.Rear Land				%		4.Size/Shape	
15.Front Foot				%		5.Access	
				%		6.Restriction	
				%		7.Corner/Locatio	
Square Foot		Square Feet				8.View/Environ	
	16.Regular Lot			%		9.Fract Share	
	17.Secondary Site			%		<b>Acres</b>	
	18.Secondary Site			%		30.Rear 20+	
	19.Condominium			%		31.Waterfront Rea	
	20.Base Homesite			%		32.Open Space	
				%		33.RestrictEsm	
				%		34.PASTURE 1	
Fract. Acre		Acreage/Sites				35.HORTICULTURAL-	
	21.HS Size Adj	20	1.00	100	%	0	36.Pasture 3
	22.Base Waterfront	21	1.00	100	%	0	37.Softwood
	23.Deep WF Size A	28	0.46	100	%	0	38.Mixed Wood
	<b>Acres</b>				%		39.Hardwood
	24.Base Waterfront				%		40.Wasteland
	25.Shallow WF Siz				%		41.CAMP SITE
	26.Base Water Inf				%		42.Mobile Home Si
	27.Influence W Si				%		43.Condo Site
	28.Rear Land 1-10				%		44.Site Improve
29.Rear Land 11-2				%		45.CAMP SITE	
		Total Acreage		1.46		46.PAVING/00	

# WISCASSET

Map Lot U19-010

Account 1818

Location 68 SHADY LANE

Card 1

Of 1

9/19/2022

Building Style <b>5 Colonial</b>	SF Bsmt Living <b>0</b>	Layout <b>1 Typical</b>
1.Conv. 5.Colonial 9.Other	Fin Bsmt Grade <b>0 0</b>	1.Typical 4. 7.
2.Ranch 6.Split 10.Double	HEARTH <b>0</b>	2.Inadeq 5. 8.
3.R Ranch 7.Mod/Cont 11.Multi	Heat Type <b>100% 7 Electric</b>	3. 6. 9.
4.Cape 8.Log 12.Cot.	1.HWBB 5.FWA 9.No Heat	Attic <b>9 None</b>
Dwelling Units <b>1</b>	2.HWCI 6.GravWA 10.	1.1/4 Fin 4.Full Fin 7.
Other Units <b>0</b>	3.H Pump 7.Electric 11.	2.1/2 Fin 5.F/Stair 8.
Stories <b>2 Two Story</b>	4.Steam 8.F/Wall 12.	3.3/4 Fin 6. 9.None
1.1 4.1.5 7.	Cool Type <b>0% 9 None</b>	Insulation <b>1 Full</b>
2.2 5.1.75 8.	1.Refrig 4.W&C Air 7.	1.Full 4.Minimal 7.
3.3 6.2.5 9.	2.Evapor 5. 8.	2.Heavy 5.Unknown 8.
Exterior Walls <b>8 ALUM/VINYL</b>	3.H Pump 6. 9.None	3.Capped 6. 9.None
1.CLAP 5.T-111 9.OTHER	Kitchen Style <b>2 TYPICAL</b>	Unfinished % <b>0%</b>
2.WD SH 6.BR/STONE 10.	1.GOOD 4.Obsolete 7.	Grade & Factor <b>3 Average 100%</b>
3.COMP 7.NOV 11.	2.TYPICAL 5. 8.	1.E Grade 4.B Grade 7.AA+ Grad
4.ASB/ASP 8.AL/VIN 12.	3.OLD TYPE 6. 9.None	2.D Grade 5.A Grade 8.AA++Grad
Roof Surface <b>1 Asphalt Shingles</b>	Bath(s) Style <b>2 TYPICAL</b>	3.C Grade 6.AA Grade 9.Same
1.Asphalt 4.Composit 7.	1.GOOD 4.Obsolete 7.	SQFT (Footprint) <b>1040</b>
2.Slate 5.Wood 8.	2.TYPICAL 5. 8.	Condition <b>4 Average</b>
3.Metal 6.Other 9.	3.Old Type 6. 9.None	1.Poor 4.Avg 7.V G
SF Masonry Trim <b>0</b>	# Rooms <b>9</b>	2.Fair 5.Avg+ 8.Exc
OPEN-3-CUSTOM <b>0</b>	# Bedrooms <b>4</b>	3.Avg- 6.Good 9.Same
OPEN-4-CUSTOM <b>0</b>	# Full Baths <b>2</b>	Phys. % Good <b>0%</b>
Year Built <b>1979</b>	# Half Baths <b>0</b>	Funct. % Good <b>100%</b>
Year Remodeled <b>0</b>	# Addn Fixtures <b>0</b>	Functional Code <b>9 None</b>
Foundation <b>1 Concrete</b>	# Fireplaces <b>0</b>	1.Incomp 4.SMALL 7.LAYOUT
1.Concrete 4.Wood 7.		2.O-Built 5.CDU 8.OTHER
2.C Block 5.Slab 8.		3.Defmaint 6.STYLE 9.None
3.Br/Stone 6.Piers 9.		Econ. % Good <b>100%</b>
Basement <b>4 Full Basement</b>		Economic Code <b>None</b>
1.1/4 Bmt 4.Full Bmt 7.		0.None 3.Services 9.None
2.1/2 Bmt 5.None 8.		1.Location 4.Traffic 8.
3.3/4 Bmt 6. 9.None		2.Encroach 8.Other 9.
Bsmt Gar # Cars <b>0</b>		Entrance Code <b>3 Information Only</b>
Wet Basement <b>1 Dry Basement</b>		1.Interior 4.Vacant 7.
1.Dry 4. 7.		2.Refusal 5.Estimate 8.
2.Damp 5. 8.		3.Informed 6. 9.
3.Wet 6. 9.		Information Code <b>1 Owner</b>
		1.Owner 4.Agent 7.
		2.Relative 5.Estimate 8.
		3.Tenant 6.Other 9.

GARAGE 24X30W 24X20 ADDITION

IGPOOL 16X32

POOL SHED 8X12

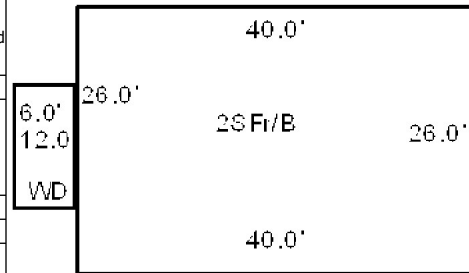

Date Inspected 12/08/2006

## Additions, Outbuildings & Improvements

Type	Year	Units	Grade	Cond	Phys.	Funct.	Sound Value	
68 Wood Deck	1988	72	3 100	3	0 %	100 %		1.ONE STORY FRAM
23 Frame Garage	1979	720	3 100	4	0 %	100 %		2.TWO STORY FRAM
63 Swimming Pool	1988	512	3 100	4	99 %	100 %		3.THREE STORY FR
24 Frame Shed	1988	96	3 100	4	0 %	100 %		4.1 & 1/2 STORY
23 Frame Garage	1998	480	3 100	4	0 %	100 %		5.1 & 3/4 STORY
68 Wood Deck	2000	128	3 100	4	0 %	100 %		6.2 & 1/2 STORY
66 Res. Greenhouse	2014				%	%	1,000	21.Open Frame Por
					%	%		22.Encl Frame Por
					%	%		23.Frame Garage
					%	%		24.Frame Shed
					%	%		25.Frame Bay Wind
					%	%		26.1SFr Overhang
					%	%		27.Unfin Basement
					%	%		28.Unfinished Att
					%	%		29.Finished Attic



BUCCINA, ROBERT F BUCCINA, STACIE M 68 SHADY LANE WISCASSET ME 04578			Property Data			Assessment Record							
			Neighborhood 109 SOUTHEAST			Year	Land		Buildings		Exempt	Total	
			Tree Growth Year 0			2020	0		4,500		4,500	0	
			FARM LAND YEAR			2021	0		4,300		4,300	0	
			OPEN SPACE YEAR			2022	0		4,000		4,000	0	
			Zone/Land Use 21 RURAL										
			Secondary Zone										
			Topography 2 Rolling										
			1.Level 4.Below St 7.Steep 2.Rolling 5.Low 8.Rough 3.Above St 6.Swampy 9.										
			Utilities										
			1.Public 4.Dr Well 7.Cesspool 2.Water 5.DUG/LAKE 8. 3.Sewer 6.Septic 9.None										
			Street 1 Paved										
			1.Paved 4.Proposed 7. 2.Semi Imp 5.Private 8. 3.Gravel 6.Pub Eas 9.NoStreet										
Inspection Witnessed By:  X <div>Date</div>			TREE GROWTH PLAN 0			Land Data							
			CONSERV EASE 0										
			Sale Data										
			Sale Date										
			Price										
No./DateDescriptionDate Insp.			Sale Type			Front Foot		Type	Effective		Influence		Influence Codes
									Frontage	Depth	Factor	Code	
			1.Land 4.Mobile 7. 2.L & B 5.Other 8. 3.Building 6. 9.								%		
			Financing								%		
			1.Convent 4.Seller 7. 2.FHA/VA 5.Private 8. 3.Assumed 6.Cash 9.Unknown								%		
Notes: '20 New Solar 'ON'			Validity			Square Foot			Square Feet				Acres
			1.Valid 4.Split 7.Renovate 2.Related 5.Partial 8.Other 3.Distress 6.Exempt 9.Foreclose								%		
			Verified								%		
			1.Buyer 4.Agent 7.Family 2.Seller 5.Pub Rec 8.Other 3.Lender 6.MLS 9.								%		
											%		
WISCASSET						Fract. Acre			Acreage/Sites				Acres
			1.HS Size Adj 22.Base Waterfron 23.Deep WF Size A								%		
			24.Base Waterfron 25.Shallow WF Siz 26.Base Water Inf 27.Influence W Si 28.Rear Land 1-10 29.Rear Land 11-2								%		
											%		
											%		
						Total Acreage		0.00					

**WISCASSET**

Map Lot U19-010-ON

Account 2701

Location 68 SHADY LANE

Card 1 Of 1 9/19/2022

Building Style			SF Bsmt Living			Layout		
1.Conv.	5.Colonial	9.Other	Fin Bsmt Grade			1.Typical 4. 7.		
2.Ranch	6.Split	10.Double	HEARTH			2.Inadeq 5. 8.		
3.R Ranch	7.Mod/Cont	11.Multi	Heat Type <b>100%</b>			3. 6. 9.		
4.Cape	8.Log	12.Cot.	1.HWBB 5.FWA 9.No Heat			Attic		
Dwelling Units			2.HWCI 6.GravWA 10.			1.1/4 Fin 4.Full Fin 7.		
Other Units			3.H Pump 7.Electric 11.			2.1/2 Fin 5.F/Stair 8.		
Stories			4.Steam 8.F/Wall 12.			3.3/4 Fin 6. 9.None		
1.1	4.1.5	7.	Cool Type <b>0%</b>			Insulation		
2.2	5.1.75	8.	1.Refrig 4.W&C Air 7.			1.Full 4.Minimal 7.		
3.3	6.2.5	9.	2.Evapor 5. 8.			2.Heavy 5.Unknown 8.		
Exterior Walls			3.H Pump 6. 9.None			3.Capped 6. 9.None		
1.CLAP	5.T-111	9.OTHER	Kitchen Style			Unfinished %		
2.WD SH	6.BR/STONE	10.	1.GOOD 4.Obsolete 7.			Grade & Factor		
3.COMP	7.NOV	11.	2.TYPICAL 5. 8.			1.E Grade 4.B Grade 7.AA+ Grad		
4.ASB/ASP	8.AL/VIN	12.	3.OLD TYPE 6. 9.None			2.D Grade 5.A Grade 8.AA++Grad		
Roof Surface			Bath(s) Style			3.C Grade 6.AA Grade 9.Same		
1.Asphalt	4.Composit	7.	1.GOOD 4.Obsolete 7.			SQFT (Footprint)		
2.Slate	5.Wood	8.	2.TYPICAL 5. 8.			Condition		
3.Metal	6.Other	9.	3.Old Type 6. 9.None			1.Poor 4.Avg 7.V G		
SF Masonry Trim			# Rooms			2.Fair 5.Avg+ 8.Exc		
OPEN-3-CUSTOM			# Bedrooms			3.Avg- 6.Good 9.Same		
OPEN-4-CUSTOM			# Full Baths			Phys. % Good		
Year Built			# Half Baths			Funct. % Good		
Year Remodeled			# Addn Fixtures			Functional Code		
Foundation			# Fireplaces			1.Incomp 4.SMALL 7.LAYOUT		
1.Concrete	4.Wood	7.				2.O-Built 5.CDU 8.OTHER		
2.C Block	5.Slab	8.				3.Defmoint 6.STYLE 9.None		
3.Br/Stone	6.Piers	9.				Econ. % Good		
Basement						Economic Code		
1.1/4 Bmt	4.Full Bmt	7.				0.None 3.Services 9.None		
2.1/2 Bmt	5.None	8.				1.Location 4.Traffic 8.		
3.3/4 Bmt	6.	9.None				2.Encroach 8.Other 9.		
Bsmt Gar # Cars						Entrance Code <b>0</b>		
Wet Basement						1.Interior 4.Vacant 7.		
1.Dry	4.	7.				2.Refusal 5.Estimate 8.		
2.Damp	5.	8.				3.Informed 6. 9.		
3.Wet	6.	9.				Information Code <b>0</b>		
						1.Owner 4.Agent 7.		
						2.Relative 5.Estimate 8.		
						3.Tenant 6.Other 9.		
Date Inspected								
<b>Additions, Outbuildings &amp; Improvements</b>								1.ONE STORY FRAM
Type	Year	Units	Grade	Cond	Phys.	Funct.	Sound Value	2.TWO STORY FRAM
124 SOLAR PANELS	2019				%	%	4,000	3.THREE STORY FR
					%	%		4.1 & 1/2 STORY
					%	%		5.1 & 3/4 STORY
					%	%		6.2 & 1/2 STORY
					%	%		21.Open Frame Por
					%	%		22.Encl Frame Por
					%	%		23.Frame Garage
					%	%		24.Frame Shed
					%	%		25.Frame Bay Wind
					%	%		26.1SFr Overhang
					%	%		27.Unfin Basement
					%	%		28.Unfinished Att
					%	%		29.Finished Attic

Map Lot U19-011

Account 1819

Location 30 SHADY LANE

Card 1 Of 1 9/19/2022

GOODWIN, EVAN TUCKER  
30 SHADY LANE  
WISCASSET ME 04578

B5687P58

Previous Owner  
MCKARNS, REBECCA A J/T  
MCKARNS, LYLE J

WISCASSET ME 04578  
Sale Date: 3/31/2021

Previous Owner  
JOSLYN, MELANIE S.  
C/O LYLE & REBECCA MCKARNS  
30 SHADY LANE  
WISCASSET ME 04578  
Sale Date: 6/06/2011

Previous Owner  
DAY, PERLEY E.  
C/O MELANIE S. JOSLYN  
30 SHADY LANE  
WISCASSET ME 04578  
Sale Date: 7/22/2005

Inspection Witnessed By:

X

Date

No./Date	Description	Date Insp.

Notes:

7/19/22 NAH VENT PIPE ON GAR ROOF (PLUMB PERMIT),  
EST BATHROOM, ADD SHED NPA  
2006-PREVIOUS OWNER: PERLEY E. DAY BK2381 PG65,  
BK2282 PG2, sold for \$150,000 in 2005.

WISCASSET

## Property Data

Neighborhood	109 SOUTHEAST		
Tree Growth Year	0		
FARM LAND YEAR	0		
OPEN SPACE YEAR	0		
Zone/Land Use	21 RURAL		
Secondary Zone			
Topography	1 Level	3 Above Street	
1.Level	4.Below St	7.Steep	
2.Rolling	5.Low	8.Rough	
3.Above St	6.Swampy	9.	
Utilities	4 Drilled Well	6 Septic System	
1.Public	4.Dr Well	7.Cesspool	
2.Water	5.DUG/LAKE	8.	
3.Sewer	6.Septic	9.None	
Street	1 Paved		
1.Paved	4.Proposed	7.	
2.Semi Imp	5.Private	8.	
3.Gravel	6.Pub Eas	9.NoStreet	
TREE GROWTH PLAN	0		
CONSERV EASE	0		
Sale Data			
Sale Date	3/31/2021		
Price	262,500		
Sale Type	2 Land & Buildings		
1.Land	4.Mobile	7.	
2.L & B	5.Other	8.	
3.Building	6.	9.	
Financing	9 Unknown		
1.Convent	4.Seller	7.	
2.FHA/VA	5.Private	8.	
3.Assumed	6.Cash	9.Unknown	
Validity	1 Arms Length Sale		
1.Valid	4.Split	7.Renovate	
2.Related	5.Partial	8.Other	
3.Distress	6.Exempt	9.Foreclose	
Verified	5 Public Record		
1.Buyer	4.Agent	7.Family	
2.Seller	5.Pub Rec	8.Other	
3.Lender	6.MLS	9.	

## Assessment Record

Year	Land	Buildings	Exempt	Total
2009	34,980	121,430	0	156,410
2010	35,000	121,400	0	156,400
2011	35,000	121,400	0	156,400
2012	35,000	121,400	0	156,400
2013	35,000	121,400	0	156,400
2014	35,000	121,400	0	156,400
2015	35,000	121,400	0	156,400
2016	35,000	121,400	0	156,400
2017	35,000	121,400	0	156,400
2018	35,000	121,400	0	156,400
2019	35,000	121,400	20,000	136,400
2020	35,000	121,400	25,000	131,400
2021	35,000	121,400	0	156,400
2022	35,000	124,600	0	159,600

## Land Data

Front Foot	Type	Effective		Influence		Influence Codes
		Frontage	Depth	Factor	Code	
11.Regular Lot				%		1.Open Space
12.Delta Triangle				%		2.Neighborhood A
13.Nabla Triangle				%		3.Topography
14.Rear Land				%		4.Size/Shape
15.Front Foot				%		5.Access
				%		6.Restriction
				%		7.Corner/Locatio
				%		8.View/Environ
				%		9.Fract Share
				%		Acres
				%		30.Rear 20+
				%		31.Waterfront Rea
				%		32.Open Space
				%		33.RestrictEsm
				%		34.PASTURE 1
				%		35.HORTICULTURAL-
				%		36.Pasture 3
				%		37.Softwood
				%		38.Mixed Wood
				%		39.Hardwood
				%		40.Wasteland
				%		41.CAMP SITE
				%		42.Mobile Home Si
				%		43.Condo Site
				%		44.Site Improve
				%		45.CAMP SITE
				%		46.PAVING/00
Total Acreage		0.60				

## Front Foot

11.Regular Lot  
12.Delta Triangle  
13.Nabla Triangle  
14.Rear Land  
15.Front Foot

## Square Foot

16.Regular Lot  
17.Secondary Site  
18.Secondary Site  
19.Condominium  
20.Base Homesite

## Fract. Acre

21.HS Size Adj  
22.Base Waterfron  
23.Deep WF Size A

## Acres

24.Base Waterfron  
25.Shallow WF Siz  
26.Base Water Inf  
27.Influence W Si  
28.Rear Land 1-10  
29.Rear Land 11-2

## Type

11.Regular Lot  
12.Delta Triangle  
13.Nabla Triangle  
14.Rear Land  
15.Front Foot

## Square Feet

16.Regular Lot  
17.Secondary Site  
18.Secondary Site  
19.Condominium  
20.Base Homesite

## Fract. Acre

21.HS Size Adj  
22.Base Waterfron  
23.Deep WF Size A

## Acres

24.Base Waterfron  
25.Shallow WF Siz  
26.Base Water Inf  
27.Influence W Si  
28.Rear Land 1-10  
29.Rear Land 11-2

## Effective

11.Regular Lot  
12.Delta Triangle  
13.Nabla Triangle  
14.Rear Land  
15.Front Foot

## Square Feet

16.Regular Lot  
17.Secondary Site  
18.Secondary Site  
19.Condominium  
20.Base Homesite

## Fract. Acre

21.HS Size Adj  
22.Base Waterfron  
23.Deep WF Size A

## Acres

24.Base Waterfron  
25.Shallow WF Siz  
26.Base Water Inf  
27.Influence W Si  
28.Rear Land 1-10  
29.Rear Land 11-2

## Influence

11.Regular Lot  
12.Delta Triangle  
13.Nabla Triangle  
14.Rear Land  
15.Front Foot

## Square Feet

16.Regular Lot  
17.Secondary Site  
18.Secondary Site  
19.Condominium  
20.Base Homesite

## Fract. Acre

21.HS Size Adj  
22.Base Waterfron  
23.Deep WF Size A

## Acres

24.Base Waterfron  
25.Shallow WF Siz  
26.Base Water Inf  
27.Influence W Si  
28.Rear Land 1-10  
29.Rear Land 11-2

## Influence Codes

1.Open Space  
2.Neighborhood A  
3.Topography  
4.Size/Shape  
5.Access  
6.Restriction  
7.Corner/Locatio  
8.View/Environ  
9.Fract Share  
Acres  
30.Rear 20+  
31.Waterfront Rea  
32.Open Space  
33.RestrictEsm  
34.PASTURE 1  
35.HORTICULTURAL-  
36.Pasture 3  
37.Softwood  
38.Mixed Wood  
39.Hardwood  
40.Wasteland  
41.CAMP SITE  
42.Mobile Home Si  
43.Condo Site  
44.Site Improve  
45.CAMP SITE  
46.PAVING/00

# WISCASSET

Map Lot U19-011

Account 1819

Location 30 SHADY LANE

Card 1

Of 1

9/19/2022

Building Style <b>3 Raised Ranch</b>	SF Bsmt Living <b>896</b>	Layout <b>1 Typical</b>
1.Conv. 5.Colonial 9.Other	Fin Bsmt Grade <b>9 100</b>	1.Typical 4. 7.
2.Ranch 6.Split 10.Double	HEARTH <b>2</b>	2.Inadeq 5. 8.
3.R Ranch 7.Mod/Cont 11.Multi	Heat Type <b>100% 1 Hot Water BB</b>	3. 6. 9.
4.Cape 8.Log 12.Cot.	1.HWBB 5.FWA 9.No Heat	Attic <b>9 None</b>
Dwelling Units <b>1</b>	2.HWCI 6.GravWA 10.	1.1/4 Fin 4.Full Fin 7.
Other Units <b>0</b>	3.H Pump 7.Electric 11.	2.1/2 Fin 5.F/Stair 8.
Stories <b>1 One Story</b>	4.Steam 8.F/Wall 12.	3.3/4 Fin 6. 9.None
1.1 4.1.5 7.	Cool Type <b>0% 9 None</b>	Insulation <b>1 Full</b>
2.2 5.1.75 8.	1.Refrig 4.W&C Air 7.	1.Full 4.Minimal 7.
3.3 6.2.5 9.	2.Evapor 5. 8.	2.Heavy 5.Unknown 8.
Exterior Walls <b>3 COMPOSITION</b>	3.H Pump 6. 9.None	3.Capped 6. 9.None
1.CLAP 5.T-111 9.OTHER	Kitchen Style <b>2 TYPICAL</b>	Unfinished % <b>0%</b>
2.WD SH 6.BR/STONE 10.	1.GOOD 4.Obsolete 7.	Grade & Factor <b>3 Average 100%</b>
3.COMP 7.NOV 11.	2.TYPICAL 5. 8.	1.E Grade 4.B Grade 7.AA+ Grad
4.ASB/ASP 8.AL/VIN 12.	3.OLD TYPE 6. 9.None	2.D Grade 5.A Grade 8.AA++Grad
Roof Surface <b>1 Asphalt Shingles</b>	Bath(s) Style <b>2 TYPICAL</b>	3.C Grade 6.AA Grade 9.Same
1.Asphalt 4.Composit 7.	1.GOOD 4.Obsolete 7.	SQFT (Footprint) <b>1040</b>
2.Slate 5.Wood 8.	2.TYPICAL 5. 8.	Condition <b>4 Average</b>
3.Metal 6.Other 9.	3.Old Type 6. 9.None	1.Poor 4.Avg 7.V G
SF Masonry Trim <b>0</b>	# Rooms <b>6</b>	2.Fair 5.Avg+ 8.Exc
OPEN-3-CUSTOM <b>0</b>	# Bedrooms <b>3</b>	3.Avg- 6.Good 9.Same
OPEN-4-CUSTOM <b>0</b>	# Full Baths <b>3</b>	Phys. % Good <b>0%</b>
Year Built <b>1978</b>	# Half Baths <b>0</b>	Funct. % Good <b>100%</b>
Year Remodeled <b>0</b>	# Addn Fixtures <b>0</b>	Functional Code <b>9 None</b>
Foundation <b>1 Concrete</b>	# Fireplaces <b>0</b>	1.Incomp 4.SMALL 7.LAYOUT
1.Concrete 4.Wood 7.		2.O-Built 5.CDU 8.OTHER
2.C Block 5.Slab 8.		3.Defmaint 6.STYLE 9.None
3.Br/Stone 6.Piers 9.		Econ. % Good <b>100%</b>
Basement <b>4 Full Basement</b>		Economic Code <b>None</b>
1.1/4 Bmt 4.Full Bmt 7.		0.None 3.Services 9.None
2.1/2 Bmt 5.None 8.		1.Location 4.Traffic 8.
3.3/4 Bmt 6. 9.None		2.Encroach 8.Other 9.
Bsmt Gar # Cars <b>0</b>		Entrance Code <b>5 Estimated</b>
Wet Basement <b>1 Dry Basement</b>		1.Interior 4.Vacant 7.
1.Dry 4. 7.		2.Refusal 5.Estimate 8.
2.Damp 5. 8.		3.Informed 6. 9.
3.Wet 6. 9.		Information Code <b>5 Estimate</b>
		1.Owner 4.Agent 7.
		2.Relative 5.Estimate 8.
		3.Tenant 6.Other 9.

Date Inspected 12/08/2006

## Additions, Outbuildings & Improvements

Type	Year	Units	Grade	Cond	Phys.	Funct.	Sound Value
26 1SFr Overhang	0	33	0 0	0	0 %	0 %	
23 Frame Garage	0	308	0 0	0	0 %	0 %	
68 Wood Deck	1978	80	0 0	0	0 %	0 %	
68 Wood Deck	2002	192	3 100	4	0 %	100 %	
24 Frame Shed	0				%	%	400
					%	%	
					%	%	
					%	%	
					%	%	
					%	%	

10.0'

10.0'

SHED

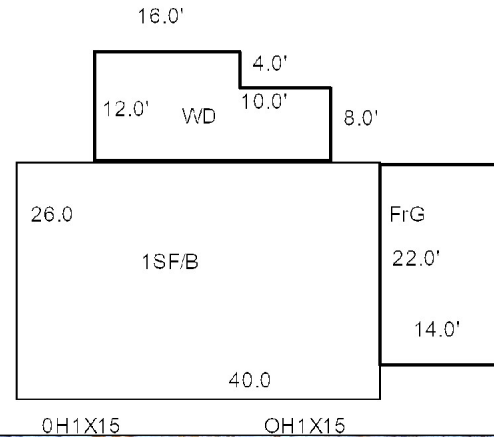

Map Lot U19-012

Account 1820

Location 806 BATH ROAD

Card 1 Of 1 9/19/2022

DELGAUDIO, ANTHONY TOPSHAM ME 04086			Property Data			Assessment Record							
			Neighborhood    200 U.S. RTE 1			Year	Land	Buildings	Exempt	Total			
			Tree Growth Year    0			2009	62,000	0	0	62,000			
			FARM LAND YEAR    0			2010	62,000	0	0	62,000			
			OPEN SPACE YEAR    0			2011	62,000	0	0	62,000			
B4804P157 Previous Owner CHAPMAN, KENNETH W. C/O ANTHONY DELGAUDIO 59 ELM STREET TOPSHAM ME 04086 Sale Date: 7/30/2140			Zone/Land Use    21 RURAL			2012	62,000	0	0	62,000			
			Secondary Zone			2013	62,000	0	0	62,000			
						2014	62,000	0	0	62,000			
			Topography    1 Level			2015	62,000	0	0	62,000			
			Previous Owner CHAPMAN, PRISCILLA JANE (J/T) CHAPMAN, KENNETH W.			1.Level    4.Below St    7.Steep	2016	62,000	0	0	62,000		
2.Rolling    5.Low    8.Rough	2017	62,000				0	0	62,000					
3.Above St    6.Swampy    9.	2018	62,000				0	0	62,000					
Utilities    9 NoWater/NoSewer	2019	62,000				0	0	62,000					
1.Public    4.Dr Well    7.Cesspool	2020	62,000				0	0	62,000					
WISCASSET ME 04578 Sale Date: 2/01/2008			2.Water    5.DUG/LAKE    8.	2021	62,000	0	0	62,000					
			3.Sewer    6.Septic    9.None	2022	62,000	0	0	62,000					
			Street    1 Paved			Land Data							
			1.Paved    4.Proposed    7.	Front Foot									
			2.Semi Imp    5.Private    8.			Frontage	Depth	Factor	Code				
Inspection Witnessed By:			3.Gravel    6.Pub Eas    9.NoStreet	11.Regular Lot						1.Open Space			
			TREE GROWTH PLAN    0	12.Delta Triangle							2.Neighborhood A		
			CONSERV EASE    0	13.Nabla Triangle							3.Topography		
			Sale Data			14.Rear Land						4.Size/Shape	
			Sale Date    7/30/2014	15.Front Foot							5.Access		
X <div>Date</div>			Price    70,000							6.Restriction			
			Sale Type    1 Land Only								7.Corner/Location		
			1.Land    4.Mobile    7.	Square Foot		Square Feet					8.View/Environment		
			2.L & B    5.Other    8.								9.Fract Share		
			3.Building    6.							10.Acres			
Notes: 2002 CREATED J/T WITH SON PREVIOUS BK2339 PG0330 2010-Release deed recorded. 7/31/14-Notice received from the attorney that this property sold to Anthony DelGaudio in Topsham. Bill for 2014 will be mailed to Mr. DelGaudio.			Financing    9 Unknown	Square Foot		Square Feet				11.Waterfront Real Estate			
			1.Convent    4.Seller    7.									12.Open Space	
			2.FHA/VA    5.Private    8.	16.Regular Lot						13.RestrictEsm			
			3.Assumed    6.Cash    9.Unknown	17.Secondary Site						14.PASTURE 1			
				18.Secondary Site						15.HORTICULTURAL-			
WISCASSET			Validity    1 Arms Length Sale	19.Condominium						16.Pasture 3			
			1.Valid    4.Split    7.Renovate	20.Base Homesite						17.Software			
			2.Related    5.Partial    8.Other	Fract. Acre						18.Mixed Wood			
			3.Distress    6.Exempt    9.Foreclose	21.HS Size Adj						19.Hardwood			
			Verified    5 Public Record	22.Base Waterfron						20.Wasteland			
			1.Buyer    4.Agent    7.Family	23.Deep WF Size A						21.CAMP SITE			
			2.Seller    5.Pub Rec    8.Other	Acres						22.Mobile Home Site			
			3.Lender    6.MLS    9.	24.Base Waterfron						23.Condo Site			
				25.Shallow WF Siz						24.Site Improvement			
				26.Base Water Inf						25.CAMP SITE			
				27.Influence W Si						26.PAVING/00			
				28.Rear Land 1-10	Total Acreage    7.00								
				29.Rear Land 11-2									



**WISCASSET**

Map Lot U19-012

Account 1820

Location 806 BATH ROAD

Card 1 Of 1 9/19/2022

Building Style			SF Bsmt Living			Layout		
1.Conv.	5.Colonial	9.Other	Fin Bsmt Grade			1.Typical 4. 7.		
2.Ranch	6.Split	10.Double	HEARTH			2.Inadeq 5. 8.		
3.R Ranch	7.Mod/Cont	11.Multi	Heat Type <b>100%</b>			3. 6. 9.		
4.Cape	8.Log	12.Cot.	1.HWBB 5.FWA 9.No Heat			Attic		
Dwelling Units			2.HWCI 6.GravWA 10.			1.1/4 Fin 4.Full Fin 7.		
Other Units			3.H Pump 7.Electric 11.			2.1/2 Fin 5.F/Stair 8.		
Stories			4.Steam 8.F/Wall 12.			3.3/4 Fin 6. 9.None		
1.1	4.1.5	7.	Cool Type <b>0%</b>			Insulation		
2.2	5.1.75	8.	1.Refrig 4.W&C Air 7.			1.Full 4.Minimal 7.		
3.3	6.2.5	9.	2.Evapor 5. 8.			2.Heavy 5.Unknown 8.		
Exterior Walls			3.H Pump 6. 9.None			3.Capped 6. 9.None		
1.CLAP	5.T-111	9.OTHER	Kitchen Style			Unfinished %		
2.WD SH	6.BR/STONE	10.	1.GOOD 4.Obsolete 7.			Grade & Factor		
3.COMP	7.NOV	11.	2.TYPICAL 5. 8.			1.E Grade 4.B Grade 7.AA+ Grad		
4.ASB/ASP	8.AL/VIN	12.	3.OLD TYPE 6. 9.None			2.D Grade 5.A Grade 8.AA++Grad		
Roof Surface			Bath(s) Style			3.C Grade 6.AA Grade 9.Same		
1.Asphalt	4.Composit	7.	1.GOOD 4.Obsolete 7.			SQFT (Footprint)		
2.Slate	5.Wood	8.	2.TYPICAL 5. 8.			Condition		
3.Metal	6.Other	9.	3.Old Type 6. 9.None			1.Poor 4.Avg 7.V G		
SF Masonry Trim			# Rooms			2.Fair 5.Avg+ 8.Exc		
OPEN-3-CUSTOM			# Bedrooms			3.Avg- 6.Good 9.Same		
OPEN-4-CUSTOM			# Full Baths			Phys. % Good		
Year Built			# Half Baths			Funct. % Good		
Year Remodeled			# Addn Fixtures			Functional Code		
Foundation			# Fireplaces			1.Incomp 4.SMALL 7.LAYOUT		
1.Concrete	4.Wood	7.				2.O-Built 5.CDU 8.OTHER		
2.C Block	5.Slab	8.				3.Defmaint 6.STYLE 9.None		
3.Br/Stone	6.Piers	9.				Econ. % Good		
Basement						Economic Code		
1.1/4 Bmt	4.Full Bmt	7.				0.None 3.Services 9.None		
2.1/2 Bmt	5.None	8.	1.Location 4.Traffic 8.					
3.3/4 Bmt	6.	9.None				2.Encroach 8.Other 9.		
Bsmt Gar # Cars						Entrance Code <b>4 Unoccupied</b>		
Wet Basement						1.Interior 4.Vacant 7.		
1.Dry	4.	7.				2.Refusal 5.Estimate 8.		
2.Damp	5.	8.				3.Informed 6. 9.		
3.Wet	6.	9.				Information Code <b>5 Estimate</b>		
						1.Owner 4.Agent 7.		
						2.Relative 5.Estimate 8.		
						3.Tenant 6.Other 9.		
Date Inspected								
<b>Additions, Outbuildings &amp; Improvements</b>								1.ONE STORY FRAM
Type	Year	Units	Grade	Cond	Phys.	Funct.	Sound Value	2.TWO STORY FRAM
					%	%		3.THREE STORY FR
					%	%		4.1 & 1/2 STORY
					%	%		5.1 & 3/4 STORY
					%	%		6.2 & 1/2 STORY
					%	%		21.Open Frame Por
					%	%		22.Encl Frame Por
					%	%		23.Frame Garage
					%	%		24.Frame Shed
					%	%		25.Frame Bay Wind
					%	%		26.1SFr Overhang
					%	%		27.Unfin Basement
					%	%		28.Unfinished Att
					%	%		29.Finished Attic



Property Data			Assessment Record						
Neighborhood    109 SOUTHEAST			Year	Land	Buildings	Exempt	Total		
Tree Growth Year    0			2009	36,780	271,220	19,000	289,000		
FARM LAND YEAR    0			2010	36,800	271,200	16,000	292,000		
OPEN SPACE YEAR    0			2011	36,800	271,200	16,000	292,000		
Zone/Land Use    21 RURAL			2012	36,800	271,200	16,000	292,000		
Secondary Zone			2013	36,800	271,200	16,000	292,000		
			2014	36,800	271,200	16,000	292,000		
Topography    3 Above Street			2015	36,800	271,200	16,000	292,000		
1.Level	4.Below St	7.Steep	2016	36,800	271,200	21,000	287,000		
2.Rolling	5.Low	8.Rough	2017	36,800	271,200	26,000	282,000		
3.Above St	6.Swampy	9.	2018	36,800	271,200	26,000	282,000		
Utilities	4 Drilled Well	6 Septic System	2019	36,800	271,200	26,000	282,000		
1.Public	4.Dr Well	7.Cesspool	2020	36,800	271,200	31,000	277,000		
2.Water	5.DUG/LAKE	8.	2021	36,800	271,200	31,000	277,000		
3.Sewer	6.Septic	9.None	2022	36,800	271,200	29,760	278,240		
Street    1 Paved			Land Data						
1.Paved	4.Proposed	7.	Front Foot	Type	Effective		Influence		Influence Codes
2.Semi Imp	5.Private	8.			Frontage	Depth	Factor	Code	
3.Gravel	6.Pub Eas	9.NoStreet				%		1.Open Space	
TREE GROWTH PLAN    0						%		2.Neighborhood A	
CONSERV   EASE    0						%		3.Topography	
Sale Data						%		4.Size/Shape	
Price						%		5.Access	
Sale Type						%		6.Restriction	
1.Land	4.Mobile	7.	Square Foot	Square Feet				7.Corner/Locatio	
2.L & B	5.Other	8.				%		8.View/Environ	
3.Building	6.	9.				%		9.Fract   Share	
Financing						%		Acre	
1.Convent	4.Seller	7.				%		30.Rear 20+	
2.FHA/VA	5.Private	8.				%		31.Waterfront Rea	
3.Assumed	6.Cash	9.Unknown				%		32.Open Space	
Validity						%		33.RestrictEsm	
1.Valid	4.Split	7.Renovate	Fract. Acre	Acreege/Sites			34.PASTURE 1		
2.Related	5.Partial	8.Other			20	1.00	100	%	0
3.Distress	6.Exempt	9.Foreclose		21	1.00	100	%	0	36.Pasture 3
Verified				28	0.24	100	%	0	37.Softwood
1.Buyer	4.Agent	7.Family				%			38.Mixed Wood
2.Seller	5.Pub Rec	8.Other				%			39.Hardwood
3.Lender	6.MLS	9.				%			40.Wasteland
						%			41.CAMP SITE
			Total Acreage		1.24			42.Mobile Home Si	
								43.Condo Site	
								44.Site Improve	
								45.CAMP SITE	
								46.PAVING/00	

# WISCASSET

Map Lot U19-013



Account 1821

Location 22 SHADY LANE

Card 1

Of 1

9/19/2022

Building Style <b>11 Multi Family</b>	SF Bsmt Living <b>200</b>	Layout <b>1 Typical</b>
1.Conv. 5.Colonial 9.Other	Fin Bsmt Grade <b>9 100</b>	1.Typical 4. 7.
2.Ranch 6.Split 10.Double	HEARTH <b>2</b>	2.Inadeq 5. 8.
3.R Ranch 7.Mod/Cont 11.Multi	Heat Type <b>100% 1 Hot Water BB</b>	3. 6. 9.
4.Cape 8.Log 12.Cot.	1.HWBB 5.FWA 9.No Heat	Attic <b>9 None</b>
Dwelling Units <b>2</b>	2.HWCI 6.GravWA 10.	1.1/4 Fin 4.Full Fin 7.
Other Units <b>0</b>	3.H Pump 7.Electric 11.	2.1/2 Fin 5.F/Stair 8.
Stories <b>2 Two Story</b>	4.Steam 8.F/Wall 12.	3.3/4 Fin 6. 9.None
1.1 4.1.5 7.	Cool Type <b>0% 9 None</b>	Insulation <b>1 Full</b>
2.2 5.1.75 8.	1.Refrig 4.W&C Air 7.	1.Full 4.Minimal 7.
3.3 6.2.5 9.	2.Evapor 5. 8.	2.Heavy 5.Unknown 8.
Exterior Walls <b>2 WOOD SHINGLE</b>	3.H Pump 6. 9.None	3.Capped 6. 9.None
1.CLAP 5.T-111 9.OTHER	Kitchen Style <b>2 TYPICAL</b>	Unfinished % <b>0%</b>
2.WD SH 6.BR/STONE 10.	1.GOOD 4.Obsolete 7.	Grade & Factor <b>4 Good 100%</b>
3.COMP 7.NOV 11.	2.TYPICAL 5. 8.	1.E Grade 4.B Grade 7.AA+ Grad
4.ASB/ASP 8.AL/VIN 12.	3.OLD TYPE 6. 9.None	2.D Grade 5.A Grade 8.AA++Grad
Roof Surface <b>1 Asphalt Shingles</b>	Bath(s) Style <b>2 TYPICAL</b>	3.C Grade 6.AA Grade 9.Same
1.Asphalt 4.Composit 7.	1.GOOD 4.Obsolete 7.	SQFT (Footprint) <b>1392</b>
2.Slate 5.Wood 8.	2.TYPICAL 5. 8.	Condition <b>5 Above Average</b>
3.Metal 6.Other 9.	3.Old Type 6. 9.None	1.Poor 4.Avg 7.V G
SF Masonry Trim <b>0</b>	# Rooms <b>10</b>	2.Fair 5.Avg+ 8.Exc
OPEN-3-CUSTOM <b>0</b>	# Bedrooms <b>4</b>	3.Avg- 6.Good 9.Same
OPEN-4-CUSTOM <b>0</b>	# Full Baths <b>3</b>	Phys. % Good <b>0%</b>
Year Built <b>1988</b>	# Half Baths <b>1</b>	Funct. % Good <b>100%</b>
Year Remodeled <b>0</b>	# Addn Fixtures <b>0</b>	Functional Code <b>1 Incomplete</b>
Foundation <b>1 Concrete</b>	# Fireplaces <b>0</b>	1.Incomp 4.SMALL 7.LAYOUT
1.Concrete 4.Wood 7.		2.O-Built 5.CDU 8.OTHER
2.C Block 5.Slab 8.		3.Defmaint 6.STYLE 9.None
3.Br/Stone 6.Piers 9.		Econ. % Good <b>100%</b>
Basement <b>4 Full Basement</b>		Economic Code <b>Location</b>
1.1/4 Bmt 4.Full Bmt 7.		0.None 3.Services 9.None
2.1/2 Bmt 5.None 8.		1.Location 4.Traffic 8.
3.3/4 Bmt 6. 9.None		2.Encroach 8.Other 9.
Bsmt Gar # Cars <b>0</b>		Entrance Code <b>1 Interior Inspect</b>
Wet Basement <b>1 Dry Basement</b>		1.Interior 4.Vacant 7.
1.Dry 4. 7.		2.Refusal 5.Estimate 8.
2.Damp 5. 8.		3.Informed 6. 9.
3.Wet 6. 9.		Information Code <b>1 Owner</b>
		1.Owner 4.Agent 7.
		2.Relative 5.Estimate 8.
		3.Tenant 6.Other 9.

Date Inspected 3/23/2007

## Additions, Outbuildings & Improvements

Type	Year	Units	Grade	Cond	Phys.	Funct.	Sound Value	
79 2 STORY	0	660	3 100	4	0 %	80 %		1.ONE STORY FRAM
2 TWO STORY	0	140	0 0	0	0 %	0 %		2.TWO STORY FRAM
26 1SFr Overhang	0	14	0 0	0	0 %	0 %		3.THREE STORY FR
22 Encl Frame Porch	0	20	0 0	0	0 %	0 %		4.1 & 1/2 STORY
68 Wood Deck	0	196	0 0	0	0 %	0 %		5.1 & 3/4 STORY
68 Wood Deck	0	210	0 0	0	0 %	0 %		6.2 & 1/2 STORY
26 1SFr Overhang	0	24	0 0	0	0 %	0 %		21.Open Frame Por
26 1SFr Overhang	0	5	0 0	0	0 %	0 %		22.Encl Frame Por
					%	%		23.Frame Garage
					%	%		24.Frame Shed
					%	%		25.Frame Bay Wind
					%	%		26.1SFr Overhang
					%	%		27.Unfin Basement
					%	%		28.Unfinished Att
					%	%		29.Finished Attic

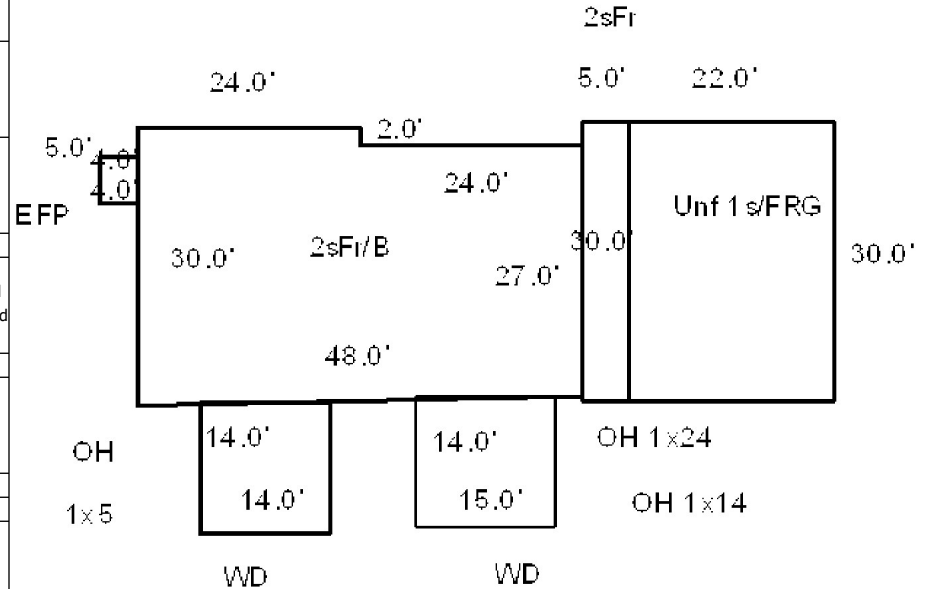

Map Lot U19-014

Account 1822

Location 16 SHADY LANE

Card 1 Of 1 9/19/2022

DALTON, ZACHARY A  
DALTON, PETER R  
16 SHADY LANE  
WISCASSET ME 04578

B1723P205 B4664P31 B4939P205 B4946P261

Previous Owner  
LEMAR, GREGORY L.  
P.O. BOX 598

WISCASSET ME 04578  
Sale Date: 10/27/2015

Previous Owner  
CRONK, WILFORD S. (DEVISEES)  
BAILEY J,CRONK W,CRONK D,BERGERON S, PINKHAM D  
C/O DAVID L. CRONK  
WISCASSET ME 04578  
Sale Date: 10/02/2015

Inspection Witnessed By:

X

Date

No./Date	Description	Date Insp.

Notes:

2002-24 X 26 GARAGE ADDED

2013-Mr. Cronk passed away March 25, 2013. Removed  
homestead and veterans exemption.

WISCASSET

## Property Data

Neighborhood	109 SOUTHEAST		
Tree Growth Year	0		
FARM LAND YEAR	0		
OPEN SPACE YEAR	0		
Zone/Land Use	21 RURAL		
Secondary Zone			
Topography	3 Above Street		
1.Level	4.Below St	7.Steep	
2.Rolling	5.Low	8.Rough	
3.Above St	6.Swampy	9.	
Utilities	4 Drilled Well	6 Septic System	
1.Public	4.Dr Well	7.Cesspool	
2.Water	5.DUG/LAKE	8.	
3.Sewer	6.Septic	9.None	
Street	1 Paved		
1.Paved	4.Proposed	7.	
2.Semi Imp	5.Private	8.	
3.Gravel	6.Pub Eas	9.NoStreet	
TREE GROWTH PLAN	0		
CONSERV EASE	0		
Sale Data			
Sale Date	10/27/2015		
Price	115,000		
Sale Type	2 Land & Buildings		
1.Land	4.Mobile	7.	
2.L & B	5.Other	8.	
3.Building	6.	9.	
Financing	9 Unknown		
1.Convent	4.Seller	7.	
2.FHA/VA	5.Private	8.	
3.Assumed	6.Cash	9.Unknown	
Validity	1 Arms Length Sale		
1.Valid	4.Split	7.Renovate	
2.Related	5.Partial	8.Other	
3.Distress	6.Exempt	9.Foreclose	
Verified	5 Public Record		
1.Buyer	4.Agent	7.Family	
2.Seller	5.Pub Rec	8.Other	
3.Lender	6.MLS	9.	

## Assessment Record

Year	Land	Buildings	Exempt	Total
2009	34,950	112,380	19,000	128,330
2010	34,900	79,600	16,000	98,500
2011	34,900	79,600	16,000	98,500
2012	34,900	79,600	16,000	98,500
2013	34,900	79,600	0	114,500
2014	34,900	79,600	0	114,500
2015	34,900	79,600	0	114,500
2016	34,900	79,600	0	114,500
2017	34,900	79,600	0	114,500
2018	34,900	79,600	0	114,500
2019	34,900	79,600	0	114,500
2020	34,900	79,600	0	114,500
2021	34,900	79,600	0	114,500
2022	34,900	79,600	0	114,500

## Land Data

Front Foot	Type	Effective		Influence		Influence Codes
		Frontage	Depth	Factor	Code	
11.Regular Lot				%		1.Open Space
12.Delta Triangle				%		2.Neighborhood A
13.Nabla Triangle				%		3.Topography
14.Rear Land				%		4.Size/Shape
15.Front Foot				%		5.Access
				%		6.Restriction
				%		7.Corner/Locatio
				%		8.View/Environ
				%		9.Fract Share
				%		Acres
				%		30.Rear 20+
				%		31.Waterfront Rea
				%		32.Open Space
				%		33.RestrictEsm
				%		34.PASTURE 1
				%		35.HORTICULTURAL-
				%		36.Pasture 3
				%		37.Softwood
				%		38.Mixed Wood
				%		39.Hardwood
				%		40.Wasteland
				%		41.CAMP SITE
				%		42.Mobile Home Si
				%		43.Condo Site
				%		44.Site Improve
				%		45.CAMP SITE
				%		46.PAVING/00
Total Acreage		0.59				

## Front Foot

11.Regular Lot  
12.Delta Triangle  
13.Nabla Triangle  
14.Rear Land  
15.Front Foot

## Square Foot

16.Regular Lot  
17.Secondary Site  
18.Secondary Site  
19.Condominium  
20.Base Homesite

## Fract. Acre

21.HS Size Adj  
22.Base Waterfron  
23.Deep WF Size A

## Acres

24.Base Waterfron  
25.Shallow WF Siz  
26.Base Water Inf  
27.Influence W Si  
28.Rear Land 1-10  
29.Rear Land 11-2

## Type

11.Regular Lot  
12.Delta Triangle  
13.Nabla Triangle  
14.Rear Land  
15.Front Foot

## Square Feet

16.Regular Lot  
17.Secondary Site  
18.Secondary Site  
19.Condominium  
20.Base Homesite

## Fract. Acre

21.HS Size Adj  
22.Base Waterfron  
23.Deep WF Size A

## Acres

24.Base Waterfron  
25.Shallow WF Siz  
26.Base Water Inf  
27.Influence W Si  
28.Rear Land 1-10  
29.Rear Land 11-2

## Effective

11.Regular Lot  
12.Delta Triangle  
13.Nabla Triangle  
14.Rear Land  
15.Front Foot

## Square Feet

16.Regular Lot  
17.Secondary Site  
18.Secondary Site  
19.Condominium  
20.Base Homesite

## Fract. Acre

21.HS Size Adj  
22.Base Waterfron  
23.Deep WF Size A

## Acres

24.Base Waterfron  
25.Shallow WF Siz  
26.Base Water Inf  
27.Influence W Si  
28.Rear Land 1-10  
29.Rear Land 11-2

## Influence

11.Regular Lot  
12.Delta Triangle  
13.Nabla Triangle  
14.Rear Land  
15.Front Foot

## Square Feet

16.Regular Lot  
17.Secondary Site  
18.Secondary Site  
19.Condominium  
20.Base Homesite

## Fract. Acre

21.HS Size Adj  
22.Base Waterfron  
23.Deep WF Size A

## Acres

24.Base Waterfron  
25.Shallow WF Siz  
26.Base Water Inf  
27.Influence W Si  
28.Rear Land 1-10  
29.Rear Land 11-2

## Influence Codes

1.Open Space  
2.Neighborhood A  
3.Topography  
4.Size/Shape  
5.Access  
6.Restriction  
7.Corner/Locatio  
8.View/Environ  
9.Fract Share  
Acres  
30.Rear 20+  
31.Waterfront Rea  
32.Open Space  
33.RestrictEsm  
34.PASTURE 1  
35.HORTICULTURAL-  
36.Pasture 3  
37.Softwood  
38.Mixed Wood  
39.Hardwood  
40.Wasteland  
41.CAMP SITE  
42.Mobile Home Si  
43.Condo Site  
44.Site Improve  
45.CAMP SITE  
46.PAVING/00

# WISCASSET

Map Lot U19-014

Account 1822

Location 16 SHADY LANE

Card 1 Of 1 9/19/2022

Building Style <b>10 Double Wide</b>	SF Bsmt Living <b>0</b>	Layout <b>1 Typical</b>
1.Conv. 5.Colonial 9.Other	Fin Bsmt Grade <b>0 0</b>	1.Typical 4. 7.
2.Ranch 6.Split 10.Double	HEARTH <b>0</b>	2.Inadeq 5. 8.
3.R Ranch 7.Mod/Cont 11.Multi	Heat Type <b>100% 5 Forced Warm Air</b>	3. 6. 9.
4.Cape 8.Log 12.Cot.	1.HWBB 5.FWA 9.No Heat	Attic <b>9 None</b>
Dwelling Units <b>1</b>	2.HWCI 6.GravWA 10.	1.1/4 Fin 4.Full Fin 7.
Other Units <b>0</b>	3.H Pump 7.Electric 11.	2.1/2 Fin 5.F/Stair 8.
Stories <b>1 One Story</b>	4.Steam 8.F/Wall 12.	3.3/4 Fin 6. 9.None
1.1 4.1.5 7.	Cool Type <b>0% 9 None</b>	Insulation <b>1 Full</b>
2.2 5.1.75 8.	1.Refrig 4.W&C Air 7.	1.Full 4.Minimal 7.
3.3 6.2.5 9.	2.Evapor 5. 8.	2.Heavy 5.Unknown 8.
Exterior Walls <b>8 ALUM/VINYL</b>	3.H Pump 6. 9.None	3.Capped 6. 9.None
1.CLAP 5.T-111 9.OTHER	Kitchen Style <b>2 TYPICAL</b>	Unfinished % <b>0%</b>
2.WD SH 6.BR/STONE 10.	1.GOOD 4.Obsolete 7.	Grade & Factor <b>2 Fair 100%</b>
3.COMP 7.NOV 11.	2.TYPICAL 5. 8.	1.E Grade 4.B Grade 7.AA+ Grad
4.ASB/ASP 8.AL/VIN 12.	3.OLD TYPE 6. 9.None	2.D Grade 5.A Grade 8.AA++Grad
Roof Surface <b>1 Asphalt Shingles</b>	Bath(s) Style <b>2 TYPICAL</b>	3.C Grade 6.AA Grade 9.Same
1.Asphalt 4.Composit 7.	1.GOOD 4.Obsolete 7.	SQFT (Footprint) <b>1152</b>
2.Slate 5.Wood 8.	2.TYPICAL 5. 8.	Condition <b>4 Average</b>
3.Metal 6.Other 9.	3.Old Type 6. 9.None	1.Poor 4.Avg 7.V G
SF Masonry Trim <b>0</b>	# Rooms <b>5</b>	2.Fair 5.Avg+ 8.Exc
OPEN-3-CUSTOM <b>0</b>	# Bedrooms <b>3</b>	3.Avg- 6.Good 9.Same
OPEN-4-CUSTOM <b>0</b>	# Full Baths <b>2</b>	Phys. % Good <b>0%</b>
Year Built <b>1994</b>	# Half Baths <b>0</b>	Funct. % Good <b>100%</b>
Year Remodeled <b>0</b>	# Addn Fixtures <b>0</b>	Functional Code <b>9 None</b>
Foundation <b>1 Concrete</b>	# Fireplaces <b>1</b>	1.Incomp 4.SMALL 7.LAYOUT
1.Concrete 4.Wood 7.		2.O-Built 5.CDU 8.OTHER
2.C Block 5.Slab 8.		3.Defmaint 6.STYLE 9.None
3.Br/Stone 6.Piers 9.		Econ. % Good <b>100%</b>
Basement <b>4 Full Basement</b>		Economic Code <b>None</b>
1.1/4 Bmt 4.Full Bmt 7.		0.None 3.Services 9.None
2.1/2 Bmt 5.None 8.		1.Location 4.Traffic 8.
3.3/4 Bmt 6. 9.None		2.Encroach 8.Other 9.
Bsmt Gar # Cars <b>0</b>		Entrance Code <b>1 Interior Inspect</b>
Wet Basement <b>1 Dry Basement</b>		1.Interior 4.Vacant 7.
1.Dry 4. 7.		2.Refusal 5.Estimate 8.
2.Damp 5. 8.		3.Informed 6. 9.
3.Wet 6. 9.		Information Code <b>1 Owner</b>
		1.Owner 4.Agent 7.
		2.Relative 5.Estimate 8.
		3.Tenant 6.Other 9.

GARAGE 24X26

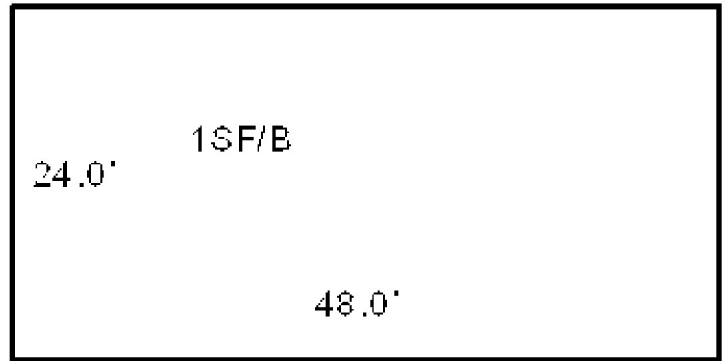

Date Inspected 3/15/2007

## Additions, Outbuildings & Improvements

Type	Year	Units	Grade	Cond	Phys.	Funct.	Sound Value	
23 Frame Garage	2001	624	3 100	4	0 %	100 %		1.ONE STORY FRAM
					%	%		2.TWO STORY FRAM
					%	%		3.THREE STORY FR
					%	%		4.1 & 1/2 STORY
					%	%		5.1 & 3/4 STORY
					%	%		6.2 & 1/2 STORY
					%	%		21.Open Frame Por
					%	%		22.Encl Frame Por
					%	%		23.Frame Garage
					%	%		24.Frame Shed
					%	%		25.Frame Bay Wind
					%	%		26.1SFr Overhang
					%	%		27.Unfin Basement
					%	%		28.Unfinished Att
					%	%		29.Finished Attic



Map Lot U19-015

Account 1823

Location 61 SHADY LANE

Card 1 Of 1 9/19/2022

FISHER, DONALD G J/T  
FISHER, DEBRA A  
WISCASSET ME 04578

B4058P118

Previous Owner  
WILLIAMS, DARREN M.

61 SHADY LANE  
WISCASSET ME 04578  
Sale Date: 9/30/2008

Inspection Witnessed By:

X

Date

No./Date	Description	Date Insp.

Notes:

2002-PREVIOUS OWNER:DARREN & TAMELA WILLIAMS  
BK2019 PG0253 & BK2713 PG290. BOUGHT LAND ONLY IN  
1994 FOR \$18,000.

2009-Previous owner: Darren M. Williams BK2713 PG290.

WISCASSET

### Property Data

Neighborhood	109 SOUTHEAST		
Tree Growth Year	0		
FARM LAND YEAR	0		
OPEN SPACE YEAR	0		
Zone/Land Use	21 RURAL		
Secondary Zone			
Topography	1 Level		
1.Level	4.Below St	7.Steep	
2.Rolling	5.Low	8.Rough	
3.Above St	6.Swampy	9.	
Utilities	1 All Public		
1.Public	4.Dr Well	7.Cesspool	
2.Water	5.DUG/LAKE	8.	
3.Sewer	6.Septic	9.None	
Street	1 Paved		
1.Paved	4.Proposed	7.	
2.Semi Imp	5.Private	8.	
3.Gravel	6.Pub Eas	9.NoStreet	
TREE GROWTH PLAN	0		
CONSERV EASE	0		
Sale Data			
Sale Date	9/30/2008		
Price	165,000		
Sale Type	2 Land & Buildings		
1.Land	4.Mobile	7.	
2.L & B	5.Other	8.	
3.Building	6.	9.	
Financing	9 Unknown		
1.Convent	4.Seller	7.	
2.FHA/VA	5.Private	8.	
3.Assumed	6.Cash	9.Unknown	
Validity	1 Arms Length Sale		
1.Valid	4.Split	7.Renovate	
2.Related	5.Partial	8.Other	
3.Distress	6.Exempt	9.Foreclose	
Verified	5 Public Record		
1.Buyer	4.Agent	7.Family	
2.Seller	5.Pub Rec	8.Other	
3.Lender	6.MLS	9.	

### Assessment Record

Year	Land	Buildings	Exempt	Total
2009	36,880	128,400	0	165,280
2010	36,900	128,400	10,000	155,300
2011	36,900	128,400	10,000	155,300
2012	36,900	128,400	10,000	155,300
2013	36,900	128,400	10,000	155,300
2014	36,900	128,400	10,000	155,300
2015	36,900	128,400	10,000	155,300
2016	36,900	128,400	15,000	150,300
2017	36,900	128,400	20,000	145,300
2018	36,900	128,400	20,000	145,300
2019	36,900	128,400	20,000	145,300
2020	36,900	128,400	25,000	140,300
2021	36,900	128,400	25,000	140,300
2022	36,900	128,400	24,000	141,300

### Land Data

Front Foot	Type	Effective		Influence		Influence Codes
		Frontage	Depth	Factor	Code	
11.Regular Lot				%		1.Open Space
12.Delta Triangle				%		2.Neighborhood A
13.Nabla Triangle				%		3.Topography
14.Rear Land				%		4.Size/Shape
15.Front Foot				%		5.Access
				%		6.Restriction
				%		7.Corner/Locatio
				%		8.View/Environ
				%		9.Fract Share
				%		Acres
				%		30.Rear 20+
				%		31.Waterfront Rea
				%		32.Open Space
				%		33.RestrictEsm
				%		34.PASTURE 1
				%		35.HORTICULTURAL-
				%		36.Pasture 3
				%		37.Softwood
				%		38.Mixed Wood
				%		39.Hardwood
				%		40.Wasteland
				%		41.CAMP SITE
				%		42.Mobile Home Si
				%		43.Condo Site
				%		44.Site Improve
				%		45.CAMP SITE
				%		46.PAVING/00
Total Acreage		1.29				





# WISCASSET

Map Lot U19-015

Account 1823

Location 61 SHADY LANE

Card 1 Of 1 9/19/2022

Building Style <b>2 Ranch</b>	SF Bsmt Living <b>0</b>	Layout <b>1 Typical</b>
1.Conv. 5.Colonial 9.Other	Fin Bsmt Grade <b>0 0</b>	1.Typical 4. 7.
2.Ranch 6.Split 10.Double	HEARTH <b>0</b>	2.Inadeq 5. 8.
3.R Ranch 7.Mod/Cont 11.Multi	Heat Type <b>100% 1 Hot Water BB</b>	3. 6. 9.
4.Cape 8.Log 12.Cot.	1.HWBB 5.FWA 9.No Heat	Attic <b>9 None</b>
Dwelling Units <b>1</b>	2.HWCI 6.GravWA 10.	1.1/4 Fin 4.Full Fin 7.
Other Units <b>0</b>	3.H Pump 7.Electric 11.	2.1/2 Fin 5.F/Stair 8.
Stories <b>1 One Story</b>	4.Steam 8.F/Wall 12.	3.3/4 Fin 6. 9.None
1.1 4.1.5 7.	Cool Type <b>0% 9 None</b>	Insulation <b>1 Full</b>
2.2 5.1.75 8.	1.Refrig 4.W&C Air 7.	1.Full 4.Minimal 7.
3.3 6.2.5 9.	2.Evapor 5. 8.	2.Heavy 5.Unknown 8.
Exterior Walls <b>8 ALUM/VINYL</b>	3.H Pump 6. 9.None	3.Capped 6. 9.None
1.CLAP 5.T-111 9.OTHER	Kitchen Style <b>2 TYPICAL</b>	Unfinished % <b>0%</b>
2.WD SH 6.BR/STONE 10.	1.GOOD 4.Obsolete 7.	Grade & Factor <b>3 Average 100%</b>
3.COMP 7.NOV 11.	2.TYPICAL 5. 8.	1.E Grade 4.B Grade 7.AA+ Grad
4.ASB/ASP 8.AL/VIN 12.	3.OLD TYPE 6. 9.None	2.D Grade 5.A Grade 8.AA++Grad
Roof Surface <b>1 Asphalt Shingles</b>	Bath(s) Style <b>2 TYPICAL</b>	3.C Grade 6.AA Grade 9.Same
1.Asphalt 4.Composit 7.	1.GOOD 4.Obsolete 7.	SQFT (Footprint) <b>1512</b>
2.Slate 5.Wood 8.	2.TYPICAL 5. 8.	Condition <b>4 Average</b>
3.Metal 6.Other 9.	3.Old Type 6. 9.None	1.Poor 4.Avg 7.V G
SF Masonry Trim <b>0</b>	# Rooms <b>6</b>	2.Fair 5.Avg+ 8.Exc
OPEN-3-CUSTOM <b>0</b>	# Bedrooms <b>3</b>	3.Avg- 6.Good 9.Same
OPEN-4-CUSTOM <b>0</b>	# Full Baths <b>2</b>	Phys. % Good <b>0%</b>
Year Built <b>1994</b>	# Half Baths <b>0</b>	Funct. % Good <b>100%</b>
Year Remodeled <b>0</b>	# Addn Fixtures <b>0</b>	Functional Code <b>9 None</b>
Foundation <b>1 Concrete</b>	# Fireplaces <b>0</b>	1.Incomp 4.SMALL 7.LAYOUT
1.Concrete 4.Wood 7.		2.O-Built 5.CDU 8.OTHER
2.C Block 5.Slab 8.		3.Defmaint 6.STYLE 9.None
3.Br/Stone 6.Piers 9.		Econ. % Good <b>100%</b>
Basement <b>4 Full Basement</b>		Economic Code <b>None</b>
1.1/4 Bmt 4.Full Bmt 7.		0.None 3.Services 9.None
2.1/2 Bmt 5.None 8.		1.Location 4.Traffic 8.
3.3/4 Bmt 6. 9.None		2.Encroach 8.Other 9.
Bsmt Gar # Cars <b>0</b>		Entrance Code <b>5 Estimated</b>
Wet Basement <b>1 Dry Basement</b>		1.Interior 4.Vacant 7.
1.Dry 4. 7.		2.Refusal 5.Estimate 8.
2.Damp 5. 8.		3.Informed 6. 9.
3.Wet 6. 9.		Information Code <b>5 Estimate</b>
		1.Owner 4.Agent 7.
		2.Relative 5.Estimate 8.
		3.Tenant 6.Other 9.

Date Inspected 12/08/2006

## Additions, Outbuildings & Improvements

Type	Year	Units	Grade	Cond	Phys.	Funct.	Sound Value	
68 Wood Deck	0	100	0 0	0	0 %	0 %		1.ONE STORY FRAM
68 Wood Deck	2004	128	3 100	4	0 %	100 %		2.TWO STORY FRAM
					%	%		3.THREE STORY FR
					%	%		4.1 & 1/2 STORY
					%	%		5.1 & 3/4 STORY
					%	%		6.2 & 1/2 STORY
					%	%		21.Open Frame Por
					%	%		22.Encl Frame Por
					%	%		23.Frame Garage
					%	%		24.Frame Shed
					%	%		25.Frame Bay Wind
					%	%		26.1SFr Overhang
					%	%		27.Unfin Basement
					%	%		28.Unfinished Att
					%	%		29.Finished Attic

