

[illegible]

WISCASSET

Map Lot U08-001

Account 1558

Location WHITES ISLAND

Card 1 Of 1 9/15/2022

Building Style			SF Bsmt Living			Layout		
1.Conv.	5.Colonial	9.Other	Fin Bsmt Grade			1.Typical 4. 7.		
2.Ranch	6.Split	10.Double	HEARTH			2.Inadeq 5. 8.		
3.R Ranch	7.Mod/Cont	11.Multi	Heat Type 0%			3. 6. 9.		
4.Cape	8.Log	12.Cot.	1.HWBB 5.FWA 9.No Heat			Attic		
Dwelling Units			2.HWCI 6.GravWA 10.			1.1/4 Fin 4.Full Fin 7.		
Other Units			3.H Pump 7.Electric 11.			2.1/2 Fin 5.F/Stair 8.		
Stories			4.Steam 8.F/Wall 12.			3.3/4 Fin 6. 9.None		
1.1	4.1.5	7.	Cool Type 0%			Insulation		
2.2	5.1.75	8.	1.Refrig 4.W&C Air 7.			1.Full 4.Minimal 7.		
3.3	6.2.5	9.	2.Evapor 5. 8.			2.Heavy 5.Unknown 8.		
Exterior Walls			3.H Pump 6. 9.None			3.Capped 6. 9.None		
1.CLAP	5.T-111	9.OTHER	Kitchen Style			Unfinished %		
2.WD SH	6.BR/STONE	10.	1.GOOD 4.Obsolete 7.			Grade & Factor		
3.COMP	7.NOV	11.	2.TYPICAL 5. 8.			1.E Grade 4.B Grade 7.AA+ Grad		
4.ASB/ASP	8.AL/VIN	12.	3.OLD TYPE 6. 9.None			2.D Grade 5.A Grade 8.AA++Grad		
Roof Surface			Bath(s) Style			3.C Grade 6.AA Grade 9.Same		
1.Asphalt	4.Composit	7.	1.GOOD 4.Obsolete 7.			SQFT (Footprint)		
2.Slate	5.Wood	8.	2.TYPICAL 5. 8.			Condition		
3.Metal	6.Other	9.	3.Old Type 6. 9.None			1.Poor 4.Avg 7.V G		
SF Masonry Trim			# Rooms			2.Fair 5.Avg+ 8.Exc		
OPEN-3-CUSTOM			# Bedrooms			3.Avg- 6.Good 9.Same		
OPEN-4-CUSTOM			# Full Baths			Phys. % Good		
Year Built			# Half Baths			Funct. % Good		
Year Remodeled			# Addn Fixtures			Functional Code		
Foundation			# Fireplaces			1.Incomp 4.SMALL 7.LAYOUT		
1.Concrete	4.Wood	7.				2.O-Built 5.CDU 8.OTHER		
2.C Block	5.Slab	8.				3.Defmait 6.STYLE 9.None		
3.Br/Stone	6.Piers	9.				Econ. % Good		
Basement						Economic Code		
1.1/4 Bmt	4.Full Bmt	7.				0.None 3.Services 9.None		
2.1/2 Bmt	5.None	8.				1.Location 4.Traffic 8.		
3.3/4 Bmt	6.	9.None				2.Encroach 8.Other 9.		
Bsmt Gar # Cars						Entrance Code 4 Unoccupied		
Wet Basement						1.Interior 4.Vacant 7.		
1.Dry	4.	7.				2.Refusal 5.Estimate 8.		
2.Damp	5.	8.	3.Informed 6. 9.					
3.Wet	6.	9.	Information Code 5 Estimate					
Date Inspected 11/30/2006			1.Owner 4.Agent 7.			2.Relative 5.Estimate 8.		
			2.Relative 5.Estimate 8.			3.Tenant 6.Other 9.		
Additions, Outbuildings & Improvements								1.ONE STORY FRAM
Type	Year	Units	Grade	Cond	Phys.	Funct.	Sound Value	2.TWO STORY FRAM
					%	%		3.THREE STORY FR
					%	%		4.1 & 1/2 STORY
					%	%		5.1 & 3/4 STORY
					%	%		6.2 & 1/2 STORY
					%	%		21.Open Frame Por
					%	%		22.Encl Frame Por
					%	%		23.Frame Garage
					%	%		24.Frame Shed
					%	%		25.Frame Bay Wind
					%	%		26.1SFr Overhang
					%	%		27.Unfin Basement
					%	%		28.Unfinished Att
					%	%		29.Finished Attic

Map Lot		U08-002		Account		1559		Location		96 BATH ROAD		Card		1		Of		1		9/15/2022	
HAYWOOD, RICHARD G HAYWOOD, AMBER ST CLAIRE 96 BATH ROAD WISCASSET ME 04578 B2685P187 B5042P190 Previous Owner BRYNJOLFSSON, BARRY E. (J/T) BRYNJOLFSSON, LESLEY G. BRADENTON FL 34203 Sale Date: 7/22/2016								Property Data				Assessment Record									
								Neighborhood 101 VILLAGE				Year		Land		Buildings		Exempt		Total	
								Tree Growth Year 0				2009		603,600		247,780		0		851,380	
								FARM LAND YEAR 0				2010		603,600		247,800		0		851,400	
								OPEN SPACE YEAR 0				2011		550,300		247,800		0		798,100	
B2685P187 B5042P190 Previous Owner BRYNJOLFSSON, BARRY E. (J/T) BRYNJOLFSSON, LESLEY G. BRADENTON FL 34203 Sale Date: 7/22/2016								Zone/Land Use 14 SHORE RESIDENTIA				2012		193,700		199,700		0		393,400	
								Secondary Zone				2013		193,700		199,700		0		393,400	
												2014		193,700		199,700		0		393,400	
								Topography 2 Rolling				2015		193,700		199,700		0		393,400	
								1.Level 4.Below St 7.Steep 2.Rolling 5.Low 8.Rough 3.Above St 6.Swampy 9.				2016		193,700		199,700		0		393,400	
												2017		193,700		199,700		0		393,400	
								Utilities 1 All Public				2018		193,700		199,700		20,000		373,400	
								1.Public 4.Dr Well 7.Cesspool 2.Water 5.DUG/LAKE 8. 3.Sewer 6.Septic 9.None				2019		193,700		199,700		20,000		373,400	
												2020		193,700		199,700		25,000		368,400	
								Street 1 Paved 1.Paved 4.Proposed 7. 2.Semi Imp 5.Private 8. 3.Gravel 6.Pub Eas 9.NoStreet				2021		193,700		199,700		25,000		368,400	
2022		193,700		199,700		24,000						369,400									
Inspection Witnessed By: <																					

WISCASSET

Map Lot U08-002

Account 1559

Location 96 BATH ROAD

Card 1 Of 1 9/15/2022

Building Style 5 Colonial	SF Bsmt Living 0	Layout 1 Typical
1.Conv. 5.Colonial 9.Other	Fin Bsmt Grade 0 0	1.Typical 4. 7.
2.Ranch 6.Split 10.Double	HEARTH 0	2.Inadeq 5. 8.
3.R Ranch 7.Mod/Cont 11.Multi	Heat Type 100% 1 Hot Water BB	3. 6. 9.
4.Cape 8.Log 12.Cot.	1.HWBB 5.FWA 9.No Heat	Attic 9 None
Dwelling Units 1	2.HWCI 6.GravWA 10.	1.1/4 Fin 4.Full Fin 7.
Other Units 0	3.H Pump 7.Electric 11.	2.1/2 Fin 5.F/Stair 8.
Stories 2 Two Story	4.Steam 8.F/Wall 12.	3.3/4 Fin 6. 9.None
1.1 4.1.5 7.	Cool Type 0% 9 None	Insulation 1 Full
2.2 5.1.75 8.	1.Refrig 4.W&C Air 7.	1.Full 4.Minimal 7.
3.3 6.2.5 9.	2.Evapor 5. 8.	2.Heavy 5.Unknown 8.
Exterior Walls 6 BRICK/STONE	3.H Pump 6. 9.None	3.Capped 6. 9.None
1.CLAP 5.T-111 9.OTHER	Kitchen Style 3 OLD STYLE	Unfinished % 0%
2.WD SH 6.BR/STONE 10.	1.GOOD 4.Obsolete 7.	Grade & Factor 4 Good 110%
3.COMP 7.NOV 11.	2.TYPICAL 5. 8.	1.E Grade 4.B Grade 7.AA+ Grad
4.ASB/ASP 8.AL/VIN 12.	3.OLD TYPE 6. 9.None	2.D Grade 5.A Grade 8.AA++Grad
Roof Surface 1 Asphalt Shingles	Bath(s) Style 3 Old Style	3.C Grade 6.AA Grade 9.Same
1.Asphalt 4.Composit 7.	1.GOOD 4.Obsolete 7.	SQFT (Footprint) 646
2.Slate 5.Wood 8.	2.TYPICAL 5. 8.	Condition 5 Above Average
3.Metal 6.Other 9.	3.Old Type 6. 9.None	1.Poor 4.Avg 7.V G
SF Masonry Trim 0	# Rooms 8	2.Fair 5.Avg+ 8.Exc
OPEN-3-CUSTOM 0	# Bedrooms 4	3.Avg- 6.Good 9.Same
OPEN-4-CUSTOM 0	# Full Baths 1	Phys. % Good 0%
Year Built 1810	# Half Baths 1	Funct. % Good 90%
Year Remodeled 0	# Addn Fixtures 0	Functional Code 7 LAYOUT
Foundation 3 Brick &/or Stone	# Fireplaces 1	1.Incomp 4.SMALL 7.LAYOUT
1.Concrete 4.Wood 7.		2.O-Built 5.CDU 8.OTHER
2.C Block 5.Slab 8.		3.Defmaint 6.STYLE 9.None
3.Br/Stone 6.Piers 9.		Econ. % Good 90%
Basement 4 Full Basement		Economic Code Location
1.1/4 Bmt 4.Full Bmt 7.		0.None 3.Services 9.None
2.1/2 Bmt 5.None 8.		1.Location 4.Traffic 8.
3.3/4 Bmt 6. 9.None		2.Encroach 8.Other 9.
Bsmt Gar # Cars 0		Entrance Code 5 Estimated
Wet Basement 2 Damp Basement		1.Interior 4.Vacant 7.
1.Dry 4. 7.		2.Refusal 5.Estimate 8.
2.Damp 5. 8.		3.Informed 6. 9.
3.Wet 6. 9.		Information Code 5 Estimate
		1.Owner 4.Agent 7.
		2.Relative 5.Estimate 8.
		3.Tenant 6.Other 9.



Date Inspected 11/30/2006

Additions, Outbuildings & Improvements

Type	Year	Units	Grade	Cond	Phys.	Funct.	Sound Value
15 1.75 Story/BSMT	0	532	0 0	0	0 %	0 %	
21 Open Frame	0	135	0 0	0	0 %	0 %	
5 1 & 3/4 STORY FR	0	304	0 0	0	0 %	0 %	
22 Encl Frame Porch	0	12	0 0	0	0 %	0 %	
78 1.75 ST	0	540	0 0	0	0 %	0 %	
24 Frame Shed	0	135	1 100	0	0 %	100 %	
21 Open Frame	0	102	0 0	0	0 %	0 %	
22 Encl Frame Porch	2003	270	4 100	4	0 %	100 %	
68 Wood Deck	2003	270	4 100	4	0 %	100 %	
					%	%	

- 1.ONE STORY FRAM
- 2.TWO STORY FRAM
- 3.THREE STORY FR
- 4.1 & 1/2 STORY
- 5.1 & 3/4 STORY
- 6.2 & 1/2 STORY
- 21.Open Frame Por
- 22.Encl Frame Por
- 23.Frame Garage
- 24.Frame Shed
- 25.Frame Bay Wind
- 26.1SFr Overhang
- 27.Unfin Basement
- 28.Unfinished Att
- 29.Finished Attic

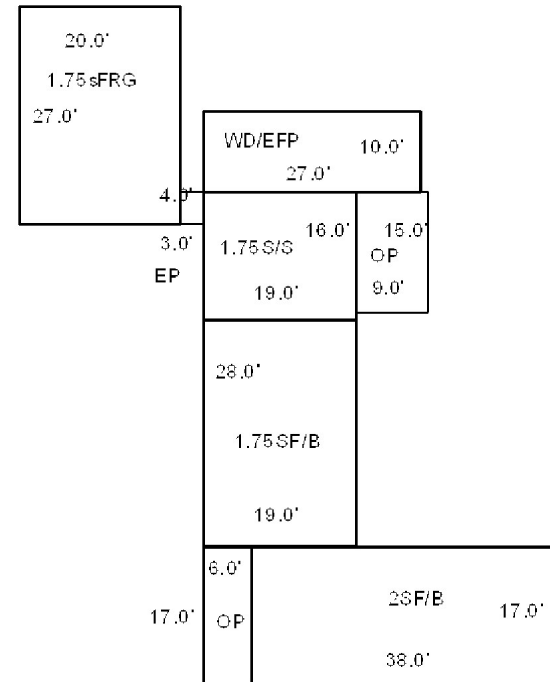

CHRIS WALLACE ERICKSON REVOCABLE TRUST
P.O. BOX 1179
WISCASSET ME 04578

B3890P143 B4367P198 B4935P263

Previous Owner
HANLEY, ROBERT A.
SNEAD, JR., GEORGE W.
C/O EDWARD H. & KRISTEN C. PETIT, III
SANDY HOOK CT 06482
Sale Date: 8/03/2007

Inspection Witnessed By:

X

Date

No./Date	Description	Date Insp.

Notes:

2008-PREVIOUS OWNER: ROBERT HANLEY & GEORGE SNEAD, JR. BOUGHT 11/98 BK2403 PG203.
2011-Added 0.4 acres from lot 2 to this lot, now this lot is 2.57 acres.

WISCASSET

Property Data

Neighborhood		101 VILLAGE	
Tree Growth Year		0	
FARM LAND YEAR		0	
OPEN SPACE YEAR		0	
Zone/Land Use		14 SHORE RESIDENTIA	
Secondary Zone			
Topography		2 Rolling	
1.Level	4.Below St	7.Steep	
2.Rolling	5.Low	8.Rough	
3.Above St	6.Swampy	9.	
Utilities		1 All Public	
1.Public	4.Dr Well	7.Cesspool	
2.Water	5.DUG/LAKE	8.	
3.Sewer	6.Septic	9.None	
Street		1 Paved	
1.Paved	4.Proposed	7.	
2.Semi Imp	5.Private	8.	
3.Gravel	6.Pub Eas	9.NoStreet	
TREE GROWTH PLAN		0	
CONSERV EASE		0	
Sale Data			
Sale Date		10/01/2015	
Price		625,000	
Sale Type		2 Land & Buildings	
1.Land	4.Mobile	7.	
2.L & B	5.Other	8.	
3.Building	6.	9.	
Financing		9 Unknown	
1.Convert	4.Seller	7.	
2.FHA/VA	5.Private	8.	
3.Assumed	6.Cash	9.Unknown	
Validity		1 Arms Length Sale	
1.Valid	4.Split	7.Renovate	
2.Related	5.Partial	8.Other	
3.Distress	6.Exempt	9.Foreclose	
Verified		5 Public Record	
1.Buyer	4.Agent	7.Family	
2.Seller	5.Pub Rec	8.Other	
3.Lender	6.MLS	9.	

Assessment Record

Year	Land	Buildings	Exempt	Total
2009	562,390	428,210	0	990,600
2010	562,400	428,200	0	990,600
2011	562,900	428,200	0	991,100
2012	562,900	428,200	0	991,100
2013	562,900	428,200	0	991,100
2014	562,900	428,200	0	991,100
2015	562,900	428,200	0	991,100
2016	562,900	428,200	0	991,100
2017	562,900	428,200	0	991,100
2018	562,900	428,200	0	991,100
2019	256,700	428,200	0	684,900
2020	256,700	428,200	0	684,900
2021	256,700	428,200	0	684,900
2022	256,700	428,200	0	684,900

Land Data

Front Foot	Type	Effective		Influence		Influence Codes
		Frontage	Depth	Factor	Code	
11.Regular Lot				%		1.Open Space
12.Delta Triangle				%		2.Neighborhood A
13.Nabla Triangle				%		3.Topography
14.Rear Land				%		4.Size/Shape
15.Front Foot				%		5.Access
				%		6.Restriction
				%		7.Corner/Locatio
						8.View/Environ
Square Foot		Square Feet				9.Fract Share
16.Regular Lot				%		Acres
17.Secondary Site				%		30.Rear 20+
18.Secondary Site				%		31.Waterfront Rea
19.Condominium				%		32.Open Space
20.Base Homesite				%		33.RestrictEsm
				%		34.PASTURE 1
				%		35.HORTICULTURAL-
Fract. Acre		Acreage/Sites				36.Pasture 3
21.HS Size Adj	26	1.00	125	%	0	37.Softwood
22.Base Waterfron	27	1.00	100	%	0	38.Mixed Wood
23.Deep WF Size A	31	1.57	100	%	0	39.Hardwood
Acres				%		40.Wasteland
24.Base Waterfron				%		41.CAMP SITE
25.Shallow WF Siz				%		42.Mobile Home Si
26.Base Water Inf				%		43.Condo Site
27.Influence W Si				%		44.Site Improve
28.Rear Land 1-10						45.CAMP SITE
29.Rear Land 11-2						46.PAVING/00
		Total Acreage	2.57			

WISCASSET

Map Lot U08-003





Account 1560

Location 100 BATH ROAD

Card 1

Of 1

9/15/2022

Building Style 5 Colonial	SF Bsmt Living 0	Layout 1 Typical
1.Conv. 5.Colonial 9.Other	Fin Bsmt Grade 0 0	1.Typical 4. 7.
2.Ranch 6.Split 10.Double	HEARTH 0	2.Inadeq 5. 8.
3.R Ranch 7.Mod/Cont 11.Multi	Heat Type 100% 1 Hot Water BB	3. 6. 9.
4.Cape 8.Log 12.Cot.	1.HWBB 5.FWA 9.No Heat	Attic 5 Floor & Stairs
Dwelling Units 1	2.HWCI 6.GravWA 10.	1.1/4 Fin 4.Full Fin 7.
Other Units 0	3.H Pump 7.Electric 11.	2.1/2 Fin 5.F/Stair 8.
Stories 2 Two Story	4.Steam 8.F/Wall 12.	3.3/4 Fin 6. 9.None
1.1 4.1.5 7.	Cool Type 0% 9 None	Insulation 1 Full
2.2 5.1.75 8.	1.Refrig 4.W&C Air 7.	1.Full 4.Minimal 7.
3.3 6.2.5 9.	2.Evapor 5. 8.	2.Heavy 5.Unknown 8.
Exterior Walls 1 CLAPBOARD	3.H Pump 6. 9.None	3.Capped 6. 9.None
1.CLAP 5.T-111 9.OTHER	Kitchen Style 1 GOOD	Unfinished % 0%
2.WD SH 6.BR/STONE 10.	1.GOOD 4.Obsolete 7.	Grade & Factor 6 Excellent 100%
3.COMP 7.NOV 11.	2.TYPICAL 5. 8.	1.E Grade 4.B Grade 7.AA+ Grad
4.ASB/ASP 8.AL/VIN 12.	3.OLD TYPE 6. 9.None	2.D Grade 5.A Grade 8.AA++Grad
Roof Surface 1 Asphalt Shingles	Bath(s) Style 1 GOOD	3.C Grade 6.AA Grade 9.Same
1.Asphalt 4.Composit 7.	1.GOOD 4.Obsolete 7.	SQFT (Footprint) 989
2.Slate 5.Wood 8.	2.TYPICAL 5. 8.	Condition 6 Good
3.Metal 6.Other 9.	3.Old Type 6. 9.None	1.Poor 4.Avg 7.V G
SF Masonry Trim 0	# Rooms 15	2.Fair 5.Avg+ 8.Exc
OPEN-3-CUSTOM 0	# Bedrooms 5	3.Avg- 6.Good 9.Same
OPEN-4-CUSTOM 0	# Full Baths 3	Phys. % Good 0%
Year Built 1889	# Half Baths 1	Funct. % Good 100%
Year Remodeled 0	# Addn Fixtures 1	Functional Code 9 None
Foundation 3 Brick &/or Stone	# Fireplaces 2	1.Incomp 4.SMALL 7.LAYOUT
1.Concrete 4.Wood 7.		2.O-Built 5.CDU 8.OTHER
2.C Block 5.Slab 8.		3.Defmaint 6.STYLE 9.None
3.Br/Stone 6.Piers 9.		Econ. % Good 100%
Basement 4 Full Basement		Economic Code None
1.1/4 Bmt 4.Full Bmt 7.		0.None 3.Services 9.None
2.1/2 Bmt 5.None 8.		1.Location 4.Traffic 8.
3.3/4 Bmt 6. 9.None		2.Encroach 8.Other 9.
Bsmt Gar # Cars 0		Entrance Code 5 Estimated
Wet Basement 1 Dry Basement		1.Interior 4.Vacant 7.
1.Dry 4. 7.		2.Refusal 5.Estimate 8.
2.Damp 5. 8.		3.Informed 6. 9.
3.Wet 6. 9.		Information Code 5 Estimate
		1.Owner 4.Agent 7.
		2.Relative 5.Estimate 8.
		3.Tenant 6.Other 9.

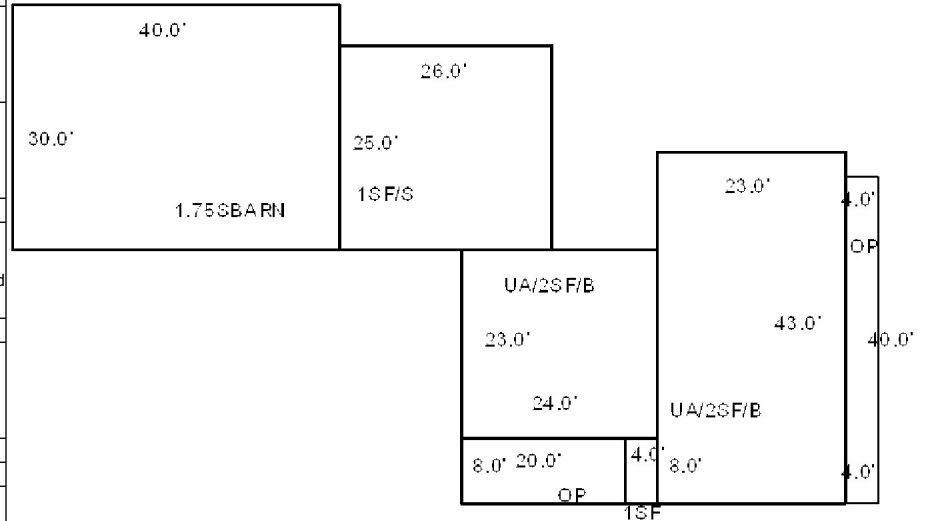

Date Inspected 11/30/2006

Additions, Outbuildings & Improvements

Type	Year	Units	Grade	Cond	Phys.	Funct.	Sound Value
12 2	0	552	0 0	0	0 %	0 %	
21 Open Frame	0	160	0 0	0	0 %	0 %	
1 ONE STORY	0	650	0 0	0	0 %	0 %	
158 1.75 ST	0	1200	0 0	0	0 %	0 %	
68 Wood Deck	0	64	0 0	0	0 %	0 %	
28 Unfinished Attic	0	552	0 0	0	0 %	0 %	
					%	%	
					%	%	
					%	%	
					%	%	

- ONE STORY FRAM
- TWO STORY FRAM
- THREE STORY FR
- 4.1 & 1/2 STORY
- 5.1 & 3/4 STORY
- 6.2 & 1/2 STORY
- 21.Open Frame Por
- 22.Encl Frame Por
- 23.Frame Garage
- 24.Frame Shed
- 25.Frame Bay Wind
- 26.1SFr Overhang
- 27.Unfin Basement
- 28.Unfinished Att
- 29.Finished Attic



Map Lot U08-004

Account 1561

Location 106 BATH ROAD

Card 1 Of 2 9/15/2022

HART, CHRISTOPHER DANIEL
EASON, ALISSA LEE
106 BATH ROAD
WISCASSET ME 04578

B1773P30 B3162P3

Previous Owner
LIVINGSTON, HEATHER T

106 BATH ROAD
WISCASSET ME 04578
Sale Date: 1/24/2020

Previous Owner
POULSEN, STEPHEN A.

PO BOX 595
WISCASSET ME 04578
Sale Date: 9/23/2003

Inspection Witnessed By:

X

Date

No./Date	Description	Date Insp.

Notes:

8/20/03-ADJUSTED ACREAGE FROM 12.05 ACRES TO 8.3 ACRES PER DEED AND MAP GIVEN BY REALTOR.
2004-PREVIOUS OWNER: STEPHEN POULSEN BK1773 PG30
6/22/04-ABATEMENT RECEIVED AS THERE IS NO SLATE ROOF, IT WAS REMOVED IN FEB. 2003 AND NO SWIMMING POOL, IT WAS REMOVED IN MID 1990'S.

WISCASSET

Property Data

Neighborhood 101 VILLAGE		
Tree Growth Year 0		
FARM LAND YEAR 0		
OPEN SPACE YEAR 0		
Zone/Land Use 14 SHORE RESIDENTIA		
Secondary Zone		
Topography 1 Level		
1.Level	4.Below St	7.Steep
2.Rolling	5.Low	8.Rough
3.Above St	6.Swampy	9.
Utilities 1 All Public		
1.Public	4.Dr Well	7.Cesspool
2.Water	5.DUG/LAKE	8.
3.Sewer	6.Septic	9.None
Street 1 Paved		
1.Paved	4.Proposed	7.
2.Semi Imp	5.Private	8.
3.Gravel	6.Pub Eas	9.NoStreet
TREE GROWTH PLAN 0		
CONSERV EASE 0		
Sale Data		
Sale Date 11/18/2019		
Price 775,000		
Sale Type 2 Land & Buildings		
1.Land	4.Mobile	7.
2.L & B	5.Other	8.
3.Building	6.	9.
Financing 9 Unknown		
1.Convent	4.Seller	7.
2.FHA/VA	5.Private	8.
3.Assumed	6.Cash	9.Unknown
Validity 1 Arms Length Sale		
1.Valid	4.Split	7.Renovate
2.Related	5.Partial	8.Other
3.Distress	6.Exempt	9.Foreclose
Verified 5 Public Record		
1.Buyer	4.Agent	7.Family
2.Seller	5.Pub Rec	8.Other
3.Lender	6.MLS	9.

Assessment Record

Year	Land	Buildings	Exempt	Total
2009	637,400	438,250	0	1,075,650
2010	637,400	438,300	10,000	1,065,700
2011	637,400	438,300	10,000	1,065,700
2012	637,400	438,300	10,000	1,065,700
2013	637,400	438,300	10,000	1,065,700
2014	637,400	438,300	10,000	1,065,700
2015	637,400	438,300	10,000	1,065,700
2016	637,400	438,300	15,000	1,060,700
2017	637,400	438,300	20,000	1,055,700
2018	637,400	438,300	20,000	1,055,700
2019	331,200	365,100	20,000	676,300
2020	331,200	365,100	0	696,300
2021	331,200	365,100	0	696,300
2022	331,200	365,100	0	696,300

Land Data

Front Foot	Type	Effective		Influence		Influence Codes
		Frontage	Depth	Factor	Code	
11.Regular Lot				%		1.Open Space
12.Delta Triangle				%		2.Neighborhood A
13.Nabla Triangle				%		3.Topography
14.Rear Land				%		4.Size/Shape
15.Front Foot				%		5.Access
				%		6.Restriction
				%		7.Corner/Locatio
				%		8.View/Environ
				%		9.Fract Share
				%		Acres
				%		30.Rear 20+
				%		31.Waterfront Rea
				%		32.Open Space
				%		33.RestrictEsm
				%		34.PASTURE 1
				%		35.HORTICULTURAL-
				%		36.Pasture 3
				%		37.Softwood
				%		38.Mixed Wood
				%		39.Hardwood
				%		40.Wasteland
				%		41.CAMP SITE
				%		42.Mobile Home Si
				%		43.Condo Site
				%		44.Site Improve
				%		45.CAMP SITE
				%		46.PAVING/00
		Total Acreage		8.30		





WISCASSET

Map Lot U08-004

Account 1561

Location 106 BATH ROAD

Card 1 Of 2 9/15/2022

Building Style 5 Colonial	SF Bsmt Living 0	Layout 1 Typical
1.Conv. 5.Colonial 9.Other	Fin Bsmt Grade 0 0	1.Typical 4. 7.
2.Ranch 6.Split 10.Double	HEARTH 0	2.Inadeq 5. 8.
3.R Ranch 7.Mod/Cont 11.Multi	Heat Type 100% 1 Hot Water BB	3. 6. 9.
4.Cape 8.Log 12.Cot.	1.HWBB 5.FWA 9.No Heat	Attic 9 None
Dwelling Units 1	2.HWCI 6.GravWA 10.	1.1/4 Fin 4.Full Fin 7.
Other Units 0	3.H Pump 7.Electric 11.	2.1/2 Fin 5.F/Stair 8.
Stories 2 Two Story	4.Steam 8.F/Wall 12.	3.3/4 Fin 6. 9.None
1.1 4.1.5 7.	Cool Type 0% 9 None	Insulation 1 Full
2.2 5.1.75 8.	1.Refrig 4.W&C Air 7.	1.Full 4.Minimal 7.
3.3 6.2.5 9.	2.Evapor 5. 8.	2.Heavy 5.Unknown 8.
Exterior Walls 6 BRICK/STONE	3.H Pump 6. 9.None	3.Capped 6. 9.None
1.CLAP 5.T-111 9.OTHER	Kitchen Style 1 GOOD	Unfinished % 0%
2.WD SH 6.BR/STONE 10.	1.GOOD 4.Obsolete 7.	Grade & Factor 6 Excellent 100%
3.COMP 7.NOV 11.	2.TYPICAL 5. 8.	1.E Grade 4.B Grade 7.AA+ Grad
4.ASB/ASP 8.AL/VIN 12.	3.OLD TYPE 6. 9.None	2.D Grade 5.A Grade 8.AA++Grad
Roof Surface 1 Asphalt Shingles	Bath(s) Style 1 GOOD	3.C Grade 6.AA Grade 9.Same
1.Asphalt 4.Composit 7.	1.GOOD 4.Obsolete 7.	SQFT (Footprint) 1288
2.Slate 5.Wood 8.	2.TYPICAL 5. 8.	Condition 4 Average
3.Metal 6.Other 9.	3.Old Type 6. 9.None	1.Poor 4.Avg 7.V G
SF Masonry Trim 0	# Rooms 12	2.Fair 5.Avg+ 8.Exc
OPEN-3-CUSTOM 0	# Bedrooms 5	3.Avg- 6.Good 9.Same
OPEN-4-CUSTOM 0	# Full Baths 3	Phys. % Good 0%
Year Built 1935	# Half Baths 1	Funct. % Good 100%
Year Remodeled 0	# Addn Fixtures 2	Functional Code 9 None
Foundation 1 Concrete	# Fireplaces 3	1.Incomp 4.SMALL 7.LAYOUT
1.Concrete 4.Wood 7.		2.O-Built 5.CDU 8.OTHER
2.C Block 5.Slab 8.		3.Defmaint 6.STYLE 9.None
3.Br/Stone 6.Piers 9.		Econ. % Good 100%
Basement 4 Full Basement		Economic Code None
1.1/4 Bmt 4.Full Bmt 7.		0.None 3.Services 9.None
2.1/2 Bmt 5.None 8.		1.Location 4.Traffic 8.
3.3/4 Bmt 6. 9.None		2.Encroach 8.Other 9.
Bsmt Gar # Cars 0		Entrance Code 5 Estimated
Wet Basement 1 Dry Basement		1.Interior 4.Vacant 7.
1.Dry 4. 7.		2.Refusal 5.Estimate 8.
2.Damp 5. 8.		3.Informed 6. 9.
3.Wet 6. 9.		Information Code 5 Estimate
		1.Owner 4.Agent 7.
		2.Relative 5.Estimate 8.
		3.Tenant 6.Other 9.

Date Inspected 11/30/2006

Additions, Outbuildings & Improvements

Type	Year	Units	Grade	Cond	Phys.	Funct.	Sound Value	
12 2	0	572	0 0	0	0 %	0 %		1.ONE STORY FRAM
15 1.75 Story/BSMT	0	352	0 0	0	0 %	0 %		2.TWO STORY FRAM
21 Open Frame	0	325	0 0	0	0 %	0 %		3.THREE STORY FR
21 Open Frame	0	96	0 0	0	0 %	0 %		4.1 & 1/2 STORY
27 Unfin Basement	0	132	0 0	0	0 %	0 %		5.1 & 3/4 STORY
24 Frame Shed	0	100	3 100	4	0 %	100 %		6.2 & 1/2 STORY
23 Frame Garage	0	440	3 100	4	0 %	100 %		21.Open Frame Por
24 Frame Shed	0	64	3 100	4	0 %	100 %		22.Encl Frame Por
24 Frame Shed	0	128	3 100	3	0 %	100 %		23.Frame Garage
					%	%		24.Frame Shed
								25.Frame Bay Wind
								26.1SFr Overhang
								27.Unfin Basement
								28.Unfinished Att
								29.Finished Attic

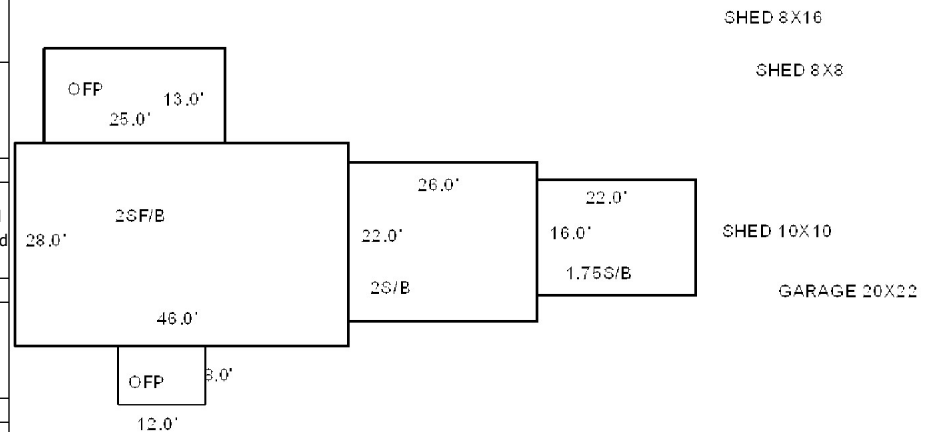

Map Lot U08-004

Account 1561

Location 106 BATH ROAD

Card 2 Of 2 9/15/2022

HART, CHRISTOPHER DANIEL
EASON, ALISSA LEE
106 BATH ROAD
WISCASSET ME 04578

B1773P30 B3162P3

Previous Owner
LIVINGSTON, HEATHER T

106 BATH ROAD
WISCASSET ME 04578
Sale Date: 1/24/2020

Previous Owner
POULSEN, STEPHEN A.

PO BOX 595
WISCASSET ME 04578
Sale Date: 9/23/2003

Inspection Witnessed By:

X

Date

No./Date	Description	Date Insp.

Notes:

WISCASSET

Property Data

Neighborhood		101 VILLAGE	
Tree Growth Year		0	
FARM LAND YEAR		0	
OPEN SPACE YEAR		0	
Zone/Land Use		14 SHORE RESIDENTIA	
Secondary Zone			
Topography		1 Level	
1.Level	4.Below St	7.Steep	
2.Rolling	5.Low	8.Rough	
3.Above St	6.Swampy	9.	
Utilities		1 All Public	
1.Public	4.Dr Well	7.Cesspool	
2.Water	5.DUG/LAKE	8.	
3.Sewer	6.Septic	9.None	
Street		1 Paved	
1.Paved	4.Proposed	7.	
2.Semi Imp	5.Private	8.	
3.Gravel	6.Pub Eas	9.NoStreet	
TREE GROWTH PLAN		0	
CONSERV EASE		0	
Sale Data			
Sale Date		11/18/2019	
Price		775,000	
Sale Type		2 Land & Buildings	
1.Land	4.Mobile	7.	
2.L & B	5.Other	8.	
3.Building	6.	9.	
Financing		9 Unknown	
1.Convent	4.Seller	7.	
2.FHA/VA	5.Private	8.	
3.Assumed	6.Cash	9.Unknown	
Validity		1 Arms Length Sale	
1.Valid	4.Split	7.Renovate	
2.Related	5.Partial	8.Other	
3.Distress	6.Exempt	9.Foreclose	
Verified		5 Public Record	
1.Buyer	4.Agent	7.Family	
2.Seller	5.Pub Rec	8.Other	
3.Lender	6.MLS	9.	

Assessment Record

Year	Land	Buildings	Exempt	Total
2009	0	107,960	0	107,960
2010	0	108,000	0	108,000
2011	0	108,000	0	108,000
2012	0	108,000	0	108,000
2013	0	108,000	0	108,000
2014	0	108,000	0	108,000
2015	0	108,000	0	108,000
2016	0	108,000	0	108,000
2017	0	108,000	0	108,000
2018	0	108,000	0	108,000
2019	0	85,300	0	85,300
2020	0	85,300	0	85,300
2021	0	85,300	0	85,300
2022	0	85,300	0	85,300

Land Data

Front Foot	Type	Effective		Influence		Influence Codes
		Frontage	Depth	Factor	Code	
11.Regular Lot				%		1.Open Space
12.Delta Triangle				%		2.Neighborhood A
13.Nabla Triangle				%		3.Topography
14.Rear Land				%		4.Size/Shape
15.Front Foot				%		5.Access
				%		6.Restriction
				%		7.Corner/Locatio
				%		8.View/Environ
				%		9.Fract Share
				%		Acres
				%		30.Rear 20+
				%		31.Waterfront Rea
				%		32.Open Space
				%		33.RestrictEsm
				%		34.PASTURE 1
				%		35.HORTICULTURAL-
				%		36.Pasture 3
				%		37.Softwood
				%		38.Mixed Wood
				%		39.Hardwood
				%		40.Wasteland
				%		41.CAMP SITE
				%		42.Mobile Home Si
				%		43.Condo Site
				%		44.Site Improve
				%		45.CAMP SITE
				%		46.PAVING/00
Total Acreage		0.00				

WISCASSET

Map Lot U08-004

Account 1561

Location 106 BATH ROAD

Card 2 Of 2 9/15/2022

Building Style 1 Conventional	SF Bsmt Living 450	Layout 1 Typical
1.Conv. 5.Colonial 9.Other	Fin Bsmt Grade 9 100	1.Typical 4. 7.
2.Ranch 6.Split 10.Double	HEARTH 0	2.Inadeq 5. 8.
3.R Ranch 7.Mod/Cont 11.Multi	Heat Type 100% 1 Hot Water BB	3. 6. 9.
4.Cape 8.Log 12.Cot.	1.HWBB 5.FWA 9.No Heat	Attic 9 None
Dwelling Units 1	2.HWCI 6.GravWA 10.	1.1/4 Fin 4.Full Fin 7.
Other Units 0	3.H Pump 7.Electric 11.	2.1/2 Fin 5.F/Stair 8.
Stories 1 One Story	4.Steam 8.F/Wall 12.	3.3/4 Fin 6. 9.None
1.1 4.1.5 7.	Cool Type 0% 9 None	Insulation 1 Full
2.2 5.1.75 8.	1.Refrig 4.W&C Air 7.	1.Full 4.Minimal 7.
3.3 6.2.5 9.	2.Evapor 5. 8.	2.Heavy 5.Unknown 8.
Exterior Walls 1 CLAPBOARD	3.H Pump 6. 9.None	3.Capped 6. 9.None
1.CLAP 5.T-111 9.OTHER	Kitchen Style 2 TYPICAL	Unfinished % 0%
2.WD SH 6.BR/STONE 10.	1.GOOD 4.Obsolete 7.	Grade & Factor 2 Fair 100%
3.COMP 7.NOV 11.	2.TYPICAL 5. 8.	1.E Grade 4.B Grade 7.AA+ Grad
4.ASB/ASP 8.AL/VIN 12.	3.OLD TYPE 6. 9.None	2.D Grade 5.A Grade 8.AA++Grad
Roof Surface 1 Asphalt Shingles	Bath(s) Style 2 TYPICAL	3.C Grade 6.AA Grade 9.Same
1.Asphalt 4.Composit 7.	1.GOOD 4.Obsolete 7.	SQFT (Footprint) 960
2.Slate 5.Wood 8.	2.TYPICAL 5. 8.	Condition 4 Average
3.Metal 6.Other 9.	3.Old Type 6. 9.None	1.Poor 4.Avg 7.V G
SF Masonry Trim 0	# Rooms 5	2.Fair 5.Avg+ 8.Exc
OPEN-3-CUSTOM 0	# Bedrooms 3	3.Avg- 6.Good 9.Same
OPEN-4-CUSTOM 0	# Full Baths 1	Phys. % Good 0%
Year Built 1960	# Half Baths 0	Funct. % Good 100%
Year Remodeled 0	# Addn Fixtures 0	Functional Code 9 None
Foundation 1 Concrete	# Fireplaces 0	1.Incomp 4.SMALL 7.LAYOUT
1.Concrete 4.Wood 7.		2.O-Built 5.CDU 8.OTHER
2.C Block 5.Slab 8.		3.Defmaint 6.STYLE 9.None
3.Br/Stone 6.Piers 9.		Econ. % Good 100%
Basement 4 Full Basement		Economic Code None
1.1/4 Bmt 4.Full Bmt 7.		0.None 3.Services 9.None
2.1/2 Bmt 5.None 8.		1.Location 4.Traffic 8.
3.3/4 Bmt 6. 9.None		2.Encroach 8.Other 9.
Bsmt Gar # Cars 0		Entrance Code 5 Estimated
Wet Basement 1 Dry Basement		1.Interior 4.Vacant 7.
1.Dry 4. 7.		2.Refusal 5.Estimate 8.
2.Damp 5. 8.		3.Informed 6. 9.
3.Wet 6. 9.		Information Code 5 Estimate
		1.Owner 4.Agent 7.
		2.Relative 5.Estimate 8.
		3.Tenant 6.Other 9.

Date Inspected 11/30/2006

Additions, Outbuildings & Improvements

Type	Year	Units	Grade	Cond	Phys.	Funct.	Sound Value	
32	0	192	0 0	0	0 %	0 %		1.ONE STORY FRAM
24 Frame Shed	0	396	2 100	3	0 %	100 %		2.TWO STORY FRAM
68 Wood Deck	0	176	0 0	0	0 %	0 %		3.THREE STORY FR
24 Frame Shed	0	80	3 100	3	0 %	100 %		4.1 & 1/2 STORY
23 Frame Garage	0	462	3 100	4	0 %	100 %		5.1 & 3/4 STORY
					%	%		6.2 & 1/2 STORY
					%	%		21.Open Frame Por
					%	%		22.Encl Frame Por
					%	%		23.Frame Garage
					%	%		24.Frame Shed
					%	%		25.Frame Bay Wind
					%	%		26.1SFr Overhang
					%	%		27.Unfin Basement
					%	%		28.Unfinished Att
					%	%		29.Finished Attic

