

Map Lot		U08-001	Account	1558	Location	WHITES ISLAND		Card	1	Of	1	10/05/2023					
WISCASSET, INHABITANTS OF WISCASSET ME 04578					Property Data			Assessment Record									
					Neighborhood 101 VILLAGE			Year	Land	Buildings	Exempt	Total					
					Tree Growth Year 0			2010	26,700	0	0	26,700					
					FARM LAND YEAR 0			2011	26,700	0	0	26,700					
					OPEN SPACE YEAR 0			2012	26,700	0	0	26,700					
B2879P200 B4979P310 B4979P312 B5080P187					Zone/Land Use 11 SHORE RES PROTEC			2013	26,700	0	0	26,700					
Previous Owner MAINE COAST HERITAGE TRUST 1 BOWDOIN MILL ISLAND					Secondary Zone			2014	26,700	0	0	26,700					
								2015	26,700	0	0	26,700					
TOPSHAM ME 04086 Sale Date: 9/29/2016					Topography 1 Level			2016	26,700	0	0	26,700					
Previous Owner PHINNEY, WILLIAM T. J/T PHINNEY, DONNA B.					1.Level 4.Below St 7.Steep 2.Rolling 5.Low 8.Rough 3.Above St 6.Swampy 9.			2017	26,700	0	26,700	0					
					Utilities 9 NoWater/NoSewer			2018	26,700	0	26,700	0					
								2019	26,700	0	26,700	0					
								2020	26,700	0	26,700	0					
								2021	26,700	0	26,700	0					
WISCASSET ME 04578 Sale Date: 2/16/2016					1.Public 4.Dr Well 7.Cesspool 2.Water 5.DUG/LAKE 8. 3.Sewer 6.Septic 9.None			2022	26,700	0	26,700	0					
					Street 9 No Street			2023	33,300	0	33,300	0					
					1.Paved 4.Proposed 7. 2.Semi Imp 5.Private 8. 3.Gravel 6.Pub Eas 9.NoStreet			Land Data									
					TREE GROWTH PLAN 0			Front Foot		Type	Effective		Influence		Influence Codes		
					CONSERV EASE 0						Frontage	Depth	Factor	Code			
Inspection Witnessed By:					Sale Data			11.Regular Lot			%		1.Open Space				
					Sale Date 9/29/2016			12.Delta Triangle			%		2.Neighborhood A				
					Price			13.Nabla Triangle			%		3.Topography				
					Sale Type 1 Land Only			14.Rear Land			%		4.Size/Shape				
					1.Land 4.Mobile 7. 2.L & B 5.Other 8. 3.Building 6. 9.			15.Front Foot			%		5.Access				
X					Date						%		6.Restriction				
No./Date		Description			Date Insp.		Square Feet				%		7.Corner/Locatio				
							16.Regular Lot				%		8.View/Environ				
							17.Secondary Site				%		9.Fract Share				
							18.Secondary Site				%		Acres				
							19.Condominium				%		30.Rear 20+				
							20.Base Homesite				%		31.Waterfront Rea				
Notes: PREVIOUS BK1829 PG0258 09/07/01 THOMAS STETSON 5 WEST STREET BATH, ME 04530 2002: ETHAN GAVE TO WIFE DEBORAH 2003-SOLD TO WILLIAM T. & DONNA B. PHINNEY PREVIOUS BK2681 PG80 \$84,999 INCLUDED U01-112 4-1-2005 REDUCED ADDITIONALLY FOR BRIDGE 20% Tax year 2007-\$37,500 valuation abatement given=\$487.50, 2010-Per survey adjusted acreage from 1.43 acres to .67					Financing 9 Unknown						%		32.Open Space				
					1.Convent 4.Seller 7. 2.FHA/VA 5.Private 8. 3.Assumed 6.Cash 9.Unknown						%		33.RestrictEsm				
					Validity 1 Arms Length Sale						%		34.PASTURE 1				
					1.Valid 4.Split 7.Renovate 2.Related 5.Partial 8.Other 3.Distress 6.Exempt 9.Foreclose			Fract. Acre		Acreage/Sites					%		35.HORTICULTURAL-
					Verified 5 Public Record			21.HS Size Adj	24	1.00	10	%	6	36.Pasture 3			
					1.Buyer 4.Agent 7.Family 2.Seller 5.Pub Rec 8.Other 3.Lender 6.MLS 9.			22.Base Waterfron	25	0.67	10	%	6	37.Softwood			
								23.Deep WF Size A			%			38.Mixed Wood			
								Acres			%			39.Hardwood			
								24.Base Waterfron			%			40.Wasteland			
								25.Shallow WF Siz			%			41.CAMP SITE			
											%		42.Mobile Home Si				
											%		43.Condo Site				
											%		44.Site Improve				
											%		45.CAMP SITE				
											%		46.PAVING/00				
											%						
											%						
											%						
											%						
											%						
											%						
											%						
											%						
											%						
											%						
											%						
											%						
											%						
											%						
											%						
											%						
											%						
											%						
											%						
											%						
											%						
											%						
											%						
											%						
											%						
											%						
											%						
											%						
											%						
											%						
											%						
											%						
											%						
											%						
											%						
											%						
											%						
											%						
											%						
											%						
											%						
											%						
											%						
											%						
											%						
											%						
											%						
											%						
											%						
											%						
											%						
											%						
											%						
											%						
											%						
											%						
											%						

Inspection Witnessed By:

X		Date
No./Date	Description	Date Insp.

Notes:
 PREVIOUS BK1829 PG0258
 09/07/01 THOMAS STETSON 5 WEST STREET BATH, ME 04530
 2002: ETHAN GAVE TO WIFE DEBORAH
 2003-SOLD TO WILLIAM T. & DONNA B. PHINNEY PREVIOUS BK2681 PG80
 \$84,999 INCLUDED U01-112
 4-1-2005 REDUCED ADDITIONALLY FOR BRIDGE 20%
 Tax year 2007-\$37,500 valuation abatement given=\$487.50,
 WISCASSET ME 04578.
 2010-Per survey adjusted acreage from 1.43 acres to .67

WISCASSET

Map Lot U08-001

Account 1558

Location WHITES ISLAND

Card 1 Of 1 10/05/2023

Building Style			SF Bsmt Living			Layout		
1.Conv.	5.Colonial	9.Other	Fin Bsmt Grade			1.Typical 4. 7.		
2.Ranch	6.Split	10.Double	HEARTH			2.Inadeq 5. 8.		
3.R Ranch	7.Mod/Cont	11.Multi	Heat Type 0%			3. 6. 9.		
4.Cape	8.Log	12.Cot.	1.HWBB	5.FWA	9.No Heat	Attic		
Dwelling Units			2.HWCI	6.GravWA	10.	1.1/4 Fin	4.Full Fin	7.
Other Units			3.H Pump	7.Electric	11.	2.1/2 Fin	5.F/Stair	8.
Stories			4.Steam	8.F/Wall	12.	3.3/4 Fin	6.	9.None
1.1	4.1.5	7.	Cool Type 0%			Insulation		
2.2	5.1.75	8.	1.Refrig	4.W&C Air	7.	1.Full	4.Minimal	7.
3.3	6.2.5	9.	2.Evapor	5.	8.	2.Heavy	5.Unknown	8.
Exterior Walls			3.H Pump	6.	9.None	3.Capped	6.	9.None
1.CLAP	5.T-111	9.OTHER	Kitchen Style			Unfinished %		
2.WD SH	6.BR/STONE	10.	1.GOOD	4.Obsolete	7.	Grade & Factor		
3.COMP	7.NOV	11.	2.TYPICAL	5.	8.	1.E Grade	4.B Grade	7.AA+ Grad
4.ASB/ASP	8.AL/VIN	12.	3.OLD TYPE	6.	9.None	2.D Grade	5.A Grade	8.AA++Grad
Roof Surface			Bath(s) Style			3.C Grade	6.AA Grade	9.Same
1.Asphalt	4.Composit	7.	1.GOOD	4.Obsolete	7.	SQFT (Footprint)		
2.Slate	5.Wood	8.	2.TYPICAL	5.	8.	Condition		
3.Metal	6.Other	9.	3.Old Type	6.	9.None	1.Poor	4.Avg	7.V G
SF Masonry Trim			# Rooms			2.Fair	5.Avg+	8.Exc
OPEN-3-CUSTOM			# Bedrooms			3.Avg-	6.Good	9.Same
OPEN-4-CUSTOM			# Full Baths			Phys. % Good		
Year Built			# Half Baths			Funct. % Good		
Year Remodeled			# Addn Fixtures			Functional Code		
Foundation			# Fireplaces			1.Incomp	4.SMALL	7.LAYOUT
1.Concrete	4.Wood	7.				2.O-Built	5.CDU	8.OTHER
2.C Block	5.Slab	8.				3.Defmait	6.STYLE	9.None
3.Br/Stone	6.Piers	9.				Econ. % Good		
Basement						Economic Code		
1.1/4 Bmt	4.Full Bmt	7.				0.None	3.Services	9.None
2.1/2 Bmt	5.None	8.				1.Location	4.Traffic	8.
3.3/4 Bmt	6.	9.None				2.Encroach	8.Other	9.
Bsmt Gar # Cars						Entrance Code 4 Unoccupied		
Wet Basement						1.Interior	4.Vacant	7.
1.Dry	4.	7.				2.Refusal	5.Estimate	8.
2.Damp	5.	8.				3.Informed	6.	9.
3.Wet	6.	9.				Information Code 5 Estimate		
Date Inspected 11/30/2006			1.Owner			4.Agent	7.	
			2.Relative			5.Estimate	8.	
			3.Tenant			6.Other	9.	
Additions, Outbuildings & Improvements								1.ONE STORY FRAM
Type	Year	Units	Grade	Cond	Phys.	Funct.	Sound Value	2.TWO STORY FRAM
					%	%		3.THREE STORY FR
					%	%		4.1 & 1/2 STORY
					%	%		5.1 & 3/4 STORY
					%	%		6.2 & 1/2 STORY
					%	%		21.Open Frame Por
					%	%		22.Encl Frame Por
					%	%		23.Frame Garage
					%	%		24.Frame Shed
					%	%		25.Frame Bay Wind
					%	%		26.1SFr Overhang
					%	%		27.Unfin Basement
					%	%		28.Unfinished Att
					%	%		29.Finished Attic

WISCASSET

Map Lot U08-002

Account 1559

Location 96 BATH ROAD

Card 1

Of 1

10/05/2023

Building Style 5 Colonial	SF Bsmt Living 0	Layout 1 Typical
1.Conv. 5.Colonial 9.Other	Fin Bsmt Grade 0 0	1.Typical 4. 7.
2.Ranch 6.Split 10.Double	HEARTH 0	2.Inadeq 5. 8.
3.R Ranch 7.Mod/Cont 11.Multi	Heat Type 100% 1 Hot Water BB	3. 6. 9.
4.Cape 8.Log 12.Cot.	1.HWBB 5.FWA 9.No Heat	Attic 9 None
Dwelling Units 1	2.HWCI 6.GravWA 10.	1.1/4 Fin 4.Full Fin 7.
Other Units 0	3.H Pump 7.Electric 11.	2.1/2 Fin 5.F/Stair 8.
Stories 2 Two Story	4.Steam 8.F/Wall 12.	3.3/4 Fin 6. 9.None
1.1 4.1.5 7.	Cool Type 0% 9 None	Insulation 1 Full
2.2 5.1.75 8.	1.Refrig 4.W&C Air 7.	1.Full 4.Minimal 7.
3.3 6.2.5 9.	2.Evapor 5. 8.	2.Heavy 5.Unknown 8.
Exterior Walls 6 BRICK/STONE	3.H Pump 6. 9.None	3.Capped 6. 9.None
1.CLAP 5.T-111 9.OTHER	Kitchen Style 3 OLD STYLE	Unfinished % 0%
2.WD SH 6.BR/STONE 10.	1.GOOD 4.Obsolete 7.	Grade & Factor 4 Good 110%
3.COMP 7.NOV 11.	2.TYPICAL 5. 8.	1.E Grade 4.B Grade 7.AA+ Grad
4.ASB/ASP 8.AL/VIN 12.	3.OLD TYPE 6. 9.None	2.D Grade 5.A Grade 8.AA++Grad
Roof Surface 1 Asphalt Shingles	Bath(s) Style 3 Old Style	3.C Grade 6.AA Grade 9.Same
1.Asphalt 4.Composit 7.	1.GOOD 4.Obsolete 7.	SQFT (Footprint) 646
2.Slate 5.Wood 8.	2.TYPICAL 5. 8.	Condition 5 Above Average
3.Metal 6.Other 9.	3.Old Type 6. 9.None	1.Poor 4.Avg 7.V G
SF Masonry Trim 0	# Rooms 8	2.Fair 5.Avg+ 8.Exc
OPEN-3-CUSTOM 0	# Bedrooms 4	3.Avg- 6.Good 9.Same
OPEN-4-CUSTOM 0	# Full Baths 1	Phys. % Good 0%
Year Built 1810	# Half Baths 1	Funct. % Good 90%
Year Remodeled 0	# Addn Fixtures 0	Functional Code 7 LAYOUT
Foundation 3 Brick &/or Stone	# Fireplaces 1	1.Incomp 4.SMALL 7.LAYOUT
1.Concrete 4.Wood 7.		2.O-Built 5.CDU 8.OTHER
2.C Block 5.Slab 8.		3.Defmaint 6.STYLE 9.None
3.Br/Stone 6.Piers 9.		Econ. % Good 90%
Basement 4 Full Basement		Economic Code Location
1.1/4 Bmt 4.Full Bmt 7.		0.None 3.Services 9.None
2.1/2 Bmt 5.None 8.		1.Location 4.Traffic 8.
3.3/4 Bmt 6. 9.None		2.Encroach 8.Other 9.
Bsmt Gar # Cars 0		Entrance Code 5 Estimated
Wet Basement 2 Damp Basement		1.Interior 4.Vacant 7.
1.Dry 4. 7.		2.Refusal 5.Estimate 8.
2.Damp 5. 8.		3.Informed 6. 9.
3.Wet 6. 9.		Information Code 5 Estimate
		1.Owner 4.Agent 7.
		2.Relative 5.Estimate 8.
		3.Tenant 6.Other 9.

Date Inspected 11/30/2006

Additions, Outbuildings & Improvements

Type	Year	Units	Grade	Cond	Phys.	Funct.	Sound Value
15 1.75 Story/BSMT	0	532	0 0	0	0 %	0 %	
21 Open Frame	0	135	0 0	0	0 %	0 %	
5 1 & 3/4 STORY FR	0	304	0 0	0	0 %	0 %	
22 Encl Frame Porch	0	12	0 0	0	0 %	0 %	
78 1.75 ST	0	540	0 0	0	0 %	0 %	
24 Frame Shed	0	135	1 100	0	0 %	100 %	
21 Open Frame	0	102	0 0	0	0 %	0 %	
22 Encl Frame Porch	2003	270	4 100	4	0 %	100 %	
68 Wood Deck	2003	270	4 100	4	0 %	100 %	
					%	%	

1.ONE STORY FRAM
2.TWO STORY FRAM
3.THREE STORY FR
4.1 & 1/2 STORY
5.1 & 3/4 STORY
6.2 & 1/2 STORY
21.Open Frame Por
22.Encl Frame Por
23.Frame Garage
24.Frame Shed
25.Frame Bay Wind
26.1SFr Overhang
27.Unfin Basement
28.Unfinished Att
29.Finished Attic

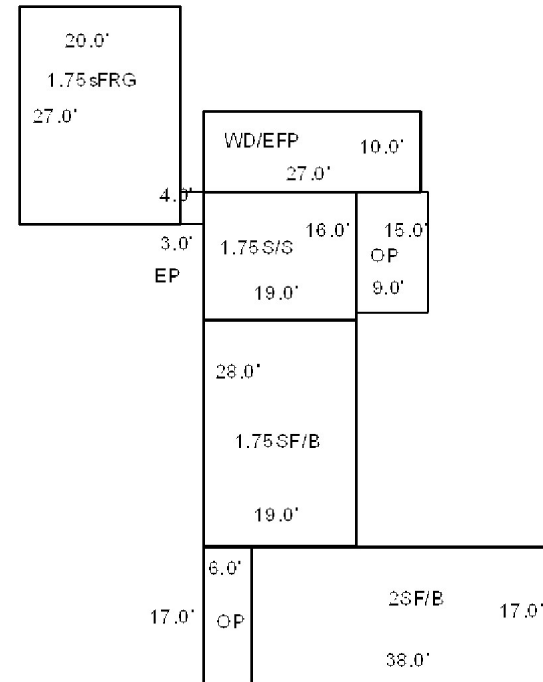

CHRIS WALLACE ERICKSON REVOCABLE TRUST P.O. BOX 1179 WISCASSET ME 04578			Property Data			Assessment Record					
			Neighborhood 101 VILLAGE			Year	Land	Buildings	Exempt	Total	
			Tree Growth Year 0			2010	562,400	428,200	0	990,600	
			FARM LAND YEAR 0			2011	562,900	428,200	0	991,100	
			OPEN SPACE YEAR 0			2012	562,900	428,200	0	991,100	
B3890P143 B4367P198 B4935P263 Previous Owner HANLEY, ROBERT A. SNEAD, JR., GEORGE W. C/O EDWARD H. & KRISTEN C. PETIT, III SANDY HOOK CT 06482 Sale Date: 8/03/2007			Zone/Land Use 14 SHORE RESIDENTIA			2013	562,900	428,200	0	991,100	
			Secondary Zone			2014	562,900	428,200	0	991,100	
						2015	562,900	428,200	0	991,100	
			Topography 2 Rolling			2016	562,900	428,200	0	991,100	
			1.Level 4.Below St 7.Steep 2.Rolling 5.Low 8.Rough 3.Above St 6.Swampy 9.			2017	562,900	428,200	0	991,100	
						2018	562,900	428,200	0	991,100	
			Utilities 1 All Public			2019	256,700	428,200	0	684,900	
			1.Public 4.Dr Well 7.Cesspool 2.Water 5.DUG/LAKE 8. 3.Sewer 6.Septic 9.None			2020	256,700	428,200	0	684,900	
						2021	256,700	428,200	0	684,900	
			Inspection Witnessed By: <div>X<div>Date</div></div>			Street 1 Paved			2022	256,700	428,200
1.Paved 4.Proposed 7. 2.Semi Imp 5.Private 8. 3.Gravel 6.Pub Eas 9.NoStreet						2023	320,800	535,300	0	856,100	
						Land Data					
Front Foot 11.Regular Lot 12.Delta Triangle 13.Nabla Triangle 14.Rear Land 15.Front Foot		Type				Effective		Influence		Influence Codes 1.Open Space 2.Neighborhood A 3.Topography 4.Size/Shape 5.Access 6.Restriction 7.Corner/Locatio 8.View/Environ 9.Fract Share Acres 30.Rear 20+ 31.Waterfront Rea 32.Open Space 33.RestrictEsm 34.PASTURE 1 35.HORTICULTURAL- 36.Pasture 3 37.Softwood 38.Mixed Wood 39.Hardwood 40.Wasteland 41.CAMP SITE 42.Mobile Home Si 43.Condo Site 44.Site Improveve 45.CAMP SITE 46.PAVING/00	
						Frontage	Depth	Factor	Code		
								%			
								%			
								%			
								%			
Square Foot 16.Regular Lot 17.Secondary Site 18.Secondary Site 19.C Condominium 20.Base Homesite						Square Feet					
					%						
						%					
						%					
						%					
						%					
						%					
						%					
						%					
						%					
Fract. Acre 21.HS Size Adj 22.Base Waterfron 23.Deep WF Size A Acres 24.Base Waterfron 25.Shallow WF Siz 26.Base Water Inf 27.Influence W Si 28.Rear Land 1-10 29.Rear Land 11-2			Acreage/Sites								
		26	1.00	125	%	0					
		27	1.00	100	%	0					
		31	1.57	100	%	0					
						%					
						%					
						%					
						%					
						%					
Notes: 2008-PREVIOUS OWNER: ROBERT HANLEY & GEORGE SNEAD, JR. BOUGHT 11/98 BK2403 PG203. 2011-Added 0.4 acres from lot 2 to this lot, now this lot is 2.57 acres.						Total Acreage 2.57					

WISCASSET

WISCASSET

Map Lot U08-003





Account 1560

Location 100 BATH ROAD

Card 1

Of 1

10/05/2023

Building Style 5 Colonial	SF Bsmt Living 0	Layout 1 Typical
1.Conv. 5.Colonial 9.Other	Fin Bsmt Grade 0 0	1.Typical 4. 7.
2.Ranch 6.Split 10.Double	HEARTH 0	2.Inadeq 5. 8.
3.R Ranch 7.Mod/Cont 11.Multi	Heat Type 100% 1 Hot Water BB	3. 6. 9.
4.Cape 8.Log 12.Cot.	1.HWBB 5.FWA 9.No Heat	Attic 5 Floor & Stairs
Dwelling Units 1	2.HWCI 6.GravWA 10.	1.1/4 Fin 4.Full Fin 7.
Other Units 0	3.H Pump 7.Electric 11.	2.1/2 Fin 5.F/Stair 8.
Stories 2 Two Story	4.Steam 8.F/Wall 12.	3.3/4 Fin 6. 9.None
1.1 4.1.5 7.	Cool Type 0% 9 None	Insulation 1 Full
2.2 5.1.75 8.	1.Refrig 4.W&C Air 7.	1.Full 4.Minimal 7.
3.3 6.2.5 9.	2.Evapor 5. 8.	2.Heavy 5.Unknown 8.
Exterior Walls 1 CLAPBOARD	3.H Pump 6. 9.None	3.Capped 6. 9.None
1.CLAP 5.T-111 9.OTHER	Kitchen Style 1 GOOD	Unfinished % 0%
2.WD SH 6.BR/STONE 10.	1.GOOD 4.Obsolete 7.	Grade & Factor 6 Excellent 100%
3.COMP 7.NOV 11.	2.TYPICAL 5. 8.	1.E Grade 4.B Grade 7.AA+ Grad
4.ASB/ASP 8.AL/VIN 12.	3.OLD TYPE 6. 9.None	2.D Grade 5.A Grade 8.AA++Grad
Roof Surface 1 Asphalt Shingles	Bath(s) Style 1 GOOD	3.C Grade 6.AA Grade 9.Same
1.Asphalt 4.Composit 7.	1.GOOD 4.Obsolete 7.	SQFT (Footprint) 989
2.Slate 5.Wood 8.	2.TYPICAL 5. 8.	Condition 6 Good
3.Metal 6.Other 9.	3.Old Type 6. 9.None	1.Poor 4.Avg 7.V G
SF Masonry Trim 0	# Rooms 15	2.Fair 5.Avg+ 8.Exc
OPEN-3-CUSTOM 0	# Bedrooms 5	3.Avg- 6.Good 9.Same
OPEN-4-CUSTOM 0	# Full Baths 3	Phys. % Good 0%
Year Built 1889	# Half Baths 1	Funct. % Good 100%
Year Remodeled 0	# Addn Fixtures 1	Functional Code 9 None
Foundation 3 Brick &/or Stone	# Fireplaces 2	1.Incomp 4.SMALL 7.LAYOUT
1.Concrete 4.Wood 7.		2.O-Built 5.CDU 8.OTHER
2.C Block 5.Slab 8.		3.Defmaint 6.STYLE 9.None
3.Br/Stone 6.Piers 9.		Econ. % Good 100%
Basement 4 Full Basement		Economic Code None
1.1/4 Bmt 4.Full Bmt 7.		0.None 3.Services 9.None
2.1/2 Bmt 5.None 8.		1.Location 4.Traffic 8.
3.3/4 Bmt 6. 9.None		2.Encroach 8.Other 9.
Bsmt Gar # Cars 0		Entrance Code 5 Estimated
Wet Basement 1 Dry Basement		1.Interior 4.Vacant 7.
1.Dry 4. 7.		2.Refusal 5.Estimate 8.
2.Damp 5. 8.		3.Informed 6. 9.
3.Wet 6. 9.		Information Code 5 Estimate
		1.Owner 4.Agent 7.
		2.Relative 5.Estimate 8.
		3.Tenant 6.Other 9.

Date Inspected 11/30/2006

Additions, Outbuildings & Improvements

Type	Year	Units	Grade	Cond	Phys.	Funct.	Sound Value
12 2	0	552	0 0	0	0 %	0 %	
21 Open Frame	0	160	0 0	0	0 %	0 %	
1 ONE STORY	0	650	0 0	0	0 %	0 %	
158 1.75 ST	0	1200	0 0	0	0 %	0 %	
68 Wood Deck	0	64	0 0	0	0 %	0 %	
28 Unfinished Attic	0	552	0 0	0	0 %	0 %	
					%	%	
					%	%	
					%	%	
					%	%	

- 1.ONE STORY FRAM
- 2.TWO STORY FRAM
- 3.THREE STORY FR
- 4.1 & 1/2 STORY
- 5.1 & 3/4 STORY
- 6.2 & 1/2 STORY
- 21.Open Frame Por
- 22.Encl Frame Por
- 23.Frame Garage
- 24.Frame Shed
- 25.Frame Bay Wind
- 26.1SFr Overhang
- 27.Unfin Basement
- 28.Unfinished Att
- 29.Finished Attic

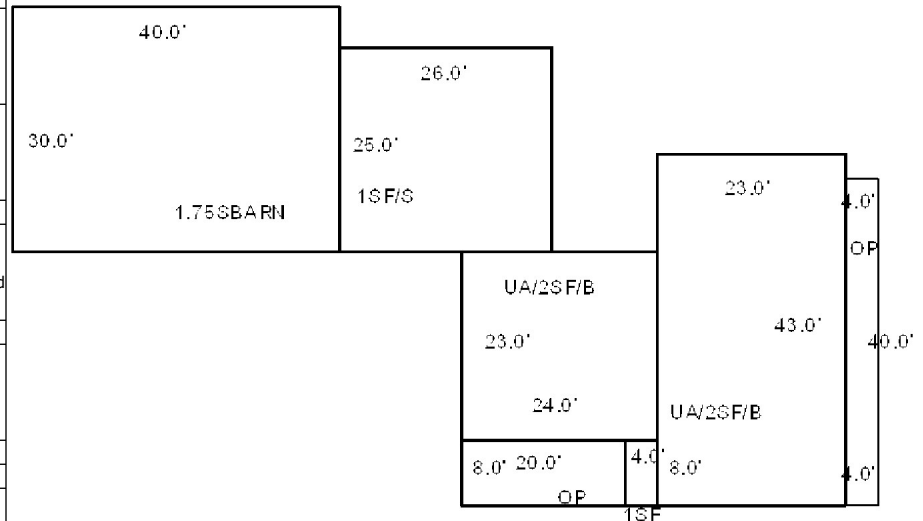

Property Data			Assessment Record						
Neighborhood 101 VILLAGE			Year	Land	Buildings	Exempt	Total		
Tree Growth Year 0			2010	637,400	438,300	10,000	1,065,700		
FARM LAND YEAR 0			2011	637,400	438,300	10,000	1,065,700		
OPEN SPACE YEAR 0			2012	637,400	438,300	10,000	1,065,700		
Zone/Land Use 14 SHORE RESIDENTIA			2013	637,400	438,300	10,000	1,065,700		
Secondary Zone			2014	637,400	438,300	10,000	1,065,700		
			2015	637,400	438,300	10,000	1,065,700		
Topography 1 Level			2016	637,400	438,300	15,000	1,060,700		
1.Level	4.Below St	7.Steep	2017	637,400	438,300	20,000	1,055,700		
2.Rolling	5.Low	8.Rough	2018	637,400	438,300	20,000	1,055,700		
3.Above St	6.Swampy	9.	2019	331,200	365,100	20,000	676,300		
Utilities 1 All Public			2020	331,200	365,100	0	696,300		
1.Public	4.Dr Well	7.Cesspool	2021	331,200	365,100	0	696,300		
2.Water	5.DUG/LAKE	8.	2022	331,200	365,100	0	696,300		
3.Sewer	6.Septic	9.None	2023	413,900	455,800	0	869,700		
Street 1 Paved			Land Data						
1.Paved	4.Proposed	7.	Front Foot	Type	Effective		Influence		Influence Codes
2.Semi Imp	5.Private	8.			Frontage	Depth	Factor	Code	
3.Gravel	6.Pub Eas	9.NoStreet					%		
TREE GROWTH PLAN 0							%		
CONSERV EASE 0							%		
Sale Data							%		
Sale Date	11/18/2019						%		
Price	775,000				%				
Sale Type	2 Land & Buildings		Square Foot		Square Feet				Acres
1.Land	4.Mobile	7.				%			
2.L & B	5.Other	8.				%			
3.Building	6.	9.				%			
Financing	9 Unknown					%			
1.Convent	4.Seller	7.				%			
2.FHA/VA	5.Private	8.				%			
3.Assumed	6.Cash	9.Unknown			%				
Validity	1 Arms Length Sale		Fract. Acre		Acreage/Sites				
1.Valid	4.Split	7.Renovate			26	1.00	125 %	0	
2.Related	5.Partial	8.Other			27	1.00	100 %	0	
3.Distress	6.Exempt	9.Foreclose			31	7.30	100 %	0	
Verified	5 Public Record						%		
1.Buyer	4.Agent	7.Family					%		
2.Seller	5.Pub Rec	8.Other					%		
3.Lender	6.MLS	9.			%				
			Total Acreage		8.30				

WISCASSET

Map Lot U08-004

Account 1561

Location 106 BATH ROAD

Card 1 Of 2 10/05/2023

Building Style 5 Colonial	SF Bsmt Living 0	Layout 1 Typical
1.Conv. 5.Colonial 9.Other	Fin Bsmt Grade 0 0	1.Typical 4. 7.
2.Ranch 6.Split 10.Double	HEARTH 0	2.Inadeq 5. 8.
3.R Ranch 7.Mod/Cont 11.Multi	Heat Type 100% 1 Hot Water BB	3. 6. 9.
4.Cape 8.Log 12.Cot.	1.HWBB 5.FWA 9.No Heat	Attic 9 None
Dwelling Units 1	2.HWCI 6.GravWA 10.	1.1/4 Fin 4.Full Fin 7.
Other Units 0	3.H Pump 7.Electric 11.	2.1/2 Fin 5.F/Stair 8.
Stories 2 Two Story	4.Steam 8.F/Wall 12.	3.3/4 Fin 6. 9.None
1.1 4.1.5 7.	Cool Type 0% 9 None	Insulation 1 Full
2.2 5.1.75 8.	1.Refrig 4.W&C Air 7.	1.Full 4.Minimal 7.
3.3 6.2.5 9.	2.Evapor 5. 8.	2.Heavy 5.Unknown 8.
Exterior Walls 6 BRICK/STONE	3.H Pump 6. 9.None	3.Capped 6. 9.None
1.CLAP 5.T-111 9.OTHER	Kitchen Style 1 GOOD	Unfinished % 0%
2.WD SH 6.BR/STONE 10.	1.GOOD 4.Obsolete 7.	Grade & Factor 6 Excellent 100%
3.COMP 7.NOV 11.	2.TYPICAL 5. 8.	1.E Grade 4.B Grade 7.AA+ Grad
4.ASB/ASP 8.AL/VIN 12.	3.OLD TYPE 6. 9.None	2.D Grade 5.A Grade 8.AA++Grad
Roof Surface 1 Asphalt Shingles	Bath(s) Style 1 GOOD	3.C Grade 6.AA Grade 9.Same
1.Asphalt 4.Composit 7.	1.GOOD 4.Obsolete 7.	SQFT (Footprint) 1288
2.Slate 5.Wood 8.	2.TYPICAL 5. 8.	Condition 4 Average
3.Metal 6.Other 9.	3.Old Type 6. 9.None	1.Poor 4.Avg 7.V G
SF Masonry Trim 0	# Rooms 12	2.Fair 5.Avg+ 8.Exc
OPEN-3-CUSTOM 0	# Bedrooms 5	3.Avg- 6.Good 9.Same
OPEN-4-CUSTOM 0	# Full Baths 3	Phys. % Good 0%
Year Built 1935	# Half Baths 1	Funct. % Good 100%
Year Remodeled 0	# Addn Fixtures 2	Functional Code 9 None
Foundation 1 Concrete	# Fireplaces 3	1.Incomp 4.SMALL 7.LAYOUT
1.Concrete 4.Wood 7.		2.O-Built 5.CDU 8.OTHER
2.C Block 5.Slab 8.		3.Defmaint 6.STYLE 9.None
3.Br/Stone 6.Piers 9.		Econ. % Good 100%
Basement 4 Full Basement		Economic Code None
1.1/4 Bmt 4.Full Bmt 7.		0.None 3.Services 9.None
2.1/2 Bmt 5.None 8.		1.Location 4.Traffic 8.
3.3/4 Bmt 6. 9.None		2.Encroach 8.Other 9.
Bsmt Gar # Cars 0		Entrance Code 5 Estimated
Wet Basement 1 Dry Basement		1.Interior 4.Vacant 7.
1.Dry 4. 7.		2.Refusal 5.Estimate 8.
2.Damp 5. 8.		3.Informed 6. 9.
3.Wet 6. 9.		Information Code 5 Estimate
		1.Owner 4.Agent 7.
		2.Relative 5.Estimate 8.
		3.Tenant 6.Other 9.

Date Inspected 11/30/2006

Additions, Outbuildings & Improvements

Type	Year	Units	Grade	Cond	Phys.	Funct.	Sound Value	
12 2	0	572	0 0	0	0 %	0 %		1.ONE STORY FRAM
15 1.75 Story/BSMT	0	352	0 0	0	0 %	0 %		2.TWO STORY FRAM
21 Open Frame	0	325	0 0	0	0 %	0 %		3.THREE STORY FR
21 Open Frame	0	96	0 0	0	0 %	0 %		4.1 & 1/2 STORY
27 Unfin Basement	0	132	0 0	0	0 %	0 %		5.1 & 3/4 STORY
24 Frame Shed	0	100	3 100	4	0 %	100 %		6.2 & 1/2 STORY
23 Frame Garage	0	440	3 100	4	0 %	100 %		21.Open Frame Por
24 Frame Shed	0	64	3 100	4	0 %	100 %		22.Encl Frame Por
					%	%		23.Frame Garage
					%	%		24.Frame Shed
					%	%		25.Frame Bay Wind
					%	%		26.1SFr Overhang
					%	%		27.Unfin Basement
					%	%		28.Unfinished Att
					%	%		29.Finished Attic

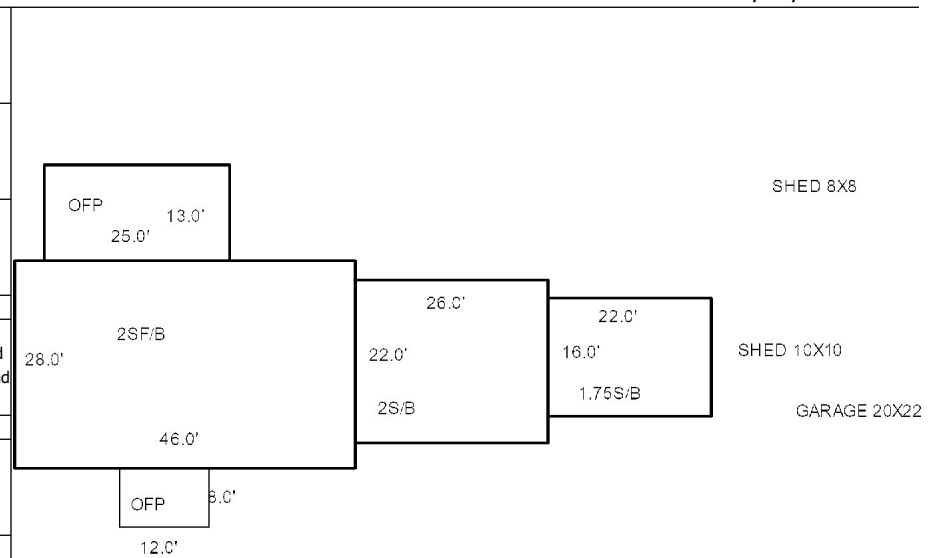

Map Lot U08-004

Account 1561

Location 106 BATH ROAD

Card 2 Of 2 10/05/2023

HART, CHRISTOPHER DANIEL
EASON, ALISSA LEE
106 BATH ROAD
WISCASSET ME 04578

B1773P30 B3162P3

Previous Owner
LIVINGSTON, HEATHER T

106 BATH ROAD
WISCASSET ME 04578
Sale Date: 1/24/2020

Previous Owner
POULSEN, STEPHEN A.

PO BOX 595
WISCASSET ME 04578
Sale Date: 9/23/2003

Inspection Witnessed By:

X

Date

No./Date	Description	Date Insp.

Notes:

WISCASSET

Property Data

Neighborhood		101 VILLAGE	
Tree Growth Year		0	
FARM LAND YEAR		0	
OPEN SPACE YEAR		0	
Zone/Land Use		14 SHORE RESIDENTIA	
Secondary Zone			
Topography		1 Level	
1.Level	4.Below St	7.Steep	
2.Rolling	5.Low	8.Rough	
3.Above St	6.Swampy	9.	
Utilities		1 All Public	
1.Public	4.Dr Well	7.Cesspool	
2.Water	5.DUG/LAKE	8.	
3.Sewer	6.Septic	9.None	
Street		1 Paved	
1.Paved	4.Proposed	7.	
2.Semi Imp	5.Private	8.	
3.Gravel	6.Pub Eas	9.NoStreet	
TREE GROWTH PLAN		0	
CONSERV EASE		0	
Sale Data			
Sale Date		11/18/2019	
Price		775,000	
Sale Type		2 Land & Buildings	
1.Land	4.Mobile	7.	
2.L & B	5.Other	8.	
3.Building	6.	9.	
Financing		9 Unknown	
1.Convent	4.Seller	7.	
2.FHA/VA	5.Private	8.	
3.Assumed	6.Cash	9.Unknown	
Validity		1 Arms Length Sale	
1.Valid	4.Split	7.Renovate	
2.Related	5.Partial	8.Other	
3.Distress	6.Exempt	9.Foreclose	
Verified		5 Public Record	
1.Buyer	4.Agent	7.Family	
2.Seller	5.Pub Rec	8.Other	
3.Lender	6.MLS	9.	

Assessment Record

Year	Land	Buildings	Exempt	Total
2010	0	108,000	0	108,000
2011	0	108,000	0	108,000
2012	0	108,000	0	108,000
2013	0	108,000	0	108,000
2014	0	108,000	0	108,000
2015	0	108,000	0	108,000
2016	0	108,000	0	108,000
2017	0	108,000	0	108,000
2018	0	108,000	0	108,000
2019	0	85,300	0	85,300
2020	0	85,300	0	85,300
2021	0	85,300	0	85,300
2022	0	85,300	0	85,300
2023	0	137,300	0	137,300

Land Data

Front Foot	Type	Effective		Influence		Influence Codes
		Frontage	Depth	Factor	Code	
11.Regular Lot				%		1.Open Space
12.Delta Triangle				%		2.Neighborhood A
13.Nabla Triangle				%		3.Topography
14.Rear Land				%		4.Size/Shape
15.Front Foot				%		5.Access
				%		6.Restriction
				%		7.Corner/Locatio
				%		8.View/Environ
				%		9.Fract Share
				%		Acres
				%		30.Rear 20+
				%		31.Waterfront Rea
				%		32.Open Space
				%		33.RestrictEsm
				%		34.PASTURE 1
				%		35.HORTICULTURAL-
				%		36.Pasture 3
				%		37.Softwood
				%		38.Mixed Wood
				%		39.Hardwood
				%		40.Wasteland
				%		41.CAMP SITE
				%		42.Mobile Home Si
				%		43.Condo Site
				%		44.Site Improve
				%		45.CAMP SITE
				%		46.PAVING/00
Total Acreage		0.00				

WISCASSET

Map Lot U08-004

Account 1561

Location 106 BATH ROAD

Card 2 Of 2 10/05/2023

Building Style 1 Conventional	SF Bsmt Living 1152	Layout 1 Typical
1.Conv. 5.Colonial 9.Other	Fin Bsmt Grade 2 100	1.Typical 4. 7.
2.Ranch 6.Split 10.Double	HEARTH 0	2.Inadeq 5. 8.
3.R Ranch 7.Mod/Cont 11.Multi	Heat Type 100% 1 Hot Water BB	3. 6. 9.
4.Cape 8.Log 12.Cot.	1.HWBB 5.FWA 9.No Heat	Attic 9 None
Dwelling Units 2	2.HWCI 6.GravWA 10.	1.1/4 Fin 4.Full Fin 7.
Other Units 0	3.H Pump 7.Electric 11.	2.1/2 Fin 5.F/Stair 8.
Stories 1 One Story	4.Steam 8.F/Wall 12.	3.3/4 Fin 6. 9.None
1.1 4.1.5 7.	Cool Type 0% 9 None	Insulation 1 Full
2.2 5.1.75 8.	1.Refrig 4.W&C Air 7.	1.Full 4.Minimal 7.
3.3 6.2.5 9.	2.Evapor 5. 8.	2.Heavy 5.Unknown 8.
Exterior Walls 1 CLAPBOARD	3.H Pump 6. 9.None	3.Capped 6. 9.None
1.CLAP 5.T-111 9.OTHER	Kitchen Style 2 TYPICAL	Unfinished % 0%
2.WD SH 6.BR/STONE 10.	1.GOOD 4.Obsolete 7.	Grade & Factor 2 Fair 100%
3.COMP 7.NOV 11.	2.TYPICAL 5. 8.	1.E Grade 4.B Grade 7.AA+ Grad
4.ASB/ASP 8.AL/VIN 12.	3.OLD TYPE 6. 9.None	2.D Grade 5.A Grade 8.AA++Grad
Roof Surface 1 Asphalt Shingles	Bath(s) Style 2 TYPICAL	3.C Grade 6.AA Grade 9.Same
1.Asphalt 4.Composit 7.	1.GOOD 4.Obsolete 7.	SQFT (Footprint) 1152
2.Slate 5.Wood 8.	2.TYPICAL 5. 8.	Condition 4 Average
3.Metal 6.Other 9.	3.Old Type 6. 9.None	1.Poor 4.Avg 7.V G
SF Masonry Trim 0	# Rooms 5	2.Fair 5.Avg+ 8.Exc
OPEN-3-CUSTOM 0	# Bedrooms 3	3.Avg- 6.Good 9.Same
OPEN-4-CUSTOM 0	# Full Baths 2	Phys. % Good 0%
Year Built 1960	# Half Baths 0	Funct. % Good 85%
Year Remodeled 0	# Addn Fixtures 0	Functional Code 1 Incomplete
Foundation 1 Concrete	# Fireplaces 0	1.Incomp 4.SMALL 7.LAYOUT
1.Concrete 4.Wood 7.		2.O-Built 5.CDU 8.OTHER
2.C Block 5.Slab 8.		3.Defmaint 6.STYLE 9.None
3.Br/Stone 6.Piers 9.		Econ. % Good 100%
Basement 4 Full Basement		Economic Code None
1.1/4 Bmt 4.Full Bmt 7.		0.None 3.Services 9.None
2.1/2 Bmt 5.None 8.		1.Location 4.Traffic 8.
3.3/4 Bmt 6. 9.None		2.Encroach 8.Other 9.
Bsmt Gar # Cars 0		Entrance Code 5 Estimated
Wet Basement 1 Dry Basement		1.Interior 4.Vacant 7.
1.Dry 4. 7.		2.Refusal 5.Estimate 8.
2.Damp 5. 8.		3.Informed 6. 9.
3.Wet 6. 9.		Information Code 5 Estimate
		1.Owner 4.Agent 7.
		2.Relative 5.Estimate 8.
		3.Tenant 6.Other 9.

Date Inspected 11/30/2006

Additions, Outbuildings & Improvements

Type	Year	Units	Grade	Cond	Phys.	Funct.	Sound Value	
1 ONE STORY	0	396	0 0	0	0 %	0 %		1.ONE STORY FRAM
68 Wood Deck	0	176	0 0	0	0 %	0 %		2.TWO STORY FRAM
24 Frame Shed	0	80	3 100	3	0 %	100 %		3.THREE STORY FR
23 Frame Garage	0	462	3 100	4	0 %	100 %		4.1 & 1/2 STORY
					%	%		5.1 & 3/4 STORY
					%	%		6.2 & 1/2 STORY
					%	%		21.Open Frame Por
					%	%		22.Encl Frame Por
					%	%		23.Frame Garage
					%	%		24.Frame Shed
					%	%		25.Frame Bay Wind
					%	%		26.1SFr Overhang
					%	%		27.Unfin Basement
					%	%		28.Unfinished Att
					%	%		29.Finished Attic

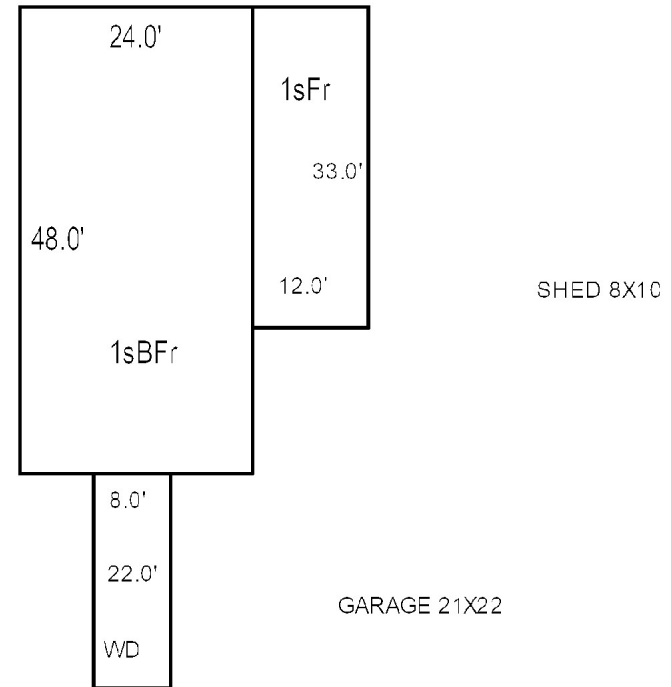

10/05/2023

Total Acreage 0.00

WISCASSET

Map Lot U08-005

Account 1568

Location FLOOD AVE/POTTLE COVE ROAD

Card 1 Of 1 10/05/2023

Building Style			SF Bsmt Living			Layout		
1.Conv.	5.Colonial	9.Other	Fin Bsmt Grade			1.Typical 4. 7.		
2.Ranch	6.Split	10.Double	HEARTH			2.Inadeq 5. 8.		
3.R Ranch	7.Mod/Cont	11.Multi	Heat Type 100%			3. 6. 9.		
4.Cape	8.Log	12.Cot.	1.HWBB 5.FWA 9.No Heat			Attic		
Dwelling Units			2.HWCI 6.GravWA 10.			1.1/4 Fin 4.Full Fin 7.		
Other Units			3.H Pump 7.Electric 11.			2.1/2 Fin 5.F/Stair 8.		
Stories			4.Steam 8.F/Wall 12.			3.3/4 Fin 6. 9.None		
1.1	4.1.5	7.	Cool Type 0%			Insulation		
2.2	5.1.75	8.	1.Refrig 4.W&C Air 7.			1.Full 4.Minimal 7.		
3.3	6.2.5	9.	2.Evapor 5. 8.			2.Heavy 5.Unknown 8.		
Exterior Walls			3.H Pump 6. 9.None			3.Capped 6. 9.None		
1.CLAP	5.T-111	9.OTHER	Kitchen Style			Unfinished %		
2.WD SH	6.BR/STONE	10.	1.GOOD 4.Obsolete 7.			Grade & Factor		
3.COMP	7.NOV	11.	2.TYPICAL 5. 8.			1.E Grade 4.B Grade 7.AA+ Grad		
4.ASB/ASP	8.AL/VIN	12.	3.OLD TYPE 6. 9.None			2.D Grade 5.A Grade 8.AA++Grad		
Roof Surface			Bath(s) Style			3.C Grade 6.AA Grade 9.Same		
1.Asphalt	4.Composit	7.	1.GOOD 4.Obsolete 7.			SQFT (Footprint)		
2.Slate	5.Wood	8.	2.TYPICAL 5. 8.			Condition		
3.Metal	6.Other	9.	3.Old Type 6. 9.None			1.Poor 4.Avg 7.V G		
SF Masonry Trim			# Rooms			2.Fair 5.Avg+ 8.Exc		
OPEN-3-CUSTOM			# Bedrooms			3.Avg- 6.Good 9.Same		
OPEN-4-CUSTOM			# Full Baths			Phys. % Good		
Year Built			# Half Baths			Funct. % Good		
Year Remodeled			# Addn Fixtures			Functional Code		
Foundation			# Fireplaces			1.Incomp 4.SMALL 7.LAYOUT		
1.Concrete	4.Wood	7.				2.O-Built 5.CDU 8.OTHER		
2.C Block	5.Slab	8.				3.Defmoint 6.STYLE 9.None		
3.Br/Stone	6.Piers	9.				Econ. % Good		
Basement						Economic Code		
1.1/4 Bmt	4.Full Bmt	7.				0.None 3.Services 9.None		
2.1/2 Bmt	5.None	8.				1.Location 4.Traffic 8.		
3.3/4 Bmt	6.	9.None				2.Encroach 8.Other 9.		
Bsmt Gar # Cars						Entrance Code 5 Estimated		
Wet Basement						1.Interior 4.Vacant 7.		
1.Dry	4.	7.				2.Refusal 5.Estimate 8.		
2.Damp	5.	8.	3.Informed 6. 9.					
3.Wet	6.	9.	Information Code 5 Estimate					
			1.Owner 4.Agent 7.					
			2.Relative 5.Estimate 8.					
			3.Tenant 6.Other 9.					
Date Inspected 2/17/2007								1.ONE STORY FRAM
Additions, Outbuildings & Improvements								2.TWO STORY FRAM
Type	Year	Units	Grade	Cond	Phys.	Funct.	Sound Value	3.THREE STORY FR
					%	%		4.1 & 1/2 STORY
					%	%		5.1 & 3/4 STORY
					%	%		6.2 & 1/2 STORY
					%	%		21.Open Frame Por
					%	%		22.Encl Frame Por
					%	%		23.Frame Garage
					%	%		24.Frame Shed
					%	%		25.Frame Bay Wind
					%	%		26.1SFr Overhang
					%	%		27.Unfin Basement
					%	%		28.Unfinished Att
					%	%		29.Finished Attic