



# WISCASSET

Map Lot U20-001



Account 1824

Location 112 CHEWONKI NECK ROAD

Card 1

Of 1

9/25/2024

Building Style	SF Bsmt Living	Layout
1.Conv. 5.Colonial 9.Other	Fin Bsmt Grade	1.Typical 4. 7.
2.Ranch 6.Split 10.Double	HEARTH	2.Inadeq 5. 8.
3.R Ranch 7.Mod/Cont 11.Multi	Heat Type <b>100%</b>	3. 6. 9.
4.Cape 8.Log 12.Cot.	1.HWBB 5.FWA 9.No Heat	Attic
Dwelling Units	2.HWCI 6.GravWA 10.	1.1/4 Fin 4.Full Fin 7.
Other Units	3.H Pump 7.Electric 11.	2.1/2 Fin 5.F/Stair 8.
Stories	4.Steam 8.F/Wall 12.	3.3/4 Fin 6. 9.None
1.1 4.1.5 7.	Cool Type <b>0%</b>	Insulation
2.2 5.1.75 8.	1.Refrig 4.W&C Air 7.	1.Full 4.Minimal 7.
3.3 6.2.5 9.	2.Evapor 5. 8.	2.Heavy 5.Unknown 8.
Exterior Walls	3.H Pump 6. 9.None	3.Capped 6. 9.None
1.CLAP 5.T-111 9.OTHER	Kitchen Style	Unfinished %
2.WD SH 6.BR/STONE 10.	1.GOOD 4.Obsolete 7.	Grade & Factor
3.COMP 7.NOV 11.	2.TYPICAL 5. 8.	1.E Grade 4.B Grade 7.AA+ Grad
4.ASB/ASP 8.AL/VIN 12.	3.OLD TYPE 6. 9.None	2.D Grade 5.A Grade 8.AA++Grad
Roof Surface	Bath(s) Style	3.C Grade 6.AA Grade 9.Same
1.Asphalt 4.Composit 7.	1.GOOD 4.Obsolete 7.	SQFT (Footprint)
2.Slate 5.Wood 8.	2.TYPICAL 5. 8.	Condition
3.Metal 6.Other 9.	3.Old Type 6. 9.None	1.Poor 4.Avg 7.V G
SF Masonry Trim	# Rooms	2.Fair 5.Avg+ 8.Exc
OPEN-3-CUSTOM	# Bedrooms	3.Avg- 6.Good 9.Same
OPEN-4-CUSTOM	# Full Baths	Phys. % Good
Year Built	# Half Baths	Funct. % Good
Year Remodeled	# Addn Fixtures	Functional Code
Foundation	# Fireplaces	1.Incomp 4.SMALL 7.LAYOUT
1.Concrete 4.Wood 7.		2.O-Built 5.CDU 8.OTHER
2.C Block 5.Slab 8.		3.Defmaint 6.STYLE 9.None
3.Br/Stone 6.Piers 9.		Econ. % Good
Basement		Economic Code
1.1/4 Bmt 4.Full Bmt 7.		0.None 3.Services 9.None
2.1/2 Bmt 5.None 8.		1.Location 4.Traffic 8.
3.3/4 Bmt 6. 9.None		2.Encroach 8.Other 9.
Bsmt Gar # Cars		Entrance Code <b>1 Interior Inspect</b>
Wet Basement		1.Interior 4.Vacant 7.
1.Dry 4. 7.		2.Refusal 5.Estimate 8.
2.Damp 5. 8.		3.Informed 6. 9.
3.Wet 6. 9.		Information Code <b>4 Agent</b>
		1.Owner 4.Agent 7.
		2.Relative 5.Estimate 8.
		3.Tenant 6.Other 9.

Date Inspected 12/09/2006

## Additions, Outbuildings & Improvements

Type	Year	Units	Grade	Cond	Phys.	Funct.	Sound Value	
267 WAREHOUSE	1970	2790	4 100	4	0 %	100 %		1.ONE STORY FRAM
271 OFFICE MEZZ	0	1550	3 100	4	0 %	100 %		2.TWO STORY FRAM
267 WAREHOUSE	0	3200	3 100	4	0 %	80 %		3.THREE STORY FR
24 Frame Shed	0	80	2 100	4	0 %	80 %		4.1 & 1/2 STORY
344 PAVING.....	1970	255000	4 100	4	0 %	50 %		5.1 & 3/4 STORY
344 PAVING.....	1970	148500	4 100	4	0 %	50 %		6.2 & 1/2 STORY
344 PAVING.....	1970	196290	3 100	4	0 %	50 %		21.Open Frame Por
344 PAVING.....	1970	10000	3 100	4	0 %	50 %		22.Encl Frame Por
344 PAVING.....	1970	722832	3 100	4	0 %	50 %		23.Frame Garage
267 WAREHOUSE	2009	2500	4 100	4	0 %	100 %		24.Frame Shed
								25.Frame Bay Wind
								26.1SFr Overhang
								27.Unfin Basement
								28.Unfinished Att
								29.Finished Attic

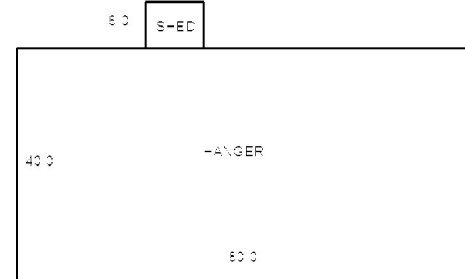
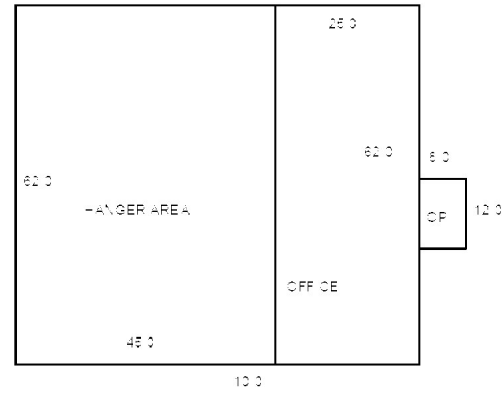

SOULE, RAYMOND WISCASSET ME 04578			Property Data			Assessment Record					
			Neighborhood <b>109 SOUTHEAST</b>			Year	Land	Buildings	Exempt	Total	
			Tree Growth Year <b>0</b>			2011	0	50,800	0	50,800	
			FARM LAND YEAR <b>0</b>			2012	0	50,800	0	50,800	
			OPEN SPACE YEAR <b>0</b>			2013	0	50,800	0	50,800	
Previous Owner BOUDIN, JR., KENNETH R.  166 WEST ALNA ROAD WISCASSET ME 04578			Zone/Land Use <b>11 SHORE RES PROTEC</b>			2014	0	50,800	0	50,800	
			Secondary Zone			2015	0	50,800	0	50,800	
						2016	0	50,800	0	50,800	
			Topography <b>1 Level</b>			2017	0	50,800	0	50,800	
			1.Level            4.Below St        7.Steep 2.Rolling        5.Low               8.Rough 3.Above St       6.Swampy           9.  Utilities <b>1 All Public</b>  1.Public            4.Dr Well            7.Cesspool 2.Water            5.DUG/LAKE        8. 3.Sewer            6.Septic             9.None						2018	0	50,800
						2019	0	50,800	0	50,800	
						2020	0	50,800	0	50,800	
						2021	0	50,800	0	50,800	
						2022	0	38,100	0	38,100	
						2023	0	26,700	0	26,700	
Inspection Witnessed By:  											

**WISCASSET**

Map Lot U20-001-001

Account 1825

Location 112 CHEWONKI NECK ROAD BLD #4

Card 1 Of 1 9/25/2024

Building Style	SF Bsmt Living	Layout
1.Conv. 5.Colonial 9.Other	Fin Bsmt Grade	1.Typical 4. 7.
2.Ranch 6.Split 10.Double	HEARTH	2.Inadeq 5. 8.
3.R Ranch 7.Mod/Cont 11.Multi	Heat Type <b>100%</b>	3. 6. 9.
4.Cape 8.Log 12.Cot.	1.HWBB 5.FWA 9.No Heat	Attic
Dwelling Units	2.HWCI 6.GravWA 10.	1.1/4 Fin 4.Full Fin 7.
Other Units	3.H Pump 7.Electric 11.	2.1/2 Fin 5.F/Stair 8.
Stories	4.Steam 8.F/Wall 12.	3.3/4 Fin 6. 9.None
1.1 4.1.5 7.	Cool Type <b>0%</b>	Insulation
2.2 5.1.75 8.	1.Refrig 4.W&C Air 7.	1.Full 4.Minimal 7.
3.3 6.2.5 9.	2.Evapor 5. 8.	2.Heavy 5.Unknown 8.
Exterior Walls	3.H Pump 6. 9.None	3.Capped 6. 9.None
1.CLAP 5.T-111 9.OTHER	Kitchen Style	Unfinished %
2.WD SH 6.BR/STONE 10.	1.GOOD 4.Obsolete 7.	Grade & Factor
3.COMP 7.NOV 11.	2.TYPICAL 5. 8.	1.E Grade 4.B Grade 7.AA+ Grad
4.ASB/ASP 8.AL/VIN 12.	3.OLD TYPE 6. 9.None	2.D Grade 5.A Grade 8.AA++Grad
Roof Surface	Bath(s) Style	3.C Grade 6.AA Grade 9.Same
1.Asphalt 4.Composit 7.	1.GOOD 4.Obsolete 7.	SQFT (Footprint)
2.Slate 5.Wood 8.	2.TYPICAL 5. 8.	Condition
3.Metal 6.Other 9.	3.Old Type 6. 9.None	1.Poor 4.Avg 7.V G
SF Masonry Trim	# Rooms	2.Fair 5.Avg+ 8.Exc
OPEN-3-CUSTOM	# Bedrooms	3.Avg- 6.Good 9.Same
OPEN-4-CUSTOM	# Full Baths	Phys. % Good
Year Built	# Half Baths	Funct. % Good
Year Remodeled	# Addn Fixtures	Functional Code
Foundation	# Fireplaces	1.Incomp 4.SMALL 7.LAYOUT
1.Concrete 4.Wood 7.		2.O-Built 5.CDU 8.OTHER
2.C Block 5.Slab 8.		3.Defmaint 6.STYLE 9.None
3.Br/Stone 6.Piers 9.		Econ. % Good
Basement		Economic Code
1.1/4 Bmt 4.Full Bmt 7.		0.None 3.Services 9.None
2.1/2 Bmt 5.None 8.		1.Location 4.Traffic 8.
3.3/4 Bmt 6. 9.None		2.Encroach 8.Other 9.
Bsmt Gar # Cars		Entrance Code <b>5 Estimated</b>
Wet Basement		1.Interior 4.Vacant 7.
1.Dry 4. 7.		2.Refusal 5.Estimate 8.
2.Damp 5. 8.		3.Informed 6. 9.
3.Wet 6. 9.		Information Code <b>5 Estimate</b>
		1.Owner 4.Agent 7.
		2.Relative 5.Estimate 8.
		3.Tenant 6.Other 9.

Date Inspected 12/09/2006

**Additions, Outbuildings & Improvements**

Type	Year	Units	Grade	Cond	Phys.	Funct.	Sound Value	
268 HANGAR STEEL	1990				%	%	26,700	1.ONE STORY FRAM
					%	%		2.TWO STORY FRAM
					%	%		3.THREE STORY FR
					%	%		4.1 & 1/2 STORY
					%	%		5.1 & 3/4 STORY
					%	%		6.2 & 1/2 STORY
					%	%		21.Open Frame Por
					%	%		22.Encl Frame Por
					%	%		23.Frame Garage
					%	%		24.Frame Shed
					%	%		25.Frame Bay Wind
					%	%		26.1SFr Overhang
					%	%		27.Unfin Basement
					%	%		28.Unfinished Att
					%	%		29.Finished Attic

STEEL HANGER

36.0'

42.0'



WILLIAMS WOODDEX BEARING CO. GEORGETOWN ME 04548			Property Data			Assessment Record							
			Neighborhood <b>109 SOUTHEAST</b>			Year	Land	Buildings	Exempt	Total			
						2011	0	44,300	0	44,300			
						2012	0	44,300	0	44,300			
			Tree Growth Year <b>0</b>			2013	0	44,300	0	44,300			
FARM LAND YEAR <b>0</b>			2014	0	44,300	0	44,300						
OPEN SPACE YEAR <b>0</b>			2015	0	44,300	0	44,300						
Zone/Land Use <b>11 SHORE RES PROTEC</b>			2016	0	44,300	0	44,300						
			Secondary Zone			2017	0	44,300	0	44,300			
						2018	0	44,300	0	44,300			
			Topography <b>1 Level</b>			2019	0	44,300	0	44,300			
1.Level               4.Below St       7.Steep 2.Rolling           5.Low               8.Rough 3.Above St       6.Swampy       9.			2020	0	44,300	0	44,300						
			Utilities <b>1 All Public</b>			2021	0	44,300	0	44,300			
						2022	0	44,300	0	44,300			
			1.Public               4.Dr Well       7.Cesspool 2.Water               5.DUG/LAKE   8. 3.Sewer               6.Septic       9.None			2023	0	31,000	0	31,000			
Street <b>1 Paved</b>			2024	0	31,000	0	31,000						
			1.Paved               4.Proposed       7. 2.Semi Imp           5.Private       8. 3.Gravel              6.Pub Eas       9.NoStreet			Land Data							
						Front Foot		Type	Effective		Influence		Influence Codes
									Frontage	Depth	Factor	Code	
Inspection Witnessed By:			11.Regular Lot 12.Delta Triangle 13.Nabla Triangle 14.Rear Land 15.Front Foot							1.Open Space			
							%		2.Neighborhood A				
							%		3.Topography				
							%		4.Size/Shape				
							%		5.Access				
X							%		6.Restriction				
							%		7.Corner/Locatio				
							%		8.View/Environ				
							%		9.Fract Share				
							%		<b>Acres</b>				
No./Date			Square Foot		Square Feet				30.Rear 20+				
						%		31.Waterfront Rea					
						%		32.Open Space					
						%		33.RestrictEsm					
						%		34.PASTURE 1					
Description							%		35.HORTICULTURAL-				
							%		36.Pasture 3				
							%		37.Softwood				
							%		38.Mixed Wood				
							%		39.Hardwood				
Date Insp.							%		40.Wasteland				
							%		41.CAMP SITE				
							%		42.Mobile Home Si				
							%		43.Condo Site				
							%		44.Site Improveme				
Notes:					Total Acreage		0.00		45.CAMP SITE				
								46.PAVING/00					
'23 Reduce Hanger value by 30%.			Fract. Acre		Acreage/Sites								
							%						
							%						
							%						
							%						
Validity			21.HS Size Adj 22.Base Waterfron 23.Deep WF Size A										
3.Distress       6.Exempt       9.Foreclose			Acres										
Verified			24.Base Waterfron 25.Shallow WF Siz 26.Base Water Inf 27.Influence W Si 28.Rear Land 1-10 29.Rear Land 11-2										
1.Buyer           4.Agent       7.Family 2.Seller           5.Pub Rec   8.Other 3.Lender           6.MLS       9.													

WISCASSET

**WISCASSET**

Map Lot U20-001-002

Account 1826

Location 112 CHEWONKI NECK ROAD

Card 1 Of 1 9/25/2024

Building Style	SF Bsmt Living	Layout
1.Conv. 5.Colonial 9.Other	Fin Bsmt Grade	1.Typical 4. 7.
2.Ranch 6.Split 10.Double	HEARTH	2.Inadeq 5. 8.
3.R Ranch 7.Mod/Cont 11.Multi	Heat Type <b>100%</b>	3. 6. 9.
4.Cape 8.Log 12.Cot.	1.HWBB 5.FWA 9.No Heat	Attic
Dwelling Units	2.HWCI 6.GravWA 10.	1.1/4 Fin 4.Full Fin 7.
Other Units	3.H Pump 7.Electric 11.	2.1/2 Fin 5.F/Stair 8.
Stories	4.Steam 8.F/Wall 12.	3.3/4 Fin 6. 9.None
1.1 4.1.5 7.	Cool Type <b>0%</b>	Insulation
2.2 5.1.75 8.	1.Refrig 4.W&C Air 7.	1.Full 4.Minimal 7.
3.3 6.2.5 9.	2.Evapor 5. 8.	2.Heavy 5.Unknown 8.
Exterior Walls	3.H Pump 6. 9.None	3.Capped 6. 9.None
1.CLAP 5.T-111 9.OTHER	Kitchen Style	Unfinished %
2.WD SH 6.BR/STONE 10.	1.GOOD 4.Obsolete 7.	Grade & Factor
3.COMP 7.NOV 11.	2.TYPICAL 5. 8.	1.E Grade 4.B Grade 7.AA+ Grad
4.ASB/ASP 8.AL/VIN 12.	3.OLD TYPE 6. 9.None	2.D Grade 5.A Grade 8.AA++Grad
Roof Surface	Bath(s) Style	3.C Grade 6.AA Grade 9.Same
1.Asphalt 4.Composit 7.	1.GOOD 4.Obsolete 7.	SQFT (Footprint)
2.Slate 5.Wood 8.	2.TYPICAL 5. 8.	Condition
3.Metal 6.Other 9.	3.Old Type 6. 9.None	1.Poor 4.Avg 7.V G
SF Masonry Trim	# Rooms	2.Fair 5.Avg+ 8.Exc
OPEN-3-CUSTOM	# Bedrooms	3.Avg- 6.Good 9.Same
OPEN-4-CUSTOM	# Full Baths	Phys. % Good
Year Built	# Half Baths	Funct. % Good
Year Remodeled	# Addn Fixtures	Functional Code
Foundation	# Fireplaces	1.Incomp 4.SMALL 7.LAYOUT
1.Concrete 4.Wood 7.		2.O-Built 5.CDU 8.OTHER
2.C Block 5.Slab 8.		3.Defmaint 6.STYLE 9.None
3.Br/Stone 6.Piers 9.		Econ. % Good
Basement		Economic Code
1.1/4 Bmt 4.Full Bmt 7.		0.None 3.Services 9.None
2.1/2 Bmt 5.None 8.		1.Location 4.Traffic 8.
3.3/4 Bmt 6. 9.None		2.Encroach 8.Other 9.
Bsmt Gar # Cars		Entrance Code <b>5 Estimated</b>
Wet Basement		1.Interior 4.Vacant 7.
1.Dry 4. 7.		2.Refusal 5.Estimate 8.
2.Damp 5. 8.		3.Informed 6. 9.
3.Wet 6. 9.		Information Code <b>5 Estimate</b>
		1.Owner 4.Agent 7.
		2.Relative 5.Estimate 8.
		3.Tenant 6.Other 9.

Date Inspected 12/09/2006

**Additions, Outbuildings & Improvements**

Type	Year	Units	Grade	Cond	Phys.	Funct.	Sound Value	
268 HANGAR STEEL	1990				%	%	31,000	1.ONE STORY FRAM
					%	%		2.TWO STORY FRAM
					%	%		3.THREE STORY FR
					%	%		4.1 & 1/2 STORY
					%	%		5.1 & 3/4 STORY
					%	%		6.2 & 1/2 STORY
					%	%		21.Open Frame Por
					%	%		22.Encl Frame Por
					%	%		23.Frame Garage
					%	%		24.Frame Shed
					%	%		25.Frame Bay Wind
					%	%		26.1SFr Overhang
					%	%		27.Unfin Basement
					%	%		28.Unfinished Att
					%	%		29.Finished Attic

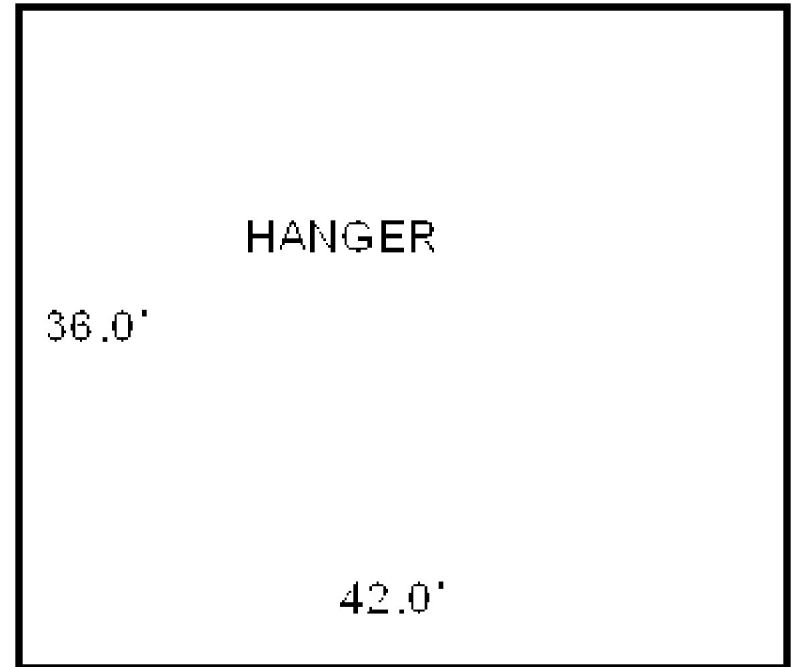

Map Lot U20-001-003

Account 2262

Location 112 CHEWONKI NECK ROAD

Card 1 Of 1 9/25/2024

HANGAR 5, LLC  
C/O CHUCK KINCER  
RICHMOND ME 04357

Previous Owner  
KINCER, CHARLES

14 CHURCH STREET  
RICHMOND ME 04357  
Sale Date: 2/12/2013

Previous Owner  
JACKSON JR., W. R.  
C/O CHARLES KINCER  
14 CHURCH STREET  
RICHMOND ME 04357  
Sale Date: 10/10/2012

Inspection Witnessed By:

X

Date

No./Date	Description	Date Insp.

Notes:

'23 Reduce Hanger value by 30%.  
10/10/2012-This hangar and land lease sold to Charles Kincer.

2/12/2013-This hangar is now in the name of Hangar 5 LLC.

WISCASSET

### Property Data

Neighborhood	109 SOUTHEAST		
Tree Growth Year	0		
FARM LAND YEAR	0		
OPEN SPACE YEAR	0		
Zone/Land Use	11 SHORE RES PROTEC		
Secondary Zone			
Topography	1 Level		
1.Level	4.Below St	7.Steep	
2.Rolling	5.Low	8.Rough	
3.Above St	6.Swampy	9.	
Utilities	1 All Public		
1.Public	4.Dr Well	7.Cesspool	
2.Water	5.DUG/LAKE	8.	
3.Sewer	6.Septic	9.None	
Street	1 Paved		
1.Paved	4.Proposed	7.	
2.Semi Imp	5.Private	8.	
3.Gravel	6.Pub Eas	9.NoStreet	
TREE GROWTH PLAN	0		
CONSERV EASE	0		
Sale Data			
Sale Date	2/12/2013		
Price			
Sale Type	3 Buildings Only		
1.Land	4.Mobile	7.	
2.L & B	5.Other	8.	
3.Building	6.	9.	
Financing	9 Unknown		
1.Convent	4.Seller	7.	
2.FHA/VA	5.Private	8.	
3.Assumed	6.Cash	9.Unknown	
Validity	1 Arms Length Sale		
1.Valid	4.Split	7.Renovate	
2.Related	5.Partial	8.Other	
3.Distress	6.Exempt	9.Foreclose	
Verified	1 Buyer		
1.Buyer	4.Agent	7.Family	
2.Seller	5.Pub Rec	8.Other	
3.Lender	6.MLS	9.	

### Assessment Record

Year	Land	Buildings	Exempt	Total
2011	0	46,900	0	46,900
2012	0	46,900	0	46,900
2013	0	46,900	0	46,900
2014	0	46,900	0	46,900
2015	0	46,900	0	46,900
2016	0	46,900	0	46,900
2017	0	46,900	0	46,900
2018	0	46,900	0	46,900
2019	0	46,900	0	46,900
2020	0	46,900	0	46,900
2021	0	46,900	0	46,900
2022	0	46,900	0	46,900
2023	0	32,800	0	32,800
2024	0	32,800	0	32,800

### Land Data

Front Foot	Type	Effective		Influence		Influence Codes
		Frontage	Depth	Factor	Code	
11.Regular Lot				%		1.Open Space
12.Delta Triangle				%		2.Neighborhood A
13.Nabla Triangle				%		3.Topography
14.Rear Land				%		4.Size/Shape
15.Front Foot				%		5.Access
				%		6.Restriction
				%		7.Corner/Locatio
				%		8.View/Environ
				%		9.Fract Share
				%		Acres
				%		30.Rear 20+
				%		31.Waterfront Rea
				%		32.Open Space
				%		33.RestrictEsm
				%		34.PASTURE 1
				%		35.HORTICULTURAL-
				%		36.Pasture 3
				%		37.Softwood
				%		38.Mixed Wood
				%		39.Hardwood
				%		40.Wasteland
				%		41.CAMP SITE
				%		42.Mobile Home Si
				%		43.Condo Site
				%		44.Site Improve
				%		45.CAMP SITE
				%		46.PAVING/00
Total Acreage		0.00				



**WISCASSET**

Map Lot U20-001-003

Account 2262

Location 112 CHEWONKI NECK ROAD

Card 1 Of 1 9/25/2024

Building Style			SF Bsmt Living			Layout					
1.Conv.	5.Colonial	9.Other	Fin Bsmt Grade			1.Typical	4.	7.			
2.Ranch	6.Split	10.Double	HEARTH			2.Inadeq	5.	8.			
3.R Ranch	7.Mod/Cont	11.Multi	Heat Type <b>100%</b>			3.	6.	9.			
4.Cape	8.Log	12.Cot.	1.HWBB	5.FWA	9.No Heat	Attic					
Dwelling Units			2.HWCI	6.GravWA	10.	1.1/4 Fin	4.Full Fin	7.			
Other Units			3.H Pump	7.Electric	11.	2.1/2 Fin	5.F/Stair	8.			
Stories			4.Steam	8.Fl/Wall	12.	3.3/4 Fin	6.	9.None			
1.1	4.1.5	7.	Cool Type <b>0%</b>			Insulation					
2.2	5.1.75	8.	1.Refrig	4.W&C Air	7.	1.Full	4.Minimal	7.			
3.3	6.2.5	9.	2.Evapor	5.	8.	2.Heavy	5.Unknown	8.			
Exterior Walls			3.H Pump	6.	9.None	3.Capped	6.	9.None			
1.CLAP	5.T-111	9.OTHER	Kitchen Style			Unfinished %					
2.WD SH	6.BR/STONE	10.	1.GOOD	4.Obsolete	7.	Grade & Factor					
3.COMP	7.NOV	11.	2.TYPICAL	5.	8.	1.E Grade	4.B Grade	7.AA+ Grad			
4.ASB/ASP	8.AL/VIN	12.	3.OLD TYPE	6.	9.None	2.D Grade	5.A Grade	8.AA++Grad			
Roof Surface			Bath(s) Style			3.C Grade	6.AA Grade	9.Same			
1.Asphalt	4.Composit	7.	1.GOOD	4.Obsolete	7.	SQFT (Footprint)					
2.Slate	5.Wood	8.	2.TYPICAL	5.	8.	Condition					
3.Metal	6.Other	9.	3.Old Type	6.	9.None	1.Poor	4.Avg	7.V G			
SF Masonry Trim			# Rooms			2.Fair	5.Avg+	8.Exc			
OPEN-3-CUSTOM			# Bedrooms			3.Avg-	6.Good	9.Same			
OPEN-4-CUSTOM			# Full Baths			Phys. % Good					
Year Built			# Half Baths			Funct. % Good					
Year Remodeled			# Addn Fixtures			Functional Code					
Foundation			# Fireplaces			1.Incomp	4.SMALL	7.LAYOUT			
1.Concrete	4.Wood	7.	<div><p><b>TRIO</b> Software A Division of Harris Computer Systems</p></div>						2.O-Built	5.CDU	8.OTHER
2.C Block	5.Slab	8.							3.Defmaint	6.STYLE	9.None
3.Br/Stone	6.Piers	9.							Econ. % Good		
Basement									Economic Code		
1.1/4 Bmt	4.Full Bmt	7.							0.None	3.Services	9.None
2.1/2 Bmt	5.None	8.							1.Location	4.Traffic	8.
3.3/4 Bmt	6.	9.None							2.Encroach	8.Other	9.
Bsmt Gar # Cars									Entrance Code <b>5 Estimated</b>		
Wet Basement									1.Interior	4.Vacant	7.
1.Dry	4.	7.							2.Refusal	5.Estimate	8.
2.Damp	5.	8.							3.Informed	6.	9.
3.Wet	6.	9.							Information Code <b>5 Estimate</b>		
									1.Owner	4.Agent	7.
									2.Relative	5.Estimate	8.
									3.Tenant	6.Other	9.

Date Inspected 12/09/2006

**Additions, Outbuildings & Improvements**

Type	Year	Units	Grade	Cond	Phys.	Funct.	Sound Value	
268 HANGAR STEEL	2001				%	%	32,800	1.ONE STORY FRAM
					%	%		2.TWO STORY FRAM
					%	%		3.THREE STORY FR
					%	%		4.1 & 1/2 STORY
					%	%		5.1 & 3/4 STORY
					%	%		6.2 & 1/2 STORY
					%	%		21.Open Frame Por
					%	%		22.Encl Frame Por
					%	%		23.Frame Garage
					%	%		24.Frame Shed
					%	%		25.Frame Bay Wind
					%	%		26.1SFr Overhang
					%	%		27.Unfin Basement
					%	%		28.Unfinished Att
					%	%		29.Finished Attic

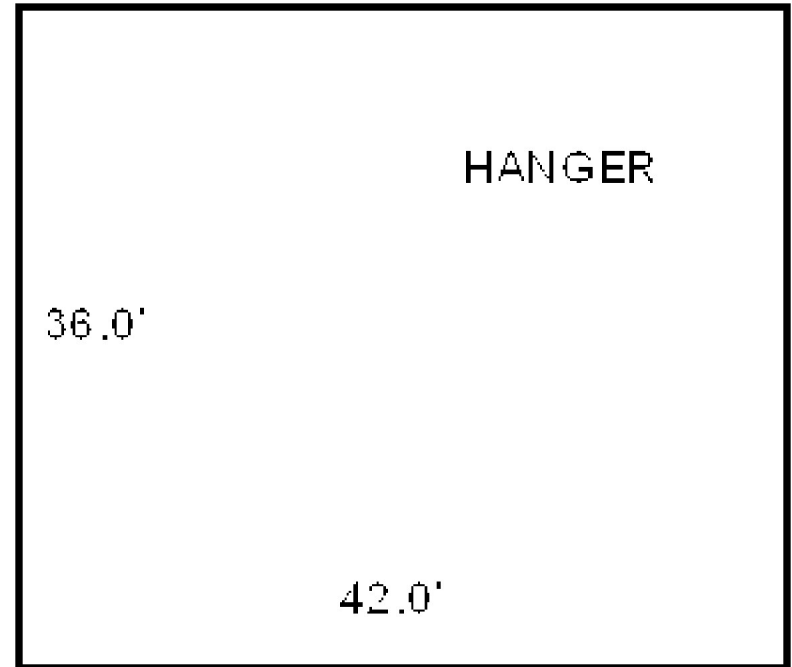



# WISCASSET

**WISCASSET**

Map Lot U20-001-004

Account 2263

Location 112 CHEWONKI NECK ROAD

Card 1 Of 1 9/25/2024

Building Style			SF Bsmt Living			Layout					
1.Conv.	5.Colonial	9.Other	Fin Bsmt Grade			1.Typical	4.	7.			
2.Ranch	6.Split	10.Double	HEARTH			2.Inadeq	5.	8.			
3.R Ranch	7.Mod/Cont	11.Multi	Heat Type <b>100%</b>			3.	6.	9.			
4.Cape	8.Log	12.Cot.	1.HWBB	5.FWA	9.No Heat	Attic					
Dwelling Units			2.HWCI	6.GravWA	10.	1.1/4 Fin	4.Full Fin	7.			
Other Units			3.H Pump	7.Electric	11.	2.1/2 Fin	5.F/Stair	8.			
Stories			4.Steam	8.FI/Wall	12.	3.3/4 Fin	6.	9.None			
1.1	4.1.5	7.	Cool Type <b>0%</b>			Insulation					
2.2	5.1.75	8.	1.Refrig	4.W&C Air	7.	1.Full	4.Minimal	7.			
3.3	6.2.5	9.	2.Evapor	5.	8.	2.Heavy	5.Unknown	8.			
Exterior Walls			3.H Pump	6.	9.None	3.Capped	6.	9.None			
1.CLAP	5.T-111	9.OTHER	Kitchen Style			Unfinished %					
2.WD SH	6.BR/STONE	10.	1.GOOD	4.Obsolete	7.	Grade & Factor					
3.COMP	7.NOV	11.	2.TYPICAL	5.	8.	1.E Grade	4.B Grade	7.AA+ Grad			
4.ASB/ASP	8.AL/VIN	12.	3.OLD TYPE	6.	9.None	2.D Grade	5.A Grade	8.AA++Grad			
Roof Surface			Bath(s) Style			3.C Grade	6.AA Grade	9.Same			
1.Asphalt	4.Composit	7.	1.GOOD	4.Obsolete	7.	SQFT (Footprint)					
2.Slate	5.Wood	8.	2.TYPICAL	5.	8.	Condition					
3.Metal	6.Other	9.	3.Old Type	6.	9.None	1.Poor	4.Avg	7.V G			
SF Masonry Trim			# Rooms			2.Fair	5.Avg+	8.Exc			
OPEN-3-CUSTOM			# Bedrooms			3.Avg-	6.Good	9.Same			
OPEN-4-CUSTOM			# Full Baths			Phys. % Good					
Year Built			# Half Baths			Funct. % Good					
Year Remodeled			# Addn Fixtures			Functional Code					
Foundation			# Fireplaces			1.Incomp	4.SMALL	7.LAYOUT			
1.Concrete	4.Wood	7.							2.O-Built	5.CDU	8.OTHER
2.C Block	5.Slab	8.							3.Defmaint	6.STYLE	9.None
3.Br/Stone	6.Piers	9.							Econ. % Good		
Economic Code											
Basement			0.None						3.Services	9.None	
1.1/4 Bmt	4.Full Bmt	7.	1.Location						4.Traffic	8.	
2.1/2 Bmt	5.None	8.	2.Encroach						8.Other	9.	
3.3/4 Bmt	6.	9.None	Entrance Code <b>5 Estimated</b>								
Bsmt Gar # Cars			1.Interior						4.Vacant	7.	
Wet Basement			2.Refusal						5.Estimate	8.	
1.Dry	4.	7.	3.Informed						6.	9.	
2.Damp	5.	8.	Information Code <b>5 Estimate</b>								
3.Wet	6.	9.	1.Owner						4.Agent	7.	
			2.Relative						5.Estimate	8.	
			3.Tenant						6.Other	9.	

Date Inspected 12/09/2006

**Additions, Outbuildings & Improvements**

Type	Year	Units	Grade	Cond	Phys.	Funct.	Sound Value	
268 HANGAR STEEL	2001				%	%	32,800	1.ONE STORY FRAM
					%	%		2.TWO STORY FRAM
					%	%		3.THREE STORY FR
					%	%		4.1 & 1/2 STORY
					%	%		5.1 & 3/4 STORY
					%	%		6.2 & 1/2 STORY
					%	%		21.Open Frame Por
					%	%		22.Encl Frame Por
					%	%		23.Frame Garage
					%	%		24.Frame Shed
					%	%		25.Frame Bay Wind
					%	%		26.1SFr Overhang
					%	%		27.Unfin Basement
					%	%		28.Unfinished Att
					%	%		29.Finished Attic

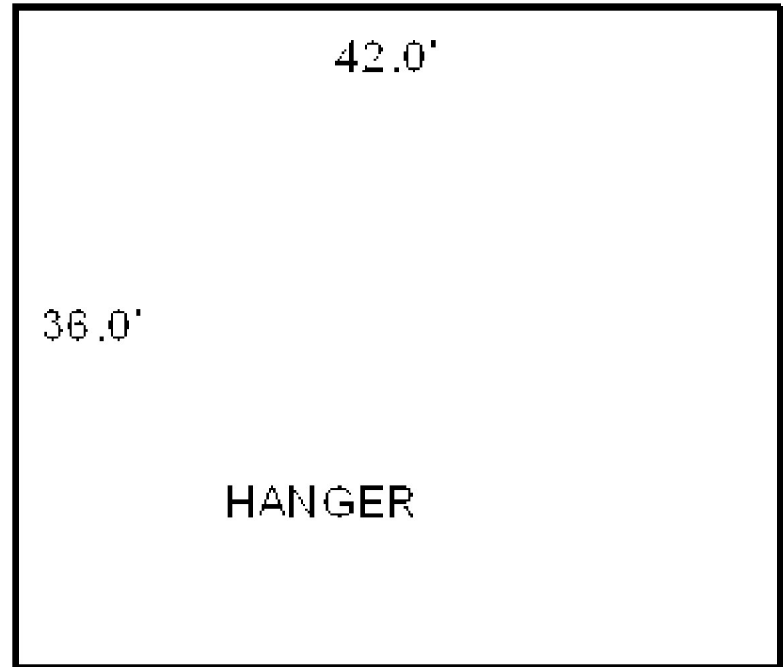

Map Lot		U20-001-005		Account		2264		Location		112 CHEWONKI NECK ROAD		Card		1		Of		1		9/25/2024	
<div>MUCHMORE, MICHAEL W. WALKO, ANN-MARIE WESTPORT ISLAND ME 04578  B3679P95 B3792P277 B5250P99</div>								Property Data				Assessment Record									
								Neighborhood 109 SOUTHEAST				Year		Land		Buildings		Exempt		Total	
								Tree Growth Year 0				2011		0		46,900		0		46,900	
								FARM LAND YEAR 0				2012		0		46,900		0		46,900	
								OPEN SPACE YEAR 0				2013		0		46,900		0		46,900	
<div>Previous Owner GREENWICH RESIDUAL VENTURES LLC MUCHMORE, MICHAEL W.  WESTPORT ISLAND ME 04578 Sale Date: 4/05/2018</div>								Zone/Land Use 11 SHORE RES PROTEC				2014		0		46,900		0		46,900	
								Secondary Zone				2015		0		46,900		0		46,900	
												2016		0		46,900		0		46,900	
												2017		0		46,900		0		46,900	
								Topography 1 Level				2018		0		46,900		0		46,900	
<div>Previous Owner WALKO, ANN-MARIE MUCHMORE, MICHAEL W.  WESTPORT ISLAND ME 04578 Sale Date: 12/28/2006</div>								1.Level 4.Below St 7.Steep 2.Rolling 5.Low 8.Rough 3.Above St 6.Swampy 9.				2019		0		46,900		0		46,900	
								Utilities 1 All Public				2020		0		46,900		0		46,900	
								1.Public 4.Dr Well 7.Cesspool 2.Water 5.DUG/LAKE 8. 3.Sewer 6.Septic 9.None				2021		0		46,900		0		46,900	
								Street 1 Paved				2022		0		46,900		0		46,900	
								1.Paved 4.Proposed 7. 2.Semi Imp 5.Private 8. 3.Gravel 6.Pub Eas 9.NoStreet				2023		0		32,800		0		32,800	
<div>673 BRIGHTON HILL ROAD MINOT ME 04258 Sale Date: 4/30/2006</div>								TREE GROWTH PLAN 0				2024		0		32,800		0		32,800	
								CONSERV EASE 0													
								Sale Data													
								Sale Date 4/05/2018													
								Price 30,000													
<div>Inspection Witnessed By:</div>								Sale Type 3 Buildings Only													
								1.Land 4.Mobile 7. 2.L & B 5.Other 8. 3.Building 6. 9.													
								Financing 9 Unknown													
								1.Convent 4.Seller 7. 2.FHA/VA 5.Private 8. 3.Assumed 6.Cash 9.Unknown													
								Validity 1 Arms Length Sale													
<div>X</div>								1.Valid 4.Split 7.Renovate 2.Related 5.Partial 8.Other 3.Distress 6.Exempt 9.Foreclose													
								Verified 5 Public Record													
								1.Buyer 4.Agent 7.Family 2.Seller 5.Pub Rec 8.Other 3.Lender 6.MLS 9.													
<div>Notes: '23 Reduce Hanger value by 30%. 2007-FORMER OWNER: THOMAS L. WALLACE WHO SOLD TO ANN-MARIE WALKO &amp; MICHAEL W. MUCHMORE 5/22/06 BK3679 PG95 WHO THEN SOLD TO GREENWICH RESIDUAL VENTURES 12/28/06 BK3792 PG277. FUNC=SIZE 2012-Transferred ownership from Greenwich Residual Ventures c/o Mike Muchmore &amp; Ann Walko.</div>																					
<div>WISCASSET</div>																					
No./Date		Description					Date Insp.		Front Foot		Type		Effective		Influence		Influence Codes				
									11.Regular Lot				Frontage		Depth		1.Open Space				
									12.Delta Triangle								2.Neighborhood A				
									13.Nabla Triangle								3.Topography				
									14.Rear Land								4.Size/Shape				
									15.Front Foot								5.Access				
																	6.Restriction				
																	7.Corner/Locatio				
																	8.View/Environ				
																	9.Fract Share				
																	Acres				
																	30.Rear 20+				
																	31.Waterfront Rea				
																	32.Open Space				
																	33.RestrictEsm				
																	34.PASTURE 1				
																	35.HORTICULTURAL-				
																	36.Pasture 3				
																	37.Softwood				
																	38.Mixed Wood				
																	39.Hardwood				
																	40.Wasteland				
																	41.CAMP SITE				
																	42.Mobile Home Si				
																	43.Condo Site				
																	44.Site Improve				
																	45.CAMP SITE				
																	46.PAVING/00				

**WISCASSET**

Map Lot U20-001-005

Account 2264

Location 112 CHEWONKI NECK ROAD

Card 1 Of 1 9/25/2024

Building Style			SF Bsmt Living			Layout		
1.Conv.	5.Colonial	9.Other	Fin Bsmt Grade			1.Typical	4.	7.
2.Ranch	6.Split	10.Double	HEARTH			2.Inadeq	5.	8.
3.R Ranch	7.Mod/Cont	11.Multi	Heat Type <b>100%</b>			3.	6.	9.
4.Cape	8.Log	12.Cot.	1.HWBB	5.FWA	9.No Heat	Attic		
Dwelling Units			2.HWCI	6.GravWA	10.	1.1/4 Fin	4.Full Fin	7.
Other Units			3.H Pump	7.Electric	11.	2.1/2 Fin	5.F/Stair	8.
Stories			4.Steam	8.FI/Wall	12.	3.3/4 Fin	6.	9.None
1.1	4.1.5	7.	Cool Type <b>0%</b>			Insulation		
2.2	5.1.75	8.	1.Refrig	4.W&C Air	7.	1.Full	4.Minimal	7.
3.3	6.2.5	9.	2.Evapor	5.	8.	2.Heavy	5.Unknown	8.
Exterior Walls			3.H Pump	6.	9.None	3.Capped	6.	9.None
1.CLAP	5.T-111	9.OTHER	Kitchen Style			Unfinished %		
2.WD SH	6.BR/STONE	10.	1.GOOD	4.Obsolete	7.	Grade & Factor		
3.COMP	7.NOV	11.	2.TYPICAL	5.	8.	1.E Grade	4.B Grade	7.AA+ Grad
4.ASB/ASP	8.AL/VIN	12.	3.OLD TYPE	6.	9.None	2.D Grade	5.A Grade	8.AA++Grad
Roof Surface			Bath(s) Style			3.C Grade	6.AA Grade	9.Same
1.Asphalt	4.Composit	7.	1.GOOD	4.Obsolete	7.	SQFT (Footprint)		
2.Slate	5.Wood	8.	2.TYPICAL	5.	8.	Condition		
3.Metal	6.Other	9.	3.Old Type	6.	9.None	1.Poor	4.Avg	7.V G
SF Masonry Trim			# Rooms			2.Fair	5.Avg+	8.Exc
OPEN-3-CUSTOM			# Bedrooms			3.Avg-	6.Good	9.Same
OPEN-4-CUSTOM			# Full Baths			Phys. % Good		
Year Built			# Half Baths			Funct. % Good		
Year Remodeled			# Addn Fixtures			Functional Code		
Foundation			# Fireplaces			1.Incomp	4.SMALL	7.LAYOUT
1.Concrete	4.Wood	7.	<div><p><b>TRIO</b> Software A Division of Harris Computer Systems</p></div>			2.O-Built	5.CDU	8.OTHER
2.C Block	5.Slab	8.				3.Defmaint	6.STYLE	9.None
3.Br/Stone	6.Piers	9.				Econ. % Good		
Basement						Economic Code		
1.1/4 Bmt	4.Full Bmt	7.				0.None	3.Services	9.None
2.1/2 Bmt	5.None	8.				1.Location	4.Traffic	8.
3.3/4 Bmt	6.	9.None				2.Encroach	8.Other	9.
Bsmt Gar # Cars						Entrance Code <b>0</b>		
Wet Basement						1.Interior	4.Vacant	7.
1.Dry	4.	7.				2.Refusal	5.Estimate	8.
2.Damp	5.	8.				3.Informed	6.	9.
3.Wet	6.	9.				Information Code <b>0</b>		
						1.Owner	4.Agent	7.
						2.Relative	5.Estimate	8.
						3.Tenant	6.Other	9.

Date Inspected

Date Inspected

**Additions, Outbuildings & Improvements**

Type	Year	Units	Grade	Cond	Phys.	Funct.	Sound Value	
268 HANGAR STEEL	2001				%	%	32,800	1.ONE STORY FRAM
					%	%		2.TWO STORY FRAM
					%	%		3.THREE STORY FR
					%	%		4.1 & 1/2 STORY
					%	%		5.1 & 3/4 STORY
					%	%		6.2 & 1/2 STORY
					%	%		21.Open Frame Por
					%	%		22.Encl Frame Por
					%	%		23.Frame Garage
					%	%		24.Frame Shed
					%	%		25.Frame Bay Wind
					%	%		26.1SFr Overhang
					%	%		27.Unfin Basement
					%	%		28.Unfinished Att
					%	%		29.Finished Attic



# WISCASSET

**WISCASSET**

Map Lot U20-001-006

Account 2265

Location 112 CHEWONKI NECK ROAD

Card 1 Of 1 9/25/2024

Building Style	SF Bsmt Living	Layout
1.Conv. 5.Colonial 9.Other	Fin Bsmt Grade	1.Typical 4. 7.
2.Ranch 6.Split 10.Double	HEARTH	2.Inadeq 5. 8.
3.R Ranch 7.Mod/Cont 11.Multi	Heat Type <b>100%</b>	3. 6. 9.
4.Cape 8.Log 12.Cot.	1.HWBB 5.FWA 9.No Heat	Attic
Dwelling Units	2.HWCI 6.GravWA 10.	1.1/4 Fin 4.Full Fin 7.
Other Units	3.H Pump 7.Electric 11.	2.1/2 Fin 5.F/Stair 8.
Stories	4.Steam 8.F/Wall 12.	3.3/4 Fin 6. 9.None
1.1 4.1.5 7.	Cool Type <b>0%</b>	Insulation
2.2 5.1.75 8.	1.Refrig 4.W&C Air 7.	1.Full 4.Minimal 7.
3.3 6.2.5 9.	2.Evapor 5. 8.	2.Heavy 5.Unknown 8.
Exterior Walls	3.H Pump 6. 9.None	3.Capped 6. 9.None
1.CLAP 5.T-111 9.OTHER	Kitchen Style	Unfinished %
2.WD SH 6.BR/STONE 10.	1.GOOD 4.Obsolete 7.	Grade & Factor
3.COMP 7.NOV 11.	2.TYPICAL 5. 8.	1.E Grade 4.B Grade 7.AA+ Grad
4.ASB/ASP 8.AL/VIN 12.	3.OLD TYPE 6. 9.None	2.D Grade 5.A Grade 8.AA++Grad
Roof Surface	Bath(s) Style	3.C Grade 6.AA Grade 9.Same
1.Asphalt 4.Composit 7.	1.GOOD 4.Obsolete 7.	SQFT (Footprint)
2.Slate 5.Wood 8.	2.TYPICAL 5. 8.	Condition
3.Metal 6.Other 9.	3.Old Type 6. 9.None	1.Poor 4.Avg 7.V G
SF Masonry Trim	# Rooms	2.Fair 5.Avg+ 8.Exc
OPEN-3-CUSTOM	# Bedrooms	3.Avg- 6.Good 9.Same
OPEN-4-CUSTOM	# Full Baths	Phys. % Good
Year Built	# Half Baths	Funct. % Good
Year Remodeled	# Addn Fixtures	Functional Code
Foundation	# Fireplaces	1.Incomp 4.SMALL 7.LAYOUT
1.Concrete 4.Wood 7.		2.O-Built 5.CDU 8.OTHER
2.C Block 5.Slab 8.		3.Defmaint 6.STYLE 9.None
3.Br/Stone 6.Piers 9.		Econ. % Good
Basement		Economic Code
1.1/4 Bmt 4.Full Bmt 7.		0.None 3.Services 9.None
2.1/2 Bmt 5.None 8.		1.Location 4.Traffic 8.
3.3/4 Bmt 6. 9.None		2.Encroach 8.Other 9.
Bsmt Gar # Cars		Entrance Code <b>5 Estimated</b>
Wet Basement		1.Interior 4.Vacant 7.
1.Dry 4. 7.		2.Refusal 5.Estimate 8.
2.Damp 5. 8.		3.Informed 6. 9.
3.Wet 6. 9.		Information Code <b>5 Estimate</b>
		1.Owner 4.Agent 7.
		2.Relative 5.Estimate 8.
		3.Tenant 6.Other 9.

Date Inspected 12/09/2006

**Additions, Outbuildings & Improvements**

Type	Year	Units	Grade	Cond	Phys.	Funct.	Sound Value	
268 HANGAR STEEL	2001				%	%	62,600	1.ONE STORY FRAM
					%	%		2.TWO STORY FRAM
					%	%		3.THREE STORY FR
					%	%		4.1 & 1/2 STORY
					%	%		5.1 & 3/4 STORY
					%	%		6.2 & 1/2 STORY
					%	%		21.Open Frame Por
					%	%		22.Encl Frame Por
					%	%		23.Frame Garage
					%	%		24.Frame Shed
					%	%		25.Frame Bay Wind
					%	%		26.1SFr Overhang
					%	%		27.Unfin Basement
					%	%		28.Unfinished Att
					%	%		29.Finished Attic

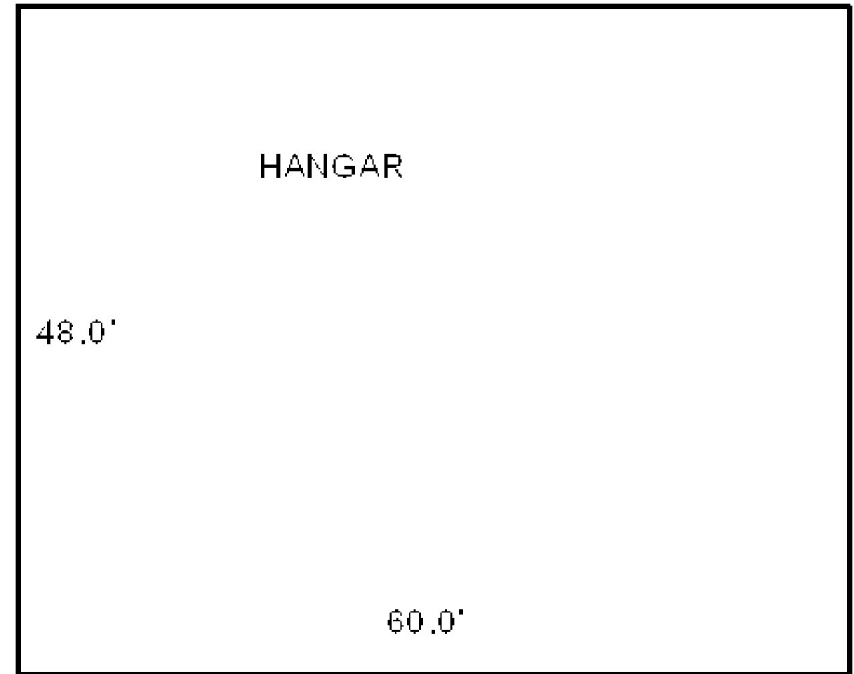



# WISCASSET



**WISCASSET**

Map Lot U20-001-007

Account 2266

Location 112 CHEWONKI NECK ROAD

Card 1 Of 1 9/25/2024

Building Style			SF Bsmt Living			Layout		
1.Conv.	5.Colonial	9.Other	Fin Bsmt Grade			1.Typical	4.	7.
2.Ranch	6.Split	10.Double	HEARTH			2.Inadeq	5.	8.
3.R Ranch	7.Mod/Cont	11.Multi	Heat Type <b>100%</b>			3.	6.	9.
4.Cape	8.Log	12.Cot.	1.HWBB	5.FWA	9.No Heat	Attic		
Dwelling Units			2.HWCI	6.GravWA	10.	1.1/4 Fin	4.Full Fin	7.
Other Units			3.H Pump	7.Electric	11.	2.1/2 Fin	5.F/Stair	8.
Stories			4.Steam	8.FI/Wall	12.	3.3/4 Fin	6.	9.None
1.1	4.1.5	7.	Cool Type <b>0%</b>			Insulation		
2.2	5.1.75	8.	1.Refrig	4.W&C Air	7.	1.Full	4.Minimal	7.
3.3	6.2.5	9.	2.Evapor	5.	8.	2.Heavy	5.Unknown	8.
Exterior Walls			3.H Pump	6.	9.None	3.Capped	6.	9.None
1.CLAP	5.T-111	9.OTHER	Kitchen Style			Unfinished %		
2.WD SH	6.BR/STONE	10.	1.GOOD	4.Obsolete	7.	Grade & Factor		
3.COMP	7.NOV	11.	2.TYPICAL	5.	8.	1.E Grade	4.B Grade	7.AA+ Grad
4.ASB/ASP	8.AL/VIN	12.	3.OLD TYPE	6.	9.None	2.D Grade	5.A Grade	8.AA++Grad
Roof Surface			Bath(s) Style			3.C Grade	6.AA Grade	9.Same
1.Asphalt	4.Composit	7.	1.GOOD	4.Obsolete	7.	SQFT (Footprint)		
2.Slate	5.Wood	8.	2.TYPICAL	5.	8.	Condition		
3.Metal	6.Other	9.	3.Old Type	6.	9.None	1.Poor	4.Avg	7.V G
SF Masonry Trim			# Rooms			2.Fair	5.Avg+	8.Exc
OPEN-3-CUSTOM			# Bedrooms			3.Avg-	6.Good	9.Same
OPEN-4-CUSTOM			# Full Baths			Phys. % Good		
Year Built			# Half Baths			Funct. % Good		
Year Remodeled			# Addn Fixtures			Functional Code		
Foundation			# Fireplaces			1.Incomp	4.SMALL	7.LAYOUT
1.Concrete	4.Wood	7.				2.O-Built	5.CDU	8.OTHER
2.C Block	5.Slab	8.				3.Defmaint	6.STYLE	9.None
3.Br/Stone	6.Piers	9.				Econ. % Good		
Basement						Economic Code		
1.1/4 Bmt	4.Full Bmt	7.				0.None	3.Services	9.None
2.1/2 Bmt	5.None	8.				1.Location	4.Traffic	8.
3.3/4 Bmt	6.	9.None				2.Encroach	8.Other	9.
Bsmt Gar # Cars						Entrance Code <b>5 Estimated</b>		
Wet Basement						1.Interior	4.Vacant	7.
1.Dry	4.	7.				2.Refusal	5.Estimate	8.
2.Damp	5.	8.				3.Informed	6.	9.
3.Wet	6.	9.				Information Code <b>5 Estimate</b>		

Date Inspected 12/09/2006

**Additions, Outbuildings & Improvements**

Type	Year	Units	Grade	Cond	Phys.	Funct.	Sound Value	
268 HANGAR STEEL	2001				%	%	62,600	1.ONE STORY FRAM
					%	%		2.TWO STORY FRAM
					%	%		3.THREE STORY FR
					%	%		4.1 & 1/2 STORY
					%	%		5.1 & 3/4 STORY
					%	%		6.2 & 1/2 STORY
					%	%		21.Open Frame Por
					%	%		22.Encl Frame Por
					%	%		23.Frame Garage
					%	%		24.Frame Shed
					%	%		25.Frame Bay Wind
					%	%		26.1SFr Overhang
					%	%		27.Unfin Basement
					%	%		28.Unfinished Att
					%	%		29.Finished Attic

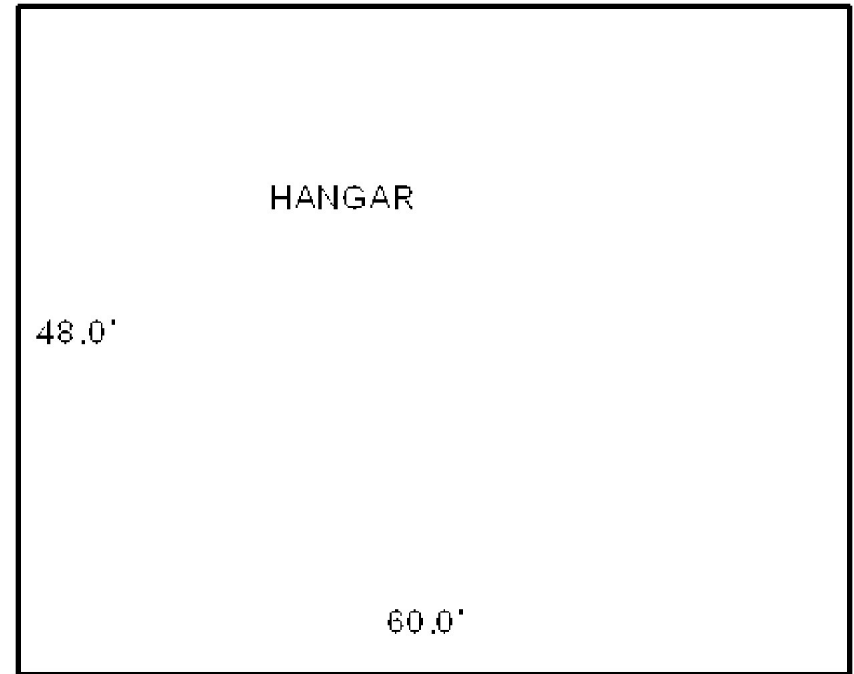

Map Lot    U20-001-008

Account    2581

Location    112 CHEWONKI NECK ROAD

Card    1    Of    1    9/25/2024

HEWITT, DAVID  
C/O PETER SHOREY  
NEWRY ME 04261

Property Data

Neighborhood    **109 SOUTHEAST**

Tree Growth Year    **0**

FARM LAND YEAR    **0**

OPEN SPACE YEAR    **0**

Zone/Land Use    **11 SHORE RES PROTEC**

Secondary Zone

Topography    **1 Level**

1.Level    4.Below St    7.Steep

2.Rolling    5.Low    8.Rough

3.Above St    6.Swampy    9.

Utilities    **1 All Public**

1.Public    4.Dr Well    7.Cesspool

2.Water    5.DUG/LAKE    8.

3.Sewer    6.Septic    9.None

Street    **1 Paved**

1.Paved    4.Proposed    7.

2.Semi Imp    5.Private    8.

3.Gravel    6.Pub Eas    9.NoStreet

TREE GROWTH PLAN    **0**

CONSERV EASE    **0**

Sale Data

Sale Date

Price

Sale Type

1.Land    4.Mobile    7.

2.L & B    5.Other    8.

3.Building    6.    9.

Financing

1.Convent    4.Seller    7.

2.FHA/VA    5.Private    8.

3.Assumed    6.Cash    9.Unknown

Validity

1.Valid    4.Split    7.Renovate

2.Related    5.Partial    8.Other

3.Distress    6.Exempt    9.Foreclose

Verified

1.Buyer    4.Agent    7.Family

2.Seller    5.Pub Rec    8.Other

3.Lender    6.MLS    9.

Assessment Record

Year

Land

Buildings

Exempt

Total

2011    0    96,300    0    96,300

2012    0    96,300    0    96,300

2013    0    96,300    0    96,300

2014    0    96,300    0    96,300

2015    0    96,300    0    96,300

2016    0    96,300    0    96,300

2017    0    96,300    0    96,300

2018    0    96,300    0    96,300

2019    0    96,300    0    96,300

2020    0    96,300    0    96,300

2021    0    96,300    0    96,300

2022    0    96,300    0    96,300

2023    0    67,400    0    67,400

2024    0    67,400    0    67,400

Land Data

Front Foot

Type

Effective

Frontage

Depth

Influence

Factor

Code

Influence Codes

11.Regular Lot

12.Delta Triangle

13.Nabla Triangle

14.Rear Land

15.Front Foot

Square Foot

Square Feet

16.Regular Lot

17.Secondary Site

18.Secondary Site

19.Condominium

20.Base Homesite

Fract. Acre

21.HS Size Adj

22.Base Waterfron

23.Deep WF Size A

Acres

24.Base Waterfron

25.Shallow WF Siz

26.Base Water Inf

27.Influence W Si

28.Rear Land 1-10

29.Rear Land 11-2

Total Acreage

0.00

1.Open Space

2.Neighborhood A

3.Topography

4.Size/Shape

5.Access

6.Restriction

7.Corner/Locatio

8.View/Environ

9.Fract Share

Acres

30.Rear 20+

31.Waterfront Rea

32.Open Space

33.RestrictEsm

34.PASTURE 1

35.HORTICULTURAL-

36.Pasture 3

37.Softwood

38.Mixed Wood

39.Hardwood

40.Wasteland

41.CAMP SITE

42.Mobile Home Si

43.Condo Site

44.Site Improve

45.CAMP SITE

46.PAVING/00

Inspection Witnessed By:

X

Date

No./Date

Description

Date Insp.

Notes:

'23 Reduce Hanger value by 30%.

WISCASSET



# WISCASSET

Map Lot U20-001-008

Account 2581

Location 112 CHEWONKI NECK ROAD

Card 1 Of 1 9/25/2024

Building Style	SF Bsmt Living	Layout
1.Conv. 5.Colonial 9.Other	Fin Bsmt Grade	1.Typical 4. 7.
2.Ranch 6.Split 10.Double	HEARTH	2.Inadeq 5. 8.
3.R Ranch 7.Mod/Cont 11.Multi	Heat Type <b>100%</b>	3. 6. 9.
4.Cape 8.Log 12.Cot.	1.HWBB 5.FWA 9.No Heat	Attic
Dwelling Units	2.HWCI 6.GravWA 10.	1.1/4 Fin 4.Full Fin 7.
Other Units	3.H Pump 7.Electric 11.	2.1/2 Fin 5.F/Stair 8.
Stories	4.Steam 8.F/Wall 12.	3.3/4 Fin 6. 9.None
1.1 4.1.5 7.	Cool Type <b>0%</b>	Insulation
2.2 5.1.75 8.	1.Refrig 4.W&C Air 7.	1.Full 4.Minimal 7.
3.3 6.2.5 9.	2.Evapor 5. 8.	2.Heavy 5.Unknown 8.
Exterior Walls	3.H Pump 6. 9.None	3.Capped 6. 9.None
1.CLAP 5.T-111 9.OTHER	Kitchen Style	Unfinished %
2.WD SH 6.BR/STONE 10.	1.GOOD 4.Obsolete 7.	Grade & Factor
3.COMP 7.NOV 11.	2.TYPICAL 5. 8.	1.E Grade 4.B Grade 7.AA+ Grad
4.ASB/ASP 8.AL/VIN 12.	3.OLD TYPE 6. 9.None	2.D Grade 5.A Grade 8.AA++Grad
Roof Surface	Bath(s) Style	3.C Grade 6.AA Grade 9.Same
1.Asphalt 4.Composit 7.	1.GOOD 4.Obsolete 7.	SQFT (Footprint)
2.Slate 5.Wood 8.	2.TYPICAL 5. 8.	Condition
3.Metal 6.Other 9.	3.Old Type 6. 9.None	1.Poor 4.Avg 7.V G
SF Masonry Trim	# Rooms	2.Fair 5.Avg+ 8.Exc
OPEN-3-CUSTOM	# Bedrooms	3.Avg- 6.Good 9.Same
OPEN-4-CUSTOM	# Full Baths	Phys. % Good
Year Built	# Half Baths	Funct. % Good
Year Remodeled	# Addn Fixtures	Functional Code
Foundation	# Fireplaces	1.Incomp 4.SMALL 7.LAYOUT
1.Concrete 4.Wood 7.		2.O-Built 5.CDU 8.OTHER
2.C Block 5.Slab 8.		3.Defmaint 6.STYLE 9.None
3.Br/Stone 6.Piers 9.		Econ. % Good
Basement		Economic Code
1.1/4 Bmt 4.Full Bmt 7.		0.None 3.Services 9.None
2.1/2 Bmt 5.None 8.		1.Location 4.Traffic 8.
3.3/4 Bmt 6. 9.None		2.Encroach 8.Other 9.
Bsmt Gar # Cars		Entrance Code <b>0</b>
Wet Basement		1.Interior 4.Vacant 7.
1.Dry 4. 7.		2.Refusal 5.Estimate 8.
2.Damp 5. 8.		3.Informed 6. 9.
3.Wet 6. 9.		Information Code <b>0</b>
		1.Owner 4.Agent 7.
		2.Relative 5.Estimate 8.
		3.Tenant 6.Other 9.

Date Inspected 6/01/2010

## Additions, Outbuildings & Improvements

Type	Year	Units	Grade	Cond	Phys.	Funct.	Sound Value	
268 HANGAR STEEL	2009				%	%	67,400	1.ONE STORY FRAM
					%	%		2.TWO STORY FRAM
					%	%		3.THREE STORY FR
					%	%		4.1 & 1/2 STORY
					%	%		5.1 & 3/4 STORY
					%	%		6.2 & 1/2 STORY
					%	%		21.Open Frame Por
					%	%		22.Encl Frame Por
					%	%		23.Frame Garage
					%	%		24.Frame Shed
					%	%		25.Frame Bay Wind
					%	%		26.1SFr Overhang
					%	%		27.Unfin Basement
					%	%		28.Unfinished Att
					%	%		29.Finished Attic

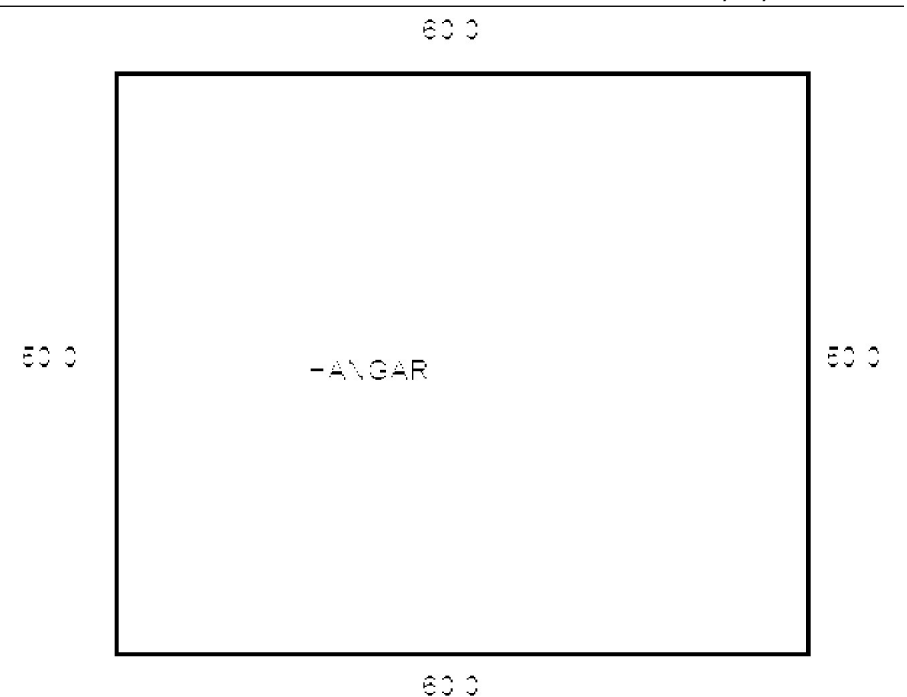

Map Lot    U20-001-SLR"ON"

Account    2802

Location    129 OLD FERRY ROAD

Card    1    Of    1    9/25/2024

MSD WISCASSET, LLC  
C/O BARKLAY DAMON, LLP  
SYRACUSE NY 13202

Property Data

Neighborhood    **109 SOUTHEAST**

Tree Growth Year    **0**

FARM LAND YEAR

OPEN SPACE YEAR

Zone/Land Use    **16 RESIDENTIAL**

Secondary Zone

Topography    **2 Rolling**

1.Level            4.Below St        7.Steep

2.Rolling        5.Low            8.Rough

3.Above St      6.Swampy        9.

Utilities

1.Public            4.Dr Well        7.Cesspool

2.Water            5.DUG/LAKE      8.

3.Sewer            6.Septic        9.None

Street    **1 Paved**

1.Paved            4.Proposed        7.

2.Semi Imp        5.Private        8.

3.Gravel            6.Pub Eas        9.NoStreet

TREE GROWTH PLAN    **0**

CONSERV EASE    **0**

Sale Data

Sale Date

Price

Sale Type

1.Land            4.Mobile        7.

2.L & B            5.Other        8.

3.Building        6.            9.

Financing

1.Convent        4.Seller        7.

2.FHA/VA        5.Private        8.

3.Assumed        6.Cash        9.Unknown

Validity

1.Valid            4.Split            7.Renovate

2.Related        5.Partial        8.Other

3.Distress        6.Exempt        9.Foreclose

Verified

1.Buyer            4.Agent        7.Family

2.Seller            5.Pub Rec      8.Other

3.Lender            6.MLS        9.

Assessment Record

Year

Land

Buildings

Exempt

Total

2024

0

2,721,400

2,721,400

0

Land Data

Front Foot

11.Regular Lot

12.Delta Triangle

13.Nabla Triangle

14.Rear Land

15.Front Foot

Square Foot

16.Regular Lot

17.Secondary Site

18.Secondary Site

19.Condominium

20.Base Homesite

Fract. Acre

21.HS Size Adj

22.Base Waterfron

23.Deep WF Size A

Acres

24.Base Waterfron

25.Shallow WF Siz

26.Base Water Inf

27.Influence W Si

28.Rear Land 1-10

29.Rear Land 11-2

Type

Effective

Influence

Influence Codes

Frontage

Depth

Factor

Code

Square Feet

Acres

Total Acreage

0.00

1.Open Space

2.Neighborhood A

3.Topography

4.Size/Shape

5.Access

6.Restriction

7.Corner/Locatio

8.View/Environ

9.Fract Share

Acres

30.Rear 20+

31.Waterfront Rea

32.Open Space

33.RestrictEsm

34.PASTURE 1

35.HORTICULTURAL-

36.Pasture 3

37.Softwood

38.Mixed Wood

39.Hardwood

40.Wasteland

41.CAMP SITE

42.Mobile Home Si

43.Condo Site

44.Site Improve

45.CAMP SITE

46.PAVING/00

Inspection Witnessed By:

X

Date

No./Date

Description

Date Insp.

Notes:

'24 New solar "ON" Exempt.

WISCASSET

**WISCASSET**

Map Lot U20-001-SLR"ON"

Account 2802

Location 129 OLD FERRY ROAD

Card 1 Of 1 9/25/2024

Building Style			SF Bsmt Living			Layout		
1.Conv.	5.Colonial	9.Other	Fin Bsmt Grade			1.Typical 4. 7.		
2.Ranch	6.Split	10.Double	HEARTH			2.Inadeq 5. 8.		
3.R Ranch	7.Mod/Cont	11.Multi	Heat Type <b>100%</b>			3. 6. 9.		
4.Cape	8.Log	12.Cot.	1.HWBB 5.FWA 9.No Heat			Attic		
Dwelling Units			2.HWCI 6.GravWA 10.			1.1/4 Fin 4.Full Fin 7.		
Other Units			3.H Pump 7.Electric 11.			2.1/2 Fin 5.F/Stair 8.		
Stories			4.Steam 8.F/Wall 12.			3.3/4 Fin 6. 9.None		
1.1	4.1.5	7.	Cool Type <b>0%</b>			Insulation		
2.2	5.1.75	8.	1.Refrig 4.W&C Air 7.			1.Full 4.Minimal 7.		
3.3	6.2.5	9.	2.Evapor 5. 8.			2.Heavy 5.Unknown 8.		
Exterior Walls			3.H Pump 6. 9.None			3.Capped 6. 9.None		
1.CLAP	5.T-111	9.OTHER	Kitchen Style			Unfinished %		
2.WD SH	6.BR/STONE	10.	1.GOOD 4.Obsolete 7.			Grade & Factor		
3.COMP	7.NOV	11.	2.TYPICAL 5. 8.			1.E Grade 4.B Grade 7.AA+ Grad		
4.ASB/ASP	8.AL/VIN	12.	3.OLD TYPE 6. 9.None			2.D Grade 5.A Grade 8.AA++Grad		
Roof Surface			Bath(s) Style			3.C Grade 6.AA Grade 9.Same		
1.Asphalt	4.Composit	7.	1.GOOD 4.Obsolete 7.			SQFT (Footprint)		
2.Slate	5.Wood	8.	2.TYPICAL 5. 8.			Condition		
3.Metal	6.Other	9.	3.Old Type 6. 9.None			1.Poor 4.Avg 7.V G		
SF Masonry Trim			# Rooms			2.Fair 5.Avg+ 8.Exc		
OPEN-3-CUSTOM			# Bedrooms			3.Avg- 6.Good 9.Same		
OPEN-4-CUSTOM			# Full Baths			Phys. % Good		
Year Built			# Half Baths			Funct. % Good		
Year Remodeled			# Addn Fixtures			Functional Code		
Foundation			# Fireplaces			1.Incomp 4.SMALL 7.LAYOUT		
1.Concrete	4.Wood	7.				2.O-Built 5.CDU 8.OTHER		
2.C Block	5.Slab	8.				3.Defmaint 6.STYLE 9.None		
3.Br/Stone	6.Piers	9.				Econ. % Good		
Basement						Economic Code		
1.1/4 Bmt	4.Full Bmt	7.				0.None 3.Services 9.None		
2.1/2 Bmt	5.None	8.				1.Location 4.Traffic 8.		
3.3/4 Bmt	6.	9.None				2.Encroach 8.Other 9.		
Bsmt Gar # Cars						Entrance Code <b>0</b>		
Wet Basement						1.Interior 4.Vacant 7.		
1.Dry	4.	7.				2.Refusal 5.Estimate 8.		
2.Damp	5.	8.	3.Informed 6. 9.					
3.Wet	6.	9.	Information Code <b>0</b>					
Date Inspected			1.Owner 4.Agent 7.			2.Relative 5.Estimate 8.		
			2.Relative 5.Estimate 8.			3.Tenant 6.Other 9.		
<b>Additions, Outbuildings &amp; Improvements</b>								1.ONE STORY FRAM
Type	Year	Units	Grade	Cond	Phys.	Funct.	Sound Value	2.TWO STORY FRAM
124 SOLAR PANELS	0				%	%	2,721,400	3.THREE STORY FR
					%	%		4.1 & 1/2 STORY
					%	%		5.1 & 3/4 STORY
					%	%		6.2 & 1/2 STORY
					%	%		21.Open Frame Por
					%	%		22.Encl Frame Por
					%	%		23.Frame Garage
					%	%		24.Frame Shed
					%	%		25.Frame Bay Wind
					%	%		26.1SFr Overhang
					%	%		27.Unfin Basement
					%	%		28.Unfinished Att
					%	%		29.Finished Attic



WILLIAMS, STEPHEN C J/T REECE, LISA R GEORGETOWN ME 04548			Property Data			Assessment Record							
			Neighborhood 109 SOUTHEAST			Year	Land	Buildings	Exempt	Total			
			Tree Growth Year 0			2011	40,700	61,900	0	102,600			
			FARM LAND YEAR 0			2012	40,700	61,900	0	102,600			
			OPEN SPACE YEAR 0			2013	40,700	61,900	0	102,600			
B4086P116			Zone/Land Use 21 RURAL			2014	40,700	61,900	0	102,600			
			Secondary Zone			2015	40,700	61,900	0	102,600			
						2016	40,700	61,900	0	102,600			
Previous Owner SHEA, CHARLES R. SHEA, FAYE J.			Topography 1 Level			2017	40,700	61,900	0	102,600			
			1.Level 4.Below St 7.Steep 2.Rolling 5.Low 8.Rough 3.Above St 6.Swampy 9.			2018	40,700	61,900	0	102,600			
						2019	40,700	61,900	0	102,600			
WISCASSET ME 04578 Sale Date: 11/26/2008			Utilities 1 All Public			2020	40,700	61,900	0	102,600			
			1.Public 4.Dr Well 7.Cesspool 2.Water 5.DUG/LAKE 8. 3.Sewer 6.Septic 9.None			2021	40,700	61,900	0	102,600			
						2022	40,700	61,900	0	102,600			
			Street 1 Paved			2023	50,900	77,400	0	128,300			
			1.Paved 4.Proposed 7. 2.Semi Imp 5.Private 8. 3.Gravel 6.Pub Eas 9.NoStreet			2024	50,900	77,400	0	128,300			
						Land Data							
Inspection Witnessed By:			Sale Data			Front Foot		Type	Effective		Influence		Influence Codes
									Frontage	Depth	Factor	Code	
X			Date			11.Regular Lot 12.Delta Triangle 13.Nabla Triangle 14.Rear Land 15.Front Foot		11.Regular Lot		11.Regular Lot		1.Open Space 2.Neighborhood A 3.Topography 4.Size/Shape 5.Access 6.Restriction 7.Corner/Locatio 8.View/Environ 9.Fract Share Acres 30.Rear 20+ 31.Waterfront Rea 32.Open Space 33.RestrictEsm 34.PASTURE 1 35.HORTICULTURAL- 36.Pasture 3 37.Softwood 38.Mixed Wood 39.Hardwood 40.Wasteland 41.CAMP SITE 42.Mobile Home Si 43.Condo Site 44.Site Improve 45.CAMP SITE 46.PAVING/00	
								12.Delta Triangle		12.Delta Triangle			
								13.Nabla Triangle		13.Nabla Triangle			
No./Date			Description			Date Insp.			14.Rear Land		14.Rear Land		
									15.Front Foot		15.Front Foot		
									16.Regular Lot		16.Regular Lot		
									17.Secondary Site		17.Secondary Site		
									18.Secondary Site		18.Secondary Site		
									19.Condominium		19.Condominium		
									20.Base Homesite		20.Base Homesite		
Notes:									Fract. Acre		Fract. Acre		
									21.HS Size Adj		21.HS Size Adj		
									22.Base Waterfron		22.Base Waterfron		
2007-put homestead exemption back on (think it got deleted when changed houses.)									23.Deep WF Size A		23.Deep WF Size A		
									Acres		Acres		
									24.Base Waterfron		24.Base Waterfron		
2008-Removed homestead exemption on this property and put one house they now live in next door.									25.Shallow WF Siz		25.Shallow WF Siz		
									26.Base Water Inf		26.Base Water Inf		
									27.Influence W Si		27.Influence W Si		
2009-Former owners: Charles & Faye Shea BK613 PG453.									28.Rear Land 1-10		28.Rear Land 1-10		
									29.Rear Land 11-2		29.Rear Land 11-2		
WISCASSET									Total Acreage		3.21		

# WISCASSET

Map Lot U20-002





Account 1827

Location 146 CHEWONKI NECK ROAD

Card 1

Of 1

9/25/2024

Building Style <b>2 Ranch</b>	SF Bsmt Living <b>0</b>	Layout <b>1 Typical</b>
1.Conv. 5.Colonial 9.Other	Fin Bsmt Grade <b>0 0</b>	1.Typical 4. 7.
2.Ranch 6.Split 10.Double	HEARTH <b>0</b>	2.Inadeq 5. 8.
3.R Ranch 7.Mod/Cont 11.Multi	Heat Type <b>100% 5 Forced Warm Air</b>	3. 6. 9.
4.Cape 8.Log 12.Cot.	1.HWBB 5.FWA 9.No Heat	Attic <b>9 None</b>
Dwelling Units <b>1</b>	2.HWCI 6.GravWA 10.	1.1/4 Fin 4.Full Fin 7.
Other Units <b>0</b>	3.H Pump 7.Electric 11.	2.1/2 Fin 5.F/Stair 8.
Stories <b>1 One Story</b>	4.Steam 8.F/Wall 12.	3.3/4 Fin 6. 9.None
1.1 4.1.5 7.	Cool Type <b>0% 9 None</b>	Insulation <b>1 Full</b>
2.2 5.1.75 8.	1.Refrig 4.W&C Air 7.	1.Full 4.Minimal 7.
3.3 6.2.5 9.	2.Evapor 5. 8.	2.Heavy 5.Unknown 8.
Exterior Walls <b>2 WOOD SHINGLE</b>	3.H Pump 6. 9.None	3.Capped 6. 9.None
1.CLAP 5.T-111 9.OTHER	Kitchen Style <b>2 TYPICAL</b>	Unfinished % <b>0%</b>
2.WD SH 6.BR/STONE 10.	1.GOOD 4.Obsolete 7.	Grade & Factor <b>3 Average 105%</b>
3.COMP 7.NOV 11.	2.TYPICAL 5. 8.	1.E Grade 4.B Grade 7.AA+ Grad
4.ASB/ASP 8.AL/VIN 12.	3.OLD TYPE 6. 9.None	2.D Grade 5.A Grade 8.AA++Grad
Roof Surface <b>1 Asphalt Shingles</b>	Bath(s) Style <b>2 TYPICAL</b>	3.C Grade 6.AA Grade 9.Same
1.Asphalt 4.Composit 7.	1.GOOD 4.Obsolete 7.	SQFT (Footprint) <b>1152</b>
2.Slate 5.Wood 8.	2.TYPICAL 5. 8.	Condition <b>2 Fair</b>
3.Metal 6.Other 9.	3.Old Type 6. 9.None	1.Poor 4.Avg 7.V G
SF Masonry Trim <b>0</b>	# Rooms <b>6</b>	2.Fair 5.Avg+ 8.Exc
OPEN-3-CUSTOM <b>0</b>	# Bedrooms <b>4</b>	3.Avg- 6.Good 9.Same
OPEN-4-CUSTOM <b>0</b>	# Full Baths <b>1</b>	Phys. % Good <b>0%</b>
Year Built <b>1954</b>	# Half Baths <b>0</b>	Funct. % Good <b>100%</b>
Year Remodeled <b>0</b>	# Addn Fixtures <b>0</b>	Functional Code <b>9 None</b>
Foundation <b>1 Concrete</b>	# Fireplaces <b>0</b>	1.Incomp 4.SMALL 7.LAYOUT
1.Concrete 4.Wood 7.		2.O-Built 5.CDU 8.OTHER
2.C Block 5.Slab 8.		3.Defmaint 6.STYLE 9.None
3.Br/Stone 6.Piers 9.		Econ. % Good <b>100%</b>
Basement <b>4 Full Basement</b>		Economic Code <b>None</b>
1.1/4 Bmt 4.Full Bmt 7.		0.None 3.Services 9.None
2.1/2 Bmt 5.None 8.		1.Location 4.Traffic 8.
3.3/4 Bmt 6. 9.None		2.Encroach 8.Other 9.
Bsmt Gar # Cars <b>0</b>		Entrance Code <b>3 Information Only</b>
Wet Basement <b>3 Wet Basement</b>		1.Interior 4.Vacant 7.
1.Dry 4. 7.		2.Refusal 5.Estimate 8.
2.Damp 5. 8.		3.Informed 6. 9.
3.Wet 6. 9.		Information Code <b>5 Estimate</b>
		1.Owner 4.Agent 7.
		2.Relative 5.Estimate 8.
		3.Tenant 6.Other 9.

Date Inspected 12/09/2006

## Additions, Outbuildings & Improvements

Type	Year	Units	Grade	Cond	Phys.	Funct.	Sound Value	
21 Open Frame	0	36	0 0	0	0 %	0 %		1.ONE STORY FRAM
22 Encl Frame Porch	0	120	0 0	0	0 %	0 %		2.TWO STORY FRAM
23 Frame Garage	0	280	0 0	0	0 %	0 %		3.THREE STORY FR
					%	%		4.1 & 1/2 STORY
					%	%		5.1 & 3/4 STORY
					%	%		6.2 & 1/2 STORY
					%	%		21.Open Frame Por
					%	%		22.Encl Frame Por
					%	%		23.Frame Garage
					%	%		24.Frame Shed
					%	%		25.Frame Bay Wind
					%	%		26.1SFr Overhang
					%	%		27.Unfin Basement
					%	%		28.Unfinished Att
					%	%		29.Finished Attic

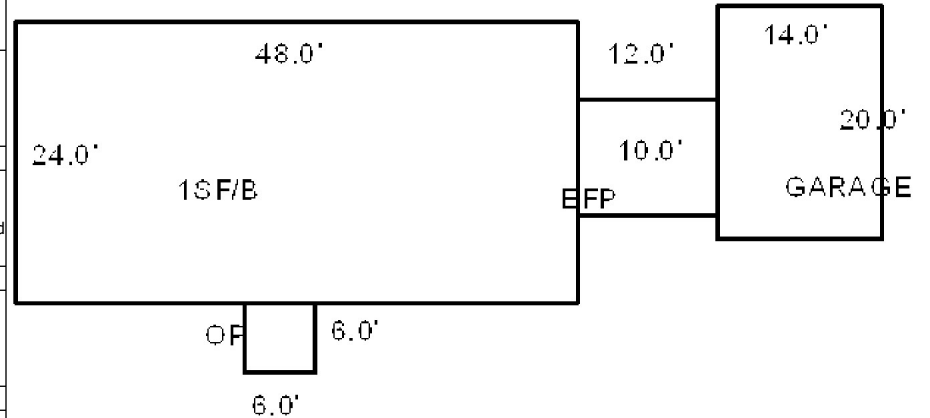

Map Lot U20-003			Account 1828			Location 154 CHEWONKI NECK ROAD			Card 1		Of 1		9/25/2024		
SHEA, CHARLES R SHEA, FAYE J WISCASSET ME 04578						Property Data			Assessment Record						
						Neighborhood 109 SOUTHEAST			Year	Land	Buildings	Exempt	Total		
						Tree Growth Year 0			2011	35,100	94,200	10,000	119,300		
						FARM LAND YEAR 0			2012	35,100	94,200	10,000	119,300		
						OPEN SPACE YEAR 0			2013	35,100	94,200	10,000	119,300		
B710P276						Zone/Land Use 21 RURAL			2014	35,100	94,200	10,000	119,300		
Previous Owner 101819714JOHNSON, BERTHA (DEWISEE) SHEA, CHARLES & FAYE J.						Secondary Zone			2015	35,100	94,200	10,000	119,300		
									2016	35,100	94,200	15,000	114,300		
WISCASSET ME 04578 Sale Date: 2/25/1997						Topography 1 Level			2017	35,100	94,200	20,000	109,300		
Previous Owner JOHNSON, BERTHA (DEWISEE) SHEA, CHARLES & FAYE J.						1.Level 4.Below St 7.Steep 2.Rolling 5.Low 8.Rough 3.Above St 6.Swampy 9.			2018	35,100	94,200	20,000	109,300		
									2019	35,100	94,200	20,000	109,300		
WISCASSET ME 04578 Sale Date: 2/25/1997						Utilities 1 All Public			2020	35,100	94,200	25,000	104,300		
									2021	35,100	94,200	25,000	104,300		
Previous Owner JOHNSON, BERTHA C/O CHARLES & FAYE J SHEA 154 CHEWONKI NECK ROAD WISCASSET ME 04578 Sale Date: 2/25/1997						1.Public 4.Dr Well 7.Cesspool 2.Water 5.DUG/LAKE 8. 3.Sewer 6.Septic 9.None			2022	35,100	94,200	24,000	105,300		
									2023	43,800	117,800	25,000	136,600		
						Street 1 Paved			2024	43,800	117,800	25,000	136,600		
						1.Paved 4.Proposed 7. 2.Semi Imp 5.Private 8. 3.Gravel 6.Pub Eas 9.NoStreet			Land Data						
Inspection Witnessed By:						Front Foot		Type	Effective		Influence		Influence Codes		
						11.Regular Lot		Frontage	Depth	Factor	Code				
						12.Delta Triangle				%					
						13.Nabla Triangle				%					
						14.Rear Land				%					
						15.Front Foot				%					
										%					
										%					
										%					
										%					
						Square Foot		Square Feet							
						16.Regular Lot				%					
						17.Secondary Site				%					
						18.Secondary Site				%					
						19.Condominium				%					
						20.Base Homesite				%					
										%					
										%					
										%					
										%					
Notes: 2004-ADDED 12 X 12 SHED 2008-ADDED HOMESTEAD EX. TO THIS PROPERTY AND REMOVED FROM OLD HOUSE. PER 1971 DEED WHEN MRS. JOHNSON PASSES AWAY THIS PROPERTY BECOMES THE PROPERTY OF THE SHEA'S.						Fract. Acre		Acreage/Sites							
						21.HS Size Adj		20	1.00	100	%	0			
						22.Base Waterfron		21	0.63	100	%	0			
						23.Deep WF Size A				%					
						Acres				%					
						24.Base Waterfron				%					
						25.Shallow WF Siz				%					
						26.Base Water Inf				%					
						27.Influence W Si				%					
						28.Rear Land 1-10									
						Total Acreage		0.63							
WISCASSET															

# WISCASSET

Map Lot U20-003

Account 1828

Location 154 CHEWONKI NECK ROAD

Card 1

Of 1

9/25/2024

Building Style <b>2 Ranch</b>	SF Bsmt Living <b>0</b>	Layout <b>1 Typical</b>
1.Conv. 5.Colonial 9.Other	Fin Bsmt Grade <b>0 0</b>	1.Typical 4. 7.
2.Ranch 6.Split 10.Double	HEARTH <b>0</b>	2.Inadeq 5. 8.
3.R Ranch 7.Mod/Cont 11.Multi	Heat Type <b>100% 1 Hot Water BB</b>	3. 6. 9.
4.Cape 8.Log 12.Cot.	1.HWBB 5.FWA 9.No Heat	Attic <b>9 None</b>
Dwelling Units <b>1</b>	2.HWCI 6.GravWA 10.	1.1/4 Fin 4.Full Fin 7.
Other Units <b>0</b>	3.H Pump 7.Electric 11.	2.1/2 Fin 5.F/Stair 8.
Stories <b>1 One Story</b>	4.Steam 8.F/Wall 12.	3.3/4 Fin 6. 9.None
1.1 4.1.5 7.	Cool Type <b>0% 9 None</b>	Insulation <b>1 Full</b>
2.2 5.1.75 8.	1.Refrig 4.W&C Air 7.	1.Full 4.Minimal 7.
3.3 6.2.5 9.	2.Evapor 5. 8.	2.Heavy 5.Unknown 8.
Exterior Walls <b>2 WOOD SHINGLE</b>	3.H Pump 6. 9.None	3.Capped 6. 9.None
1.CLAP 5.T-111 9.OTHER	Kitchen Style <b>2 TYPICAL</b>	Unfinished % <b>0%</b>
2.WD SH 6.BR/STONE 10.	1.GOOD 4.Obsolete 7.	Grade & Factor <b>3 Average 105%</b>
3.COMP 7.NOV 11.	2.TYPICAL 5. 8.	1.E Grade 4.B Grade 7.AA+ Grad
4.ASB/ASP 8.AL/VIN 12.	3.OLD TYPE 6. 9.None	2.D Grade 5.A Grade 8.AA++Grad
Roof Surface <b>1 Asphalt Shingles</b>	Bath(s) Style <b>2 TYPICAL</b>	3.C Grade 6.AA Grade 9.Same
1.Asphalt 4.Composit 7.	1.GOOD 4.Obsolete 7.	SQFT (Footprint) <b>960</b>
2.Slate 5.Wood 8.	2.TYPICAL 5. 8.	Condition <b>4 Average</b>
3.Metal 6.Other 9.	3.Old Type 6. 9.None	1.Poor 4.Avg 7.V G
SF Masonry Trim <b>0</b>	# Rooms <b>4</b>	2.Fair 5.Avg+ 8.Exc
OPEN-3-CUSTOM <b>0</b>	# Bedrooms <b>2</b>	3.Avg- 6.Good 9.Same
OPEN-4-CUSTOM <b>0</b>	# Full Baths <b>1</b>	Phys. % Good <b>0%</b>
Year Built <b>1971</b>	# Half Baths <b>1</b>	Funct. % Good <b>100%</b>
Year Remodeled <b>0</b>	# Addn Fixtures <b>0</b>	Functional Code <b>9 None</b>
Foundation <b>1 Concrete</b>	# Fireplaces <b>1</b>	1.Incomp 4.SMALL 7.LAYOUT
1.Concrete 4.Wood 7.		2.O-Built 5.CDU 8.OTHER
2.C Block 5.Slab 8.		3.Defmaint 6.STYLE 9.None
3.Br/Stone 6.Piers 9.		Econ. % Good <b>100%</b>
Basement <b>4 Full Basement</b>		Economic Code <b>None</b>
1.1/4 Bmt 4.Full Bmt 7.		0.None 3.Services 9.None
2.1/2 Bmt 5.None 8.		1.Location 4.Traffic 8.
3.3/4 Bmt 6. 9.None		2.Encroach 8.Other 9.
Bsmt Gar # Cars <b>0</b>		Entrance Code <b>1 Interior Inspect</b>
Wet Basement <b>1 Dry Basement</b>		1.Interior 4.Vacant 7.
1.Dry 4. 7.		2.Refusal 5.Estimate 8.
2.Damp 5. 8.		3.Informed 6. 9.
3.Wet 6. 9.		Information Code <b>1 Owner</b>
		1.Owner 4.Agent 7.
		2.Relative 5.Estimate 8.
		3.Tenant 6.Other 9.

Date Inspected 12/09/2006

## Additions, Outbuildings & Improvements

Type	Year	Units	Grade	Cond	Phys.	Funct.	Sound Value	
23 Frame Garage	0	576	0 0	0	0 %	0 %		1.ONE STORY FRAM
24 Frame Shed	1980	80	2 100	1	0 %	50 %		2.TWO STORY FRAM
24 Frame Shed	2004	144	3 100	4	0 %	100 %		3.THREE STORY FR
24 Frame Shed	1980	96	1 100	1	0 %	100 %		4.1 & 1/2 STORY
68 Wood Deck	1971	96	2 100	3	0 %	100 %		5.1 & 3/4 STORY
24 Frame Shed	2010	130	2 100	3	0 %	100 %		6.2 & 1/2 STORY
					%	%		21.Open Frame Por
					%	%		22.Encl Frame Por
					%	%		23.Frame Garage
					%	%		24.Frame Shed
					%	%		25.Frame Bay Wind
					%	%		26.1SFr Overhang
					%	%		27.Unfin Basement
					%	%		28.Unfinished Att
					%	%		29.Finished Attic

SHED 12X12

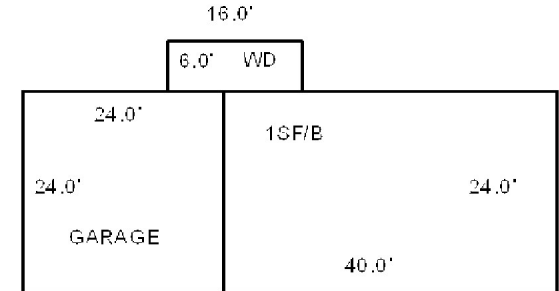

WISCASSET, INHABITANTS OF MUN. AIRPORT-SOULE WISCASSET ME 04578			Property Data			Assessment Record							
			Neighborhood <b>109 SOUTHEAST</b>			Year	Land	Buildings	Exempt	Total			
			Tree Growth Year <b>0</b>			2011	39,100	0	39,100	0			
			FARM LAND YEAR <b>0</b>			2012	39,100	0	39,100	0			
			OPEN SPACE YEAR <b>0</b>			2013	39,100	0	39,100	0			
B2695P247 Previous Owner WISCASSET,INHABITANTS OF MUN.  51 BATH ROAD WISCASSET ME 04578 Sale Date: 6/27/2001			Zone/Land Use <b>21 RURAL</b>			2014	39,100	0	39,100	0			
			Secondary Zone			2015	39,100	0	39,100	0			
						2016	39,100	0	39,100	0			
			Topography <b>1 Level</b>			2017	39,100	0	39,100	0			
						1.Level           4.Below St       7.Steep 2.Rolling       5.Low           8.Rough 3.Above St      6.Swampy       9.			2018	39,100	0	39,100	0
2019	39,100	0							39,100	0			
2020	39,100	0							39,100	0			
Utilities <b>1 All Public</b>						2021	39,100	0	39,100	0			
						1.Public           4.Dr Well       7.Cesspool 2.Water           5.DUG/LAKE     8. 3.Sewer           6.Septic        9.None			2022	39,100	0	39,100	0
			2023	48,800	0				48,800	0			
			2024	48,800	0				48,800	0			
			Street <b>1 Paved</b>			Land Data							
			1.Paved           4.Proposed       7. 2.Semi Imp       5.Private       8. 3.Gravel          6.Pub Eas       9.NoStreet										
Front Foot		Type				Effective		Influence		Influence Codes			
						Frontage	Depth	Factor	Code				
			11.Regular Lot				1.Open Space						
			12.Delta Triangle				2.Neighborhood A						
			13.Nabla Triangle				3.Topography						
Inspection Witnessed By:			14.Rear Land			15.Front Foot		4.Size/Shape					
						5.Access							
						6.Restriction							
						7.Corner/Locatio							
						8.View/Environ							
X  Date			Price <b>130,000</b>			9.Fract Share		Acres					
						30.Rear 20+							
						31.Waterfront Rea							
						32.Open Space							
						33.RestrictEsm							
No./Date           Description													

**WISCASSET**

Map Lot U20-004

Account 1829

Location 166 CHEWONKI NECK ROAD

Card 1 Of 1 9/25/2024

Building Style			SF Bsmt Living			Layout		
1.Conv.	5.Colonial	9.Other	Fin Bsmt Grade			1.Typical 4. 7.		
2.Ranch	6.Split	10.Double	HEARTH			2.Inadeq 5. 8.		
3.R Ranch	7.Mod/Cont	11.Multi	Heat Type <b>100%</b>			3. 6. 9.		
4.Cape	8.Log	12.Cot.	1.HWBB 5.FWA 9.No Heat			Attic		
Dwelling Units			2.HWCI 6.GravWA 10.			1.1/4 Fin 4.Full Fin 7.		
Other Units			3.H Pump 7.Electric 11.			2.1/2 Fin 5.F/Stair 8.		
Stories			4.Steam 8.F/Wall 12.			3.3/4 Fin 6. 9.None		
1.1	4.1.5	7.	Cool Type <b>0%</b>			Insulation		
2.2	5.1.75	8.	1.Refrig 4.W&C Air 7.			1.Full 4.Minimal 7.		
3.3	6.2.5	9.	2.Evapor 5. 8.			2.Heavy 5.Unknown 8.		
Exterior Walls			3.H Pump 6. 9.None			3.Capped 6. 9.None		
1.CLAP	5.T-111	9.OTHER	Kitchen Style			Unfinished %		
2.WD SH	6.BR/STONE	10.	1.GOOD 4.Obsolete 7.			Grade & Factor		
3.COMP	7.NOV	11.	2.TYPICAL 5. 8.			1.E Grade 4.B Grade 7.AA+ Grad		
4.ASB/ASP	8.AL/VIN	12.	3.OLD TYPE 6. 9.None			2.D Grade 5.A Grade 8.AA++Grad		
Roof Surface			Bath(s) Style			3.C Grade 6.AA Grade 9.Same		
1.Asphalt	4.Composit	7.	1.GOOD 4.Obsolete 7.			SQFT (Footprint)		
2.Slate	5.Wood	8.	2.TYPICAL 5. 8.			Condition		
3.Metal	6.Other	9.	3.Old Type 6. 9.None			1.Poor 4.Avg 7.V G		
SF Masonry Trim			# Rooms			2.Fair 5.Avg+ 8.Exc		
OPEN-3-CUSTOM			# Bedrooms			3.Avg- 6.Good 9.Same		
OPEN-4-CUSTOM			# Full Baths			Phys. % Good		
Year Built			# Half Baths			Funct. % Good		
Year Remodeled			# Addn Fixtures			Functional Code		
Foundation			# Fireplaces			1.Incomp 4.SMALL 7.LAYOUT		
1.Concrete	4.Wood	7.				2.O-Built 5.CDU 8.OTHER		
2.C Block	5.Slab	8.				3.Defmaint 6.STYLE 9.None		
3.Br/Stone	6.Piers	9.				Econ. % Good		
Basement						Economic Code		
1.1/4 Bmt	4.Full Bmt	7.				0.None 3.Services 9.None		
2.1/2 Bmt	5.None	8.				1.Location 4.Traffic 8.		
3.3/4 Bmt	6.	9.None				2.Encroach 8.Other 9.		
Bsmt Gar # Cars						Entrance Code <b>4 Unoccupied</b>		
Wet Basement						1.Interior 4.Vacant 7.		
1.Dry	4.	7.				2.Refusal 5.Estimate 8.		
2.Damp	5.	8.	3.Informed 6. 9.					
3.Wet	6.	9.	Information Code <b>5 Estimate</b>					
Date Inspected 4/14/1998			1.Owner 4.Agent 7.			2.Relative 5.Estimate 8.		
			2.Relative 5.Estimate 8.			3.Tenant 6.Other 9.		
<b>Additions, Outbuildings &amp; Improvements</b>								1.ONE STORY FRAM
Type	Year	Units	Grade	Cond	Phys.	Funct.	Sound Value	2.TWO STORY FRAM
					%	%		3.THREE STORY FR
					%	%		4.1 & 1/2 STORY
					%	%		5.1 & 3/4 STORY
					%	%		6.2 & 1/2 STORY
					%	%		21.Open Frame Por
					%	%		22.Encl Frame Por
					%	%		23.Frame Garage
					%	%		24.Frame Shed
					%	%		25.Frame Bay Wind
					%	%		26.1SFr Overhang
					%	%		27.Unfin Basement
					%	%		28.Unfinished Att
					%	%		29.Finished Attic



Map Lot    U20-005			Account    1830			Location    9 THORNDIKE ROAD			Card    1    Of    1			9/25/2024							
LEMAR, GEORGE W III 9 THORNDIKE ROAD WISCASSET ME 04578						Property Data			Assessment Record										
						Neighborhood    109 SOUTHEAST			Year	Land	Buildings	Exempt	Total						
						Tree Growth Year    0			2011	46,300	78,100	10,000	114,400						
						FARM LAND YEAR    0			2012	46,300	78,100	10,000	114,400						
						OPEN SPACE YEAR    0			2013	46,300	78,100	10,000	114,400						
B2328P98						Zone/Land Use    21 RURAL			2014	46,300	78,100	10,000	114,400						
						Secondary Zone			2015	46,300	78,100	10,000	114,400						
									2016	44,300	78,100	15,000	107,400						
						Topography    1 Level			2017	44,300	78,100	20,000	102,400						
						1.Level            4.Below St        7.Steep 2.Rolling           5.Low               8.Rough 3.Above St        6.Swampy          9.			2018	44,300	78,100	20,000	102,400						
									2019	44,300	85,100	20,000	109,400						
									2020	44,300	95,700	25,000	115,000						
						Utilities            1 All Public  1.Public            4.Dr Well          7.Cesspool 2.Water            5.DUG/LAKE       8. 3.Sewer            6.Septic           9.None			2021	44,300	95,700	25,000	115,000						
									2022	44,300	123,100	24,000	143,400						
									2023	55,400	166,500	25,000	196,900						
						Street            1 Paved			2024	52,800	166,500	25,000	194,300						
						Inspection Witnessed By:						Land Data							
												Front Foot  11.Regular Lot 12.Delta Triangle 13.Nabla Triangle 14.Rear Land 15.Front Foot  <							

# WISCASSET

Map Lot U20-005

Account 1830

Location 9 THORNDIKE ROAD

Card 1 Of 1 9/25/2024

Building Style <b>1 Conventional</b>	SF Bsmt Living <b>0</b>	Layout <b>1 Typical</b>
1.Conv. 5.Colonial 9.Other	Fin Bsmt Grade <b>0 0</b>	1.Typical 4. 7.
2.Ranch 6.Split 10.Double	HEARTH <b>0</b>	2.Inadeq 5. 8.
3.R Ranch 7.Mod/Cont 11.Multi	Heat Type <b>100% 5 Forced Warm Air</b>	3. 6. 9.
4.Cape 8.Log 12.Cot.	1.HWBB 5.FWA 9.No Heat	Attic <b>9 None</b>
Dwelling Units <b>1</b>	2.HWCI 6.GravWA 10.	1.1/4 Fin 4.Full Fin 7.
Other Units <b>0</b>	3.H Pump 7.Electric 11.	2.1/2 Fin 5.F/Stair 8.
Stories <b>5 One &amp; 3/4 Story</b>	4.Steam 8.F/Wall 12.	3.3/4 Fin 6. 9.None
1.1 4.1.5 7.	Cool Type <b>0% 9 None</b>	Insulation <b>3 Capped Only</b>
2.2 5.1.75 8.	1.Refrig 4.W&C Air 7.	1.Full 4.Minimal 7.
3.3 6.2.5 9.	2.Evapor 5. 8.	2.Heavy 5.Unknown 8.
Exterior Walls <b>8 ALUM/VINYL</b>	3.H Pump 6. 9.None	3.Capped 6. 9.None
1.CLAP 5.T-111 9.OTHER	Kitchen Style <b>3 OLD STYLE</b>	Unfinished % <b>0%</b>
2.WD SH 6.BR/STONE 10.	1.GOOD 4.Obsolete 7.	Grade & Factor <b>3 Average 95%</b>
3.COMP 7.NOV 11.	2.TYPICAL 5. 8.	1.E Grade 4.B Grade 7.AA+ Grad
4.ASB/ASP 8.AL/VIN 12.	3.OLD TYPE 6. 9.None	2.D Grade 5.A Grade 8.AA++Grad
Roof Surface <b>1 Asphalt Shingles</b>	Bath(s) Style <b>3 Old Style</b>	3.C Grade 6.AA Grade 9.Same
1.Asphalt 4.Composit 7.	1.GOOD 4.Obsolete 7.	SQFT (Footprint) <b>400</b>
2.Slate 5.Wood 8.	2.TYPICAL 5. 8.	Condition <b>4 Average</b>
3.Metal 6.Other 9.	3.Old Type 6. 9.None	1.Poor 4.Avg 7.V G
SF Masonry Trim <b>0</b>	# Rooms <b>4</b>	2.Fair 5.Avg+ 8.Exc
OPEN-3-CUSTOM <b>0</b>	# Bedrooms <b>2</b>	3.Avg- 6.Good 9.Same
OPEN-4-CUSTOM <b>0</b>	# Full Baths <b>1</b>	Phys. % Good <b>0%</b>
Year Built <b>1930</b>	# Half Baths <b>0</b>	Funct. % Good <b>100%</b>
Year Remodeled <b>0</b>	# Addn Fixtures <b>0</b>	Functional Code <b>9 None</b>
Foundation <b>3 Brick &amp;/or Stone</b>	# Fireplaces <b>0</b>	1.Incomp 4.SMALL 7.LAYOUT
1.Concrete 4.Wood 7.		2.O-Built 5.CDU 8.OTHER
2.C Block 5.Slab 8.		3.Defmaint 6.STYLE 9.None
3.Br/Stone 6.Piers 9.		Econ. % Good <b>100%</b>
Basement <b>4 Full Basement</b>		Economic Code <b>None</b>
1.1/4 Bmt 4.Full Bmt 7.		0.None 3.Services 9.None
2.1/2 Bmt 5.None 8.		1.Location 4.Traffic 8.
3.3/4 Bmt 6. 9.None		2.Encroach 8.Other 9.
Bsmt Gar # Cars <b>0</b>		Entrance Code <b>3 Information Only</b>
Wet Basement <b>3 Wet Basement</b>		1.Interior 4.Vacant 7.
1.Dry 4. 7.		2.Refusal 5.Estimate 8.
2.Damp 5. 8.		3.Informed 6. 9.
3.Wet 6. 9.		Information Code <b>3 Tenant</b>
		1.Owner 4.Agent 7.
		2.Relative 5.Estimate 8.
		3.Tenant 6.Other 9.

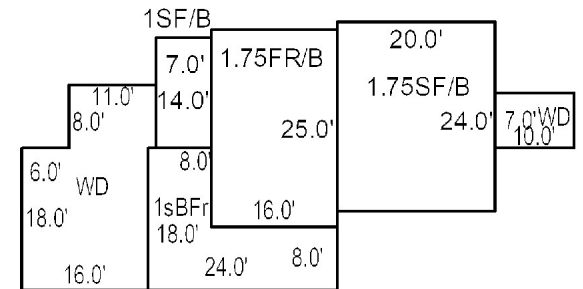
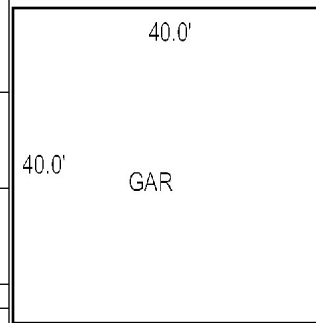

Date Inspected 6/01/2010

Additions, Outbuildings & Improvements								Sound Value
Type	Year	Units	Grade	Cond	Phys.	Funct.		
11 1	1930	98	3 95	4	0 %	100 %		
68 Wood Deck	2000	70	3 100	4	0 %	100 %		
5 1 & 3/4 STORY FR	2007	480	3 95	4	0 %	100 %		
11 1	2018	272	9 100	4	0 %	100 %		
23 Frame Garage	2021	1600	3 100	4	0 %	100 %		
68 Wood Deck	2021	376	3 100	4	0 %	100 %		
					%	%		
					%	%		
					%	%		
					%	%		

- ONE STORY FRAM
- TWO STORY FRAM
- THREE STORY FR
- 4.1 & 1/2 STORY
- 5.1 & 3/4 STORY
- 6.2 & 1/2 STORY
- 21.Open Frame Por
- 22.Encl Frame Por
- 23.Frame Garage
- 24.Frame Shed
- 25.Frame Bay Wind
- 26.1SFr Overhang
- 27.Unfin Basement
- 28.Unfinished Att
- 29.Finished Attic

Map Lot    U20-005-A			Account    2623			Location    163 CHEWONKI NECK ROAD			Card    1		Of    1		9/25/2024						
MCKUSIC, RICHARD M 163 CHEWONKI NECK ROAD WISCASSET ME 04578						Property Data			Assessment Record										
						Neighborhood    109 SOUTHEAST			Year	Land	Buildings	Exempt	Total						
						Tree Growth Year    0			2016	36,300	59,500	0	95,800						
						FARM LAND YEAR    0			2017	36,300	62,400	0	98,700						
						OPEN SPACE YEAR    0			2018	36,300	62,400	0	98,700						
B5388P304						Zone/Land Use    21 RURAL			2019	36,300	62,400	0	98,700						
Previous Owner LEMAR, GEORGE W III  9 THORNDIKE ROAD WISCASSET ME 04578 Sale Date: 5/31/2019						Secondary Zone			2020	36,300	62,400	0	98,700						
									2021	36,300	62,400	0	98,700						
						Topography    2 Rolling			2022	36,300	62,400	0	98,700						
						1.Level            4.Below St        7.Steep 2.Rolling        5.Low            8.Rough 3.Above St      6.Swampy        9.			2023	45,400	78,000	0	123,400						
									2024	45,400	78,000	0	123,400						
						Utilities    4 Drilled Well    6 Septic System													
						1.Public            4.Dr Well        7.Cesspool 2.Water            5.DUG/LAKE    8. 3.Sewer            6.Septic        9.None													
						Street    1 Paved													
						1.Paved            4.Proposed        7. 2.Semi Imp        5.Private          8. 3.Gravel            6.Pub Eas        9.NoStreet			Land Data										
									Front Foot		Type	Effective		Influence		Influence Codes			
												Frontage	Depth	Factor	Code				
						Inspection Witnessed By:						11.Regular Lot 12.Delta Triangle 13.Nabla Triangle 14.Rear Land 15.Front Foot							1.Open Space
																			2.Neighborhood A
					3.Topography														
					4.Size/Shape														
					5.Access														
X																			

WISCASSET

# WISCASSET

Map Lot U20-005-A

Account 2623

Location 163 CHEWONKI NECK ROAD

Card 1 Of 1 9/25/2024

Building Style <b>10 Double Wide</b>			SF Bsmt Living <b>0</b>			Layout <b>2 Inadequate</b>		
1.Conv.	5.Colonial	9.Other	Fin Bsmt Grade <b>0 0</b>			1.Typical 4. 7.		
2.Ranch	6.Split	10.Double	HEARTH <b>0</b>			2.Inadeq 5. 8.		
3.R Ranch	7.Mod/Cont	11.Multi	Heat Type <b>100% 5 Forced Warm Air</b>			3. 6. 9.		
4.Cape	8.Log	12.Cot.	1.HWBB 5.FWA 9.No Heat			Attic <b>9 None</b>		
Dwelling Units <b>1</b>			2.HWCI 6.GravWA 10.			1.1/4 Fin 4.Full Fin 7.		
Other Units <b>0</b>			3.H Pump 7.Electric 11.			2.1/2 Fin 5.Fl/Stair 8.		
Stories <b>1 One Story</b>			4.Steam 8.Fl/Wall 12.			3.3/4 Fin 6. 9.None		
1.1	4.1.5	7.	Cool Type <b>0% 9 None</b>			Insulation <b>4 Minimal</b>		
2.2	5.1.75	8.	1.Refrig 4.W&C Air 7.			1.Full 4.Minimal 7.		
3.3	6.2.5	9.	2.Evapor 5. 8.			2.Heavy 5.Unknown 8.		
Exterior Walls <b>2 WOOD SHINGLE</b>			3.H Pump 6. 9.None			3.Capped 6. 9.None		
1.CLAP	5.T-111	9.OTHER	Kitchen Style <b>2 TYPICAL</b>			Unfinished % <b>0%</b>		
2.WD SH	6.BR/STONE	10.	1.GOOD 4.Obsolete 7.			Grade & Factor <b>2 Fair 100%</b>		
3.COMP	7.NOV	11.	2.TYPICAL 5. 8.			1.E Grade 4.B Grade 7.AA+ Grad		
4.ASB/ASP	8.AL/VIN	12.	3.OLD TYPE 6. 9.None			2.D Grade 5.A Grade 8.AA++Grad		
Roof Surface <b>1 Asphalt Shingles</b>			Bath(s) Style <b>2 TYPICAL</b>			3.C Grade 6.AA Grade 9.Same		
1.Asphalt	4.Composit	7.	1.GOOD 4.Obsolete 7.			SQFT (Footprint) <b>1680</b>		
2.Slate	5.Wood	8.	2.TYPICAL 5. 8.			Condition <b>3 Below Average</b>		
3.Metal	6.Other	9.	3.OLD Type 6. 9.None			1.Poor 4.Avg 7.V G		
SF Masonry Trim <b>0</b>			# Rooms <b>5</b>			2.Fair 5.Avg+ 8.Exc		
OPEN-3-CUSTOM <b>0</b>			# Bedrooms <b>3</b>			3.Avg- 6.Good 9.Same		
OPEN-4-CUSTOM <b>0</b>			# Full Baths <b>2</b>			Phys. % Good <b>0%</b>		
Year Built <b>2003</b>			# Half Baths <b>0</b>			Funct. % Good <b>75%</b>		
Year Remodeled <b>0</b>			# Addn Fixtures <b>0</b>			Functional Code <b>9 None</b>		
Foundation <b>5 Concrete Slab</b>			# Fireplaces <b>0</b>			1.Incomp 4.SMALL 7.LAYOUT		
1.Concrete	4.Wood	7.	<div><p><b>TRIO</b> Software A Division of Harris Computer Systems</p></div>			2.O-Built 5.CDU 8.OTHER		
2.C Block	5.Slab	8.				3.Defmaint 6.STYLE 9.None		
3.Br/Stone	6.Piers	9.				Econ. % Good <b>100%</b>		
Basement <b>9 No Basement</b>						Economic Code <b>None</b>		
1.1/4 Bmt	4.Full Bmt	7.				0.None 3.Services 9.None		
2.1/2 Bmt	5.None	8.				1.Location 4.Traffic 8.		
3.3/4 Bmt	6. 9.None					2.Encroach 8.Other 9.		
Bsmt Gar # Cars <b>0</b>						Entrance Code <b>0</b>		
Wet Basement <b>9 No Basement</b>						1.Interior 4.Vacant 7.		
1.Dry	4. 7.					2.Refusal 5.Estimate 8.		
2.Damp	5. 8.		3.Informed 6. 9.					
3.Wet	6. 9.		Information Code <b>0</b>					
			1.Owner 4.Agent 7.					
			2.Relative 5.Estimate 8.					
			3.Tenant 6.Other 9.					

Date Inspected

Additions, Outbuildings & Improvements								1.ONE STORY FRAM
Type	Year	Units	Grade	Cond	Phys.	Funct.	Sound Value	2.TWO STORY FRAM
1 ONE STORY	2006	312	2 100	3	0 %	75 %		3.THREE STORY FR
68 Wood Deck	2016	288	3 100	4	0 %	100 %		4.1 & 1/2 STORY
					%	%		5.1 & 3/4 STORY
					%	%		6.2 & 1/2 STORY
					%	%		21.Open Frame Por
					%	%		22.Encl Frame Por
					%	%		23.Frame Garage
					%	%		24.Frame Shed
					%	%		25.Frame Bay Wind
					%	%		26.1SFr Overhang
					%	%		27.Unfin Basement
					%	%		28.Unfinished Att
					%	%		29.Finished Attic

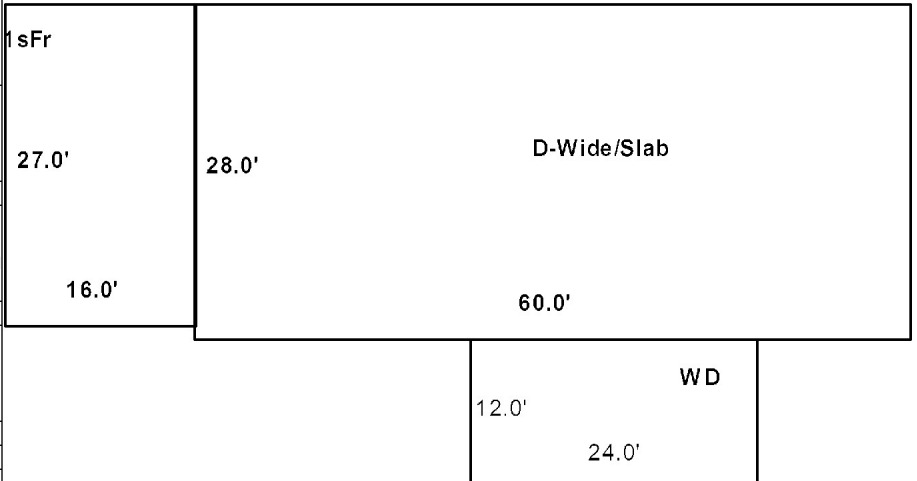

Map Lot    U20-005B

Account    2795

Location    THORNDIKE ROAD

Card    1    Of    1    9/25/2024

BANEK, MICHELLE I  
P.O. BOX 195  
WISCASSET ME 04578

B5995P185

Property Data

Neighborhood    **108 SOUTHWEST**

Tree Growth Year    **0**

FARM LAND YEAR

OPEN SPACE YEAR

Zone/Land Use    **16 RESIDENTIAL**

Secondary Zone

Topography    **2 Rolling**

1.Level            4.Below St        7.Steep

2.Rolling        5.Low            8.Rough

3.Above St      6.Swampy        9.

Utilities

1.Public            4.Dr Well        7.Cesspool

2.Water            5.DUG/LAKE      8.

3.Sewer            6.Septic        9.None

Street    **1 Paved**

1.Paved            4.Proposed        7.

2.Semi Imp        5.Private          8.

3.Gravel           6.Pub Eas        9.NoStreet

TREE GROWTH PLAN    **0**

CONSERV EASE    **0**

Sale Data

Sale Date    **5/03/2023**

Price    **32,000**

Sale Type    **1 Land Only**

1.Land            4.Mobile        7.

2.L & B           5.Other        8.

3.Building        6.            9.

Financing    **9 Unknown**

1.Convent        4.Seller        7.

2.FHA/VA        5.Private       8.

3.Assumed       6.Cash        9.Unknown

Validity    **1 Arms Length Sale**

1.Valid            4.Split          7.Renovate

2.Related        5.Partial        8.Other

3.Distress       6.Exempt        9.Foreclose

Verified    **5 Public Record**

1.Buyer            4.Agent        7.Family

2.Seller            5.Pub Rec      8.Other

3.Lender           6.MLS        9.

Assessment Record

Year

2024

Land

41,400

Buildings

0

Exempt

0

Total

41,400

Land Data

Front Foot

11.Regular Lot

12.Delta Triangle

13.Nabla Triangle

14.Rear Land

15.Front Foot

Square Foot

16.Regular Lot

17.Secondary Site

18.Secondary Site

19.Condominium

20.Base Homesite

Fract. Acre

21.HS Size Adj

22.Base Waterfron

23.Deep WF Size A

Acres

24.Base Waterfron

25.Shallow WF Siz

26.Base Water Inf

27.Influence W Si

28.Rear Land 1-10

29.Rear Land 11-2

Type

Effective

Influence

Influence Codes

Frontage

Depth

Factor

Code

Square Feet

Acres

Acres/Sites

Total Acreage

1

2

3

4

5

6

7

8

9

10

11

12

13

14

15

16

17

18

19

20

21

22

23

24

25

26

27

28

29

30

31

32

33

34

35

36

37

38

39

40

41

42

43

44

45

46

Inspection Witnessed By:

X

Date

No./Date

Description

Date Insp.

Notes:

'24 1.04 acres from lot 5.

WISCASSET

**WISCASSET**

Map Lot U20-005B

Account 2795

Location THORNDIKE ROAD

Card 1 Of 1 9/25/2024

Building Style			SF Bsmt Living			Layout		
1.Conv.	5.Colonial	9.Other	Fin Bsmt Grade			1.Typical 4. 7.		
2.Ranch	6.Split	10.Double	HEARTH			2.Inadeq 5. 8.		
3.R Ranch	7.Mod/Cont	11.Multi	Heat Type <b>100%</b>			3. 6. 9.		
4.Cape	8.Log	12.Cot.	1.HWBB 5.FWA 9.No Heat			Attic		
Dwelling Units			2.HWCI 6.GravWA 10.			1.1/4 Fin 4.Full Fin 7.		
Other Units			3.H Pump 7.Electric 11.			2.1/2 Fin 5.F/Stair 8.		
Stories			4.Steam 8.F/Wall 12.			3.3/4 Fin 6. 9.None		
1.1	4.1.5	7.	Cool Type <b>0%</b>			Insulation		
2.2	5.1.75	8.	1.Refrig 4.W&C Air 7.			1.Full 4.Minimal 7.		
3.3	6.2.5	9.	2.Evapor 5. 8.			2.Heavy 5.Unknown 8.		
Exterior Walls			3.H Pump 6. 9.None			3.Capped 6. 9.None		
1.CLAP	5.T-111	9.OTHER	Kitchen Style			Unfinished %		
2.WD SH	6.BR/STONE	10.	1.GOOD 4.Obsolete 7.			Grade & Factor		
3.COMP	7.NOV	11.	2.TYPICAL 5. 8.			1.E Grade 4.B Grade 7.AA+ Grad		
4.ASB/ASP	8.AL/VIN	12.	3.OLD TYPE 6. 9.None			2.D Grade 5.A Grade 8.AA++Grad		
Roof Surface			Bath(s) Style			3.C Grade 6.AA Grade 9.Same		
1.Asphalt	4.Composit	7.	1.GOOD 4.Obsolete 7.			SQFT (Footprint)		
2.Slate	5.Wood	8.	2.TYPICAL 5. 8.			Condition		
3.Metal	6.Other	9.	3.Old Type 6. 9.None			1.Poor 4.Avg 7.V G		
SF Masonry Trim			# Rooms			2.Fair 5.Avg+ 8.Exc		
OPEN-3-CUSTOM			# Bedrooms			3.Avg- 6.Good 9.Same		
OPEN-4-CUSTOM			# Full Baths			Phys. % Good		
Year Built			# Half Baths			Funct. % Good		
Year Remodeled			# Addn Fixtures			Functional Code		
Foundation			# Fireplaces			1.Incomp 4.SMALL 7.LAYOUT		
1.Concrete	4.Wood	7.				2.O-Built 5.CDU 8.OTHER		
2.C Block	5.Slab	8.				3.Defmaint 6.STYLE 9.None		
3.Br/Stone	6.Piers	9.				Econ. % Good		
Basement						Economic Code		
1.1/4 Bmt	4.Full Bmt	7.				0.None 3.Services 9.None		
2.1/2 Bmt	5.None	8.				1.Location 4.Traffic 8.		
3.3/4 Bmt	6.	9.None				2.Encroach 8.Other 9.		
Bsmt Gar # Cars						Entrance Code <b>0</b>		
Wet Basement						1.Interior 4.Vacant 7.		
1.Dry	4.	7.				2.Refusal 5.Estimate 8.		
2.Damp	5.	8.	3.Informed 6. 9.					
3.Wet	6.	9.	Information Code <b>0</b>					
Date Inspected			1.Owner 4.Agent 7.			2.Relative 5.Estimate 8.		
			3.Tenant 6.Other 9.					
<b>Additions, Outbuildings &amp; Improvements</b>								1.ONE STORY FRAM
Type	Year	Units	Grade	Cond	Phys.	Funct.	Sound Value	2.TWO STORY FRAM
					%	%		3.THREE STORY FR
					%	%		4.1 & 1/2 STORY
					%	%		5.1 & 3/4 STORY
					%	%		6.2 & 1/2 STORY
					%	%		21.Open Frame Por
					%	%		22.Encl Frame Por
					%	%		23.Frame Garage
					%	%		24.Frame Shed
					%	%		25.Frame Bay Wind
					%	%		26.1SFr Overhang
					%	%		27.Unfin Basement
					%	%		28.Unfinished Att
					%	%		29.Finished Attic



# WISCASSET



# WISCASSET

Map Lot U20-006

Account 1831

Location 155 CHEWONKI NECK ROAD

Card 1 Of 1 9/25/2024

Building Style <b>2 Ranch</b>	SF Bsmt Living <b>0</b>	Layout <b>1 Typical</b>
1.Conv. 5.Colonial 9.Other	Fin Bsmt Grade <b>0 0</b>	1.Typical 4. 7.
2.Ranch 6.Split 10.Double	HEARTH <b>1</b>	2.Inadeq 5. 8.
3.R Ranch 7.Mod/Cont 11.Multi	Heat Type <b>100% 7 Electric</b>	3. 6. 9.
4.Cape 8.Log 12.Cot.	1.HWBB 5.FWA 9.No Heat	Attic <b>9 None</b>
Dwelling Units <b>1</b>	2.HWCI 6.GravWA 10.	1.1/4 Fin 4.Full Fin 7.
Other Units <b>0</b>	3.H Pump 7.Electric 11.	2.1/2 Fin 5.F/Stair 8.
Stories <b>1 One Story</b>	4.Steam 8.F/Wall 12.	3.3/4 Fin 6. 9.None
1.1 4.1.5 7.	Cool Type <b>0% 9 None</b>	Insulation <b>1 Full</b>
2.2 5.1.75 8.	1.Refrig 4.W&C Air 7.	1.Full 4.Minimal 7.
3.3 6.2.5 9.	2.Evapor 5. 8.	2.Heavy 5.Unknown 8.
Exterior Walls <b>5 T-111</b>	3.H Pump 6. 9.None	3.Capped 6. 9.None
1.CLAP 5.T-111 9.OTHER	Kitchen Style <b>2 TYPICAL</b>	Unfinished % <b>0%</b>
2.WD SH 6.BR/STONE 10.	1.GOOD 4.Obsolete 7.	Grade & Factor <b>3 Average 95%</b>
3.COMP 7.NOV 11.	2.TYPICAL 5. 8.	1.E Grade 4.B Grade 7.AA+ Grad
4.ASB/ASP 8.AL/VIN 12.	3.OLD TYPE 6. 9.None	2.D Grade 5.A Grade 8.AA++Grad
Roof Surface <b>1 Asphalt Shingles</b>	Bath(s) Style <b>2 TYPICAL</b>	3.C Grade 6.AA Grade 9.Same
1.Asphalt 4.Composit 7.	1.GOOD 4.Obsolete 7.	SQFT (Footprint) <b>960</b>
2.Slate 5.Wood 8.	2.TYPICAL 5. 8.	Condition <b>3 Below Average</b>
3.Metal 6.Other 9.	3.Old Type 6. 9.None	1.Poor 4.Avg 7.V G
SF Masonry Trim <b>0</b>	# Rooms <b>5</b>	2.Fair 5.Avg+ 8.Exc
OPEN-3-CUSTOM <b>0</b>	# Bedrooms <b>2</b>	3.Avg- 6.Good 9.Same
OPEN-4-CUSTOM <b>0</b>	# Full Baths <b>1</b>	Phys. % Good <b>0%</b>
Year Built <b>1980</b>	# Half Baths <b>0</b>	Funct. % Good <b>90%</b>
Year Remodeled <b>0</b>	# Addn Fixtures <b>0</b>	Functional Code <b>8 OTHER</b>
Foundation <b>1 Concrete</b>	# Fireplaces <b>0</b>	1.Incomp 4.SMALL 7.LAYOUT
1.Concrete 4.Wood 7.		2.O-Built 5.CDU 8.OTHER
2.C Block 5.Slab 8.		3.Defmaint 6.STYLE 9.None
3.Br/Stone 6.Piers 9.		Econ. % Good <b>100%</b>
Basement <b>5 Crawl Space</b>		Economic Code <b>None</b>
1.1/4 Bmt 4.Full Bmt 7.		0.None 3.Services 9.None
2.1/2 Bmt 5.None 8.		1.Location 4.Traffic 8.
3.3/4 Bmt 6. 9.None		2.Encroach 8.Other 9.
Bsmt Gar # Cars <b>0</b>		Entrance Code <b>1 Interior Inspect</b>
Wet Basement <b>9 No Basement</b>		1.Interior 4.Vacant 7.
1.Dry 4. 7.		2.Refusal 5.Estimate 8.
2.Damp 5. 8.		3.Informed 6. 9.
3.Wet 6. 9.		Information Code <b>1 Owner</b>
		1.Owner 4.Agent 7.
		2.Relative 5.Estimate 8.
		3.Tenant 6.Other 9.

Date Inspected 12/09/2006

## Additions, Outbuildings & Improvements

Type	Year	Units	Grade	Cond	Phys.	Funct.	Sound Value	
22 Encl Frame Porch	0	48	0 0	0	0 %	0 %		1.ONE STORY FRAM
24 Frame Shed	1966	1078	3 100	4	0 %	100 %		2.TWO STORY FRAM
248 MAN STEEL.....	1966	3720	3 100	3	0 %	60 %		3.THREE STORY FR
267 WAREHOUSE	1988	960	2 100	4	0 %	60 %		4.1 & 1/2 STORY
					%	%		5.1 & 3/4 STORY
					%	%		6.2 & 1/2 STORY
					%	%		21.Open Frame Por
					%	%		22.Encl Frame Por
					%	%		23.Frame Garage
					%	%		24.Frame Shed
					%	%		25.Frame Bay Wind
					%	%		26.1SFr Overhang
					%	%		27.Unfin Basement
					%	%		28.Unfinished Att
					%	%		29.Finished Attic

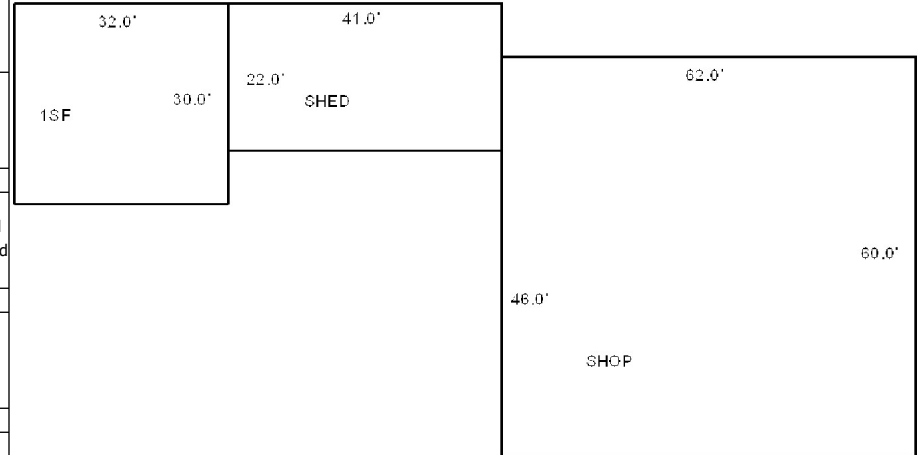



# WISCASSET

Map Lot U20-007

Account 1832

Location 119 CHEWONKI NECK ROAD

Card 1 Of 1 9/25/2024

Building Style	SF Bsmt Living	Layout
1.Conv. 5.Colonial 9.Other	Fin Bsmt Grade	1.Typical 4. 7.
2.Ranch 6.Split 10.Double	HEARTH	2.Inadeq 5. 8.
3.R Ranch 7.Mod/Cont 11.Multi	Heat Type <b>100%</b>	3. 6. 9.
4.Cape 8.Log 12.Cot.	1.HWBB 5.FWA 9.No Heat	Attic
Dwelling Units	2.HWCI 6.GravWA 10.	1.1/4 Fin 4.Full Fin 7.
Other Units	3.H Pump 7.Electric 11.	2.1/2 Fin 5.F/Stair 8.
Stories	4.Steam 8.F/Wall 12.	3.3/4 Fin 6. 9.None
1.1 4.1.5 7.	Cool Type <b>0%</b>	Insulation
2.2 5.1.75 8.	1.Refrig 4.W&C Air 7.	1.Full 4.Minimal 7.
3.3 6.2.5 9.	2.Evapor 5. 8.	2.Heavy 5.Unknown 8.
Exterior Walls	3.H Pump 6. 9.None	3.Capped 6. 9.None
1.CLAP 5.T-111 9.OTHER	Kitchen Style	Unfinished %
2.WD SH 6.BR/STONE 10.	1.GOOD 4.Obsolete 7.	Grade & Factor
3.COMP 7.NOV 11.	2.TYPICAL 5. 8.	1.E Grade 4.B Grade 7.AA+ Grad
4.ASB/ASP 8.AL/VIN 12.	3.OLD TYPE 6. 9.None	2.D Grade 5.A Grade 8.AA++Grad
Roof Surface	Bath(s) Style	3.C Grade 6.AA Grade 9.Same
1.Asphalt 4.Composit 7.	1.GOOD 4.Obsolete 7.	SQFT (Footprint)
2.Slate 5.Wood 8.	2.TYPICAL 5. 8.	Condition
3.Metal 6.Other 9.	3.Old Type 6. 9.None	1.Poor 4.Avg 7.V G
SF Masonry Trim	# Rooms	2.Fair 5.Avg+ 8.Exc
OPEN-3-CUSTOM	# Bedrooms	3.Avg- 6.Good 9.Same
OPEN-4-CUSTOM	# Full Baths	Phys. % Good
Year Built	# Half Baths	Funct. % Good
Year Remodeled	# Addn Fixtures	Functional Code
Foundation	# Fireplaces	1.Incomp 4.SMALL 7.LAYOUT
1.Concrete 4.Wood 7.		2.O-Built 5.CDU 8.OTHER
2.C Block 5.Slab 8.		3.Defmaint 6.STYLE 9.None
3.Br/Stone 6.Piers 9.		Econ. % Good
Basement		Economic Code
1.1/4 Bmt 4.Full Bmt 7.		0.None 3.Services 9.None
2.1/2 Bmt 5.None 8.		1.Location 4.Traffic 8.
3.3/4 Bmt 6. 9.None		2.Encroach 8.Other 9.
Bsmt Gar # Cars		Entrance Code <b>1 Interior Inspect</b>
Wet Basement		1.Interior 4.Vacant 7.
1.Dry 4. 7.		2.Refusal 5.Estimate 8.
2.Damp 5. 8.		3.Informed 6. 9.
3.Wet 6. 9.		Information Code <b>6 Other</b>
		1.Owner 4.Agent 7.
		2.Relative 5.Estimate 8.
		3.Tenant 6.Other 9.

Date Inspected 12/09/2006

## Additions, Outbuildings & Improvements

Type	Year	Units	Grade	Cond	Phys.	Funct.	Sound Value	
23 Frame Garage	1972	576	3 100	4	0 %	100 %		1.ONE STORY FRAM
24 Frame Shed	1972	400	2 100	1	0 %	100 %		2.TWO STORY FRAM
998 14' Mobile	2013	14x68	2 100	4	0 %	50 %		3.THREE STORY FR
68 Wood Deck	2013	48	3 100	4	0 %	100 %		4.1 & 1/2 STORY
					%	%		5.1 & 3/4 STORY
					%	%		6.2 & 1/2 STORY
					%	%		21.Open Frame Por
					%	%		22.Encl Frame Por
					%	%		23.Frame Garage
					%	%		24.Frame Shed
					%	%		25.Frame Bay Wind
					%	%		26.1SFr Overhang
					%	%		27.Unfin Basement
					%	%		28.Unfinished Att
					%	%		29.Finished Attic

SHED 16X36

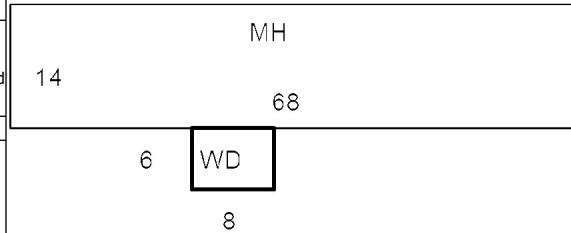

GARAGE 20X20

